



## CONTENTS



Colors and decorations may vary from those shown.

Please remove everything from the package and compare to the contents shown here.  
If any items are missing, please call 1-800-524-TOYS.



*Keep these instructions for future reference as they contain important information.*

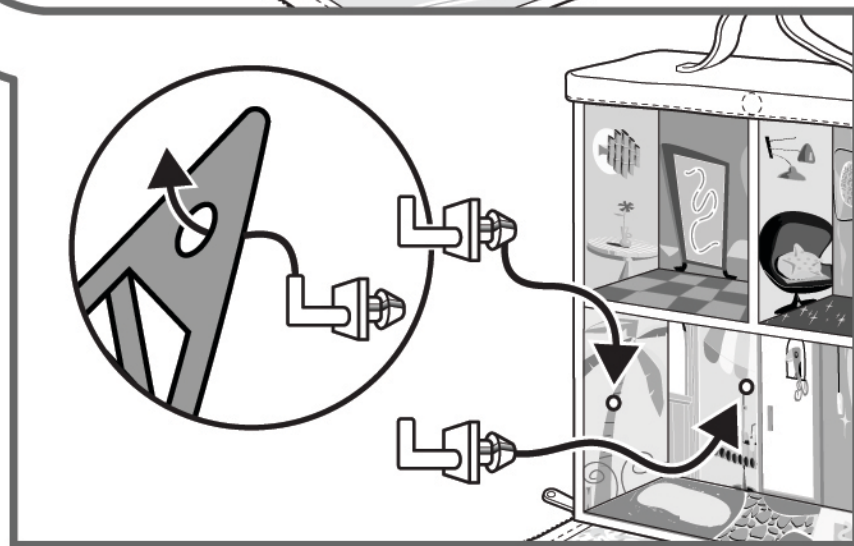
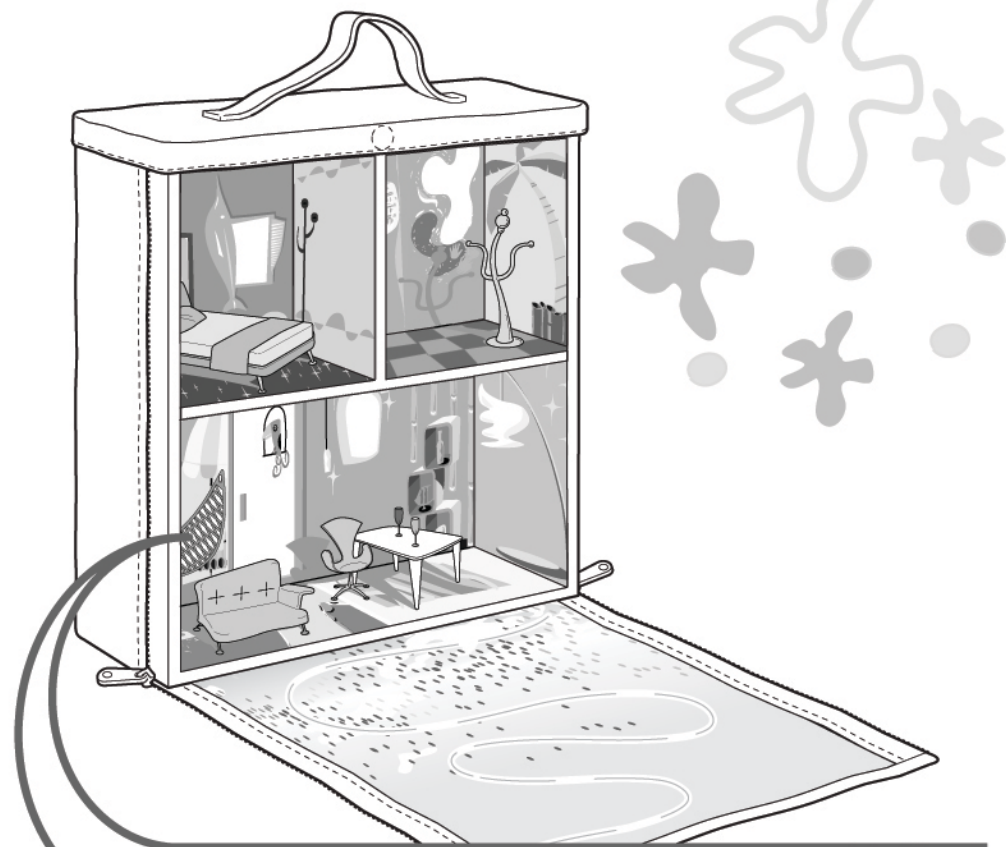
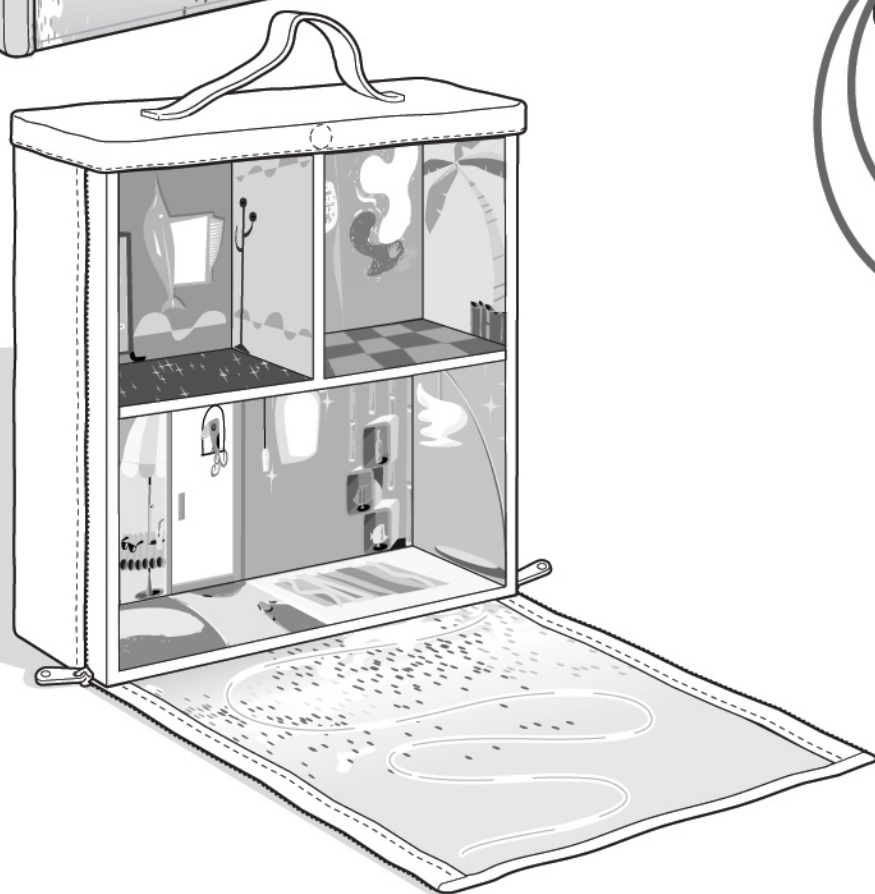
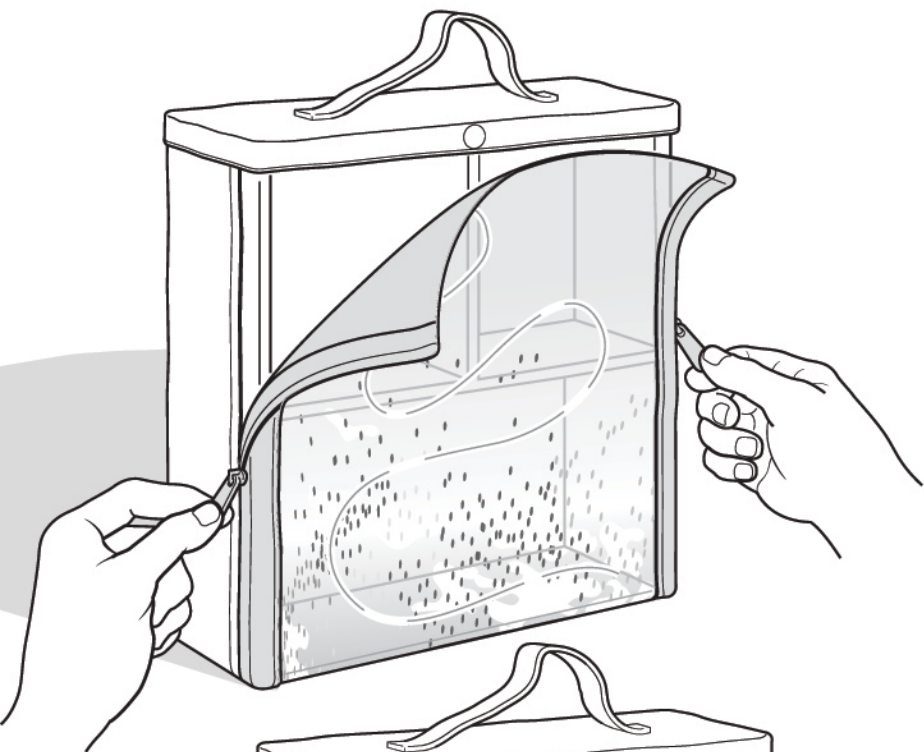

When fashions become dry, use baby powder for lubrication.

---

#### CONSUMER INFORMATION

**YOU CAN TELL IT'S MATTEL!**<sup>TM</sup> CALL us toll-free or write with any comments or questions about our products or service. Monday-Friday 8:00 a.m.-6:00 p.m. Eastern Time. Outside U.S.A., see telephone directory for Mattel listing.

**Consumer Relations, Mattel, Inc.**  
333 Continental Blvd.  
El Segundo, CA 90245 USA

**1(800) 524-TOYS**

**WE ARE DEDICATED TO QUALITY PRODUCTS.**

---

Mattel U.K., Ltd., Vanwall Business Park, Maidenhead SL6 4UB. Helpline 01628500303.

Mattel Australia Pty., Ltd., Richmond, Victoria 3121. Consumer Advisory Service 1300 135 312 (valid only in Australia).

Mattel East Asia Ltd, Room 1106, South Tower, World Finance Centre, Harbour City, Tsimshatsui, HK, China.