

SESAME STREET

Elmo's Sing & Teach™ Table

INSTRUCTION SHEET

Please keep these instructions for future reference as they contain important information.

ADULT ASSEMBLY REQUIRED

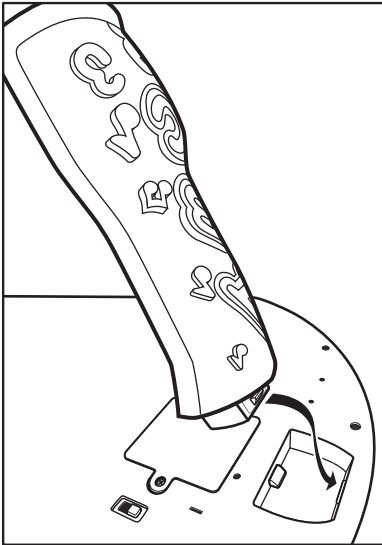

Assembly of 3 legs

PARENTS NOTE: Assembly of the 3 legs and Elmo's head is a one-time assembly. Once these pieces are assembled they cannot be taken apart.

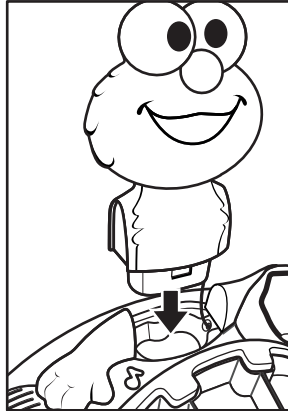

Assembly of Elmo's head

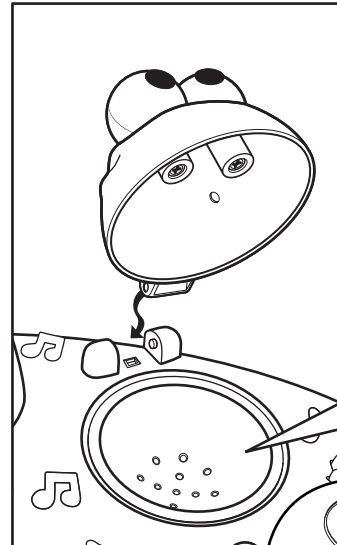

Assembly of Cookie Monster's Cup

PARENTS NOTE: Cookie Monster's Cup is removable and hand washable. Do NOT put in a dishwasher.

To begin play, be sure the ON/OFF switch is in the ON position. The ON/OFF switch is located on the bottom of the table.

BATTERY REPLACEMENT

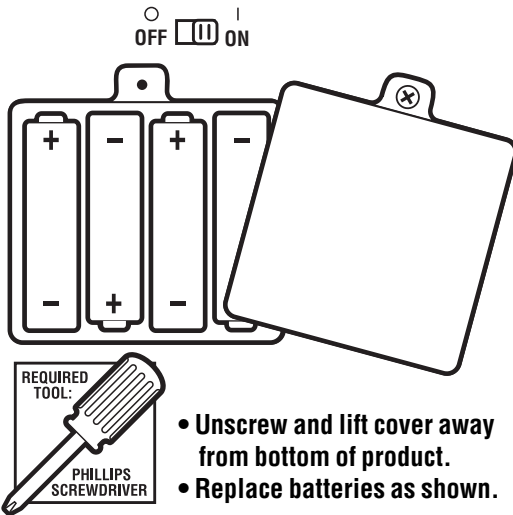

- Unscrew and lift cover away from bottom of product.
- Replace batteries as shown.

- Batteries included are for demonstration purposes only.
- If sounds play slowly or distort or the lights dim, replace 4 "AA" batteries as shown.
- Battery compartment is located on the bottom of the main plastic unit.
- For longer life use only alkaline batteries.

BATTERY SAFETY INFORMATION

In exceptional circumstances batteries may leak fluids that can cause a chemical burn injury or ruin your toy (product). To avoid battery leakage;

- Non-rechargeable batteries are not to be recharged.
- Rechargeable batteries are to be removed from the product before being charged (if designed to be removable).
- Rechargeable batteries are only to be charged under adult supervision (if designed to be removable).
- Do not mix alkaline, standard (carbon-zinc), or rechargeable (nickel-cadmium) batteries.
- Do not mix old and new batteries.
- Only batteries of the same or equivalent type as recommended are to be used.
- Batteries are to be inserted with the correct polarity.
- Exhausted batteries are to be removed from the product.
- The supply terminals are not to be short-circuited.
- Dispose of battery(ies) safely.
- Do not dispose of this product in a fire. The batteries inside may explode or leak.

©2003 Sesame Workshop. "Sesame Street," "Sesame Workshop" and their logos are trademarks of Sesame Workshop. All rights reserved.

Watch Sesame Street on PBS and 123 Sesame on Noggin. Fisher-Price, Inc., a subsidiary of Mattel, Inc., New York, New York 10010 U.S.A.

PRINTED IN CHINA.

Manufactured for Fisher-Price. ©2003 Mattel, Inc. All Rights Reserved.

Fisher-Price and the Fisher-Price logo are U.S. trademarks of Mattel, Inc. Packaging and address should be retained for future reference. Mattel Canada Inc., Mississauga, Ontario L5R 3W2. You may call us free at 1-800-665-6288.

Mattel U.K. Ltd., Vanwall Business Park, Maidenhead SL6 4UB. Helpline 01628500303.

Mattel Australia Pty., Ltd., Richmond, Victoria. 3121.

Consumer Advisory Service - 1300 135 312.

Mattel East Asia Ltd, Room 1106, South Tower,

World Finance Centre, Harbour City, Tsimshatsui, HK, China.

Diimport & Diedarkan Oleh: Mattel SEA Ptd Ltd.(993532-P) Lot 13.5, 13th Floor, Menara Lien Hoe,

Persiaran Tropicana Golf Country Resort, 47410 PJ.

Tel:03-78803817, Fax:03-78803867.

Mattel, Inc., El Segundo, CA 90245 U.S.A.

Consumer Affairs 1 (800) 524-Toys.



Questions or Comments?
1-888-892-6123

ITEM NO. C1344

Fisher-Price®

C1344-0920