



# MEGA RIG™ DINO ADVENTURE!



**Born from tough trucks and top technology, Mega Rigs are designed to adapt, react, and conquer.**

**All blueprints, materials and information you are about to see are confidential and for your eyes only. Keep them secret.**

**Your mission: to capture a living dinosaur. Good luck!**

Please keep these instructions for future reference as they contain important information.

Requires 3 AG13 (LR44) button cell batteries or equivalent batteries (included). Batteries included are for demonstration purposes only.

© 2005 Mattel, Inc. All Rights Reserved. PRINTED IN CHINA



G3714-0920G1

## MEGA SYSTEM

Pieces Combine and Recombine!  
Try Any Combination!

### CONTENTS

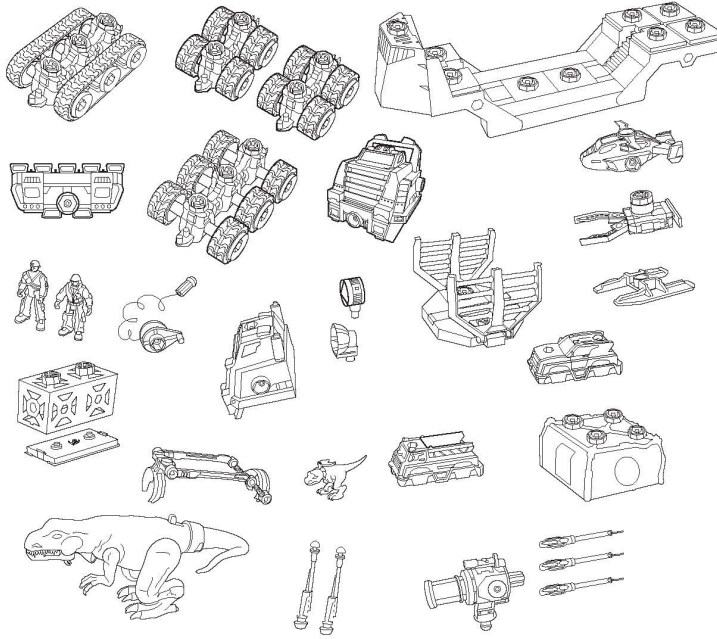

**WARNING:**  
CHOKING HAZARD - Small parts.  
Not for children under 3 years.

**ADVERTENCIA:**  
PUEDE CAUSAR ASFIXIA.  
No recomendable para menores de 3 años. Contiene piezas pequeñas.

**ATTENTION:**  
NE CONVIENT PAS aux enfants de moins de 36 mois. Petits éléments détachables susceptibles d'être avalés.

### CAN YOU BUILD THESE?

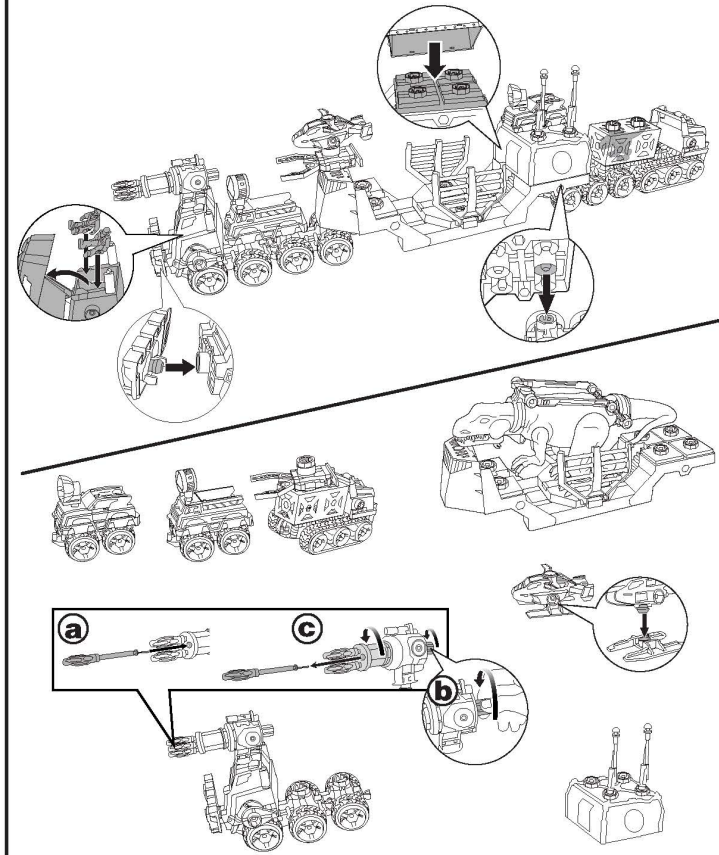

## CAN YOU BUILD THESE?

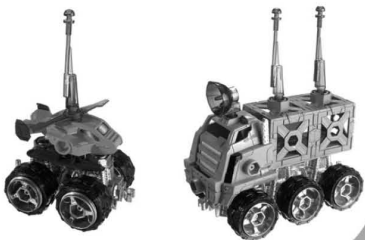

## BATTERY INSTALLATION/REPLACEMENT

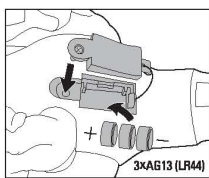

Open battery cover with Phillips head screwdriver (not included) remove batteries included for demonstration purposes only and insert 3 new bottom cell AG13 (LR44) alkaline batteries (not included) as shown. Replace cover and tighten screw. For longer life use only alkaline batteries. Replace batteries when sound distorts or product does not function properly.

## ASSEMBLY

### Connect Mega Pieces!

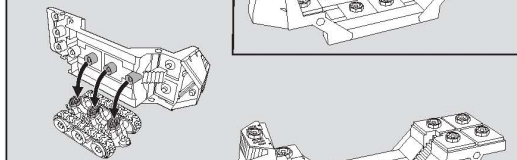
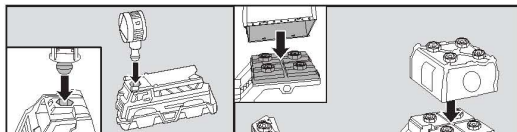
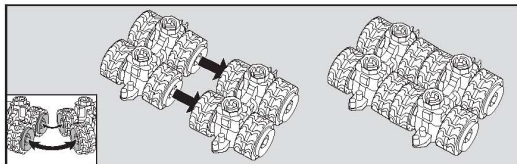
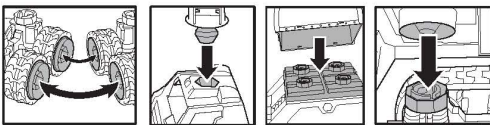

## Hitch One Rig To Another

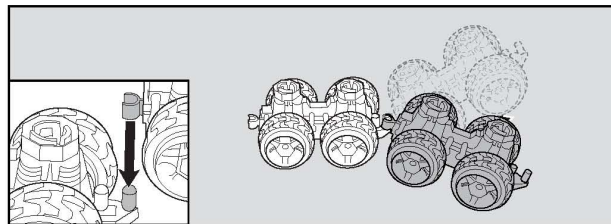
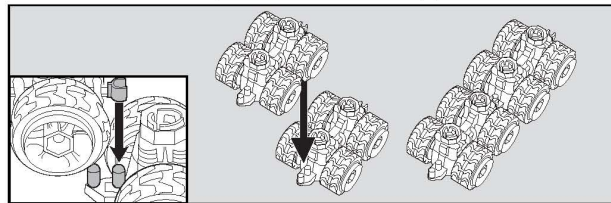
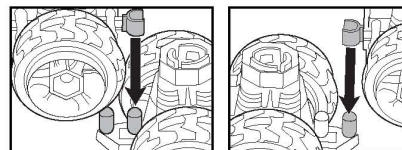

## Spin Barrel To Make Missiles Really Fire

• Only use projectiles supplied with this toy. Do not fire at people or animals or at point blank range.

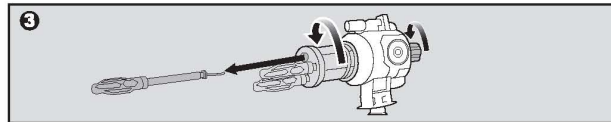
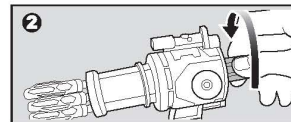
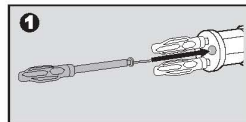

### Matchbox® Men Inside

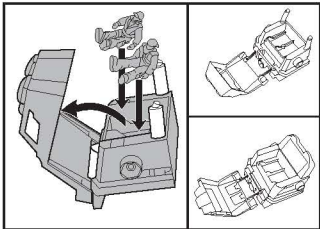

### Cage Opens

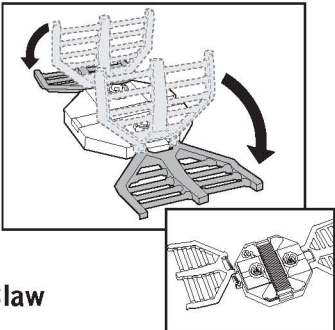

### Pull To Activate Capture Claw

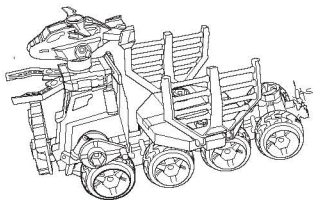
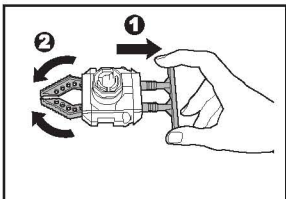

### Turn Handle To Make Winch Work

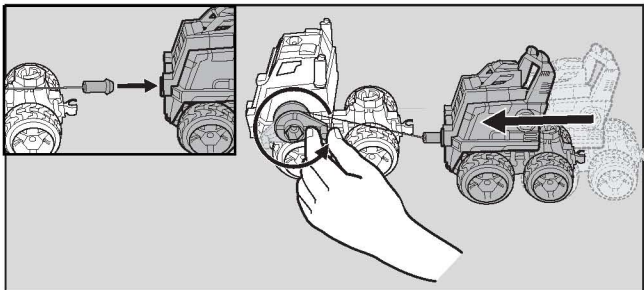

### Attach Capture Collar To Dino

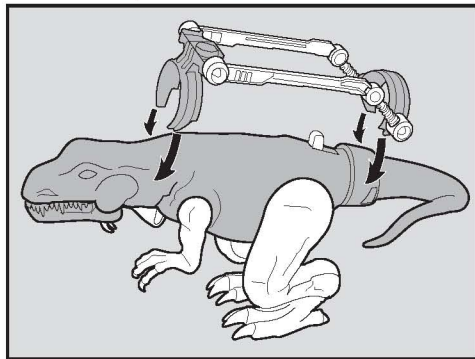

### Pull Lever To Open Dino Mouth

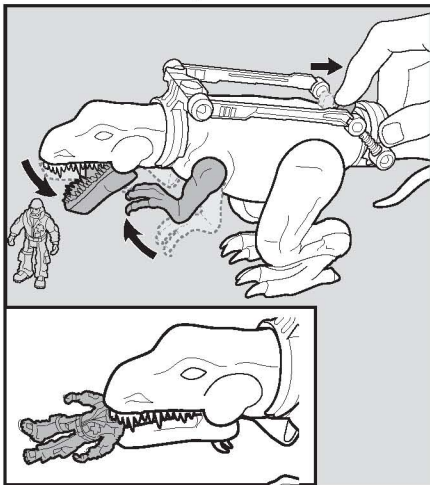

## The Biggest

Argentinosaurus was the biggest land animal in history. It was seven stories high, and it was as long as one-third of a football field. This creature was so massive, the earth literally shook as it went by. Get clear or get crushed!

## The Baddest

Gigantosaurus was the largest land predator ever to chow down. Roaming the ancient plains of South America, this monster had teeth almost a foot long. Gulp!

# KNOW YOUR DINOS

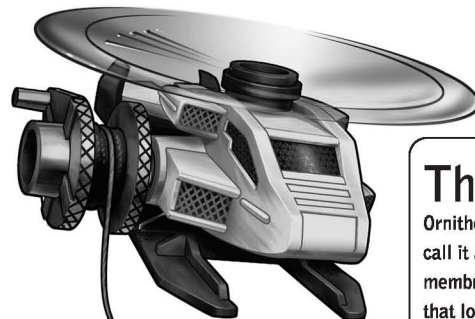

## The Altitudinous

Ornitomochilus flew in the air, but don't call it a bird. It had massive membranous (say mem-brain-us) wings that looked like a bat's. They were enormous – 40 feet from tip to tip – as big as an airplane. And it had sharp teeth, and it could drift on thermals for 100 miles without flapping a wing.



## The Coolest

Koolasuchus didn't look cool. With a massive head and flat body, it rested in shallow water, eating anything dumb enough to come for a drink. It also wasn't too cool at surviving, being beat out by the early crocodiles. Still...somebody named it Koolasuchus, so you decide!

## Battery Safety Information

In exceptional circumstances batteries may leak fluids that can cause a chemical burn injury or ruin your toy (product). To avoid battery leakage:

- Non-rechargeable batteries are not to be recharged.
- Rechargeable batteries are to be removed from the product before being charged (if designed to be removable).
- Rechargeable batteries are only to be charged under adult supervision (if designed to be removable).
- Do not mix alkaline, standard (carbon-zinc), or rechargeable (nickel-cadmium) batteries.
- Do not mix old and new batteries.
- Only batteries of the same or equivalent type as recommended are to be used.
- Batteries are to be inserted with the correct polarity.
- Exhausted batteries are to be removed from the product.
- The supply terminals are not to be short-circuited.
- Dispose of battery(ies) safely.
- Do not dispose of this product in a fire. The batteries inside may explode or leak.

## RECYCLE INFORMATION (USA ONLY)

Please recycle button cell battery(ies) contained in this product by:

- Visiting your nearest recycling center. For location of the nearest recycling center, visit us online at [www.service.mattel.com](http://www.service.mattel.com).
- If a recycling center is not available in your area, contact us for a pre-paid mailing label. Visit us online at [www.service.mattel.com](http://www.service.mattel.com) or call toll-free at 1(800)524-TOYS.

*Valid in the US only • Solo válido en los EE.UU. • Valable aux États-Unis seulement.*

This equipment has been tested and found to comply with the limits for a Class B digital device, pursuant to part 15 of the FCC rules. These limits are designed to provide reasonable protection against harmful interference in a residential installation. This equipment generates, uses and can radiate radio frequency energy and, if not installed and used in accordance with the instructions, may cause harmful interference to radio communications. However, there is no guarantee that interference will not occur in a particular installation. If this equipment does cause harmful interference to radio or television reception, which can be determined by turning the equipment off and on, the user is encouraged to try to correct the interference by one or more of the following measures:

Reorient or relocate the receiving antenna.

Increase the separation between the equipment and receiver.

Connect the equipment into an outlet on a circuit different from that to which the receiver is connected.

Consult the dealer or an experienced radio/TV technician for help.

Mattel, Inc.  
333 Continental Blvd.  
El Segundo, CA  
(310) 252-2400

Note: Changes or modifications not expressly approved by the manufacturer responsible for compliance could void the user's authority to operate the equipment.

© 2005 Mattel, Inc., El Segundo, CA 90245 U.S.A. All Rights Reserved. Tous Droits Réservés. • Mattel Canada Inc., Mississauga, Ontario L5R 3W2. You may call us free at 1-800-524-8697. • Mattel U.K. Ltd., Vanwall Business Park, Maidenhead SL6 4UB. Helpline: 01628 500303. • Mattel France, 27/33 rue d'Antony, Siliç 145, 94523 Rungis Cedex N° Indigo 0 825 00 00 25 (0,15 TTC/mn) ou [www.allomattel.com](http://www.allomattel.com). • Mattel B.V., Postbus 576, 1180 AN Amstelveen, Nederland 0800 - 2628835. • Mattel Belgium, Trade Mart, Atomiumsquare, Bogota 202 - B 275, 1020 Brussel, België. • Deutschland: Mattel GmbH, An der Trift 75, D-63303 Dreieich. • Schweiz: Mattel AG, Monbijoustrasse 68, CH-3000 Bern 23. • Österreich: Mattel Ges.m.b.H., Triester Str. 14, A-2355 Wiener Neudorf. • Mattel Scandinavia A/S, Ringager 4C, DK-2605 Brøndby. • Mattel Northern Europe A/S., Sinikalliontie 3, 02630 ESPOO, Puh. 0303 9060. • Mattel Srl., 28040 Oleggio Castello, Italy. • Mattel España, S.A., Aribau 200. 08036 Barcelona. [cservice.spain@mattel.com](mailto:cservice.spain@mattel.com). • Mattel Portugal Lda., Av. da República, nº 90/96, 2º andar Fracção 2, 1600-206 Lisboa. • Mattel AEBE, Ελληνικό 2, 011777. 011777. 011777. • Mattel Australia Pty Ltd., Richmond, Victoria. 3121. 1300 135 312. • Mattel East Asia Ltd, Room 1106, South Tower, World Finance Centre, Harbour City, Tsimshatsui, HK, China. • Diimport & Diedarkan Oleh: Mattel SEA Ptd Ltd. (993532-P) Lot 13.5, Menara Lien Hoe, Persiaran Tropicana Golf Country Resort, 47410 PJ. Tel: 03-78803817, Fax: 03-78803867. • Mattel, Inc., 333 Continental Blvd., El Segundo, CA 90245 U.S.A. Consumer Affairs: 1 (800) 524-TOYS. • Importado y distribuido por Mattel de México, S.A. de C.V., Insurgentes Sur # 3579, Torre 3, Oficina 601, Col. Talpan, Delegación Talpan, C.P. 14020, México, D.F. TEL: 54-49-41-00. MME-920701-NB3. • Mattel Chile, S.A., Avenida Américo Vespucio 501-B, Quilicura, Santiago. • Mattel de Venezuela, C.A., Ave. Mara, C.C. Macaracuay Plaza, Torre B, Piso 8, Colinas de la California, Caracas 1071. • Mattel Argentina S.A., Curupayí 1186, (1607) - Villa Adelina, Buenos Aires. • Mattel Colombia, S.A., calle 123#7-07 P.5, Bogotá. Mattel do Brasil Ltda. - CNPJ : 54.558.002/0004-72 Av. Tamboré, 1400/1440 Quadra A de 02 a 03 - 06460-000 - Barueri - SP. Atendimento ao Consumidor: SAC 0800550780.