



8+



ASST. K72
K7242/K7243-0920



INSTRUCTIONS

Keep these instructions for future reference as they contain important information.
This plane is designed to be played outdoors. Its main advantage is its lightness.
That means, however, you'll need to take extra precautions when handling the aircraft.

CONTENTS/FEATURES

1 PLANE
MOTORS AND CHARGER
CHARGER SQUADRON™ CHARGER PACK

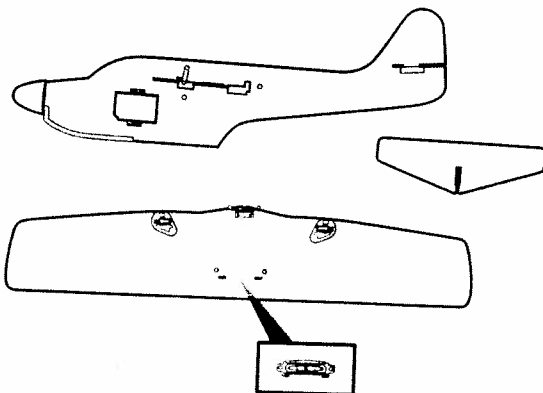
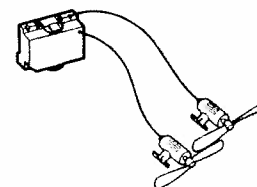
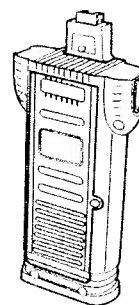

Rescue Plane

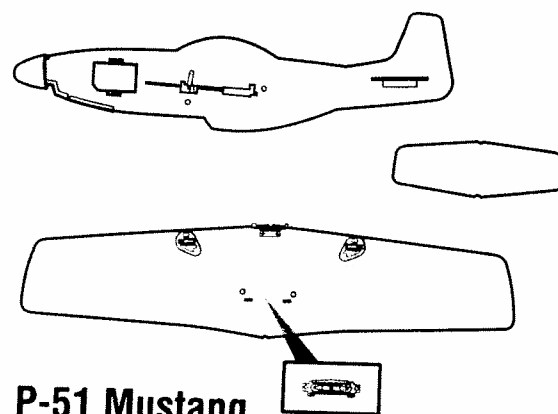

P-51 Mustang

Produced under license from Boeing Management Company. P-51 & North American are among the trademarks owned by Boeing.

Additional vehicles sold separately, subject to availability.

Adult assembly required.

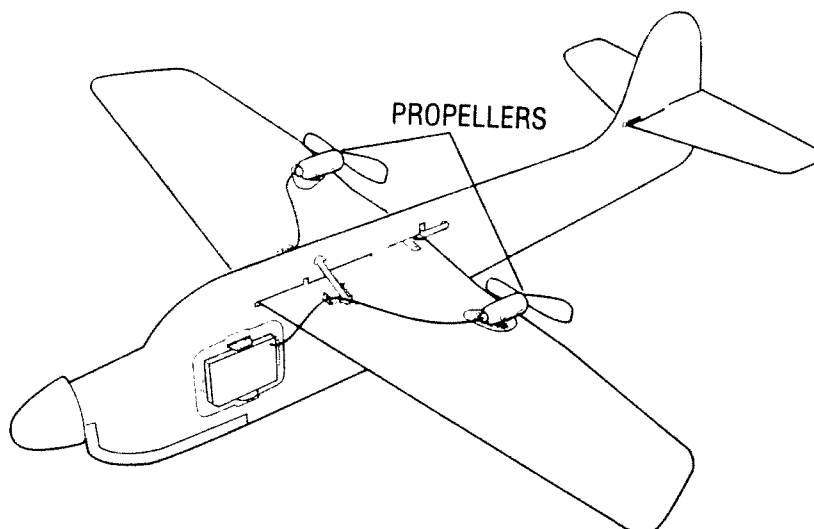

INSTALL BATTERIES

Unscrew battery cover with a Phillips head screwdriver (not included). Install 3 "AA" (LR6) alkaline batteries (not included), in the orientation (+/-) shown. Replace battery cover and tighten screws.

BATTERY SAFETY INFORMATION

In exceptional circumstances batteries may leak fluids that can cause a chemical burn injury or ruin your product.

To avoid battery leakage:

- Non-rechargeable batteries are not to be recharged.
- Rechargeable batteries are to be removed from the product before being charged (if designed to be removable).
- Rechargeable batteries are only to be charged under adult supervision (if designed to be removable).
- Do not mix alkaline, standard (carbon-zinc), or rechargeable (nickel-cadmium) batteries.
- Do not mix old and new batteries.
- Only batteries of the same or equivalent type as recommended are to be used.
- Batteries are to be inserted with the correct polarity.
- Exhausted batteries are to be removed from the product.
- The supply terminals are not to be short-circuited.
- Dispose of battery(ies) safely.
- Do not dispose of this product in a fire. The batteries inside may explode or leak.

Battery Performance Note:

For best performance use alkaline batteries. Battery life may vary depending on battery brand.

IMPORTANT INFORMATION

- DO NOT RECHARGE THE PLANE IF IT FEELS HOT. ALLOW IT TO COOL BEFORE RECHARGING.
- DO NOT ATTEMPT TO USE OR CHARGE THE PLANE IF IT SHOWS SIGNS OF LEAKAGE OR CORROSION.
- DO NOT DISASSEMBLE THE MOTORS AND CHARGER.
- IF THE PLANE AND/OR CHARGER ARE WET, THOROUGHLY DRY BEFORE USING OR CHARGING.
- REGULARLY EXAMINE ALL WIRES AND CONNECTORS. IN THE EVENT OF DAMAGE, DO NOT USE.
- CHARGER CONTAINS A RECHARGEABLE COMPONENT. IF FLUID LEAKS, AVOID CONTACT WITH EYES AND DISCARD CHARGER.
- ONLY USE THE CHARGER PACK SUPPLIED WITH THIS TOY. USE OF AN ALTERNATE CHARGING SOURCE WILL DAMAGE YOUR CHARGER.
- DO NOT CHARGE THE PLANE IF THE PROPELLERS DO NOT IMMEDIATELY START TO TURN WHEN CHARGER PACK IS APPLIED.

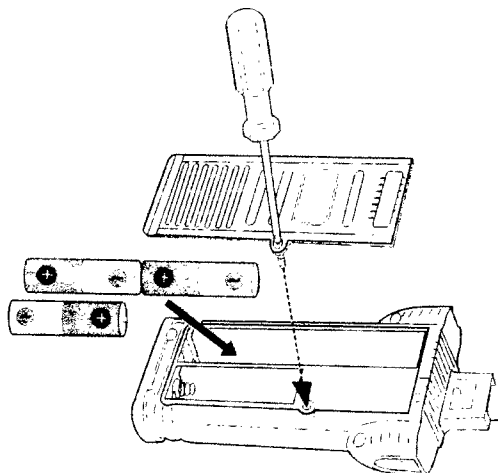

BUILD IT!

1.

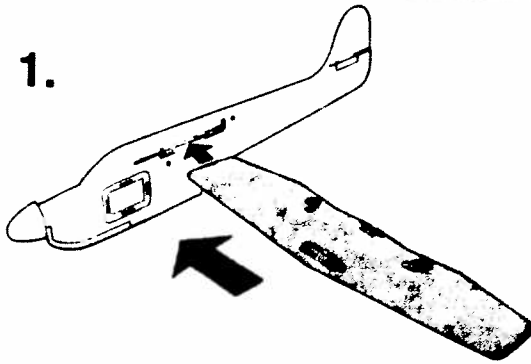

2.

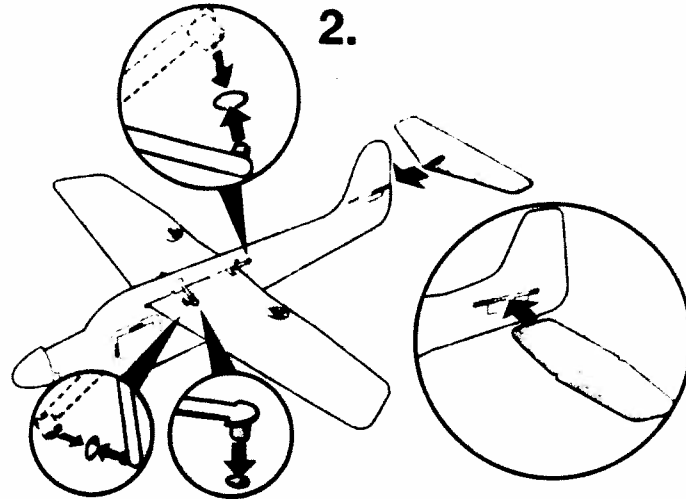

3.

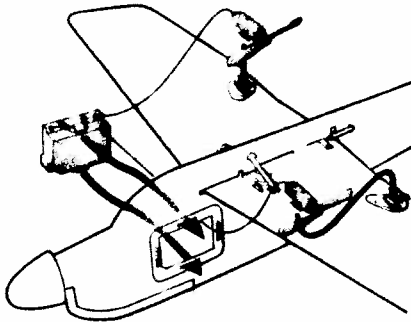

4.

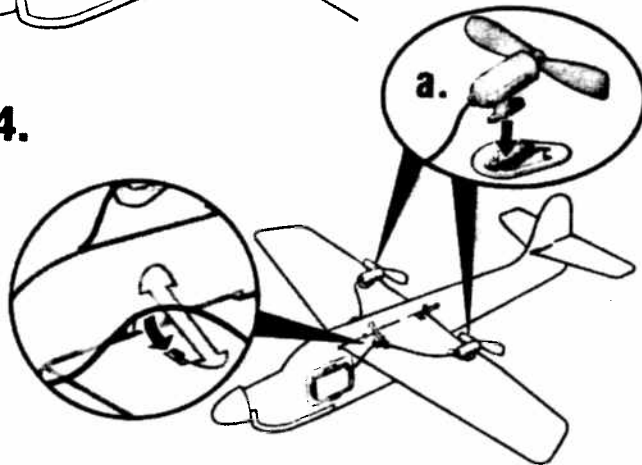

TOP VIEW

TOP VIEW

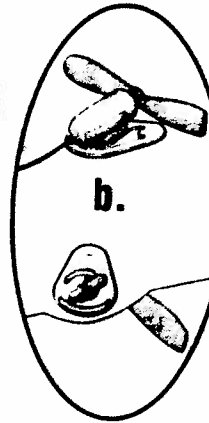

BOTTOM VIEW

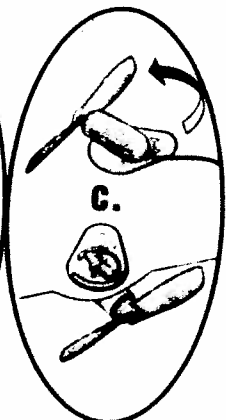

BOTTOM VIEW

PRE-FLIGHT CHECK

NOTE: Only fly in no wind/still conditions.

1. Give yourself plenty of flying room. For best results, you should have at least 36 feet/ 12m of open space in all directions. Try to find a grassy open area as pavement will damage the product.

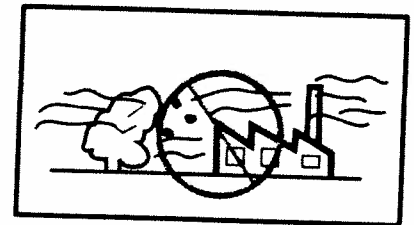
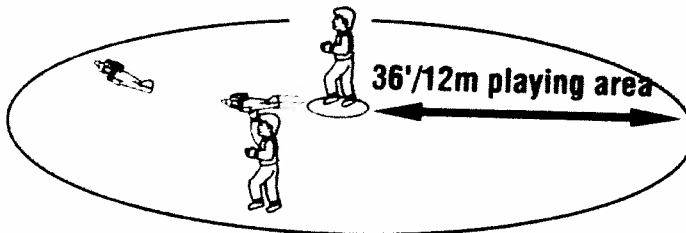

2. Avoid tall buildings, trees, and power lines as they may obstruct your flight path, and they may create air currents that make it difficult for your plane to fly.
 3. DO NOT fly in the street!
 4. Before charging the plane, throw it as a glider to make sure the plane is gliding straight. If it is not, make sure wings are aligned and connections are all tight.
- Be careful! Be a safe pilot...use common sense and care when flying. Watch out for people, animals, and

Set-up

1. Set the LEFT and RIGHT motors parallel to the fuselage.
2. Charge the plane for 5 seconds **ONLY**.
3. Toss the plane gently into the wind.
4. Observe whether the plane turns to the Right or Left side.

If the plane turns to the Right side trim the Right side motor towards the fuselage (Counter clockwise). We recommend 2-3 clicks inward from a straight position.

NOTE: The plane's turning radius will decrease as the motor is turned more towards the fuselage. Adjust the right motor angle to find a small enough radius for your play area and a large enough radius to keep the plane flying.

If the plane turns to the LEFT side, trim the LEFT side motor towards the fuselage (Clockwise). Again, we recommend 2-3 clicks inward from the straight position.

NOTE: The plane's turning radius will decrease as the motor is turned more towards the fuselage. Adjust the left motor angle to find a small enough radius for your play area and a large enough radius to keep the plane flying.

If the plane goes straight, you can trim either the LEFT or RIGHT side motor towards the fuselage as described above.

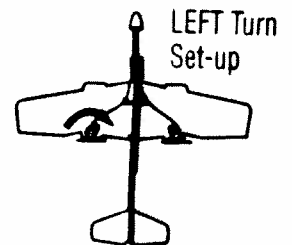
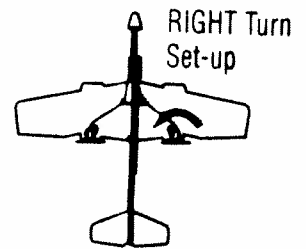

CHARGE IT!

- Insert top of charger pack into slot under the charger on plane.
- Press thumb switch on charger pack to charge plane.
- Propellers will begin to spin, so keep your hands clear. Do not attempt to hold propellers while charging. Propellers must spin during charging period.
- Maximum charge time is 15 seconds. Additional charging will not improve performance. Overcharging may reduce the life of your charger.
- Release the thumb switch and disconnect charger pack from plane. Propellers will be spinning and plane is ready to toss.

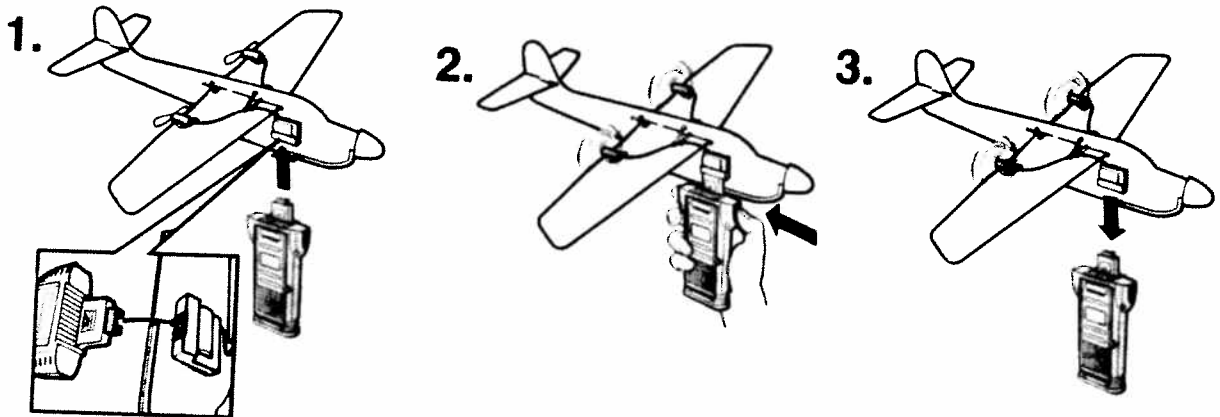

FLY IT!

Toss the plane gently for best flying. The propellers will continue to spin slowly after landing for a few minutes. This is normal. Wait 2 minutes and plane can be re-charged and flown again.

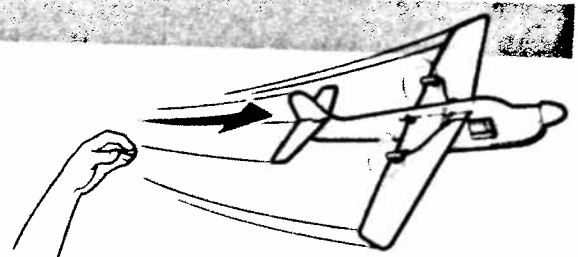

REPAIR

Use clear household tape to repair tears, creases or cracks. Use sparingly as added weight will affect perform

TROUBLESHOOTING

It takes a little time and practice to become an ace pilot. If you still have difficulty flying the plane, please che guide. Usually the problem is a simple one...with a quick solution.

1. Check air conditions. DO NOT attempt to operate the plane in windy conditions.
2. After landing, make sure the wing and fuselage assemblies are properly aligned.
3. Check the plane for dirt or mud and clean it if necessary.
4. Check all removable batteries. Make sure connections are secure. You may need to replace the battery with

WORKS WITH



QUICK TIPS

1.

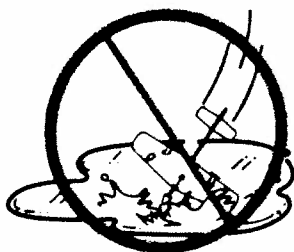

2.



1. Because the plane is sensitive to extra weight, dirt or mud on the plane can affect its operation. Use a clear dirt or mud immediately. If the plane gets wet, it's important not to operate it until it's completely dry, insic surfaces with a towel and allow the plane to air-dry until it's dry...overnight at least.
2. Do not store the plane near heat or in direct sunlight.

U.S.A.

90-DAY LIMITED WARRANTY – TYCO® R/C R/C PRODUCTS

Mattel, Inc. warrants to the original consumer purchaser that this product will be free of defects in material and workmanship for ninety (90) days (unless specified in alternate warranties) from the date of purchase. Mattel will repair or replace the product, at our sole option, in the event of such a defect within the warranty period.

In the event of a defect covered under this warranty, first call the toll-free number listed below. Many problems can be solved in this manner. If necessary, you will be instructed to return the product, postage prepaid and insured, to the address below. Enclose your name, address, dated sales receipt, and a brief explanation of the defect. Repair or replacement, and return shipment, will be free of charge. Please return only the defective part or unit, packed securely.

This warranty does not cover damage resulting from unauthorized modification, accident, misuse or abuse. If the product is returned without a dated sales receipt, the product may be excluded from coverage under this warranty.

Mattel's liability for defects in material and workmanship under this warranty shall be limited to repair or replacement, at our sole option, and in no event shall we be responsible for incidental, consequential, or contingent damages (except in those states that do not allow this exclusion or limitation). This warranty is exclusive, and is made in lieu of any express or implied warranty. This warranty gives you specific legal rights and you may have other rights, which vary from state to state. Some states do not allow the exclusion of incidental or consequential damages, so the above exclusions or limitations may not apply to you.

TOLL-FREE NUMBER: 1-888-557-TYCO (8926) - **Valid only in U.S.A.**

Hours: 8:00 A.M.-5:00 P.M. Eastern Time; Monday - Friday. Expect some delay in January following the holiday season.
Please be patient and keep trying the toll-free number.

ADDRESS FOR RETURNS: CONSUMER RELATIONS 636 GIRARD AVENUE EAST AURORA, NY 14052

Valid only in U.S.A.



Protect the environment by not disposing of this product with household waste [2002/96/EC]. Check your local authority for recycling advice and facilities.

© 2007 Mattel, Inc., 333 Continental Blvd., El Segundo, CA 90245 U.S.A. Consumer Relations 1-888-557-8926. **PRINTED IN CHINA.** All Rights Reserved. MATTEL, TYCO and associated trademarks and trade dress are owned by Mattel, Inc. Retain this address for future reference: Mattel U.K. Ltd., Varneall Business Park, Maidenhead SL6 4UB, Helpline 01628 500303. service.mattel.com Mattel Australia Pty Ltd., Richmond, Victoria 3121 - Consumer Advisory Service: 1300 135 312. Mattel East Asia Ltd, Room 1106, South Tower, World Finance Centre, Harbour City, Tsimshatsui, HK, China. Diimport & Diedarkan Oleh: Mattel SEA Ptd Ltd. (993532-P) Lot 13.5, Menara Lien Hoe, Persiaran Tropicana Golf Country Resort, 47410 P.J. Tel: 03-78803817, Fax: 03-78803867.