

TO PLAY (CONT)

2.

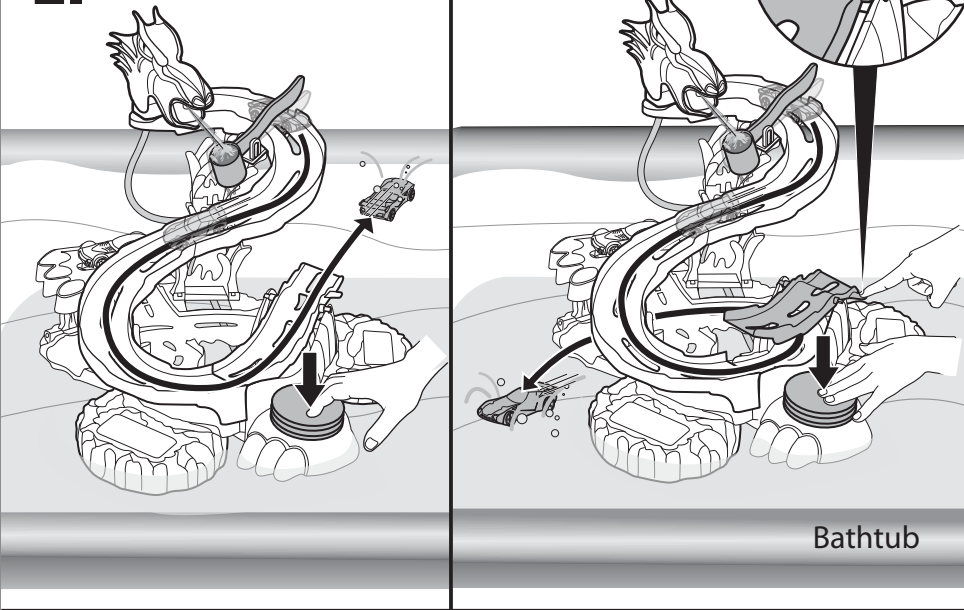

MORE WAYS TO PLAY

3.

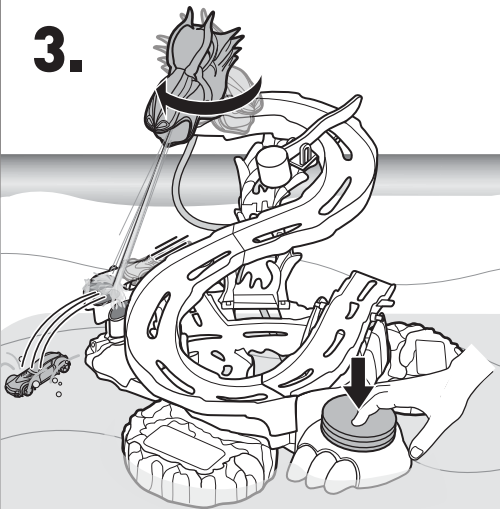

Drain, rinse, clean and dry all items thoroughly before storing.

4.

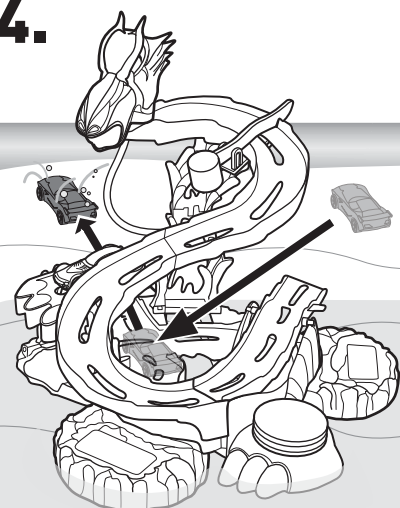

SEA SERPENT ISLAND™

INSTRUCTIONS

CONTENTS

4+



X2581-0920

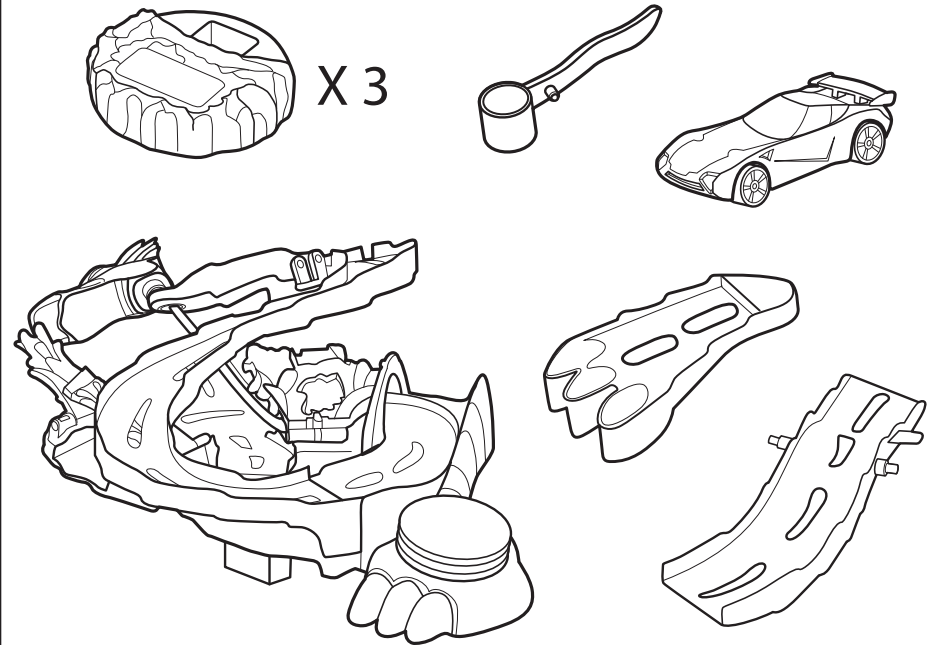

©2012 Mattel, Inc. All Rights Reserved. Mattel, Inc., 636 Girard Avenue, East Aurora, NY 14052, U.S.A. Consumer Relations 1-800-524-8697. • Mattel U.K. Ltd., Vanwall Business Park, Maidenhead SL6 4UB. Helpline 01628 500303. • Mattel Australia Pty., Ltd., Richmond, Victoria. 3121. Consumer Advisory Service - 1300 135 312. • Mattel East Asia Ltd., Room 1106, South Tower, World Finance Centre, Harbour City, Tsimshatsui, HK, China. • Diimport & Diedarkan Oleh: Mattel SEA Ptd Ltd. (993532-P) Lot 13.5, 13th Floor, Menara Lien Hoe, Persiaran Tropicana Golf Country Resort, 47410 PJ. Tel:03-78803817, Fax:03-78803867. service.mattel.com

ASSEMBLY

1.

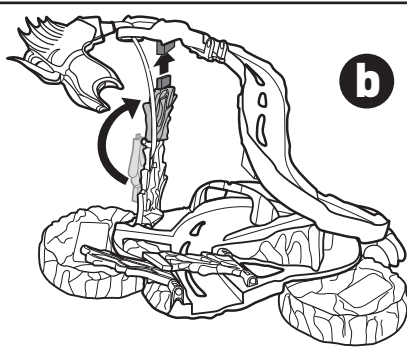
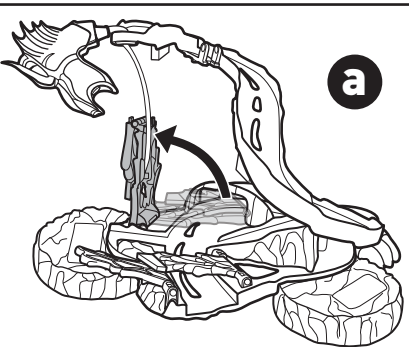
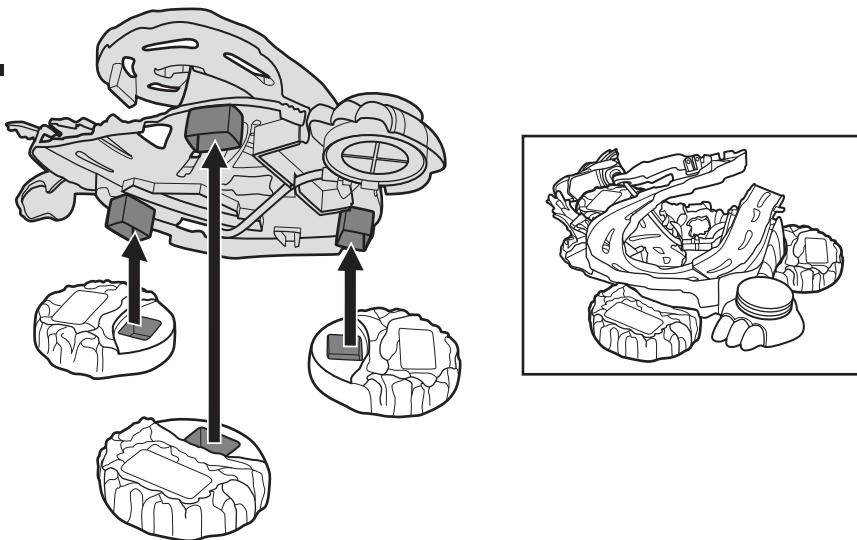

2.

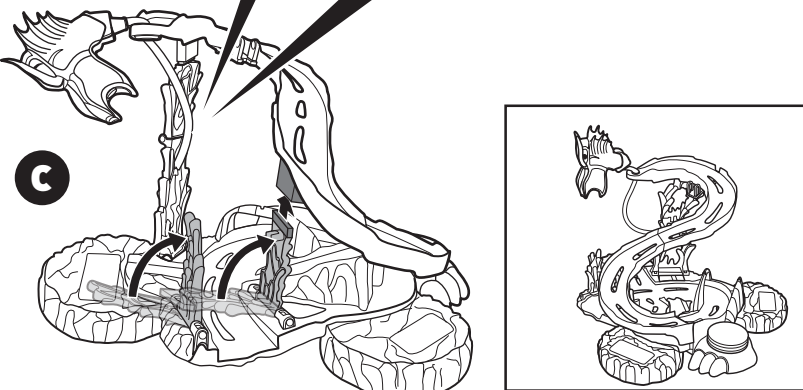

3.

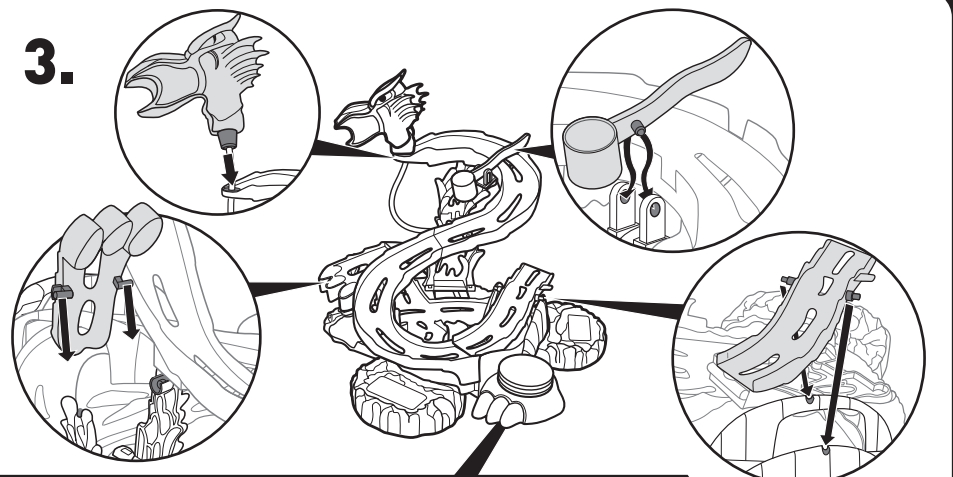

RE-INSTALL THE HOSE Adult supervision required.

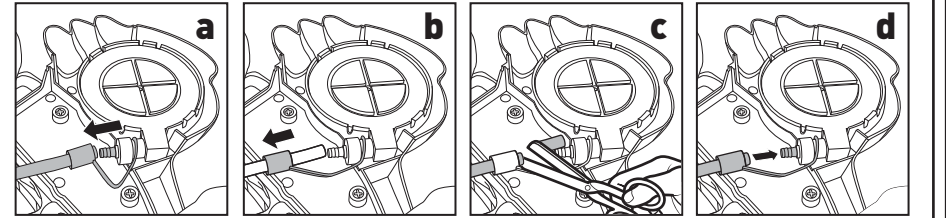

Bottom View

TO PLAY

1.

