

Hot Wheels®

SHARK PARK

INSTRUCTIONS

Adult Assembly Required.

CONTENTS:

Requires 3 "AA" batteries,
not included. Vehicles shown
not included.



WARNING:

CHOKING HAZARD – Small parts.
Not for children under 3 years.

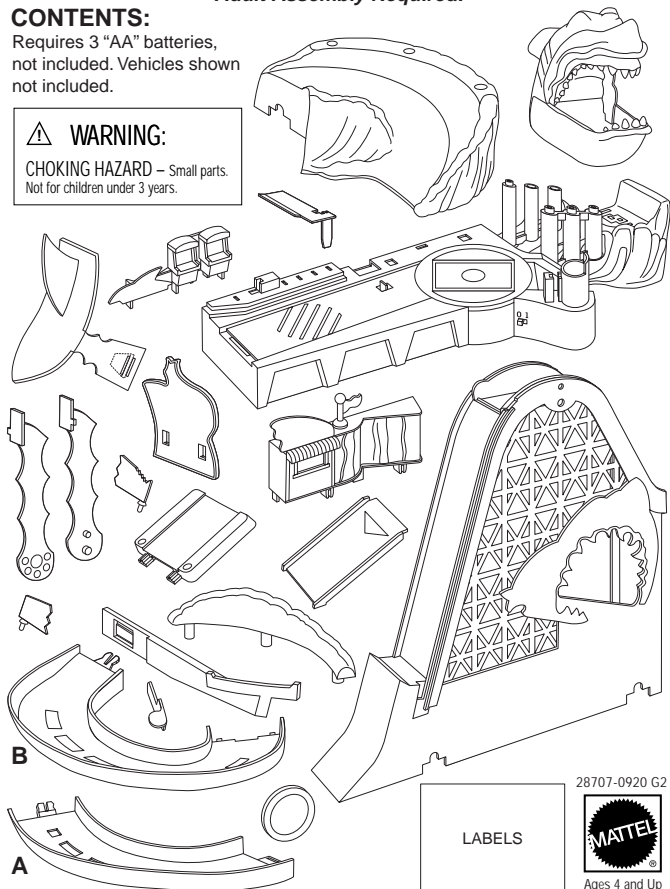

28707-0920 G2



Ages 4 and Up

- Do not get this toy wet.
- This product is not recommended for use on loose dirt or wet surfaces.

ALKALINE BATTERIES RECOMMENDED:

Toy may not function or operate with other types of batteries.

BATTERY SAFETY INFORMATION:

1. Non-rechargeable batteries are not to be recharged.
2. Rechargeable batteries are to be removed from the toy before being recharged.
3. Rechargeable batteries are only to be charged under adult supervision.
4. Do not mix alkaline, standard (carbon-zinc), or rechargeable (nickel-cadmium) batteries.
5. Do not mix old and new batteries.
6. Only batteries of the same or equivalent type as recommended are to be used.
7. Batteries are to be inserted with the correct polarity.
8. Exhausted batteries are to be removed from the toy.
9. The supply terminals are not to be short-circuited.
10. Dispose of batteries safely.

Batteries should be changed when the shark voice sounds scratchy or intermittent and cannot be understood.

2-YEAR LIMITED WARRANTY

Mattel, Inc. warrants to the original consumer purchaser that this product will be free of defects in material or workmanship for two years (unless specified in alternate warranties) from the date of purchase. If defective, return the product along with proof of the date of purchase, postage prepaid, to Consumer Relations, 636 Girard Avenue, East Aurora, New York 14052 for replacement or refund at our option. This warranty does not cover damage resulting from unauthorized modification, accident, misuse, or abuse. In no event shall we be responsible for incidental, consequential, or contingent damages (except in those states that do not allow this exclusion or limitation). **Valid only in U.S.A.** This warranty gives you specific legal rights and you may also have other rights which vary from state to state. Some states do not allow the exclusion of incidental or consequential damages, so the above limitations may not apply to you.

Send only the product to the address above. Send all correspondence to Consumer Relations, Mattel, Inc., 333 Continental Blvd., El Segundo, California 90245-5012, U.S.A.

Or you may phone us toll-free at 1-800-524-TOYS, Monday-Friday, 8:00 a.m.-6:00 p.m. Eastern Time. Outside U.S.A., see telephone directory for Mattel listing.

CONSUMER INFORMATION	
	<p>YOU CAN TELL IT'S MATTEL!™ Call us toll-free or write with any comments or questions about our products or service. Monday-Friday, 8:00 a.m.-6:00 p.m. Eastern Time. Outside U.S.A., see telephone directory for Mattel listing. Consumer Relations, Mattel, Inc., 333 Continental Blvd., El Segundo, CA 90245 U.S.A.</p>
	<p>1 (800) 524-TOYS</p>
	
<p>CONFORMS TO THE SAFETY REQUIREMENTS OF ASTM F963.</p>	
<p>We are dedicated to quality products.</p>	

Mattel U.K. Ltd., Vanwall Business Park, Maidenhead SL6 4UB. Helpline 01628500303.

Mattel Australia Pty. Ltd., Richmond, Victoria 3121.

Consumer Advisory Service 1800 800 812 (valid only in Australia).

INSTALL BATTERIES:

To open, lift up on tab at edge of battery door. Remove cover and set aside. Insert three "AA" size batteries (not included). Close cover.

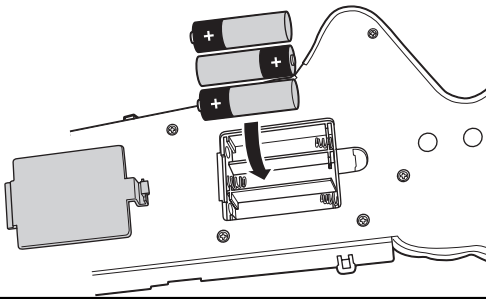

1. ASSEMBLY / LABELS:

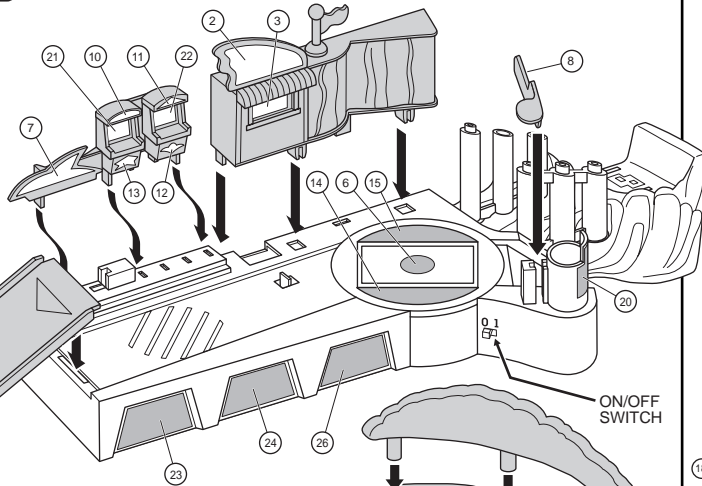

2.

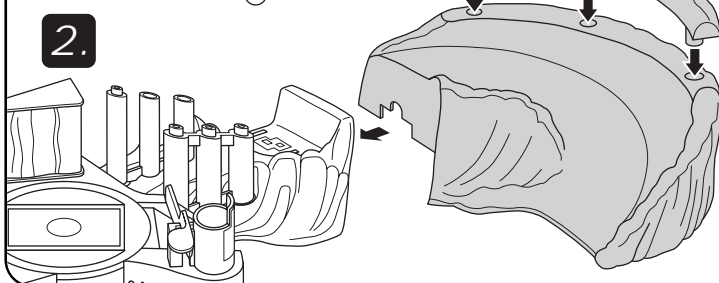

3.

Lift tilt ramp and fit car lift onto rail.

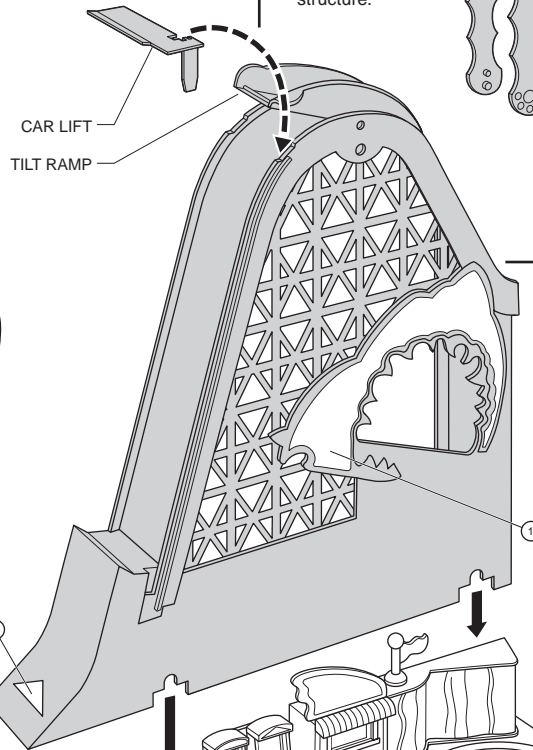

4.

Assemble sign arms first. Carefully spread arms to fit in holes of coaster structure.

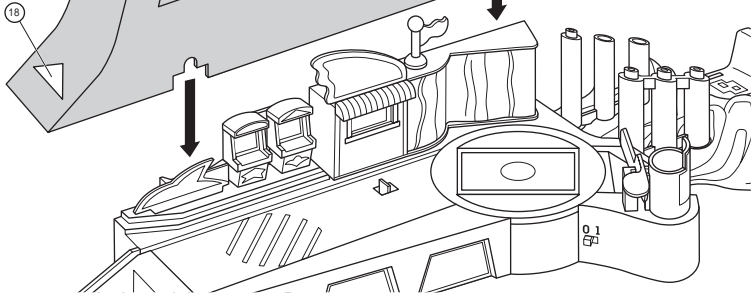
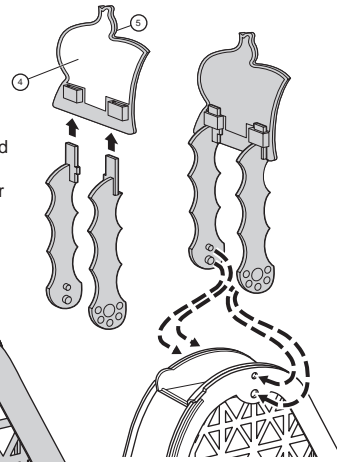

5.

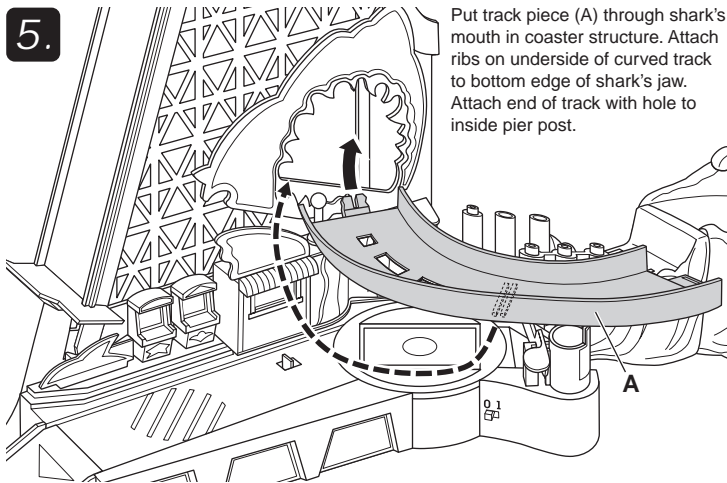

Put track piece (A) through shark's mouth in coaster structure. Attach ribs on underside of curved track to bottom edge of shark's jaw. Attach end of track with hole to inside pier post.

8.

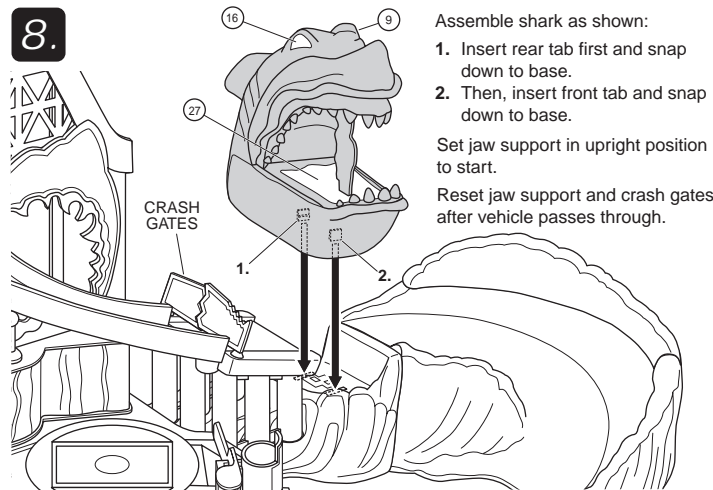

Adult assembly required.

Assemble shark as shown:

1. Insert rear tab first and snap down to base.
2. Then, insert front tab and snap down to base.

Set jaw support in upright position to start.

Reset jaw support and crash gates after vehicle passes through.

6.

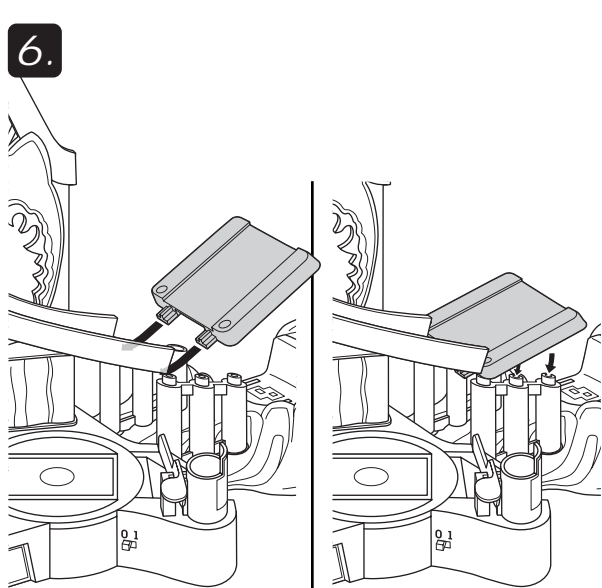

7.

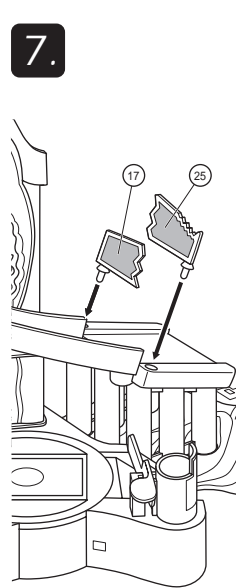

9.

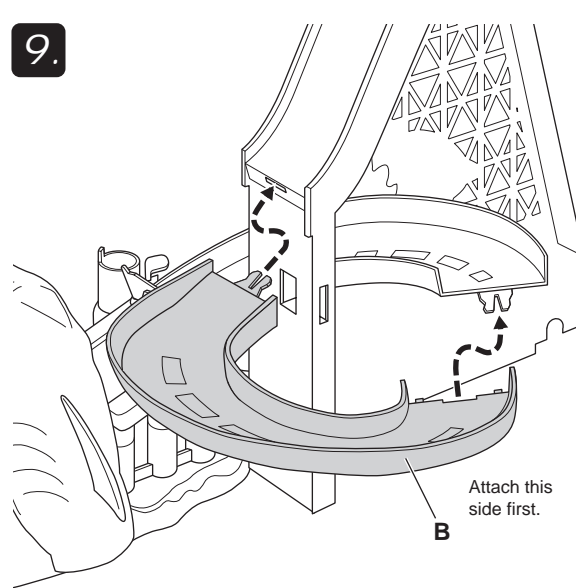

Attach this side first.

10.

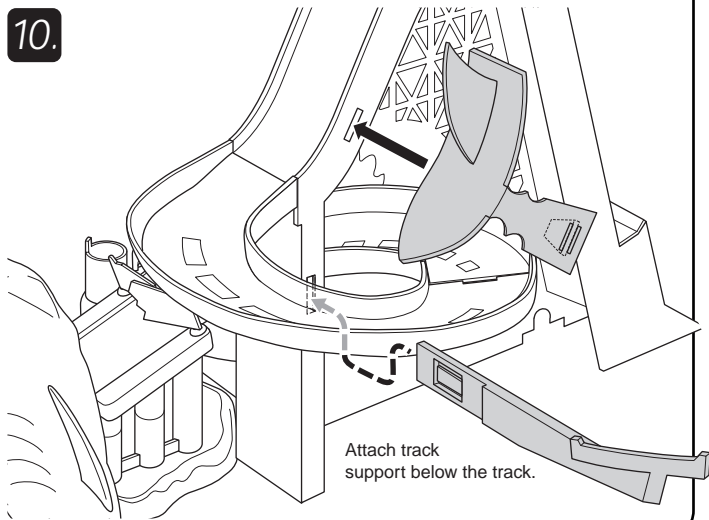

MOVING FEATURES:

PIZZA: (Auto Action Feature)

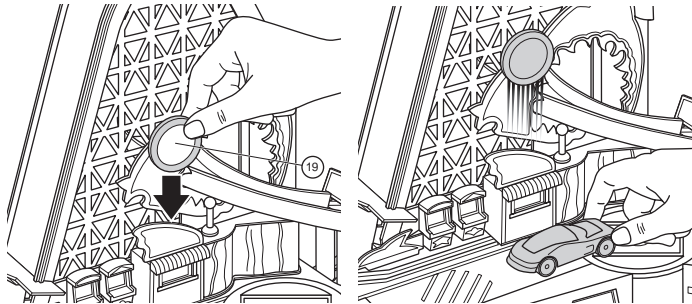

Only use projectiles (pizza) supplied with this toy.

MOVING FEATURES:

LIFT GATE: (With Sound)

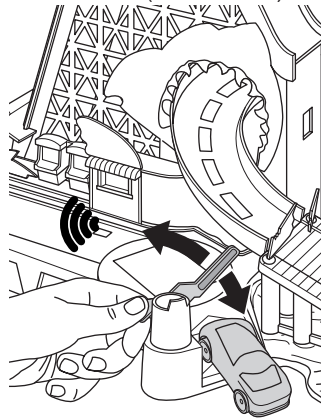

TURNTABLE:



CAR LIFT: (With Sound)

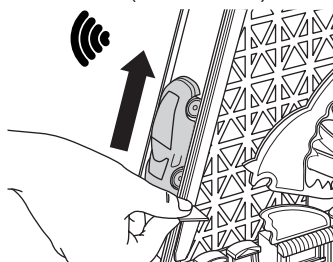

CAR LAUNCH:

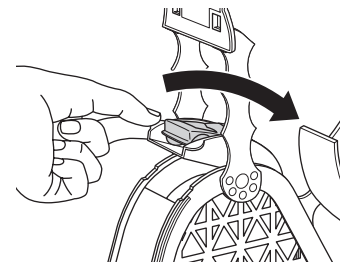

CAR CHOMPING SHARK: (With Sound)

