

INSTRUCTIONS

CONTENTS

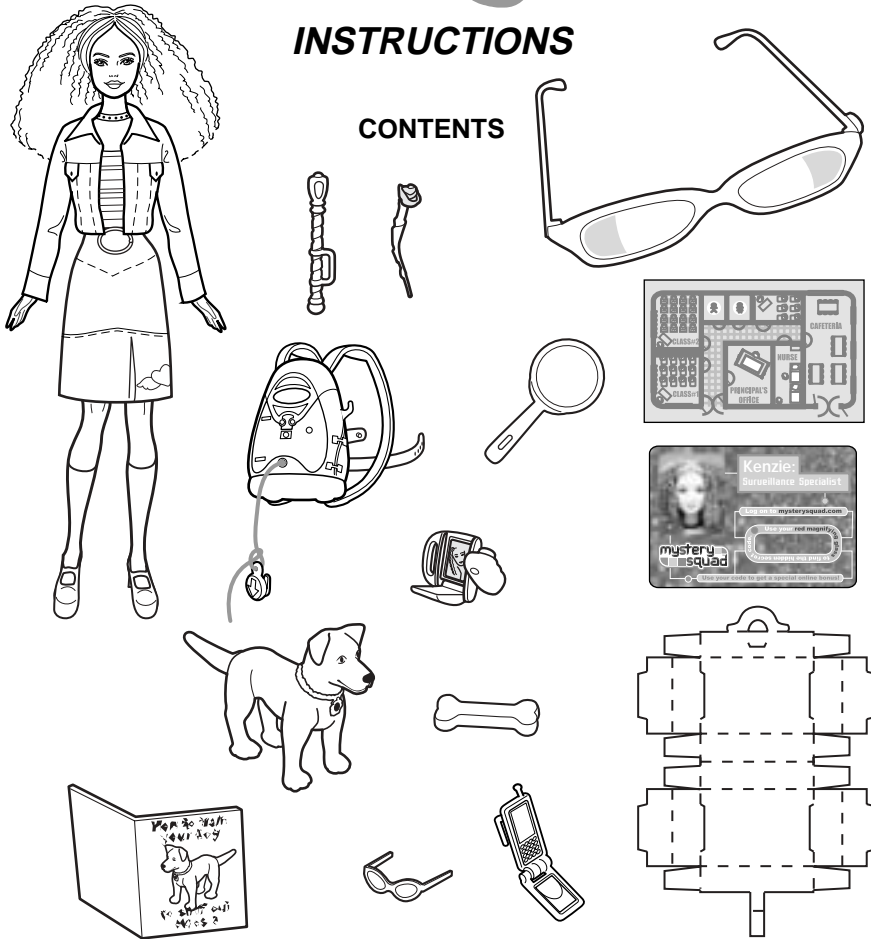

2 Non-replaceable batteries included. Colors and decorations may vary from those shown.

Please remove everything from the package and compare to the contents shown here. If any items are missing, please call 1-800-524-TOYS.



54224-0920-G1

Keep these instructions for future reference as they contain important information.

©2001 Mattel, Inc. El Segundo, CA 90245 U.S.A. All Rights Reserved.

BATTERY SAFETY INFORMATION:

1. Non-rechargeable batteries are not to be recharged.
2. Rechargeable batteries are to be removed from the toy before being charged (if designed to be removable).
3. Rechargeable batteries are only to be charged under adult supervision (if designed to be removable).
4. Do not mix alkaline, standard (carbon-zinc), or rechargeable (nickel-cadmium) batteries.
5. Do not mix old and new batteries.
6. Only batteries of the same or equivalent type as recommended are to be used.
7. Batteries are to be inserted with the correct polarity.
8. Exhausted batteries are to be removed from the toy.
9. The supply terminals are not to be short-circuited.
10. Dispose of battery(ies) safely.
11. Do not dispose of in a fire as batteries may explode or leak.
12. Products with non-replaceable batteries are not to be disposed of in a fire as the batteries inside may explode or leak.

TWO YEAR LIMITED WARRANTY

Mattel, Inc. warrants to the original consumer purchaser that this product will be free of defects in material or workmanship for two years (unless specified in alternate warranties) from the date of purchase. If defective, return the product along with proof of the date of purchase, postage prepaid, to Consumer Relations, 636 Girard Avenue, East Aurora, New York 14052 for replacement or refund at our option. This warranty does not cover damage resulting from unauthorized modification, accident, misuse or abuse. In no event shall we be responsible for incidental, consequential, or contingent damages (except in those states that do not allow this exclusion or limitation). **VALID ONLY IN U.S.A.** This warranty gives you specific legal rights and you may also have other rights which vary from state to state. Some states do not allow the exclusion of incidental or consequential damages, so the above exclusions or limitations may not apply to you.

Send only the product to the address above. Send all correspondence to Consumer Relations, Mattel, Inc., 333 Continental Blvd., El Segundo, California 90245-5012 U.S.A. Or you may phone us toll-free at 1-800-524-TOYS, Monday – Friday, 8:00 a.m. – 6:00 p.m. EST. Outside U.S.A., see telephone directory for Mattel listing.

CONSUMER INFORMATION

MATTY MATTEL™ TOYS



YOU CAN TELL IT'S MATTEL!™ CALL us toll-free or write with any comments or questions about our products or service. Monday-Friday 8:00 a.m.-6:00 p.m. Eastern Time. Outside U.S.A., see telephone directory for Mattel listing.

Consumer Relations, Mattel, Inc.
333 Continental Blvd.
El Segundo, CA 90245 USA

1(800) 524-TOYS

WE ARE DEDICATED TO QUALITY PRODUCTS.

There's a mystery to be solved.
The Mystery Squad™ leaps into action!
 The crew meets back at the secret Mystery Squad Headquarters™. The prom queen's stuff is missing!
 It's another case for the Mystery Squad™....

Mystery Squad Headquarters™ sold separately, subject to availability.

Kenzie™ Surveillance Specialist

She drops in with her grappling hook after mystery dog gives the "all clear" signal.

Prom Pieces



Each doll comes with accessories from the prom caper mystery!

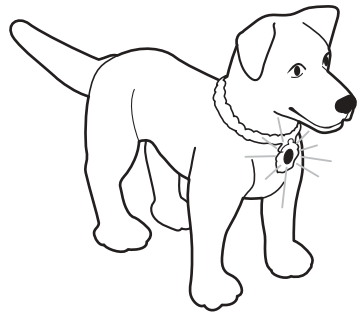

Dog collar hides a secret flash "camera"! Push the button on the dog's underside to activate the "camera's" light.

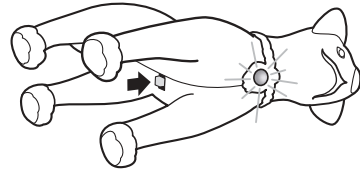

"Digital camera" "records" important clues!

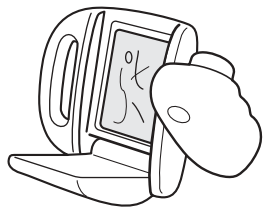

Your doll can hold the "digital camera" in her left hand.

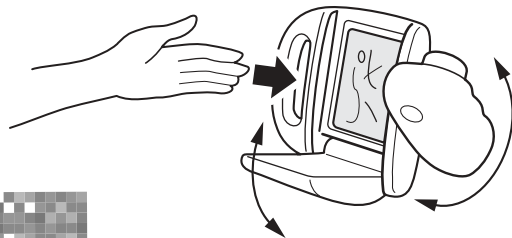

Spring-loaded grappling hook lets Kenzie™ drop in anywhere! The waist belt makes the backpack more secure.

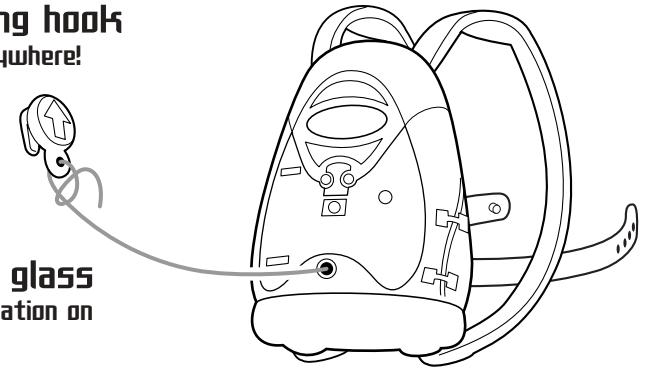

Use the magnifying glass to reveal secret information on your doll's I.D. card.



Special Detective Glasses for you to wear, with mirrors to see behind you.

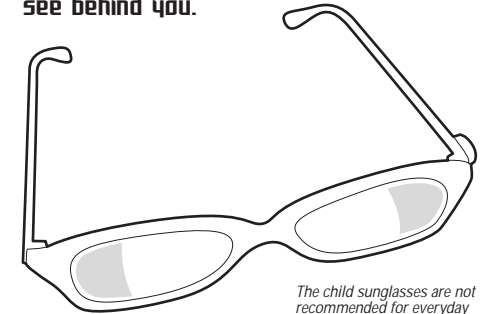

The child sunglasses are not recommended for everyday normal wear.

Here's how to fold up the box.

