

## CLEANING

- Mix & Dip Maker and accessories are not dishwasher safe.
- Do not immerse Mix & Dip maker in water. Clean with a moist soft cloth or paper towel.

## INGREDIENTS

**CHOCOLATE FLAVORED MIX:** SUGAR, COCOA POWDER PROCESSED WITH ALKALI, NONFAT DRY MILK, MODIFIED FOOD STARCH, GUAR GUM.

**RASPBERRY FLAVORED MIX:** SUGAR, NONFAT DRY MILK, MODIFIED FOOD STARCH, GUAR GUM, CITRIC ACID, MALTODEXTRIN, ARTIFICIAL FLAVOR, RED #40, BLUE #1.

**WHITE CHOCOLATE FLAVORED MIX:** SUGAR, NONFAT DRY MILK, MODIFIED FOOD STARCH, GUAR GUM, NATURAL AND ARTIFICIAL FLAVOR, GUM ARABIC, MALTODEXTRIN, TITANIUM DIOXIDE FOR COLOR, COCOA POWDER PROCESSED WITH ALKALI.

**GUMMI CANDY:** CORN SYRUP, SUGAR, GELATIN, DEXTROSE, CITRIC ACID, CORN STARCH, ARTIFICIAL AND NATURAL FLAVORS, ARTIFICIAL COLORS: FD&C YELLOW #5, RED #40, BLUE #1, FRACTIONATED COCONUT OIL, CARNUBA WAX, BEESWAX COATING.

Use Mix & Dip Maker with your Mix & Magic™ Kitchen.  
Sold separately and subject to availability.

Mattel, Inc., El Segundo, CA 90245 U.S.A.  
Consumer Affairs 1 (800) 524-Toys.

Mattel Canada Inc., Mississauga, Ontario L5R 3W2.  
You may call us free at 1-800-665-6288.

Mattel U.K. Ltd., Vanwall Business Park, Maidenhead SL6 4UB.  
Helpline 01628500303.

Mattel Australia Pty., Ltd., Richmond, Victoria. 3121.  
Consumer Advisory Service - 1300 135 312.

Mattel East Asia Ltd, Room 1106, South Tower, World Finance Centre,  
Harbour City, Tsimshatsui, HK, China

Diimport & Diedarkan Oleh: Mattel SEA Ptd Ltd.(993532-P) Lot 13.5,  
13th Floor, Menara Lien Hoe, Persiaran Tropicana Golf Country Resort,  
47410 PJ. Tel:03-78803817, Fax:03-78803867.

### CONSUMER INFORMATION

YOU CAN TELL IT'S MATTEL!™ CALL us toll-free or write with any comments or questions about our products or service. Monday-Friday 8:00 a.m.-6:00 p.m. Eastern Time. Outside U.S.A., see telephone directory for Mattel listing.

Consumer Relations, Mattel, Inc.  
333 Continental Blvd.  
El Segundo, CA 90245 USA

1 (800) 524-TOYS

WE ARE DEDICATED TO QUALITY PRODUCTS.



## Instructions

### CONTENTS



Please remove everything from the package and compare to the contents shown here. If any items are missing, please call 1-800-524-TOYS.  
Keep these instructions for future reference as they contain important information.

For use with included food only. Colors and decorations may vary from those shown. This product may stain fabrics and other surfaces. Avoid contact with carpet, clothing, walls and furniture. Not dishwasher safe.



# ..Just add water!

Before use, thoroughly wipe clean all parts that may contact food.  
Food products sometimes get messy.  
Protect play surfaces.  
Discard all loose leftover food after play. **Do not re-use food.**

## ASSEMBLE

Attach Mix & Dip Maker to your manual mixing base or to your Mix & Magic™ Kitchen (not included).

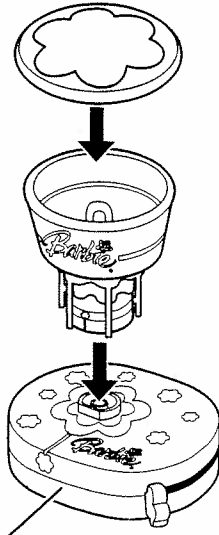

MANUAL MIXING BASE

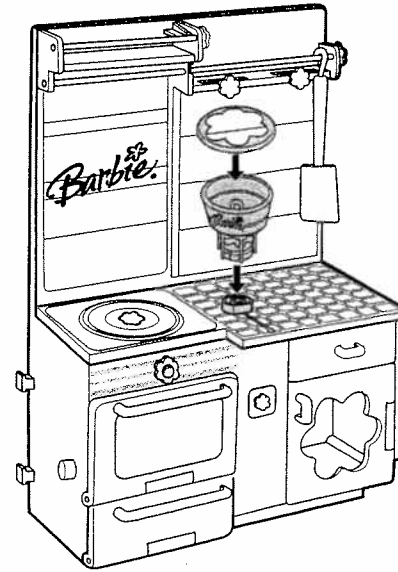

# 1.

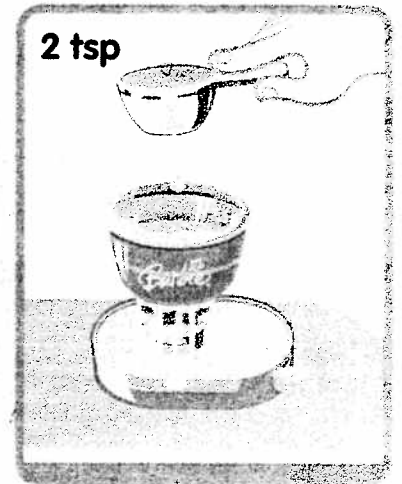

# 2.

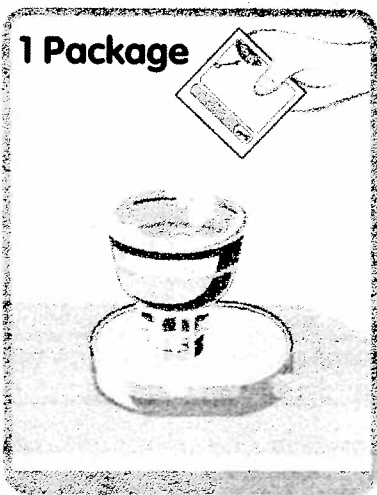

# 3.

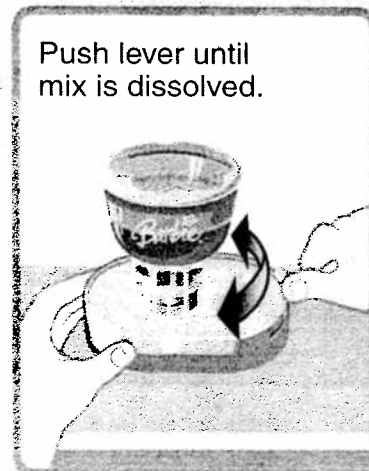

# 4.

