

**Fisher-Price®**

[www.fisher-price.com](http://www.fisher-price.com)



**GeoTrax**  
Rail & Road System

**Railside Farm Co.™**

Fisher-Price®

GeoTrax  
Rail & Road System

Your child is bound for  
a world of adventure!



## Assembly

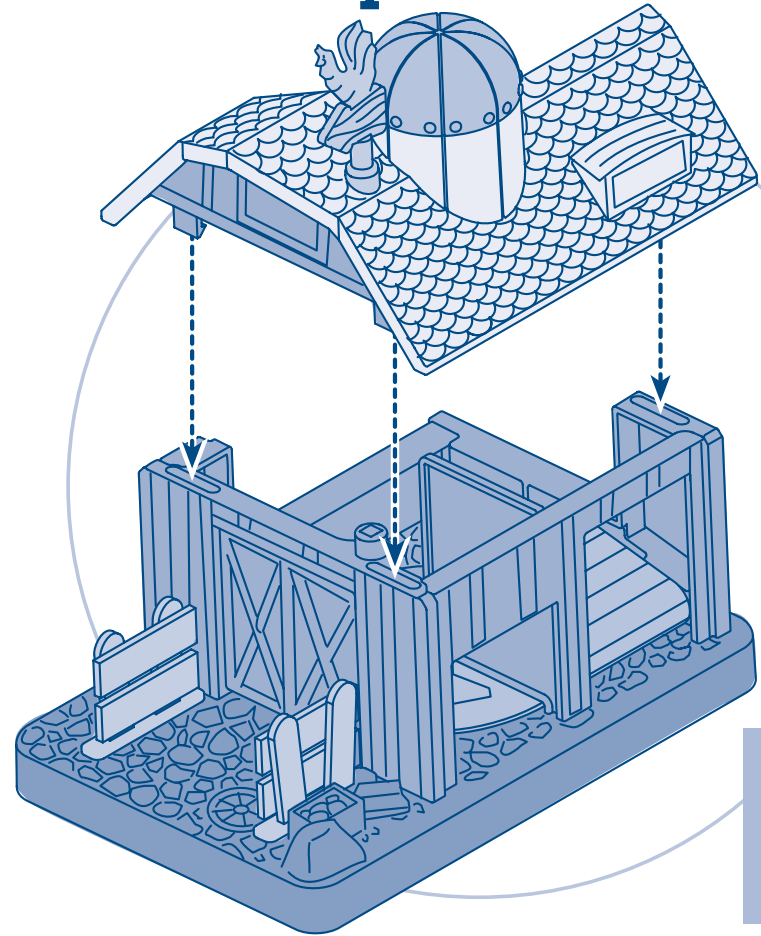

**PARTS NOT SHOWN:**  
Rail Car  
Hay Bale  
Sign  
Track Piece

The more  
you collect,  
the more  
fun it gets!



Each sold separately &  
subject to availability.





[www.fisher-price.com](http://www.fisher-price.com)

**Questions? We'd like to hear from you!**

Call Fisher-Price® Consumer Relations, toll-free at **1-800-432-5437**,  
8 AM - 6 PM EST Monday through Friday. Hearing-impaired  
consumers using TTY/TDD equipment, please call 1-800-382-7470.  
Or, write to: Fisher-Price® Consumer Relations, 636 Girard Avenue,  
East Aurora, New York 14052, U.S.A.

Please keep this instruction sheet for future reference,  
as it contains important information.

Adult Assembly is required.  
No tools needed for assembly.

Wipe the toy with a clean damp cloth.

**For other countries outside the United States:**

**Canada:** call 1-800-567-7724, or write to: Mattel Canada Inc., 6155 Freemont Blvd., Mississauga, Ontario L5R 3W2. **Great Britain:** telephone 01628 500302. **Australia:** Mattel Australia Pty. Ltd., 658 Church Street, Locked Bag #870, Richmond, Victoria 3121 Australia. Consumer Advisory Service 1300 135 312. **New Zealand:** 16-18 William Pickering Drive, Albany 1331, Auckland. **Asia:** Mattel East Asia Ltd, Room 1106, South Tower, World Finance Centre, Harbour City, Tsingshatsui, HK, China.