

## INSTRUCTIONS

Keep these instructions for future reference as they contain important information.

**ONE-TIME SNAPS:** Assembly steps that are marked with a star(★) are “one-time snaps”. Once these parts are put together, they cannot be taken apart.

### LABEL PLACEMENT

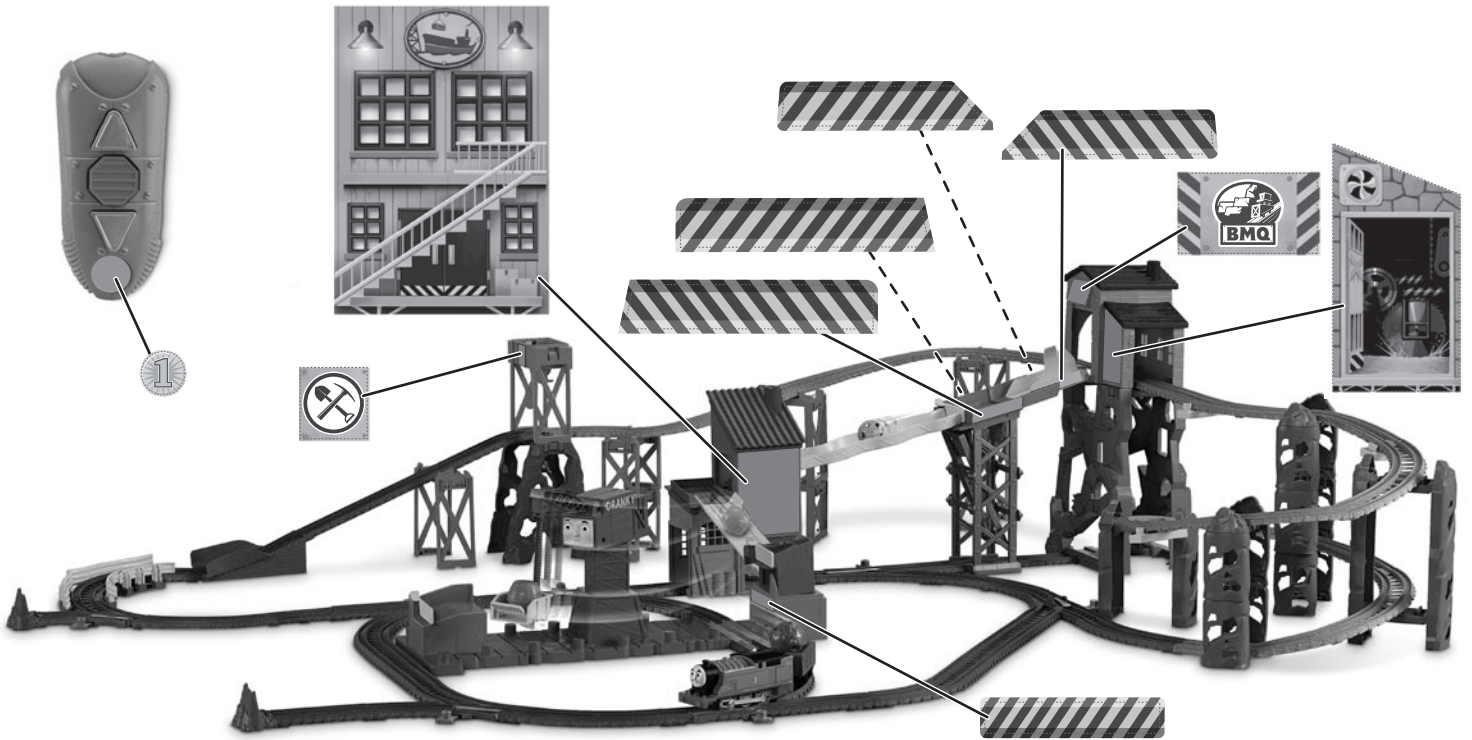

### ASSEMBLY

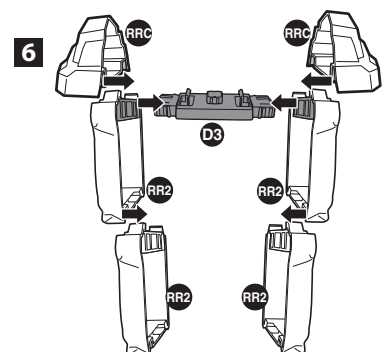
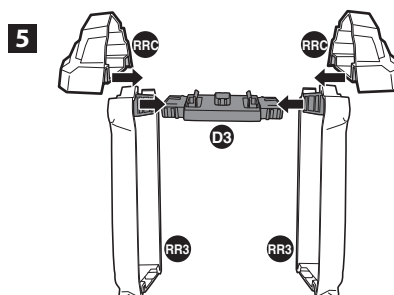
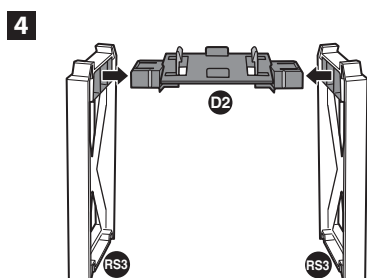
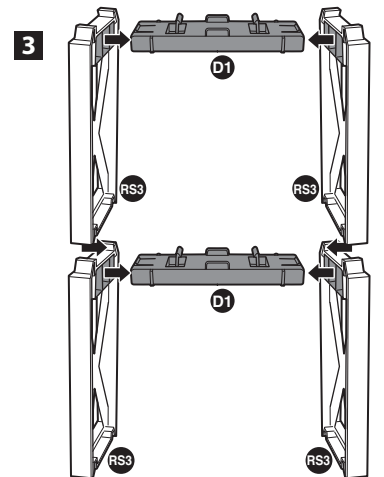
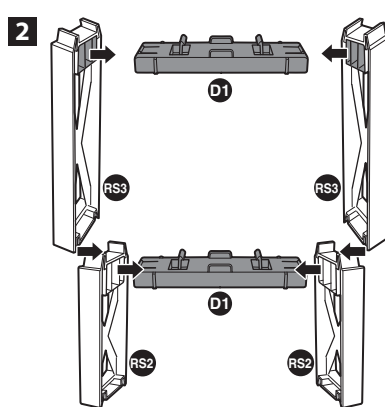
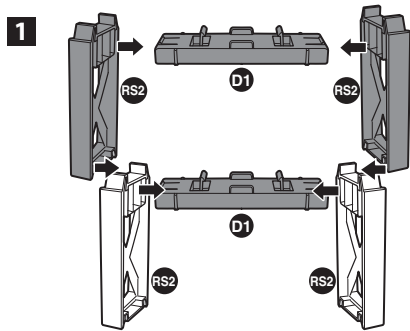

7

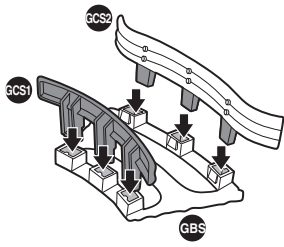

8

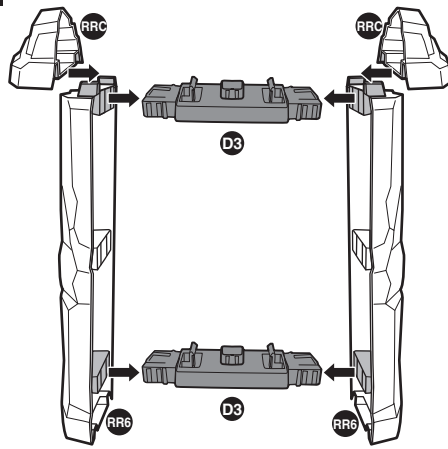

9

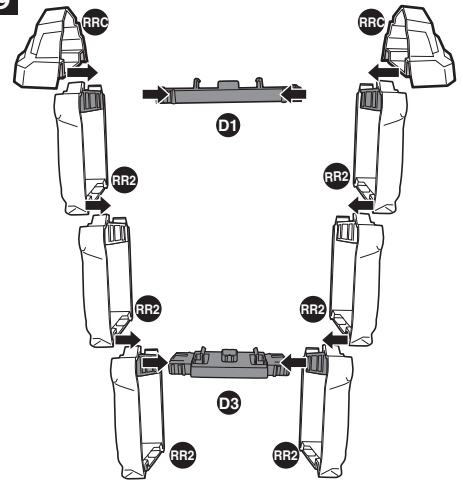

10

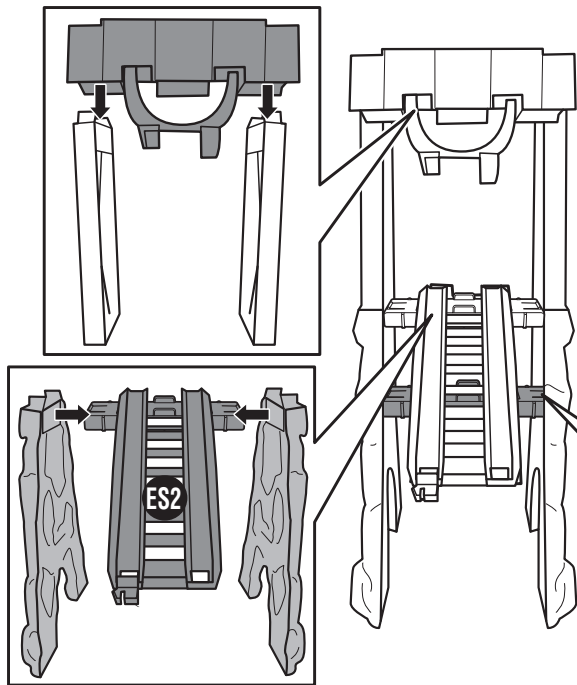

11 CARGO TRIGGER

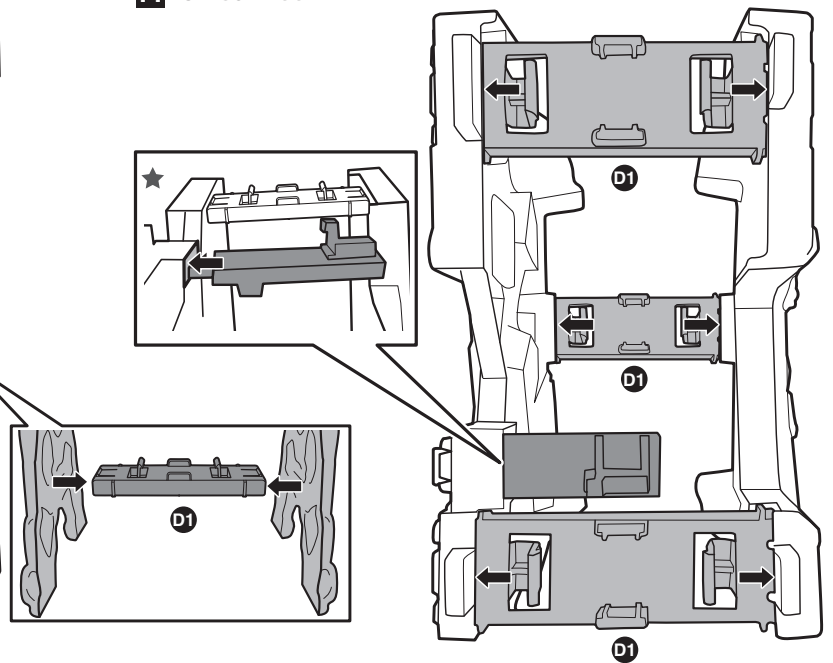

12

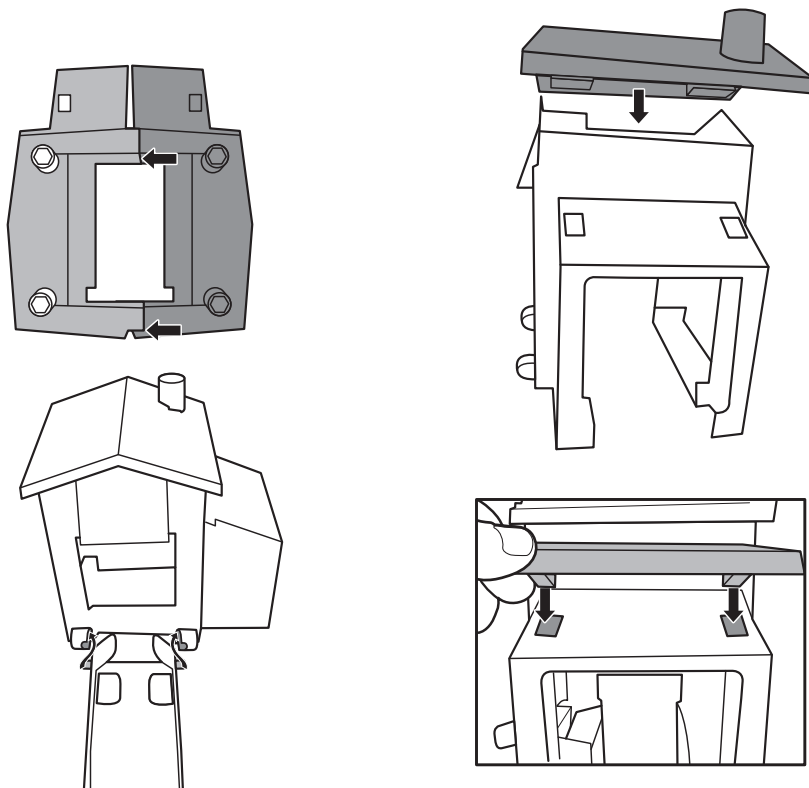

13

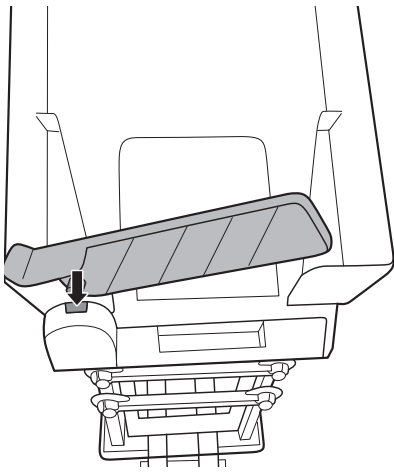

14

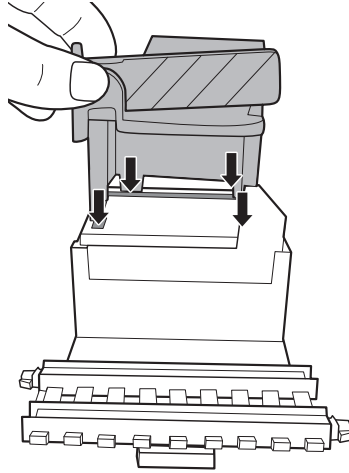

15

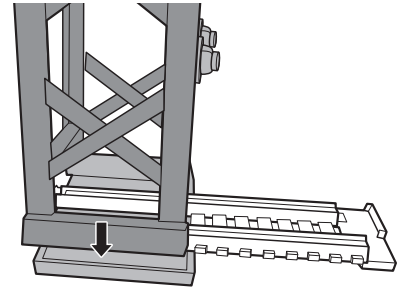

16

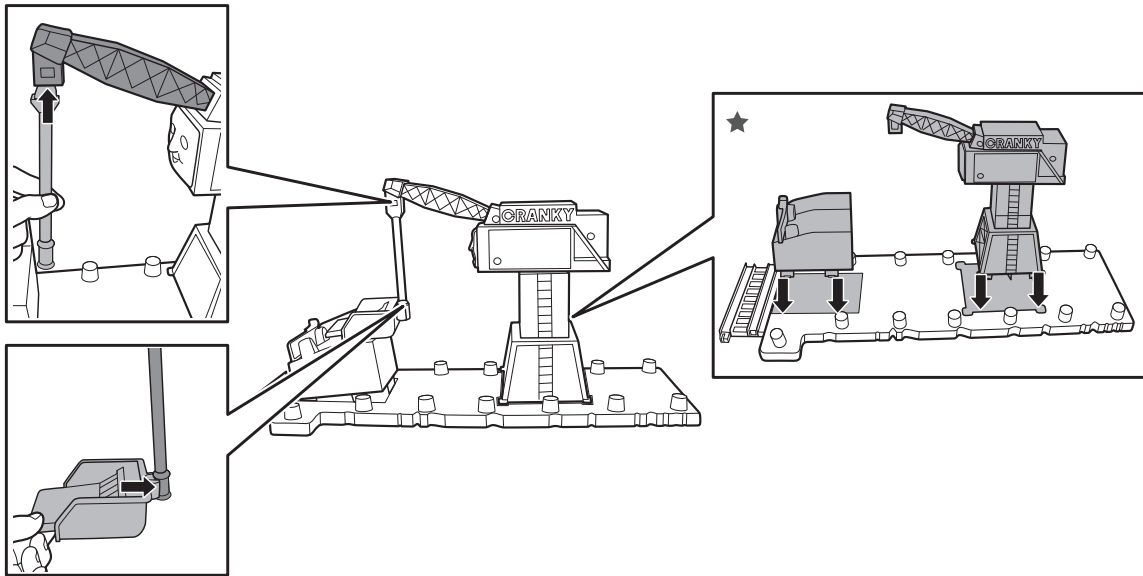

17

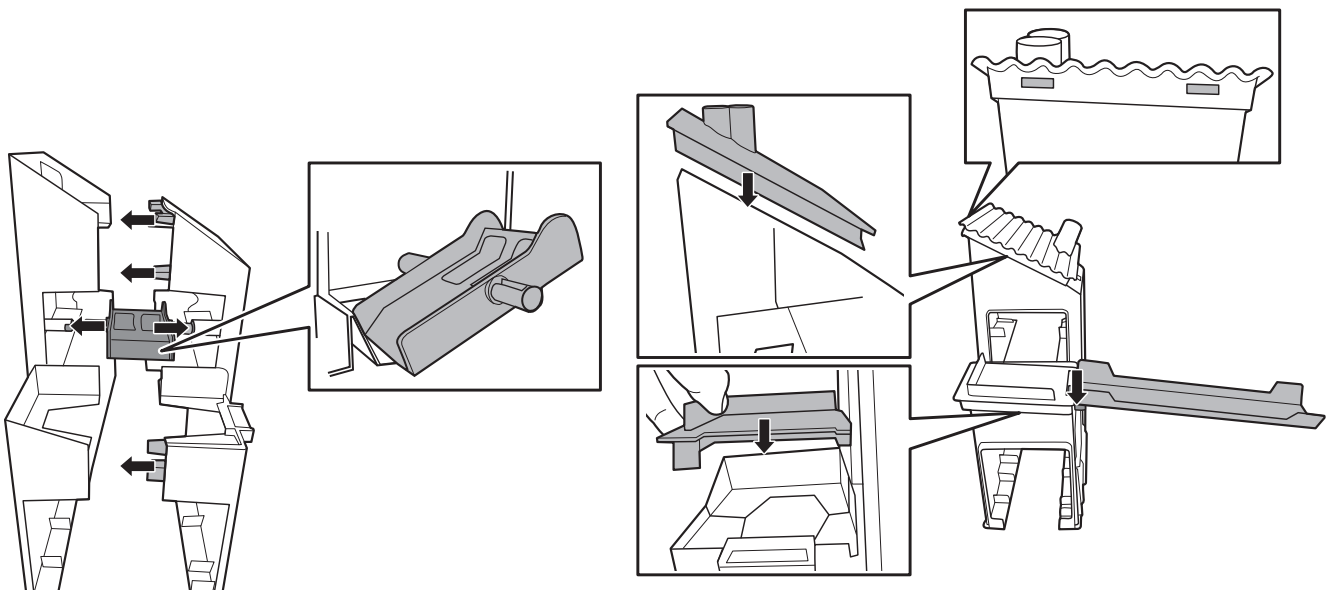

**ADULT ASSEMBLY REQUIRED.** No tools needed.

# TRACK LAYOUT

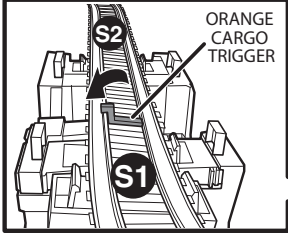

After assembling the S1 track piece to the top tower, be sure to snap the square hook of the orange CARGO TRIGGER over the top of the track piece by pushing it up with your index finger from below. This orange piece is what triggers the cargo car to dump the boulder.

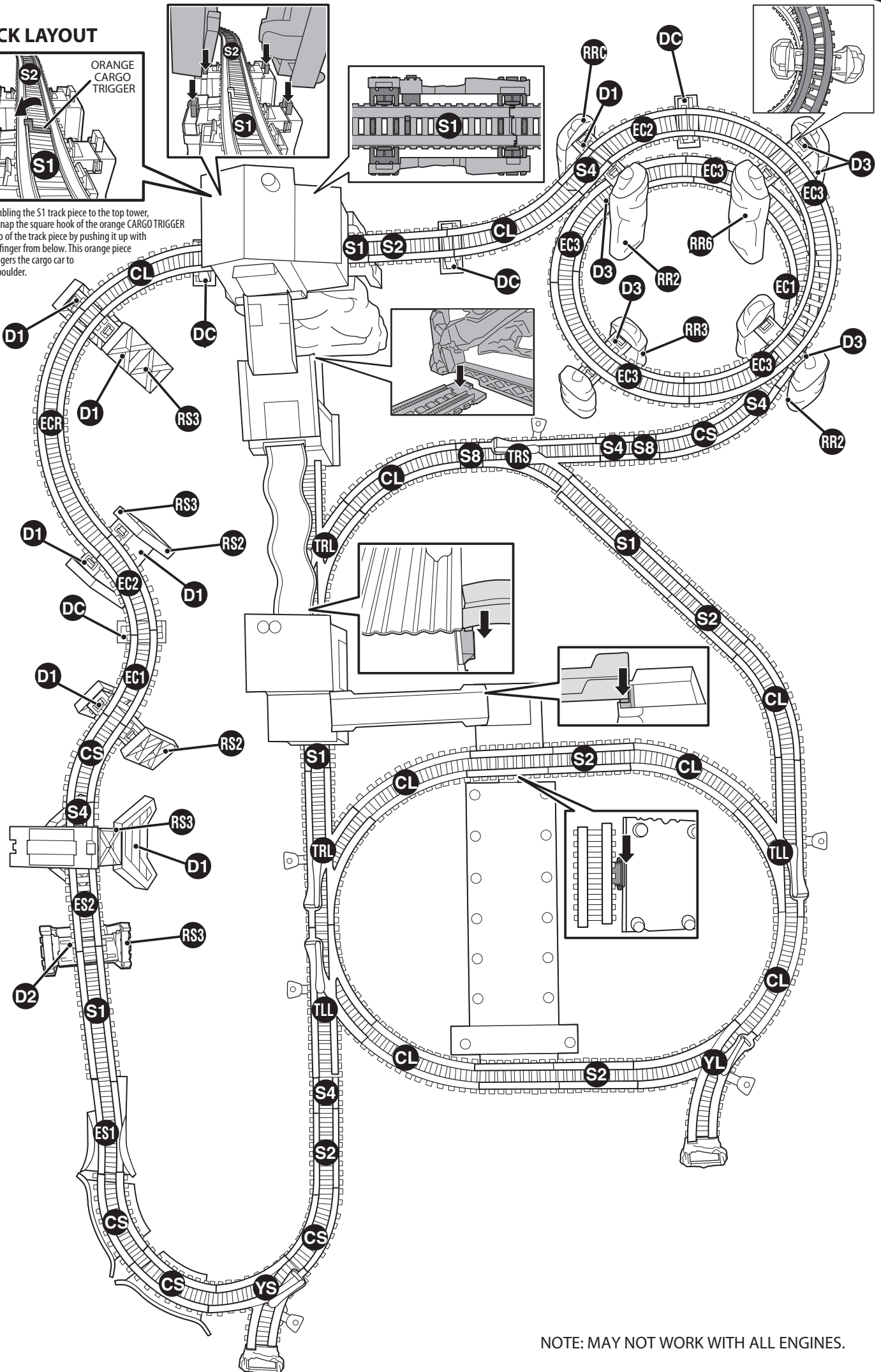

NOTE: MAY NOT WORK WITH ALL ENGINES.

## BEFORE YOU BEGIN

1. Set the boulder at the top of the hopper.

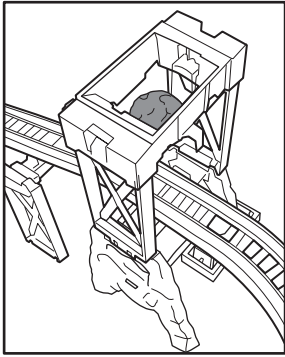

2. Place the barrel inside the Sodor Shipping Company.

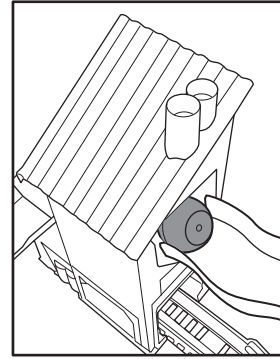

3. Wind cranky so he is in position to pick up the cargo at the Sodor Shipping Company.

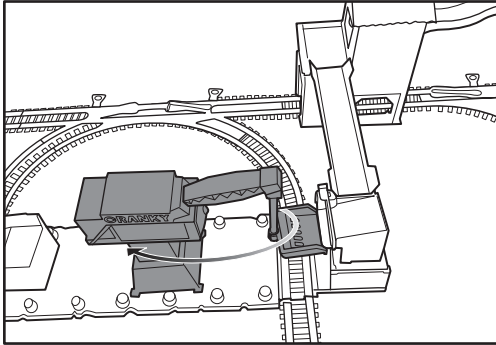

## HOW TO PLAY

1. As Thomas passes through the hopper, it will release the boulder into his cargo car.

2. As Thomas speeds into Blue Mountain Quarry, his cargo car automatically dumps the boulder down the chute. NOTE: If the cargo car DOES NOT automatically dump the boulder, check to make sure the orange CARGO TRIGGER is assembled properly to the track (see ASSEMBLY and TRACK LAYOUT).

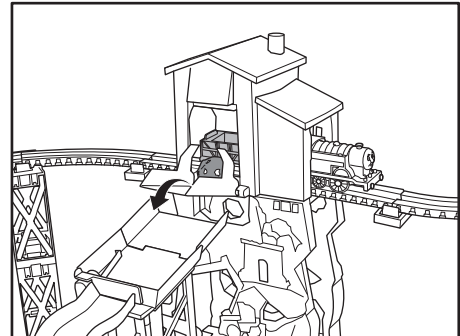
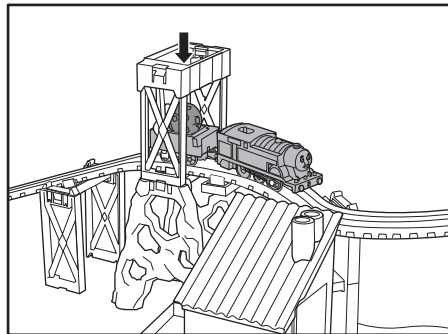
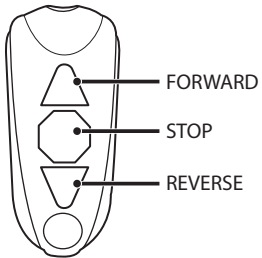

3. As the boulder rolls down the chute, it automatically transforms into a barrel inside the Sodor Shipping Company.

4. Raise the gate so the barrel rolls onto Cranky's scoop, triggering Cranky to deliver the cargo to Brendam Docks.

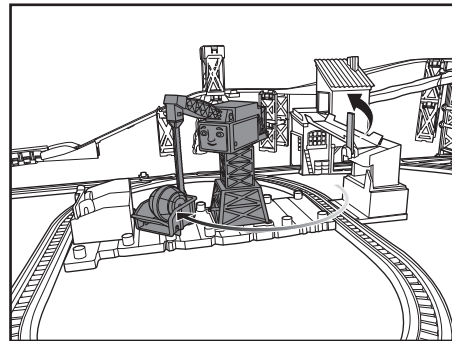
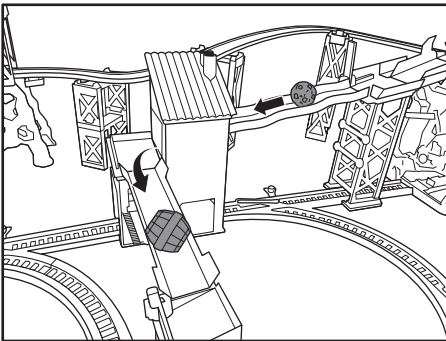

5. Raise the gate to load the cargo onto Thomas' cargo car.

6. The next time Thomas passes through Blue Mountain Quarry, lower the gate so the boulder stops at the top of the riser. Thomas can then back into the riser, allowing the boulder to drop into his cargo car.

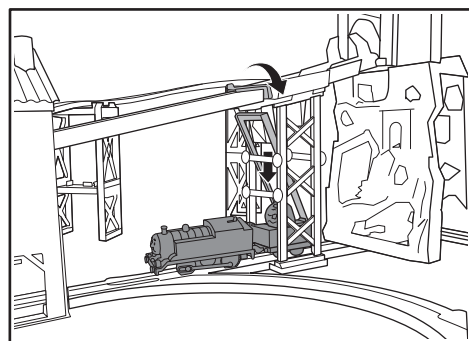
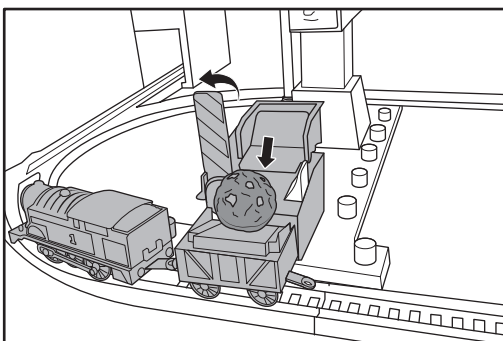

## BATTERY INSTALLATION

Access the battery compartment by unscrewing and separating the top half of the engine from the bottom half of the engine. Install the batteries as indicated inside the battery compartment. Re-assemble the two halves of the engine, re-insert the screw, and tighten. If the engine begins to operate erratically, you may need to reset the electronics by removing the batteries from the engine and reinstalling them. Requires 3 "AAA" (LR03) batteries.

For longer life use only alkaline batteries.  
Unscrew and lift covers away from back of Remote Control.  
Install batteries as indicated inside the battery compartment.  
For longer life use only alkaline batteries.  
Requires 2 "AAA" (LR03) alkaline batteries for Remote Control.

**Required tool:**  
Phillips screwdriver (not included)

THOMAS

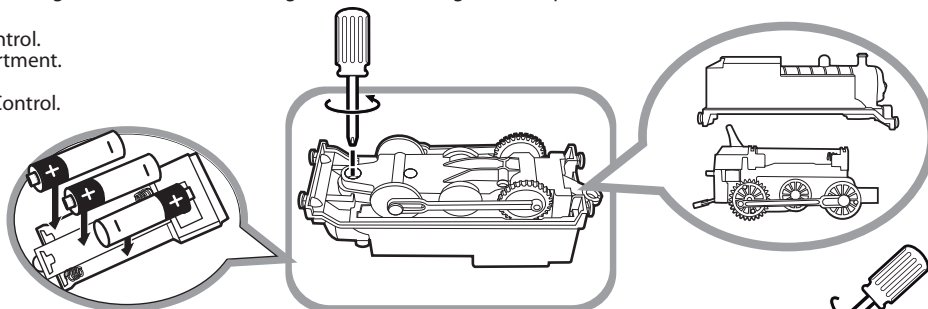
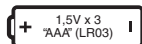

REMOTE CONTROL

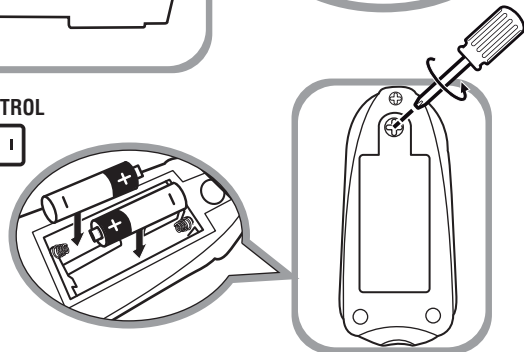
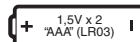

## BATTERY SAFETY INFORMATION

In exceptional circumstances batteries may leak fluids that can cause a chemical burn injury or ruin your product. To avoid battery leakage:

- Non-rechargeable batteries are not to be recharged.
- Rechargeable batteries are to be removed from the product before being charged.
- Rechargeable batteries are only to be charged under adult supervision.
- Do not mix alkaline, standard (carbon-zinc), or rechargeable (nickel-cadmium) batteries.
- Do not mix old and new batteries.
- Only batteries of the same or equivalent type as recommended are to be used.
- Batteries are to be inserted with the correct polarity.
- Exhausted batteries are to be removed from the product.
- The supply terminals are not to be short-circuited.
- Dispose of battery(ies) safely.
- Do not dispose of this product in a fire. The batteries inside may explode or leak.

This equipment has been tested and found to comply with the limits for a Class B digital device, pursuant to Part 15 of the FCC rules. These limits are designed to provide reasonable protection against harmful interference in a residential installation. This equipment generates uses and can radiate radio frequency energy and, if not installed and used in accordance with the instructions, may cause harmful interference to radio communications. However, there is no guarantee that interference will not occur in a particular installation. If this equipment does cause harmful interference to radio or television reception, which can be determined by turning the equipment off and on, the user is encouraged to try to correct the interference by one or more of the following measures:

- Reorient or relocate the receiving antenna.
- Increase the separation between the equipment and receiver.
- Consult the dealer or an experienced radio/TV technician for help.

NOTE: Changes or modifications not expressly approved by the manufacturer responsible for compliance could void the user's authority to operate the equipment. This device complies with Part 15 of the FCC Rules. Operation is subject to the following two conditions: (1) This device may not cause harmful interference, and (2) this device must accept any interference received, including interference that may cause undesired operation.

CAN ICES-3 (B)/NMB-3 (B)

Operation is subject to the following two conditions: (1) this device may not cause interference, and (2) this device must accept any interference, including interference that may cause undesired operation of the device.

L'utilisation de ce dispositif est autorisée seulement aux conditions suivantes : (1) il ne doit pas produire de brouillage et (2) l'utilisateur du dispositif doit être prêt à accepter tout brouillage radioélectrique reçu, même si ce brouillage est susceptible de compromettre le fonctionnement du dispositif.

SYMPTOM	SOLUTION
Engine drives slowly	The wheels on the engine or attached cars may be dirty. Wipe them with a clean cloth.
Engine does not respond to the remote controller	<ul style="list-style-type: none"> <li>• <b>Re-start the engine by switching it "OFF (o)" &amp; "ON (I)".</b> If you do not operate the remote controller for a few minutes, the engine shuts off automatically.</li> <li>• Battery power in the remote controller or in the engine may be weak. Replace <b>TWO</b> batteries in controller and <b>THREE</b> batteries in engine with fresh, alkaline batteries.</li> <li>• You may be beyond the maximum range of the remote controller (about 12 feet).</li> <li>• You may not have a clear path between the engine and the remote controller. This toy works best when there are no obstructions between the engine and the remote. Operate the toy by holding the controller 2-feet minimum horizontally above the train.</li> <li>• Try dimming the lights in the room. Bright sunlight or fluorescent lights may effect the range of the remote controller.</li> </ul> <p><b>NOTE: (i) Remote control engines only operate with the TrackMaster™ remote. They do not move on their own. (ii) Interference may occur and performance start to degrade if more than two characters are used at the same time in the same vicinity.</b></p>

**CONSUMER ASSISTANCE**  
1-800-432-5437 (US & Canada)  
1300 135 312 (Australia)

**service.fisher-price.com**

Fisher-Price, Inc., 636 Girard Avenue, East Aurora, NY 14052.  
Hearing-impaired consumers: 1-800-382-7470.

**Outside the United States:**

Canada: Mattel Canada Inc., 6155 Freemont Blvd., Mississauga, Ontario L5R 3W2; www.service.mattel.com.

Great Britain: Mattel UK Ltd, Vanwall Business Park, Maidenhead SL6 4UB. Helpline: 01628 500303. www.service.mattel.com/uk

Mattel Europa B.V., Gondel 1, 1186 MJ Amstelveen, Nederland.

Australia: Mattel Australia Pty. Ltd., 658 Church Street, Locked Bag #870, Richmond, Victoria 3121 Australia.

New Zealand: 16-18 William Pickering Drive, Albany 1331, Auckland.

Thomas the Tank Engine & Friends™



CREATED BY BRITT ALLCROFT

Based on the Railway Series by The Reverend W Awdry.

©2014 Gullane (Thomas) Limited. Thomas the Tank Engine & Friends and Thomas & Friends are trademarks of Gullane (Thomas) Limited.

©2014 HIT Entertainment Limited. HIT and the HIT logo are trademarks of HIT Entertainment Limited.

©2014 Mattel. All Rights Reserved. ® and ™ designate U.S. trademarks of Mattel, except as noted.

**PRINTED IN CHINA.** Mattel East Asia Ltd., Room 503-09, North Tower, World Finance Centre, Harbour City, Tsimshatsui, HK, China.

**Redesigned Track!**  
• Stronger Connectors  
• More Realistic  
Includes adaptors to connect TrackMaster™ sets.

THOMAS & FRIENDS TRACKMASTER  
Motorized Engines may not work with all TrackMaster™ sets.

**WARNING:**  
CHOKING HAZARD - Toy contains small balls. Not for children under 3 years.

**CAUTION:**  
To prevent entanglement, keep hair away from wheels.



Protect the environment by not disposing of this product with household waste (2002/96/EC). Check your local authority for recycling advice and facilities.



BDP15

Fisher-Price®