

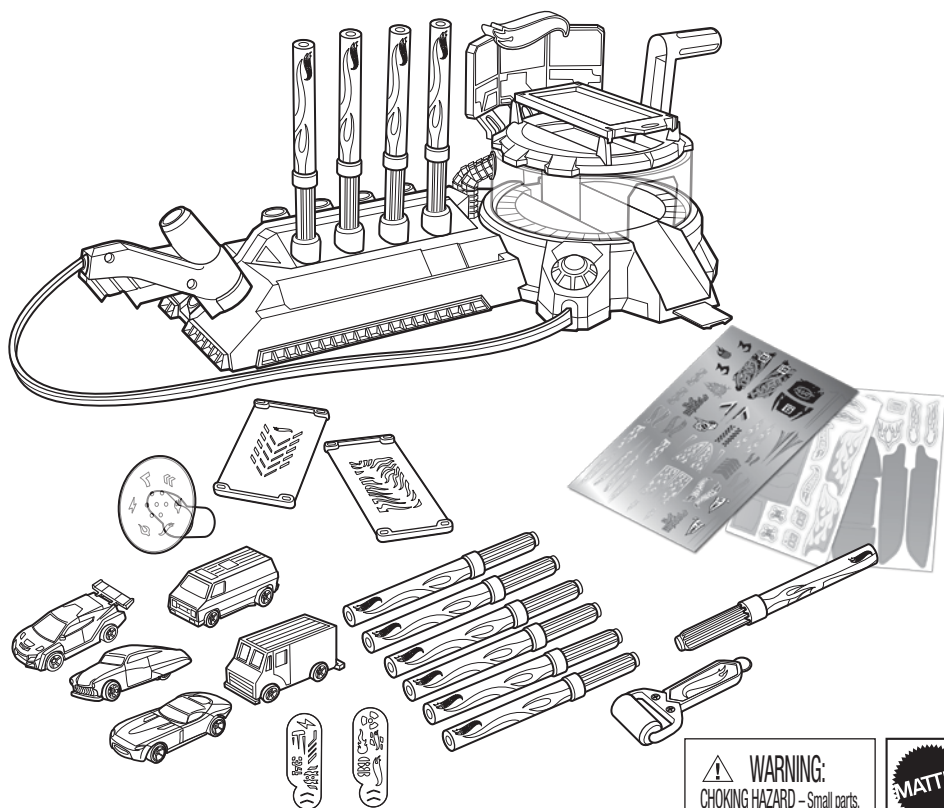

## WORKSHOP AIRBRUSH AUTO DESIGN COMBO PACK



**WARNING:**  
CHOKING HAZARD – Small parts.  
Not for children under 3 years.



BHT79-0920

PLEASE KEEP THESE INSTRUCTIONS FOR FUTURE  
REFERENCE AS THEY CONTAIN IMPORTANT INFORMATION.

PROTECT PLAY SURFACES BEFORE USE.  
PENS CONFORM TO ASTM D4236.

**5+**

service.mattel.com

**HOTWHEELS.COM**

# CONTENTS

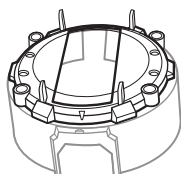
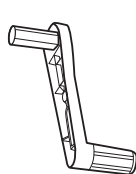
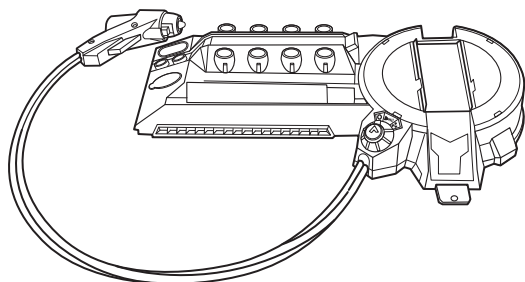

Ink Pens



Color Revealing Pen

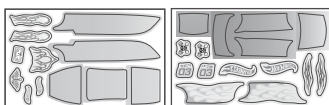
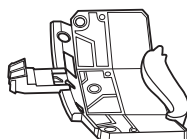
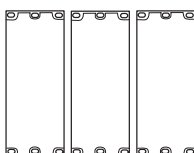

COLOR REVEAL DECAL SHEET x 2

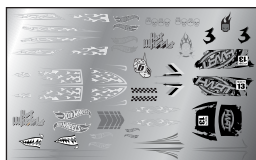

FOIL DECAL SHEET x 1

## BATTERY INSTALLATION

- Unscrew the battery cover with a Phillips head screwdriver (not included).
- Install 4 new "C" size (LR14) alkaline batteries (not included) in the orientation (+/-) shown.
- Replace battery cover and tighten screws.
- For longer life use alkaline batteries.
- Replace batteries when the airbrush can no longer spray ink.
- When exposed to an electrostatic source, the product may malfunction. To resume normal operation, remove and re-install the batteries.

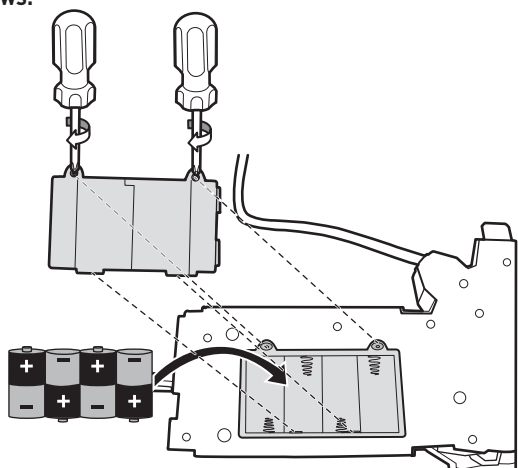

# ASSEMBLY

1.

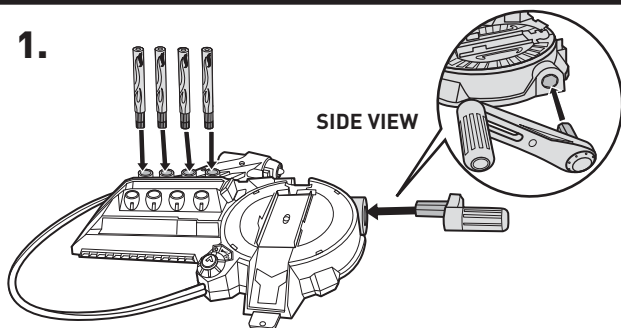

2.

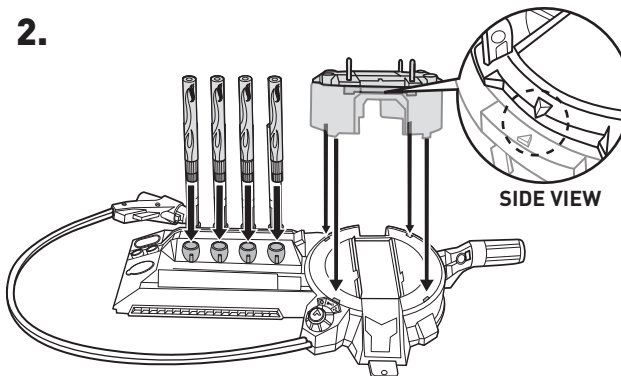

3.

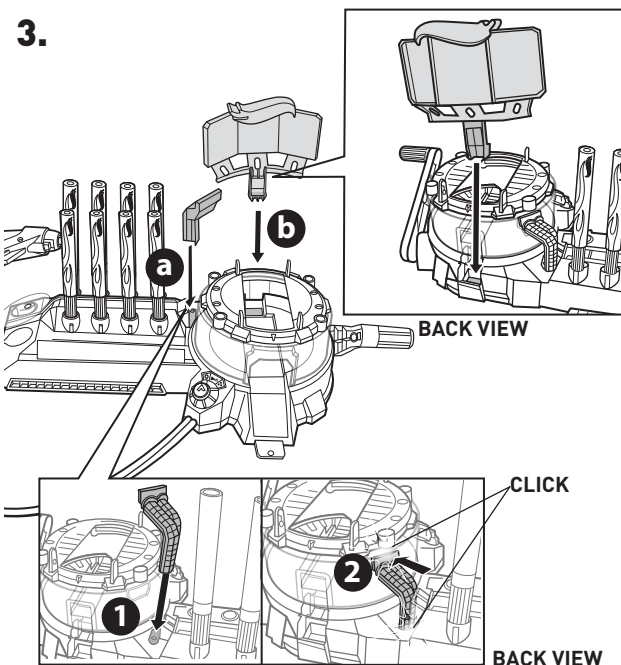

4.

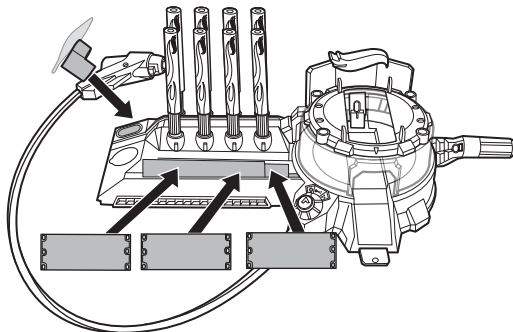

5.

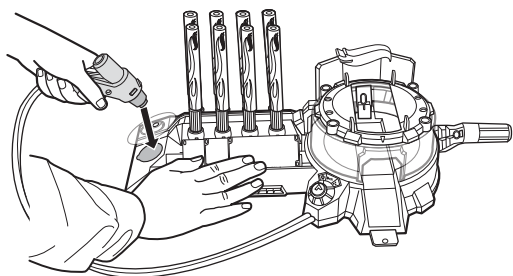

6.

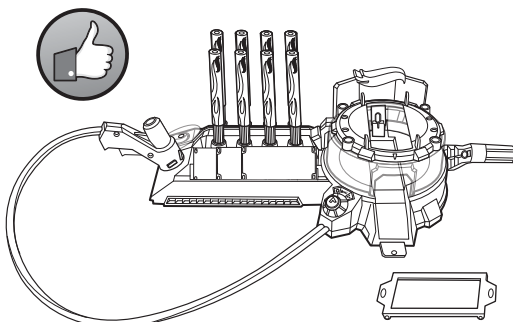

# SET UP

- 1.** Remove cap and insert ink pen into airbrush until it clicks in.

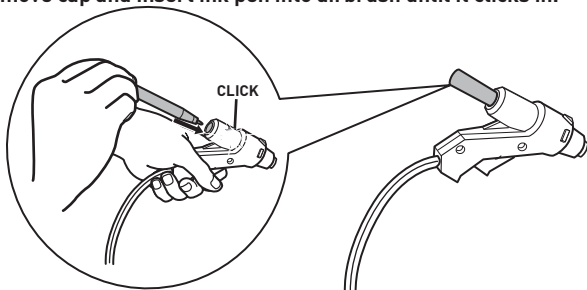

- 2.** **a** Rotate switch to select airbrush (▶).  
**b** Place a piece of paper (not included) under airbrush. Pull trigger and spray ink between half an inch and 1.5 inches from paper.

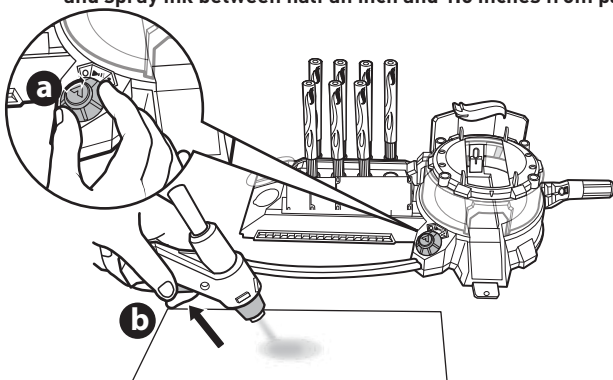

- 3.** Adjust nozzle until sprayed ink is fine and even.

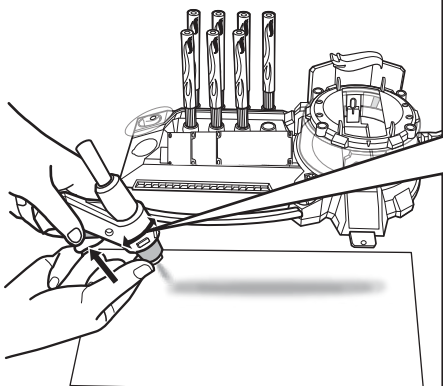

If little or no ink comes out, turn dial slightly toward +.

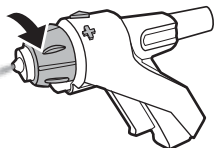

If ink foams at the tip, turn dial slightly toward -.

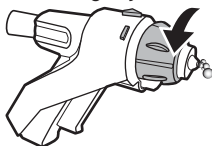

**NOTE:** You must re-adjust the nozzle every time a new ink pen is loaded.

**TO PREVENT INK FROM DRYING, RECAP PENS AFTER USE AND REPLACE IN HOLDER. PENS MAY STAIN FABRICS AND OTHER SURFACES. AVOID CONTACT WITH CARPET, CLOTHING, WALLS AND FURNITURE.**



# AIRBRUSH – FREE HAND

- 1.** **a** Load vehicle inside chamber and center on the platform.  
**b** Lift handle to raise vehicle.

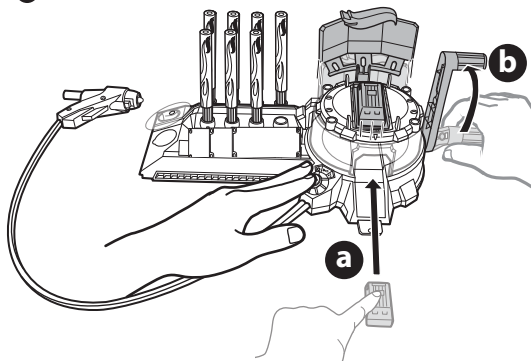

- 4.** When finished spraying, rotate the platform so the vehicle faces you.

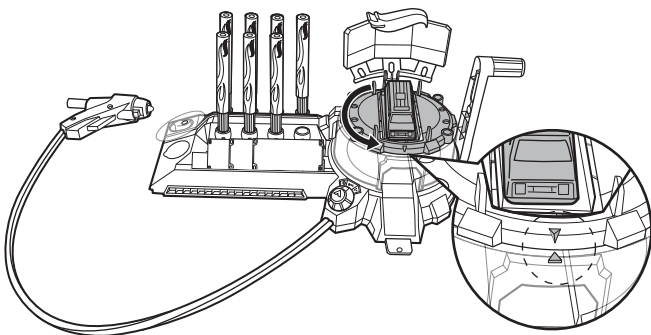

- 2.** Hold airbrush between half an inch and 1.5 inches away, then pull trigger to spray.

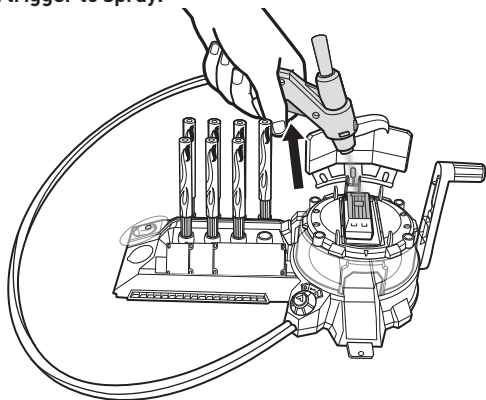

- 5.** **a** Press handle down halfway to lower the platform.  
**b** Rotate switch to fan (🌀) and dry for at least 30 seconds.

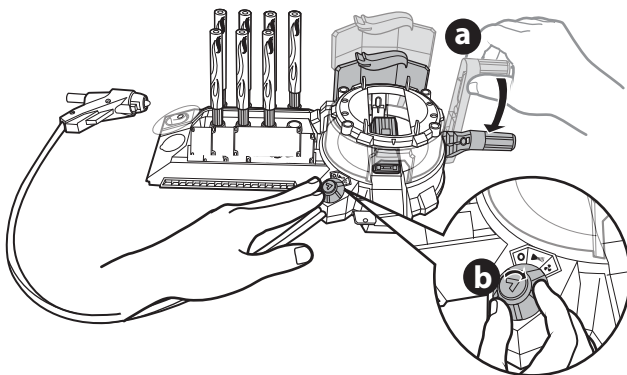

- 3.** Rotate platform to spray other sides.

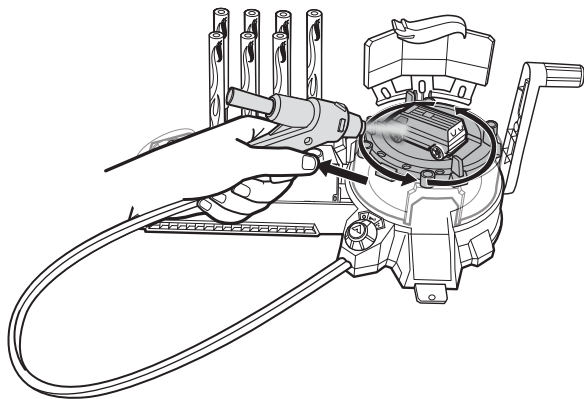

- 6.** **a** Rotate switch to OFF (O).  
**b** Press handle down all the way to release vehicle.

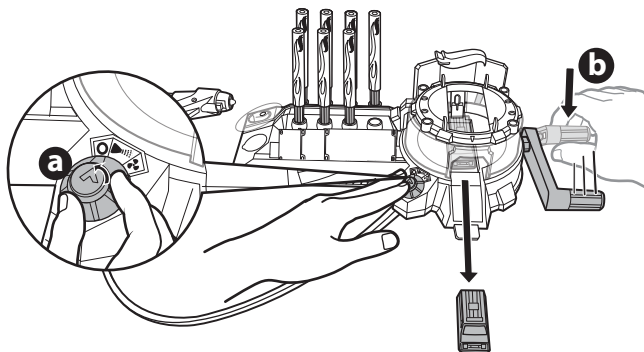

NOT FOR USE WITH SOME HOT WHEELS® VEHICLES.

# AIRBRUSH – SPRAY PATTERN

- 1.** Attach spray pattern to frame as shown.

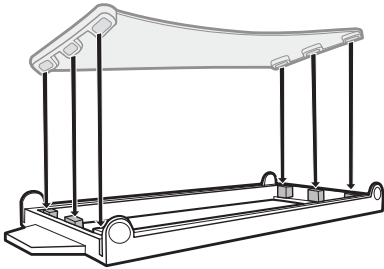

- 2.** Attach to platform with tabs facing down.

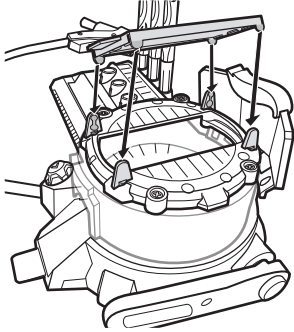

- 3.** Press frame down to bottom position for shorter vehicles.  
Lift frame up to top position for taller vehicles.

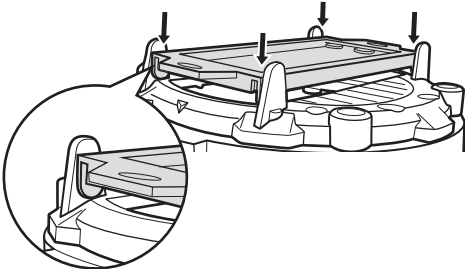

Lift frame up to top position for taller vehicles.

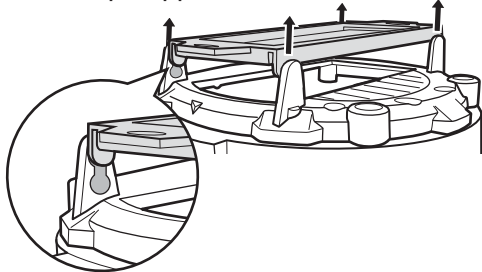

- 4.** **a** Load vehicle inside and center on the platform.  
**b** Lift handle to raise vehicle into the spray pattern.

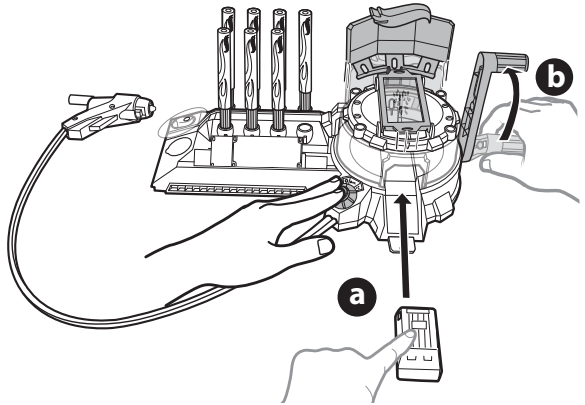

- 5.** Hold airbrush between half an inch and 1.5 inches away and pull trigger to spray pattern onto vehicle.

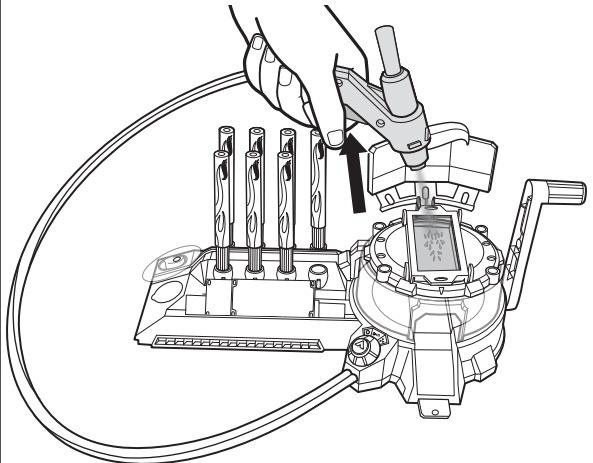

- 6.** Repeat steps 4-6 under AIRBRUSH – FREE HAND to dry vehicle.

# TO PLAY – STENCIL TOOLS

## A. AIRBRUSH

**1.** Attach stencil tool to airbrush.

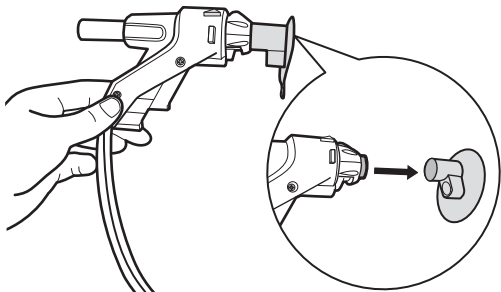

**2.** Select a graphic and align with the nozzle.

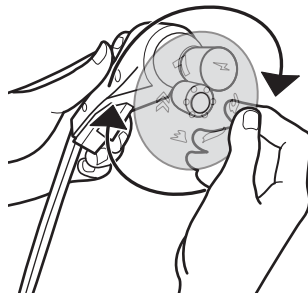

**3.** Press stencil tool flush against the vehicle. Pull and hold trigger for around 10 seconds to spray graphic onto vehicle.

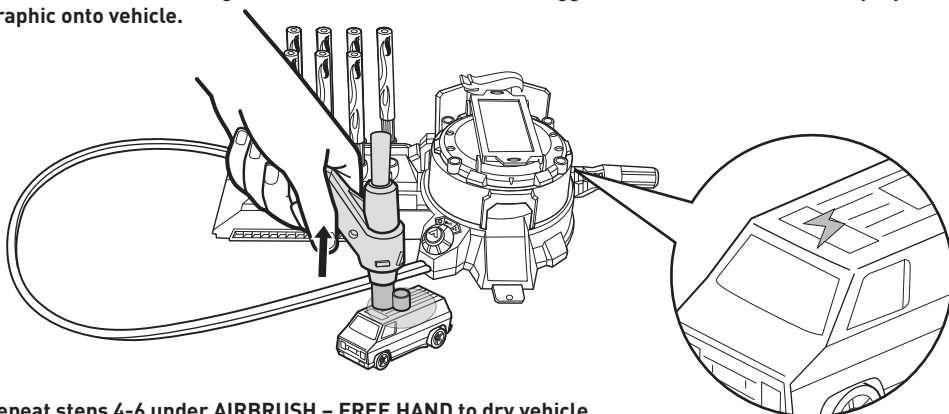

**4.** Repeat steps 4-6 under AIRBRUSH – FREE HAND to dry vehicle.

## B. INK PENS

Use stencil pieces to draw designs directly onto vehicles.

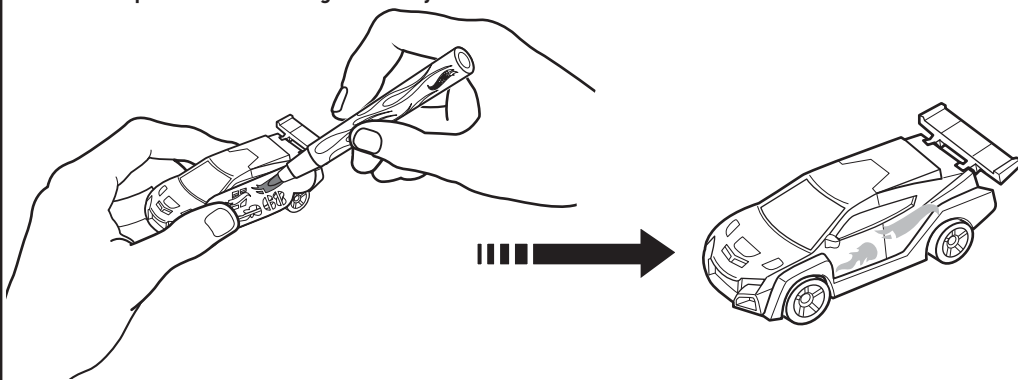

# TO PLAY – DECAL SHEETS

## A. COLOR REVEAL DECAL SHEETS

- 1.** Peel off and apply color reveal panels onto each vehicle.

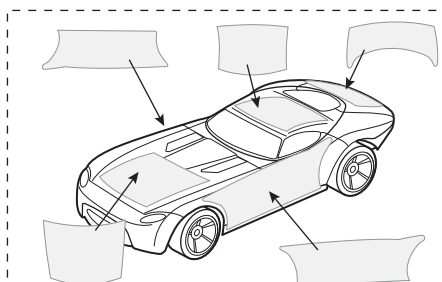
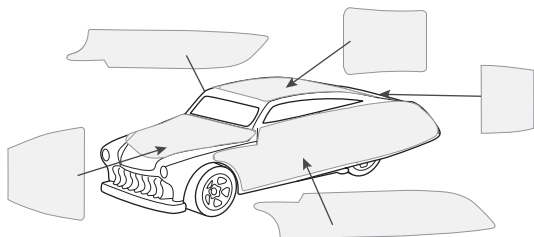

- 2.** Flatten the panels with the smoothing tool.

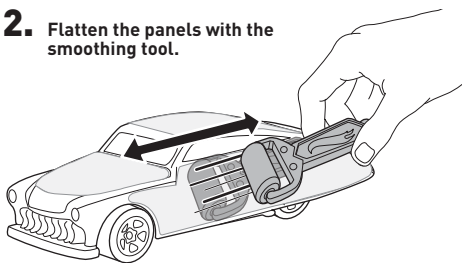

- 3.** Add color reveal decals onto the panels to create your design.

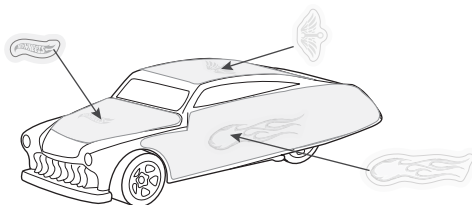

- 4.** Apply color revealing pen to decals to uncover awesome graphics.

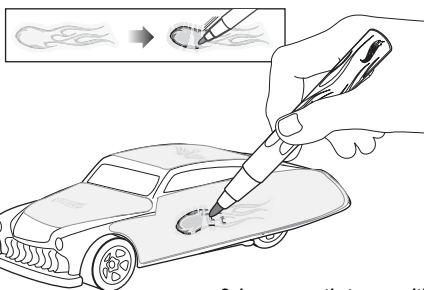

Only use pens that come with the toy.  
Recap pens after use.

- 5.** Reveal whatever portion you want of the decals or panels to customize your design!

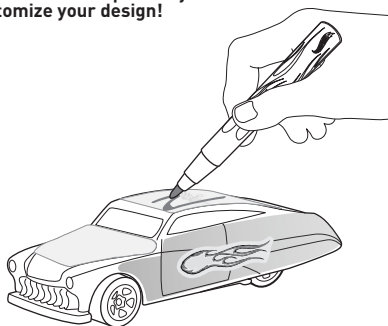

NOT FOR USE WITH SOME HOT WHEELS® VEHICLES

## B. FOIL DECAL SHEET

Decorate your vehicles with foil decals for a shiny look!

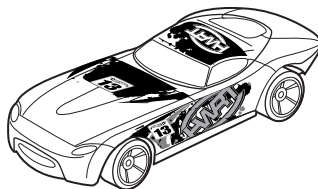
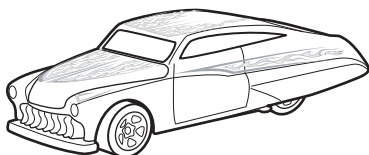

**NOTE:** Foil decals do not work with Color Revealing Pen.

# CLEAN UP – AIRBRUSH

- 1.** To create a new design, use a damp cloth (not included) to wipe off the ink until vehicle is clean.

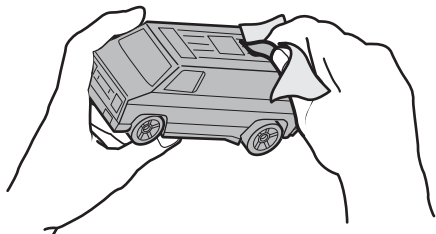

- 2.** Wipe the nozzle clean with a damp cloth.

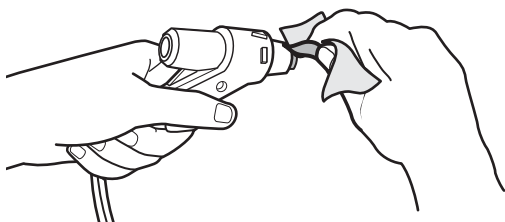

- 3.** To clean the inside of the stencil tool, use a damp cloth or cotton swab (not included).

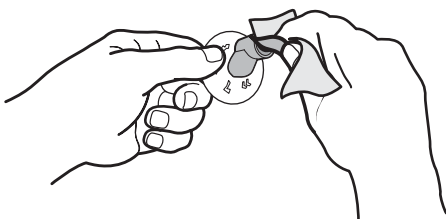

- 4.** Wipe platform, spray patterns and stencil tool clean with a damp cloth.

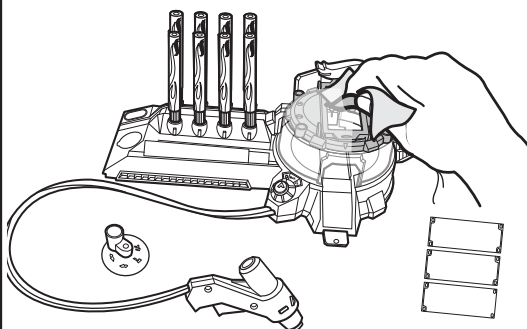

# CLEAN OFF COLOR REVEAL DECALS TO REDESIGN

- 1.** To remove your design, rinse vehicle under running water.

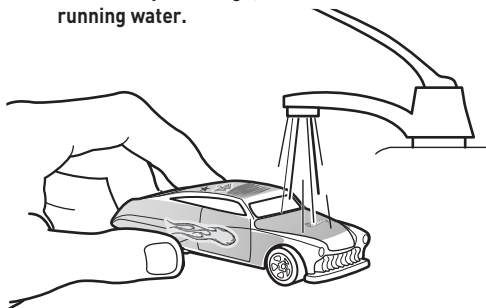

- 2.** Let dry until design disappears and start again!

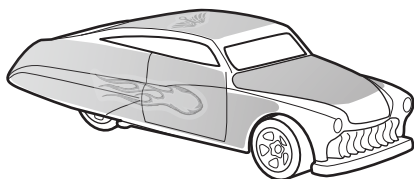

Drain, clean and dry all items thoroughly before storing.

# MORE WAYS TO PLAY

Connect to other Hot Wheels® sets (sold separately).

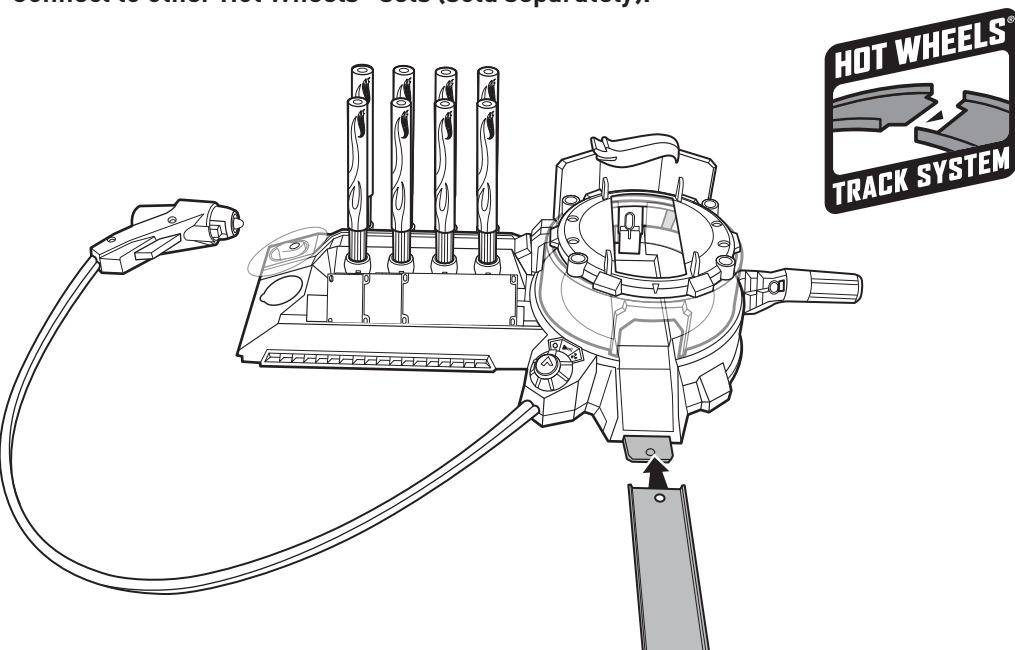

## PERFORMANCE TIPS

- A. Take time to adjust the nozzle until the sprayed ink is fine and even. If ink is blotchy, it will smear and spoil your design.**
- B. While spraying, point nozzle straight down so it is perpendicular to the vehicle. Apply a thin coat of ink with smooth, back and forth strokes.**
- C. For a deeper color, airbrush additional thin coats of ink onto the vehicle after drying.**
- D. Keep nozzle clean by wiping down occasionally during use or when there is ink build-up.**
- E. Always keep pens stored cap side down in holder.**