



Monster Dome Playset

INSTRUCTIONS

Keep these instructions for future reference as they contain important information.

PARTS / LABEL PLACEMENT

Parts

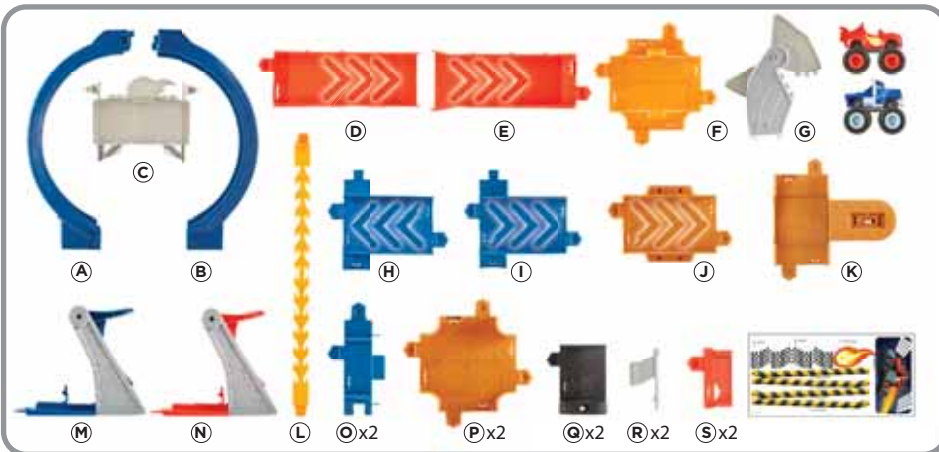

Label Placement

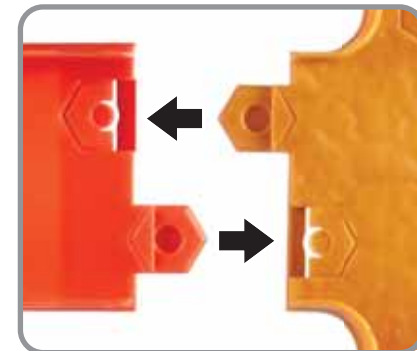
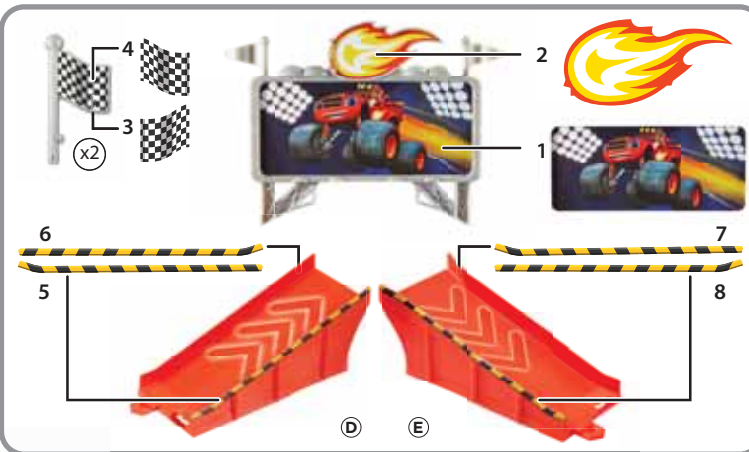

Push to connect.

TRACK LAYOUT #1



- NOTE: When assembling the track, be sure the launcher is placed directly in front of the 360° loop for optimal performance.
- Not for use with some Blaze vehicles.

ASSEMBLY

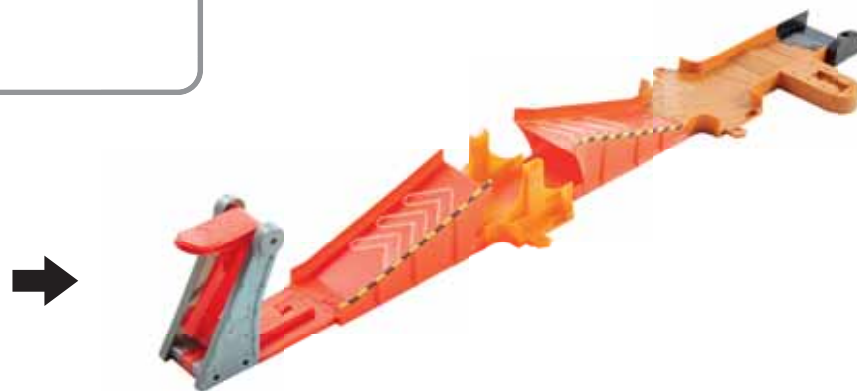
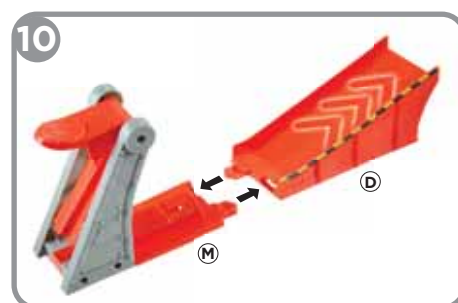
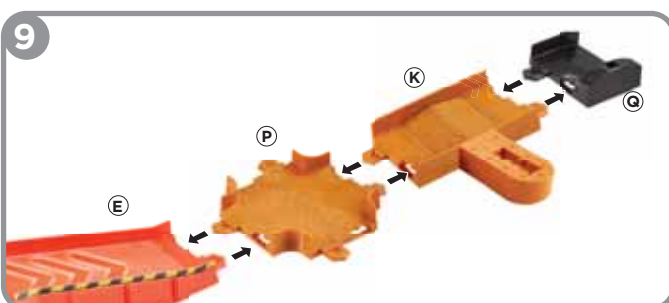
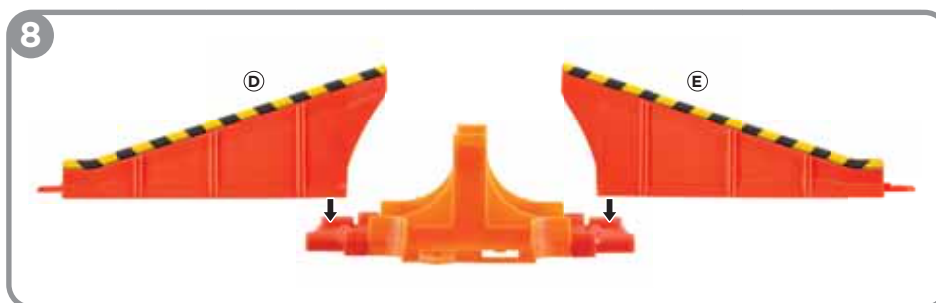
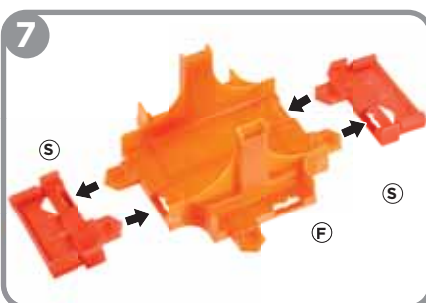
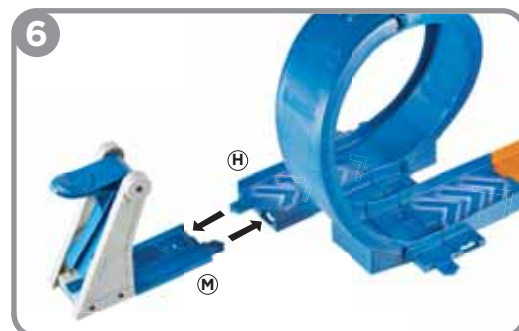
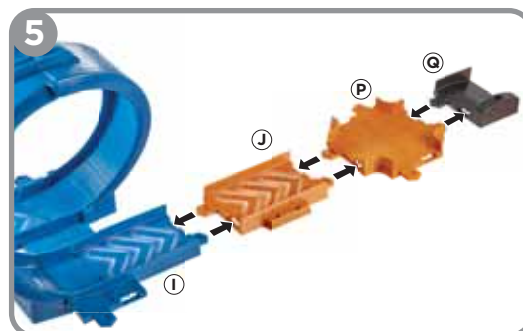
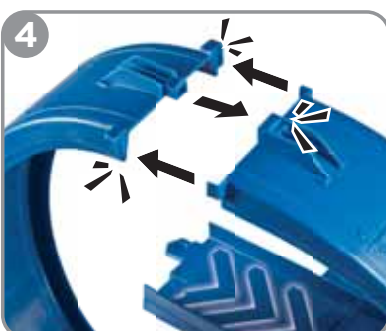
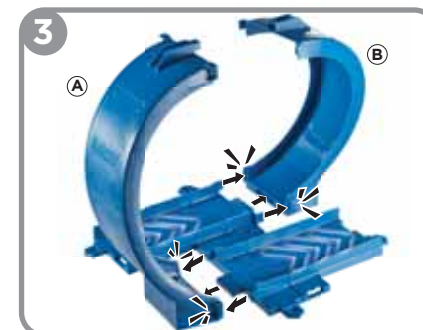
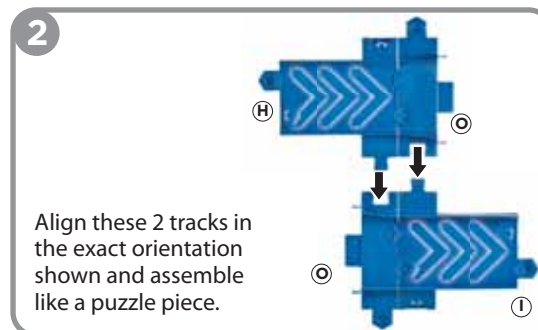
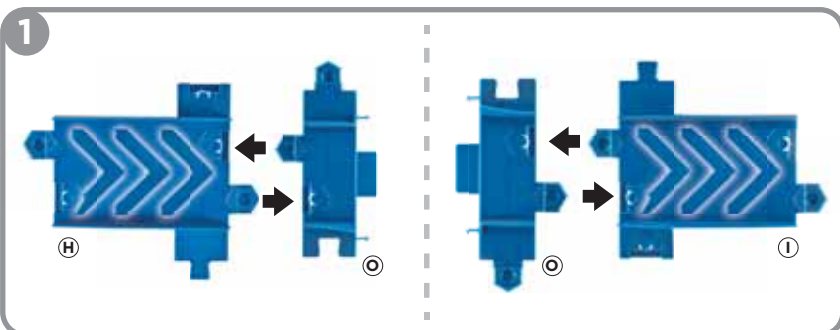

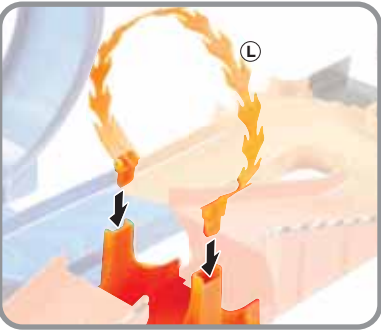
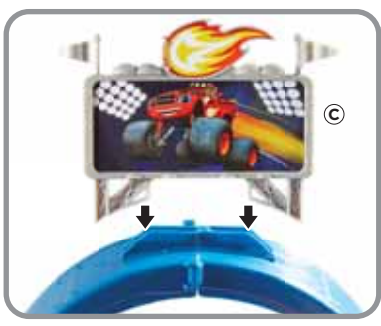

11

TOP VIEW

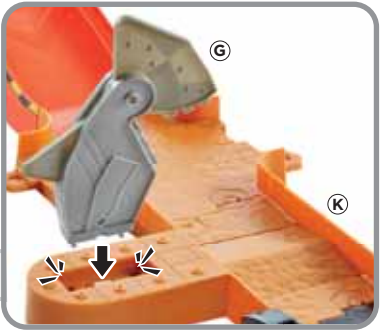
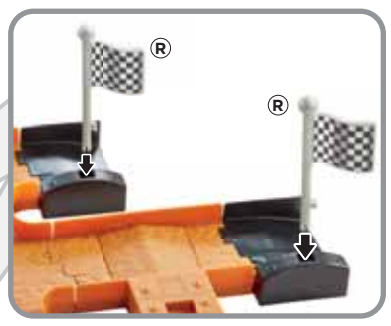
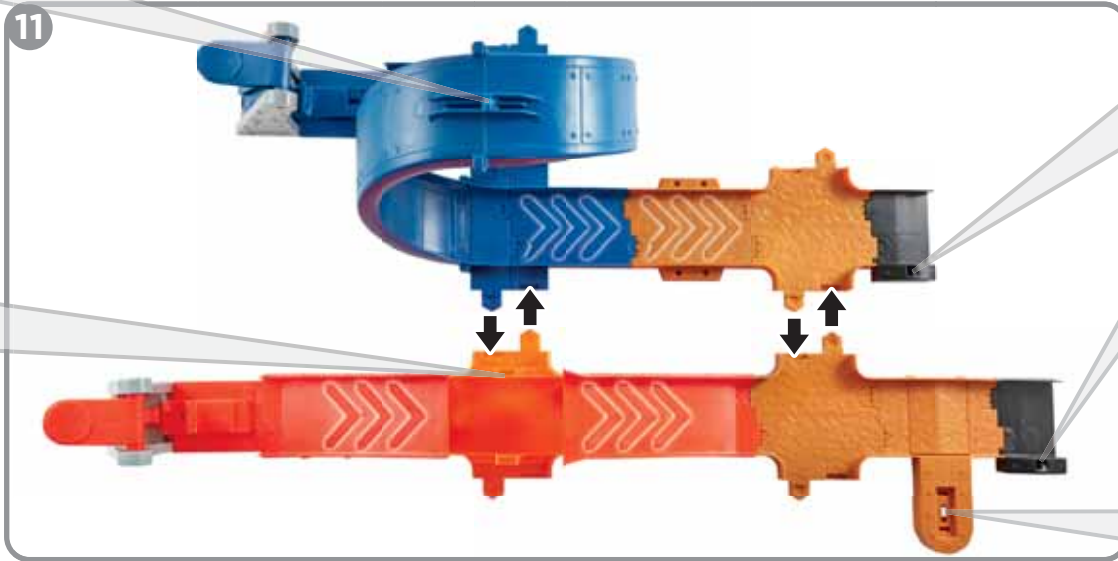

NOTE: This step is a "ONE-TIME SNAP". Once this part is inserted, it cannot be taken apart.

HOW TO PLAY

Blaze into STEM!
Science Technology Engineering Math



Momentum is the strength of a moving thing, measured by both its speed and weight. The harder you hit the launcher, the more momentum Blaze and Crusher will have to zoom down the track, around the loop, and through the flaming ring!

2 Launchers!



1. Load the vehicles into the launchers.



2. Slam down on the back of the launchers with your fist to race.

360° Loop!

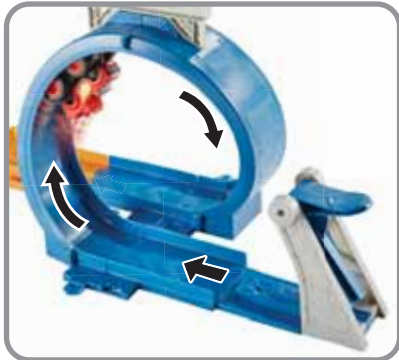

When assembling the track be sure the launcher is placed directly in front of the 360° loop for optimal performance.

Ring of Fire!



Fly through the ring of fire!

Chomping Sharkbot!

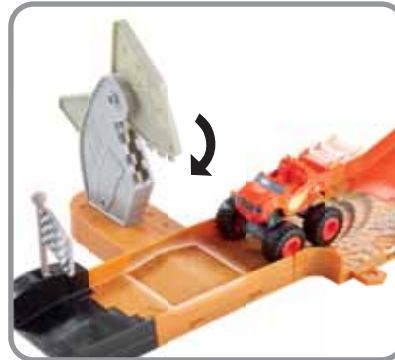

Watch out for the chomping sharkbot!

Racing Flags!



Race through the racing flags!

REARRANGE FOR OTHER LAYOUTS



CONSUMER ASSISTANCE
1-800-432-5437 (US & Canada)
1300 135 312 (Australia)

service.fisher-price.com

Fisher-Price, Inc., 636 Girard Avenue, East Aurora, NY 14052.
Hearing-impaired consumers: 1-800-382-7470.

Outside the United States:
Canada: Mattel Canada Inc., 6155 Freemont Blvd., Mississauga, Ontario L5R 3W2; www.service.mattel.com.
Great Britain: Mattel UK Ltd, Vanwall Business Park, Maidenhead SL6 4UB. Helpline: 01628 500303. www.service.mattel.com/uk
Mattel Europa B.V., Gondel 1, 1186 MJ Amstelveen, Nederland.
Australia: Mattel Australia Pty. Ltd., 658 Church Street, Locked Bag #870, Richmond, Victoria 3121 Australia.
New Zealand: 16-18 William Pickering Drive, Albany 1331, Auckland.

© 2015 Viacom International Inc. All Rights Reserved. Nickelodeon, Blaze and the Monster Machines and all related titles, logos and characters are trademarks of Viacom International Inc.
© 2015 Mattel. All Rights Reserved. ® and ™ designate U.S. trademarks of Mattel, except as noted. **PRINTED IN CHINA.**
Mattel East Asia Ltd., Room 503-09, North Tower, World Finance Centre, Harbour City, Tsimshatsui, HK, China. Tel.: (852) 3185-6500.

