

BOARD HANGING INSTRUCTIONS

J-Clip Mounting Instructions

1. Determine a desired height you want for the bottom edge of the board.
2. At this height, use a level and draw 2 small horizontal lines at least 6 inches in from the corners of the board.
3. Attach J-clips to wall in orientation shown, making certain the bottom of the J-clips are on the lines you marked. Mark holes through J-clips. Remove J-clips. Next, drill pilot holes a minimum of 1" deep to hold the anchors. Tap wall anchors (supplied) into holes. (If the board is to be mounted to a stud the wall anchors are not necessary). Place J-clip over anchor and mount the j-clip by tightly screwing it to the wall.
4. Set the board on bottom J-clips and draw 2 lines along the top of the board at least 6 inches in from the corners of the board.
5. Remove the board and attach the remaining J-clips to the wall in orientation shown. Position the J-clips slightly above the 2 lines you drew on the top in the full up position so that the J-clips can be tapped down on top of the frame.
6. Replace the board back onto the bottom brackets and push the top brackets down over the frame to hold the board firmly into place.

1.

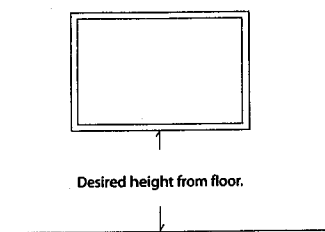

2.

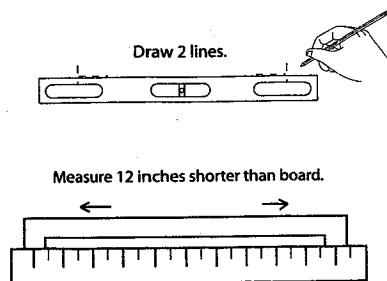

3.

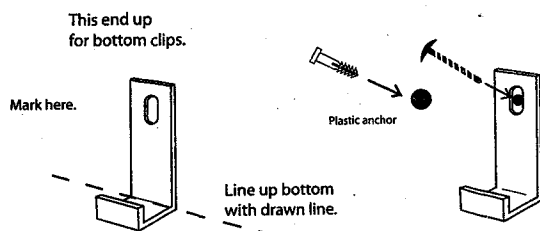

4.

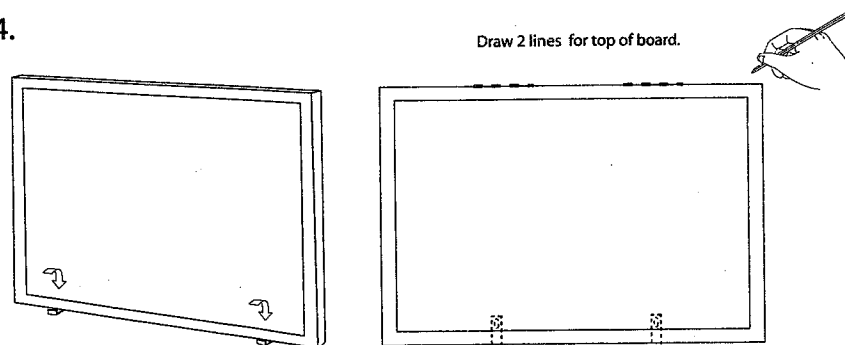

5.

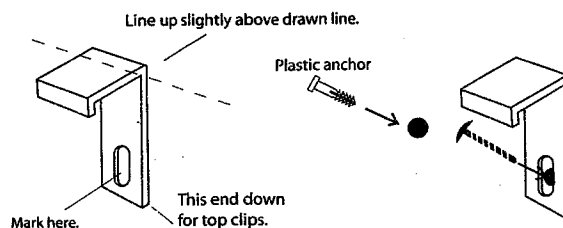

6.

