

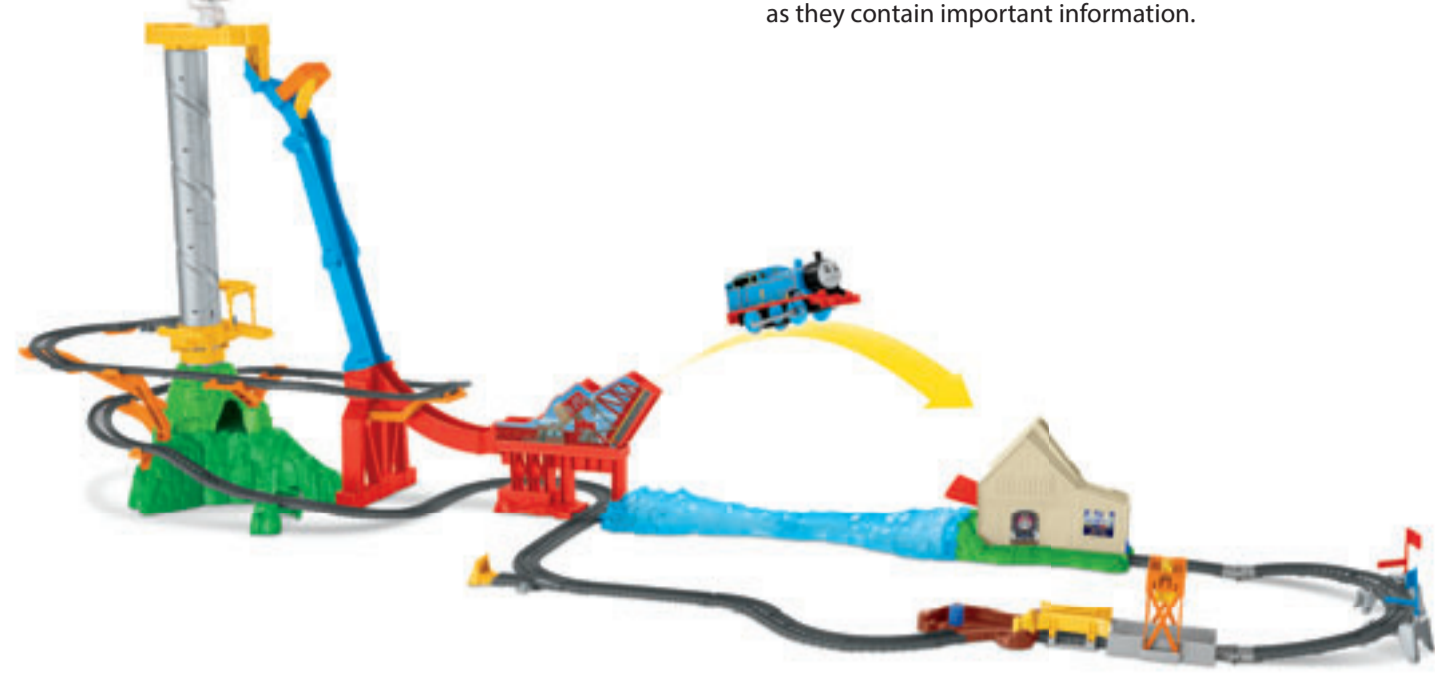

SKY-HIGH BRIDGE JUMP

Keep these instructions for future reference as they contain important information.



WHAT'S INCLUDED

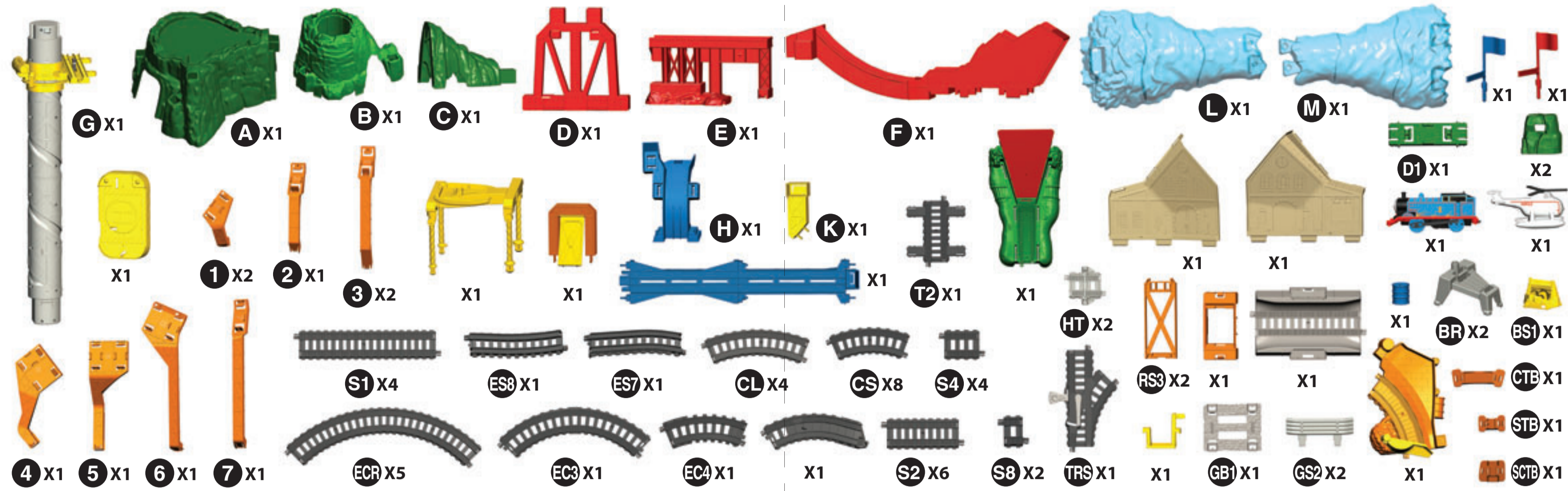

BATTERY INFORMATION

BATTERY INSTALLATION

- Access the battery compartment by unscrewing and separating the top half of the engine from the bottom half of the engine.
- Install the batteries as indicated inside the battery compartment.
- Re-assemble the two halves of the engine, re-insert the screw, and tighten.
- If the engine begins to operate erratically, you may need to reset the electronics by removing the batteries from the engine and reinstalling them.
- Requires 2 "AAA" (LR03) batteries.
- For longer life use only alkaline batteries.

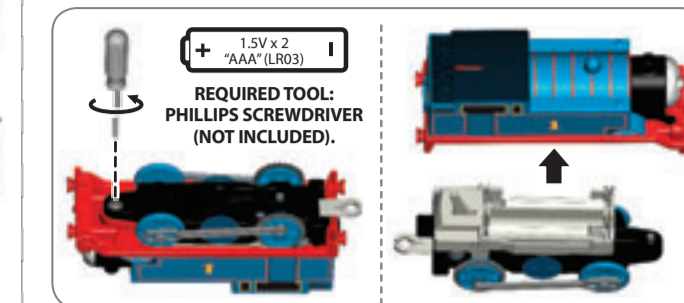

BATTERY SAFETY INFORMATION

- In exceptional circumstances batteries may leak fluids that can cause a chemical burn injury or ruin your product. To avoid battery leakage:
 - Non-rechargeable batteries are not to be recharged.
 - Rechargeable batteries are to be removed from the product before being charged.
 - Rechargeable batteries are only to be charged under adult supervision.
 - Do not mix alkaline, standard (carbon-zinc), or rechargeable (nickel-cadmium) batteries.
 - Do not mix old and new batteries.
 - Only batteries of the same or equivalent type as recommended are to be used.
 - Batteries are to be inserted with the correct polarity.
 - Exhausted batteries are to be removed from the product.
 - The supply terminals are not to be short-circuited.
 - Dispose of batteries safely.
 - Do not dispose of this product in a fire. The batteries inside may explode or leak.

CONSUMER ASSISTANCE
 1-800-4-A-MATTEL
 service.fisher-price.com
 Copyright © 2016 Mattel. All Rights Reserved. Printed in China.

Thomas the Tank Engine & Friends™
 CREATED BY BRIT ALLCROFT
 Based on the Railway Series by The Reverend W Awdry.
 ©2016 Gullane (Thomas) Limited. Thomas the Tank Engine & Friends and Thomas & Friends are trademarks of Gullane (Thomas) Limited.
 ©2016 HIT Entertainment Limited. HIT and the HIT logo are trademarks of HIT Entertainment Limited.
 ©2016 Mattel. All Rights Reserved. "and" designate U.S. trademarks of Mattel, except as noted. PRINTED IN CHINA.
 Mattel East Asia Ltd., Room 503-09, North Tower, World Finance Centre, Harbour City, Tsimshatsui, HK, China. Tel: (852) 3185-6500.



LABEL PLACEMENT

HELPFUL HINTS

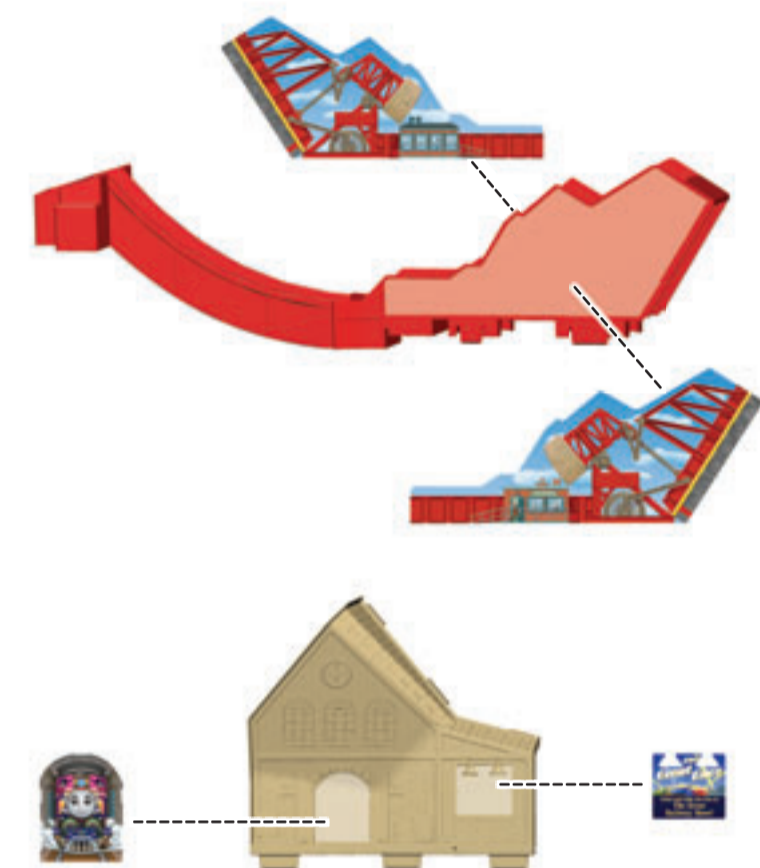

- ★ ONE-TIME SNAPS:** Assembly steps that are marked with a star are "one-time snaps". Once these parts are put together, they cannot be taken apart.
- Track marking codes are found on the bottom of tracks and risers.
- While connecting the tracks (ES8, ES7) that are marked with a triangle, make sure the side with the triangle is aligned to the lower track.
- Some track pieces (ECR, S8, ES7, ES8) are intentionally curved, they are not damaged.
- Note: Some engines may not work on this track set.
- CAUTION:** To prevent entanglement, keep hair away from wheels.
- WARNING:** CHOKING HAZARD - Small parts. Not for children under 3 years.

ADULT ASSEMBLY REQUIRED.
 No tools needed.

ASSEMBLY

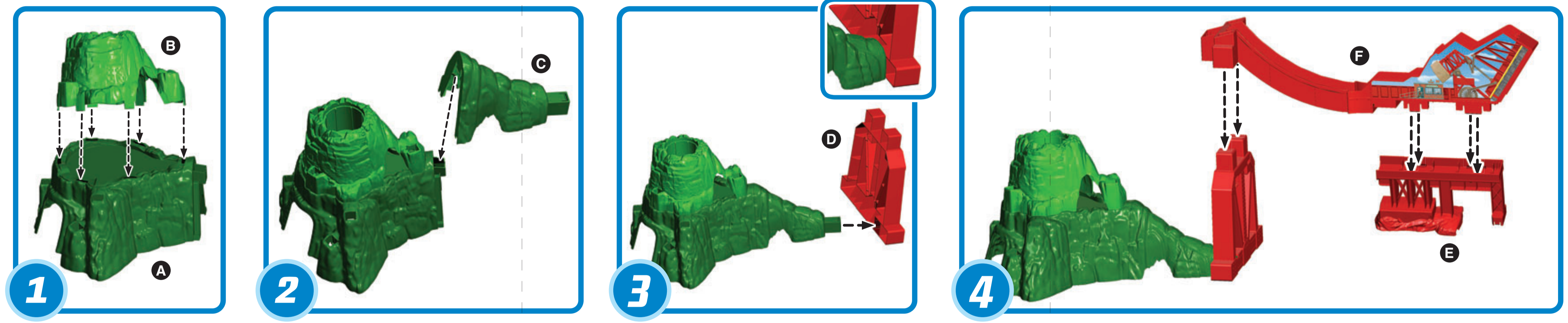

ASSEMBLY

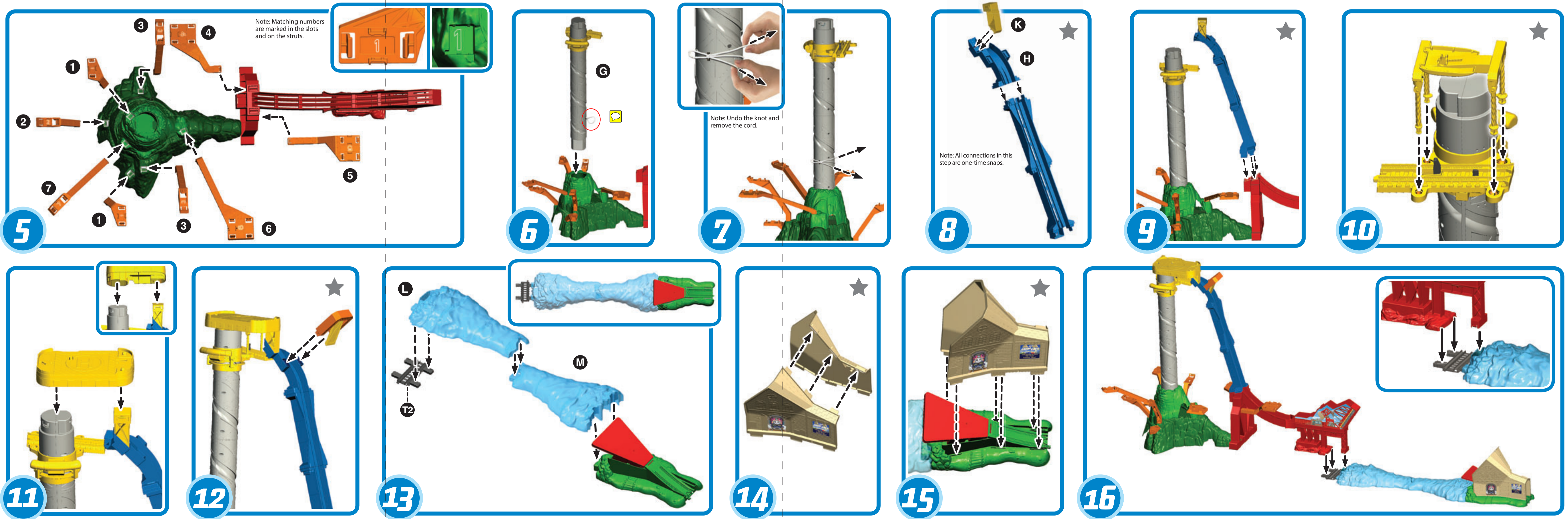

Item No.: DFMS4-0970/110096404-00M
 Blank Size: 33.1" x 23.4"
 Paper: Woodfree paper, 70 gsm
 Color: 4C
 Date: Mar. 23, 2016 (Jilly Liang)

Folding method:

Side 1	Cover	2	3	4
		5	6	7
		8		
Side 2		9	10	11
		12	13	14
		15	16	
	Cover	2	3	4
	Cover	2	3	4

ASSEMBLY

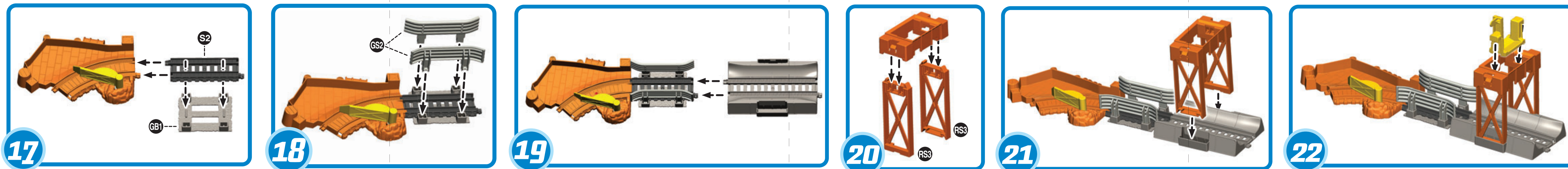

TRACK LAYOUT

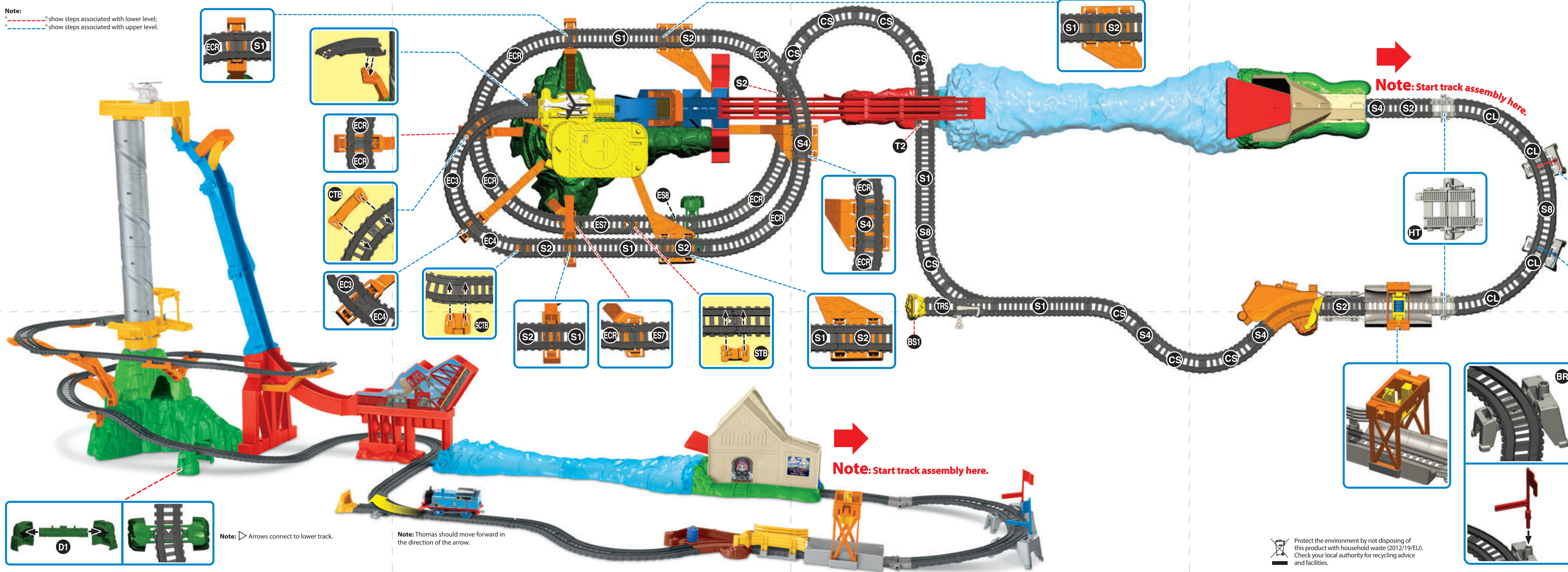

HOW TO PLAY

(Thomas should move forward in the direction as shown.)

