

INSTRUCTIONS

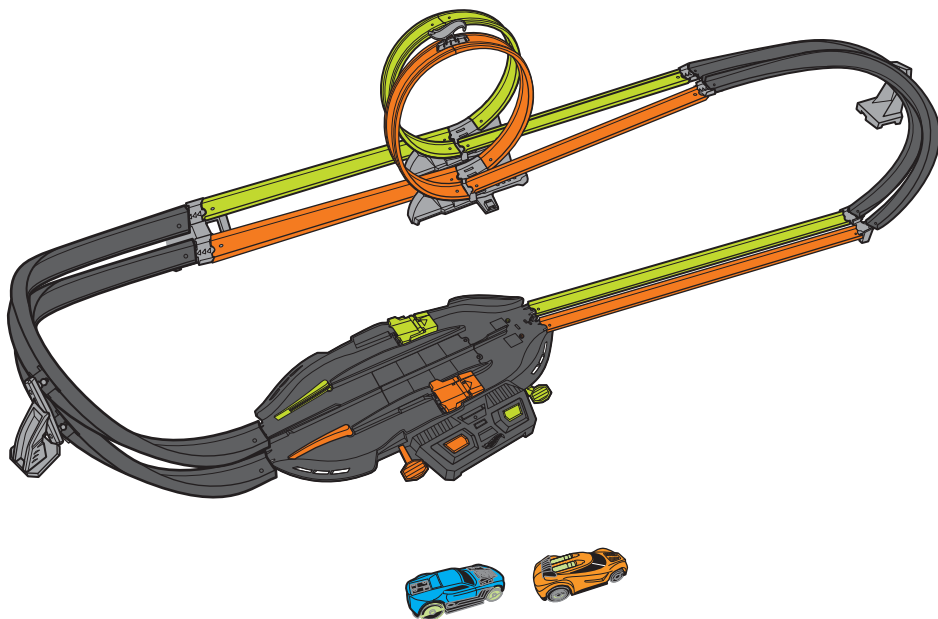

CIRCUIT SPEEDWAY™



COLORS AND DECORATIONS MAY VARY.

5+

service.mattel.com
HOTWHEELS.COM



DTM13-0970
1101135826-DOM_G2

PLEASE KEEP THESE INSTRUCTIONS FOR FUTURE REFERENCE AS THEY CONTAIN IMPORTANT INFORMATION.

CONTENTS

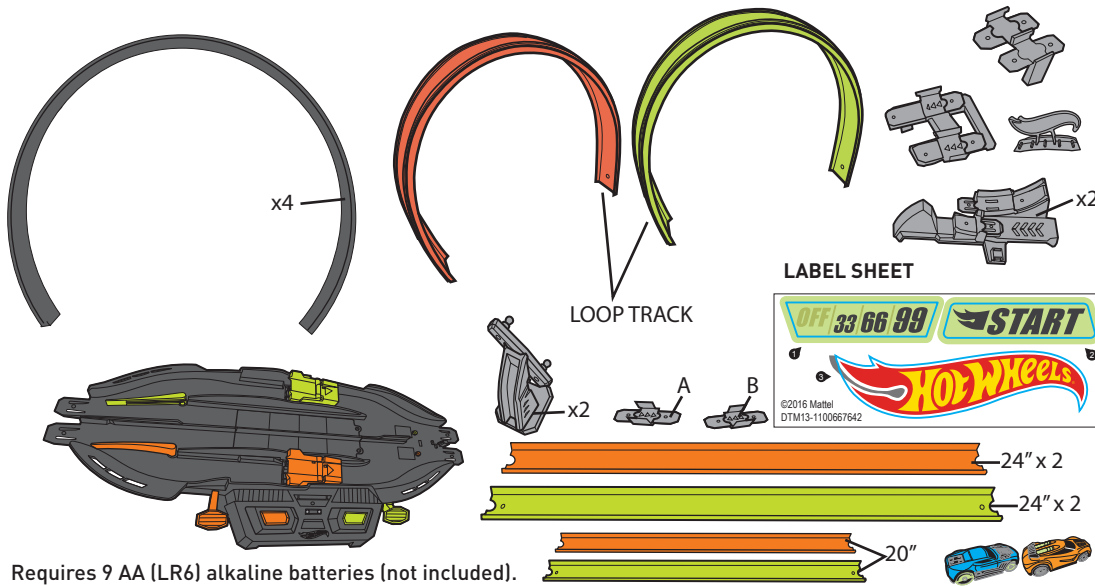

APPLY LABELS

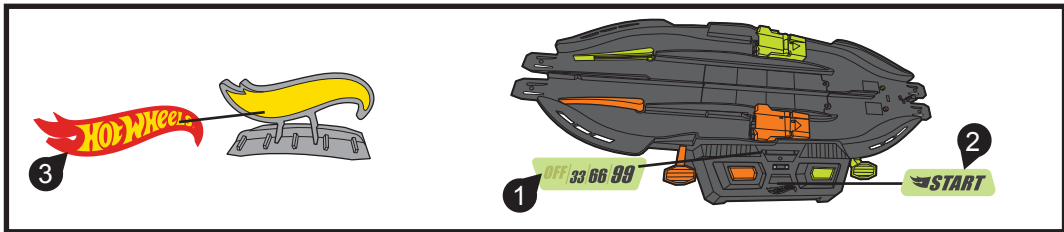

BATTERY INSTALLATION

- Unscrew the battery cover with a Phillips head screwdriver (not included).
- Install 9 AA (LR6) alkaline batteries (not included) in the orientation (+/-) shown.
- Replace battery cover and tighten screw.
- Replace the batteries in the top or bottom row when pit lane on that side can no longer charge cars.
- Replace the batteries in the middle row when lap counter lights dim.
- For longer life use alkaline batteries.
- When exposed to an electrostatic source, the product may malfunction. To resume normal operation, remove and re-install the batteries.

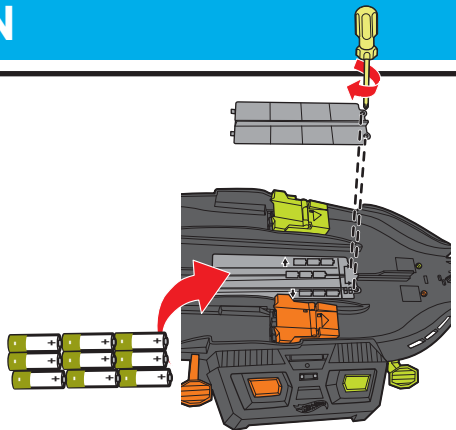

ASSEMBLY

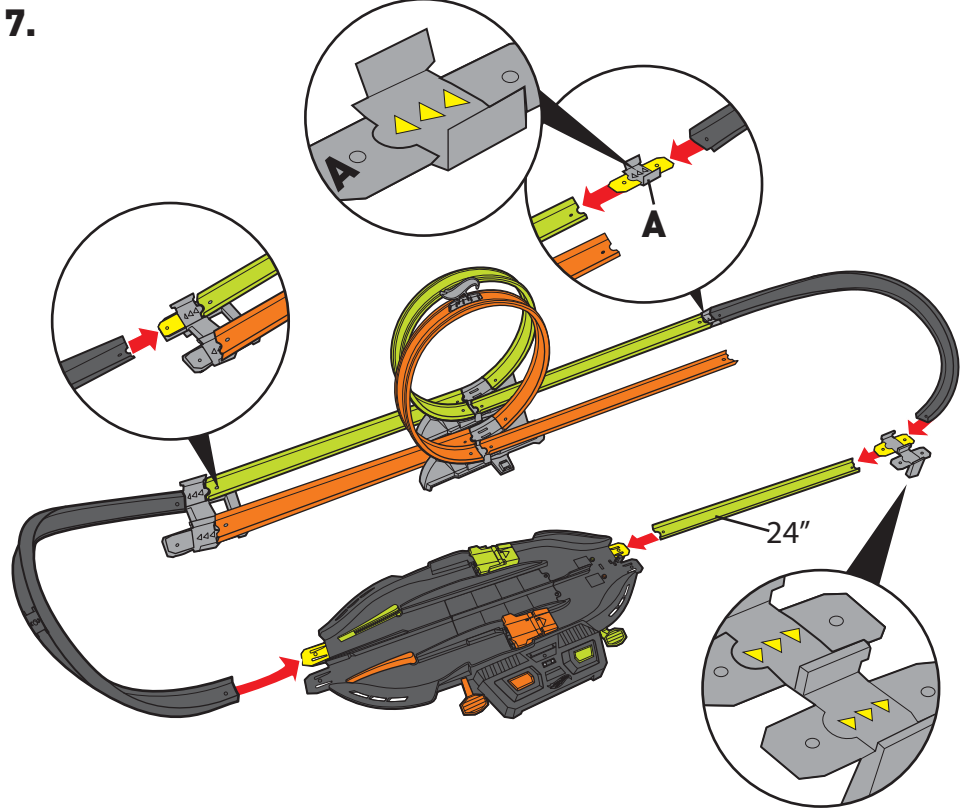
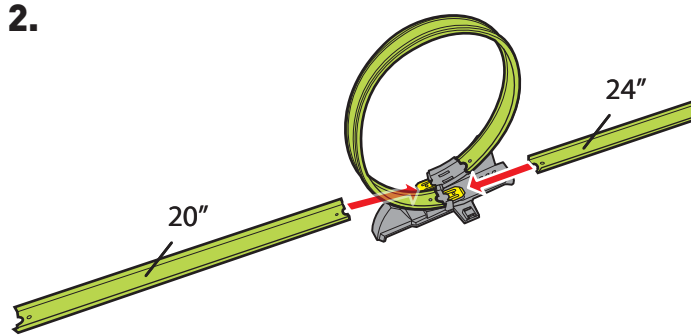
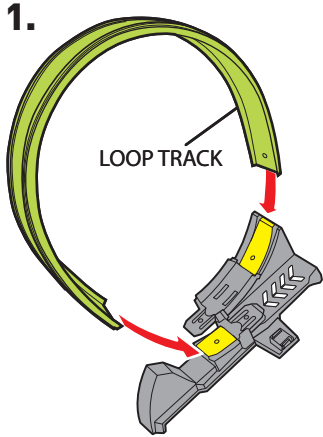

8

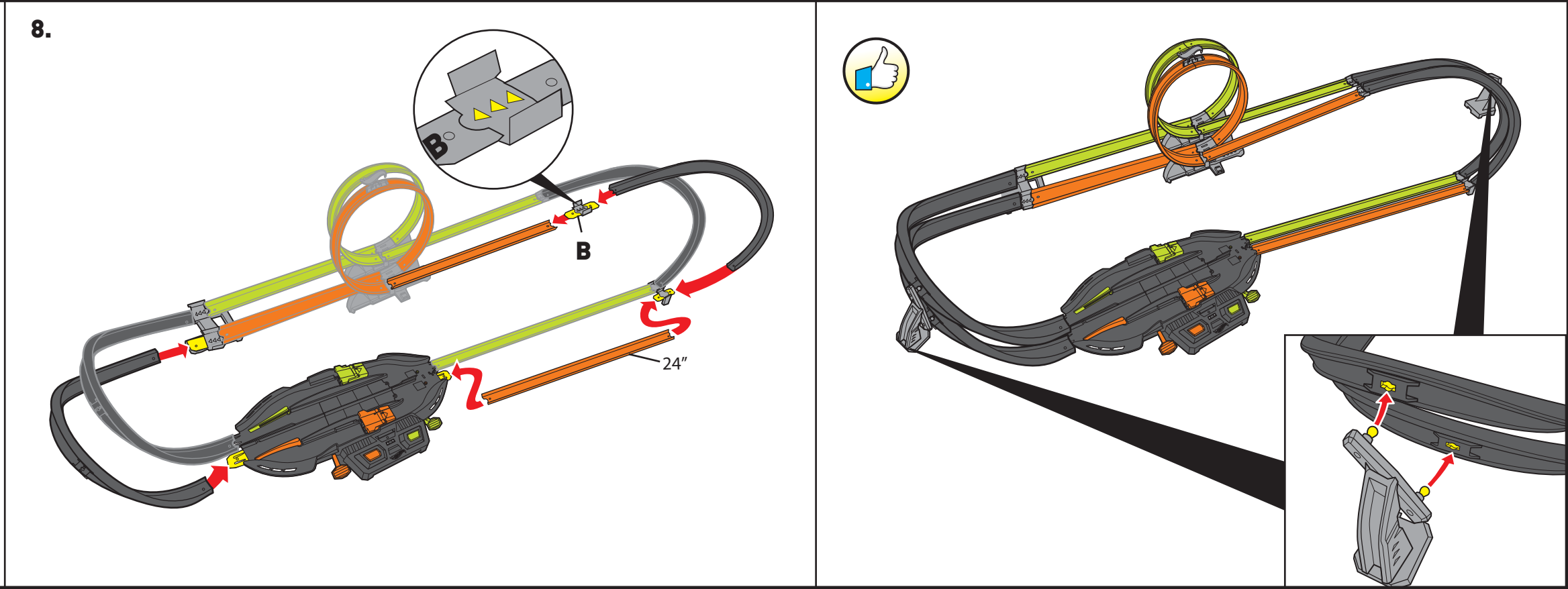
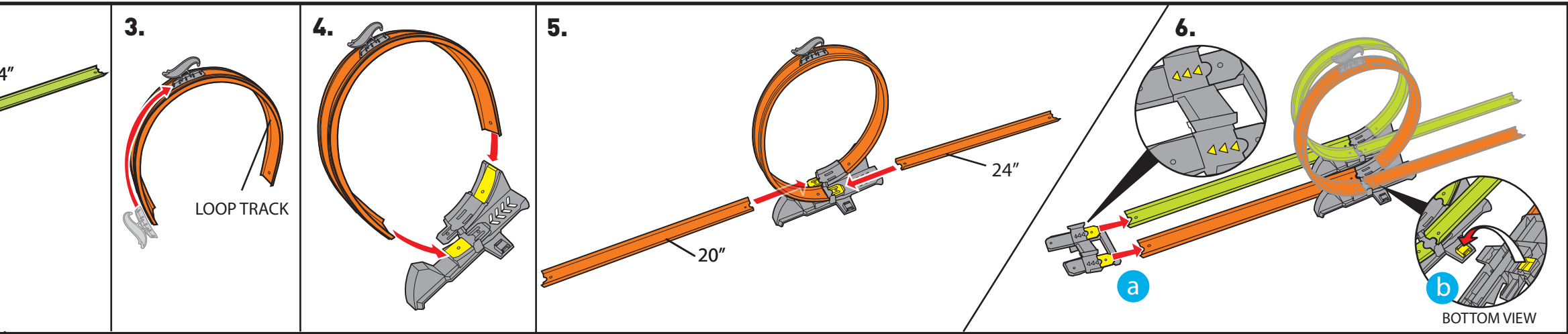

TO PLAY

1. SELECT THE NUMBER OF LAPS FOR YOUR RACE.

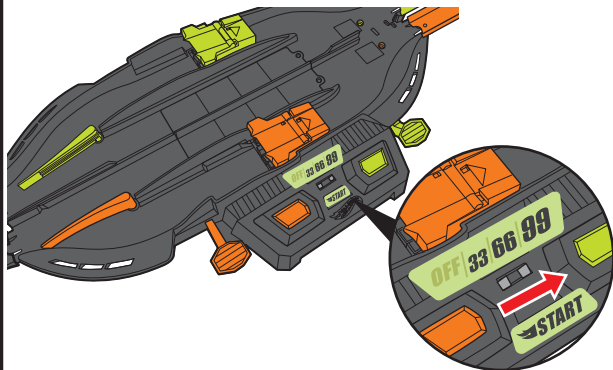

2. LOAD SPEED CHARGERS CARS INTO PIT LANES AND CHARGE. A FULL CHARGE WILL TAKE AROUND 10 SECONDS.

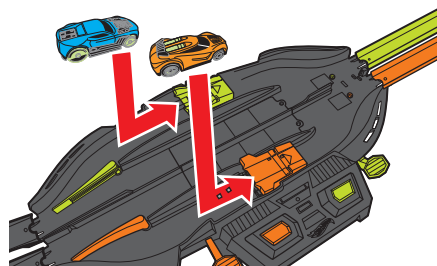

NOTE: A FULLY CHARGED CAR SHOULD LAST AROUND 10-15 LAPS. NUMBER OF LAPS WILL VARY DEPENDING ON THE PIT LANE'S BATTERY LEVEL.

3. PRESS START BUTTON TO BEGIN LAP COUNTER.

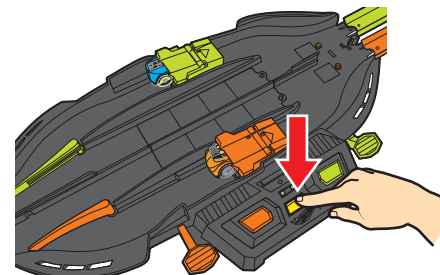

4. PRESS BUTTONS TO LAUNCH CARS INTO RACE!

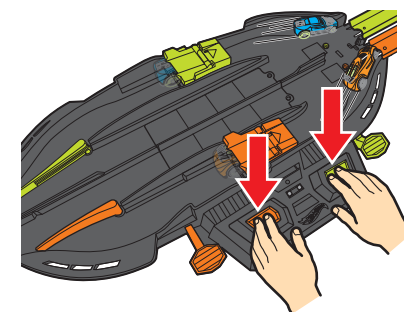

5. USE RACE STRATEGY TO TIME YOUR PIT STOPS AND RECHARGE!
FIRST CAR TO COMPLETE ALL THE LAPS WINS!

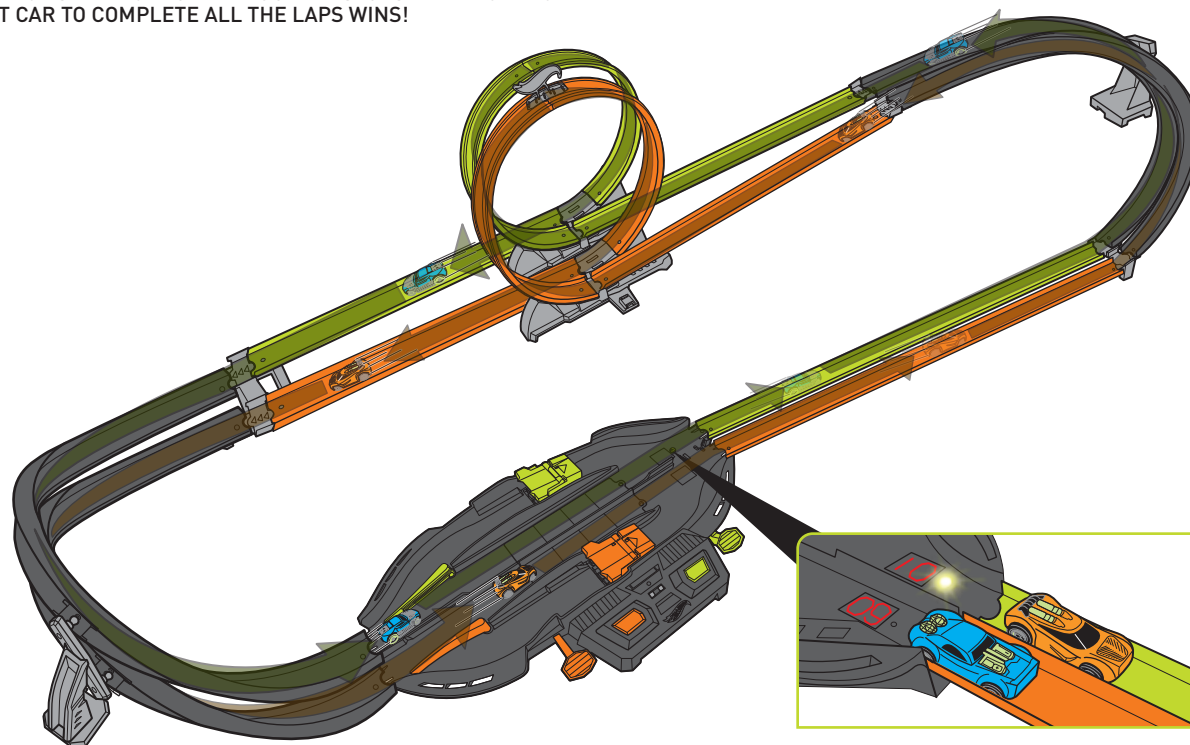

LAP COUNTER TELLS YOU WHO IS LEADING THE RACE.
LED LIGHT INDICATES THE WINNER!

6. PRESS LEVER TO MAKE A PIT STOP AND RECHARGE WHEN CAR STARTS SLOWING DOWN.

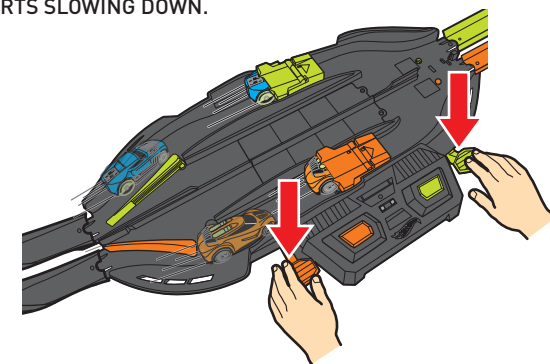

7. EXIT THE PIT LANE AND KEEP ON RACING!

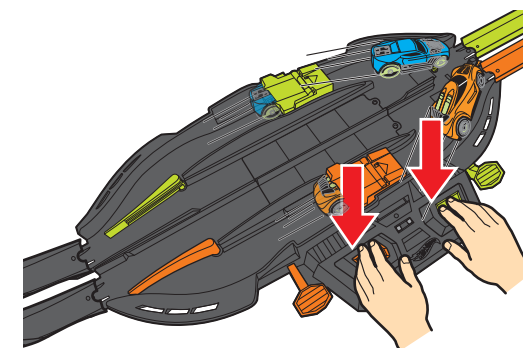

FOR USE WITH SPEED CHARGERS CARS ONLY.

PERFORMANCE TIPS

Q: Why can't my car fully enter the pit lane to recharge?

A: Your car might be traveling too fast when it enters the pit lane. Push your car forward into the pit lane to continue charging your car.

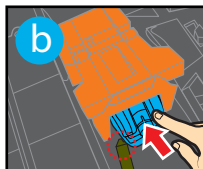
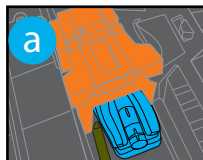

Q. My car keeps crashing on the track for no reason. What is the problem?

A. Clear all obstructions on the track. Adjust track side walls at each connection point.

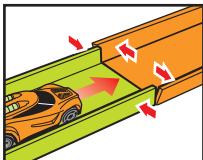

Q. My Speed Chargers car keeps slowing down by itself on the tracks even though it is charged.

A. Lint may collect around your car's axles. This may cause the car to run slowly. Use tweezers or a toothpick to remove lint.

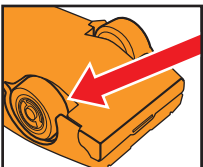

BATTERY SAFETY INFORMATION

In exceptional circumstances batteries may leak fluids that can cause a chemical burn injury or ruin your product. To avoid battery leakage:

- Non-rechargeable batteries are not to be recharged.
- Rechargeable batteries are to be removed from the product before being charged.
- Rechargeable batteries are only to be charged under adult supervision.
- Do not mix alkaline, standard (carbon-zinc), or rechargeable (nickel-cadmium) batteries.
- Do not mix old and new batteries.
- Only batteries of the same or equivalent type as recommended are to be used.
- Batteries are to be inserted with the correct polarity.
- Exhausted batteries are to be removed from the product.
- The supply terminals are not to be short-circuited.
- Dispose of battery(ies) safely.
- Do not dispose of this product in a fire. The batteries inside may explode or leak.



Protect the environment by not disposing of this product with household waste [2012/19/EU]. Check your local authority for recycling advice and facilities.

©2016 Mattel. All Rights Reserved. Mattel, Inc., 636 Girard Avenue, East Aurora, NY 14052, U.S.A. Consumer Services 1-800-524-8697. Mattel U.K. Ltd., Vanwall Business Park, Maidenhead SL6 4UB. Helpline 01628 500303. Mattel Australia Pty., Ltd., Richmond, Victoria. 3121. Consumer Advisory Service - 1300 135 312. Mattel East Asia Ltd., Room 503-09, North Tower, World Finance Centre, Harbour City, Tsimshatsui, HK, China. Tel.: (852) 3185-6500. Diimport & Diedarkan Oleh: Mattel Southeast Asia Pte. Ltd., No 19-1, Tower 3 Avenue 7, Bangsar South City, No 8, Jalan Kerinchi, 59200 Kuala Lumpur, Malaysia. Tel: 03-78803817, Fax: 03-78803867.