

TROUBLESHOOTING

TRY ME PULL TAB

The pull-tab in the Try Me slot should be automatically removed when toy is taken out of the package. If not, simply remove the pull-tab before playing.

RESET BUTTON

Reset playhouse if Pixel Chix pal leaves house, she has been neglected for a few days, or to start a fresh game. Ask an adult to insert a metal tip, such as a bent paper clip, into the hole.

When exposed to an electrostatic source, the product may malfunction and suffer memory loss. Reset the product if this occurs.

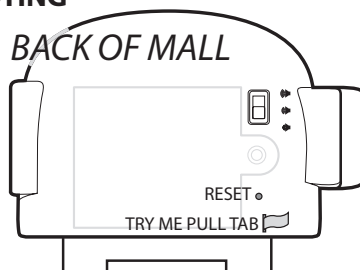

BATTERY REPLACEMENT

Batteries included are for demonstration purposes only. 4 AAA (LR03) alkaline batteries recommended.

Toy uses 4 replaceable AAA (LR03) alkaline batteries. When "LOW BATTERY" shows on screen, change batteries within 3 minutes. To replace batteries, use a Phillips head screwdriver (not included) to open battery door. Remove and set aside. Insert 4 replaceable AAA (LR03) alkaline batteries as shown. Use either AAA (LR03) alkaline batteries or equivalent. Replace battery cover and screw closed.

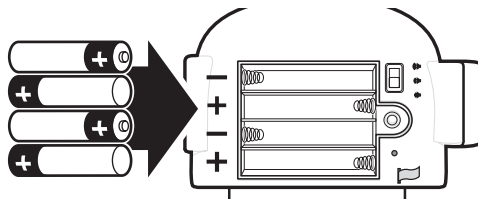

BATTERY SAFETY INFORMATION

In exceptional circumstances batteries may leak fluids that can cause a chemical burn injury or ruin your product. To avoid battery leakage:

- Non-rechargeable batteries are not to be recharged.
- Rechargeable batteries are to be removed from the product before being charged (if designed to be removable).
- Rechargeable batteries are only to be charged under adult supervision (if designed to be removable).

- Do not mix alkaline, standard (carbon-zinc), or rechargeable (nickel-cadmium) batteries.
- Do not mix old and new batteries.
- Only batteries of the same or equivalent type as recommended are to be used.
- Batteries are to be inserted with the correct polarity.
- Exhausted batteries are to be removed from the product.
- The supply terminals are not to be short-circuited.
- Dispose of battery(ies) safely.
- Do not dispose of this product in a fire. The batteries inside may explode or leak.

This equipment has been tested and found to comply with the limits for a Class B digital device, pursuant to part 15 of the FCC rules. These limits are designed to provide reasonable protection against harmful interference in a residential installation. This equipment generates, uses and can radiate radio frequency energy and, if not installed and used in accordance with the instructions, may cause harmful interference to radio communications. However, there is no guarantee that interference will not occur in a particular installation. If this equipment does cause harmful interference to radio or television reception, which can be determined by turning the equipment off and on, the user is encouraged to try to correct the interference by consulting the dealer or an experienced radio/TV technician for help.

Mattel Inc.
333 Continental Blvd.
El Segundo, CA
(310) 252-2000

NOTE: Changes or modifications not expressly approved by the manufacturer responsible for compliance could void the user's authority to operate the equipment.



Protect the environment by not disposing of this product with household waste (2002/96/EC). Check your local authority for recycling advice and facilities.

CONSUMER INFORMATION

Need Assistance? Visit service.mattel.com or call 1-800-524-8697 (US and Canada only), M-F 9AM - 7PM & SAT 11AM - 5PM, Eastern.

SERVICE.MATTEL.COM

Mattel Canada Inc., Mississauga, Ontario L5R 3W2. You may call us free at 1-800-524-8697.

Mattel U.K. Ltd., Vanwall Business Park, Maidenhead SL6 4UB, Helpline 01628500303.

Mattel Australia Pty., Ltd., Richmond, Victoria 3121. Consumer Advisory Service 1300 135 312 (valid only in Australia).

Mattel East Asia Ltd, Room 1106, South Tower, World Finance Centre, Harbour City, Tsimshatsui, HK, China.

Diimport & Diedarkan Oleh: Mattel SEA Ptd Ltd. (993532-P) Lot 13.5, Menara Lien Hoe, Persiaran Tropicana Golf Country Resort, 47410

PIXEL CHIX™

INSTRUCTIONS

6+



J9435-0920-G4
J9436

CONTENTS

J9435 / J9436*



*Each sold separately and subject to availability.

We want you to have fun playing with our products, so please give us your feedback by filling out the short On-line survey. Go to service.mattel.com/surveys

Thanks for helping us make great toys even better!
English-only site. • Site Web en anglais uniquement.

Please remove everything from the package and compare to the contents shown here. Keep these instructions for future reference as they contain important information.

©2006 Mattel, Inc., 333 Continental Blvd., El Segundo, CA 90245 U.S.A. All Rights Reserved.

A PIXILLION things we can do together!™

Your Pixel Chix™ friend can shop to buy items in stores, but first must work to earn money. With each item your friend buys, a new animation or game associated with that item becomes available in the MONEY/STUFF screen. If you cannot select an item in the MONEY/STUFF menu, you have not purchased it yet. If your Pixel Chix™ friend says "I don't have enough," it is because you don't have enough money to buy items, and you must earn more. There are 2 ways to earn money: when working in a store, you treat customers nicely and help them (and make a sale), or win games (3 games = \$10 bonus).

2 STORES TO WORK OR SHOP!

Flip the LCD screen up and down to change the store.

J9435*

food court

boutique

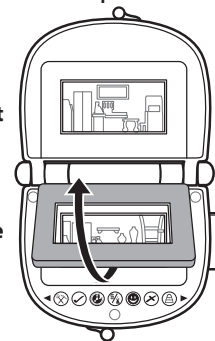

*Each sold separately and subject to availability.

J9436*

pet store

salon

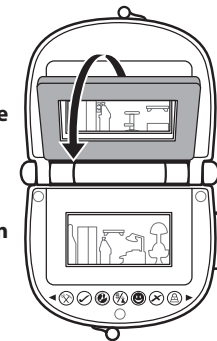

GO AHEAD AND PUSH MY BUTTONS!

Press any button to start playing. There are 2 play modes, **Shop** mode and **Work** mode.



WORK

The first time you press this button, your Pixel Chix™ friend needs to interview for a job. Your friend can work in a boutique, a pet shop, a hair salon, or a restaurant. By successfully completing a game in work mode, your friend earns money.

When playing a game, this button moves your Pixel Chix™ friend or the selection arrow to the left.



YES

Press to select an item, task, or to buy.



BREAK TIME

Press to take a break from shopping or working. There are many ways to take a break!



MONEY/STUFF

This shows what your Pixel Chix™ friend owns and how much money she has. Select a store and see what your friend bought at that store. Select an item and see an animation or play a **game!** (See game play details to the left.)



FUN

Press the FUN button for games. The games that you play will be different in each mode.



NO

Press to cancel selection of an item, task, or purchase.



SHOP

Shop for fashions in a boutique, a pet in a pet shop, a meal in the food court, or a new look at the hair salon! Make sure your Pixel Chix™ friend has enough money!

When playing a game, this button moves your friend or the selection arrow to the right.

GAMES

Here is an example of typical game.

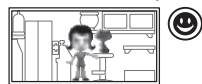

Press the FUN button to play a game. Your Pixel Chix™ friend says "Help me dress the kitty."



A pet fashion appears in the girl's hand. Use the WORK and SHOP buttons to scroll through the different fashions.

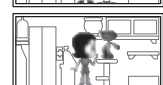

When the fashion you want to choose appears, press YES to select. The girl puts the fashion on the kitty.

NOTE

- Press NO at any time to exit a game.
- To put the toy to sleep, hold down both the YES and NO buttons for 3 seconds. This will also turn off the Mall. Closing the Mall also turns it off.
- A 3 position switch for volume control is on the back of the Mall.
- The Mall automatically goes into sleep mode after 2 minutes of no play.

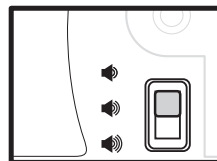

CONNECT TO A HOUSE, CAR OR ANOTHER MALL FOR EVEN MORE FUN!

Remove cover first, then connect the malls, or houses or cars to the mall.

Do not put finger into ports as this may reset game.



CONNECT 2 MALLS

- Press FUN, WORK or SHOP button on one mall while connected and the Pixel Chix™ friend comes over to the mall you pushed the button on.

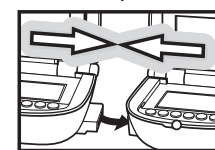

- Hold down NO button on active mall to send the Pixel Chix™ friend back to her original mall.

On the non-active mall, any button can be pressed to bring her back.

CONNECT 3 OR MORE MALLS

- When 3 or more malls are connected, pressing the FUN button will play a synchronized animation using all the girls in their respective malls.

CONNECT A HOUSE TO THE MALL

- Press FUN button on the mall and the Pixel Chix™ friend goes from the house to the mall.

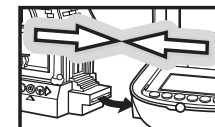

CONNECT A CAR TO THE MALL

- To bring a girl over from the mall to the car, press any button on the car.

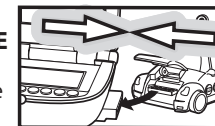

Hair color of girls leaving house may be different from the hair colors of girls entering the car.
House, car and additional mall sold separately, subject to availability. Colors and decorations may vary.