

This is a battery-operated product.
1 flyer (00007-1849G6) is required
to be placed inside the packaging.

This is a battery-operated product.
1 flyer (00001-1373G1) is required
to be placed inside the packaging.

To Play 3

DRIFT WITH DOC HUDSON!

Swivel the launcher (A). Load Lightning McQueen (B).
Press the button (C) to launch Lightning McQueen around
the dirt track.

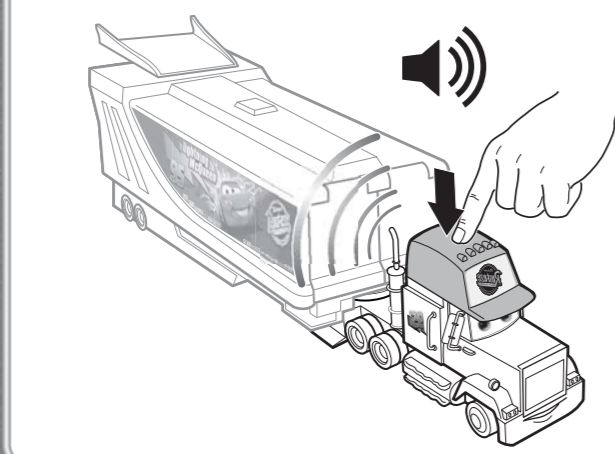
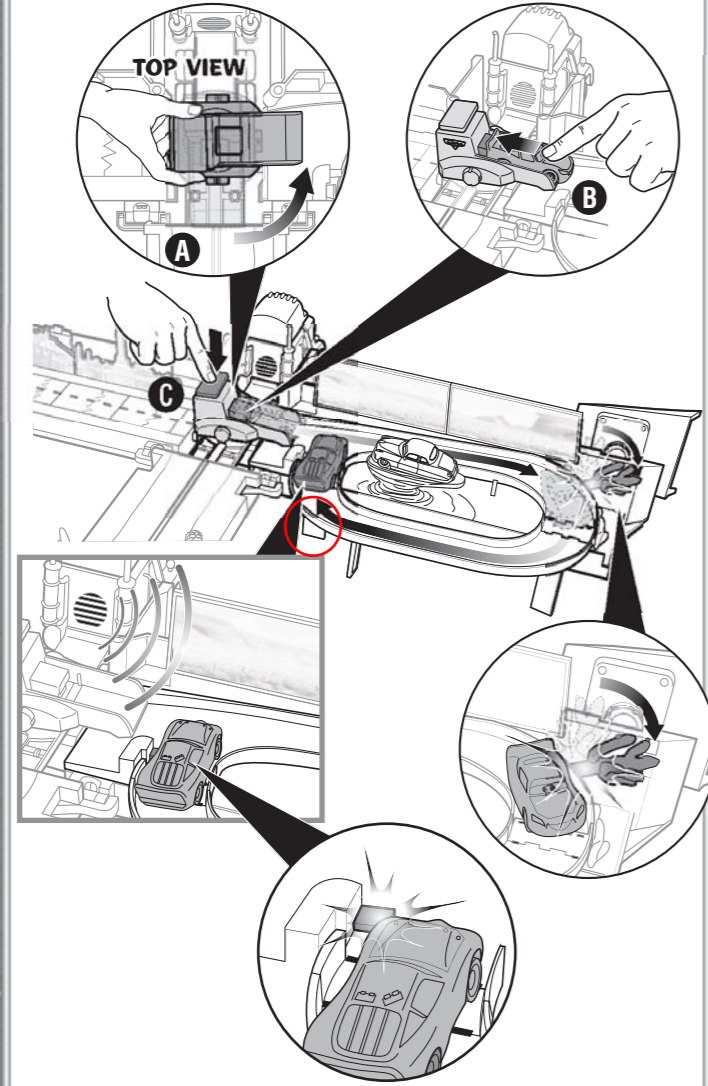

Storage

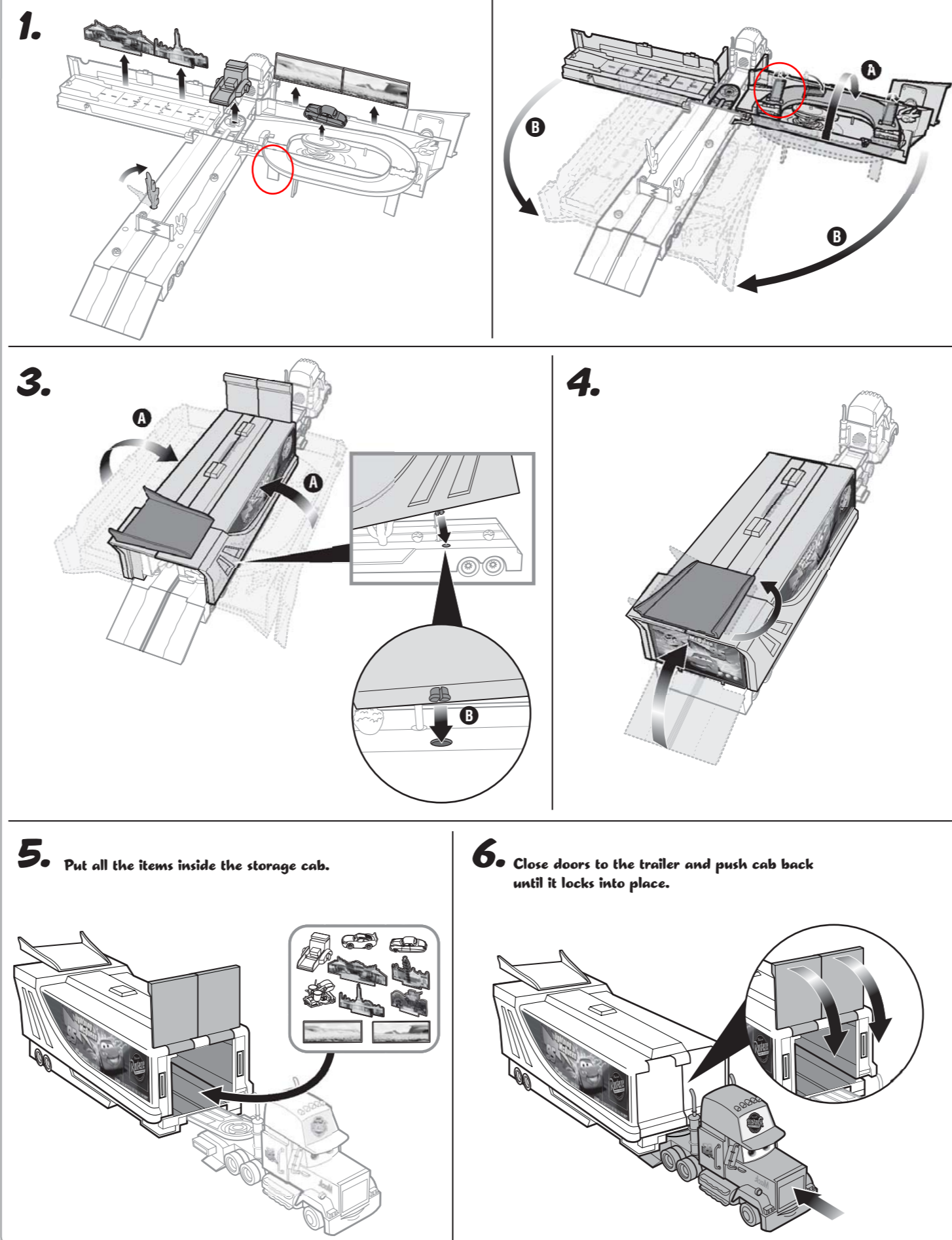

Mega Mack Playtown™ Instructions

Contents

Please keep these instructions for future reference
as they contain important information.

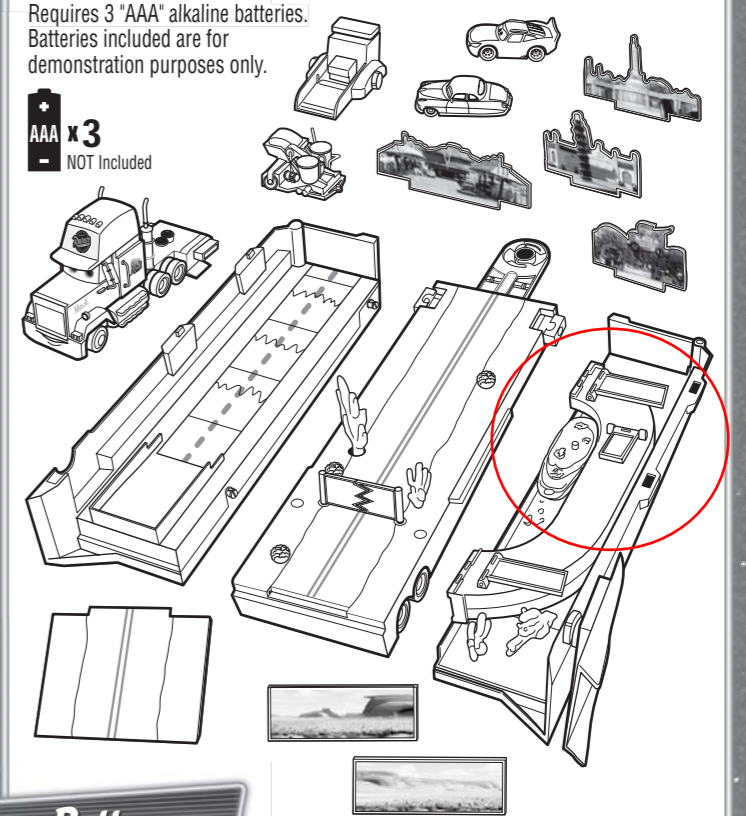

Battery Installation

- Unscrew the battery cover with a Phillips-head screwdriver (not included).
- Remove batteries included for demonstration purposes only and dispose of them safely.
- Insert 3 new "AAA" alkaline batteries (not included) in the orientation shown.
- Replace the battery cover and tighten screw.
- Replace batteries if sound is distorted or if movement slows.
- For best performance, use only alkaline batteries.

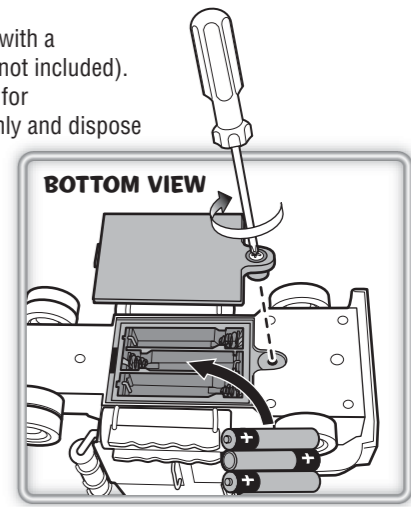

INSTRUCTION SHEET SPECIFICATIONS

Toy:	Lightning McQueen
Toy No.:	L2579
Part No.:	0920G1
Trim Size:	16.5"W x 11.25"H
Folded Size:	5.625"W x 8.25"H
Type of Fold:	
# colors:	One
Colors:	Black
Paper Stock:	White Offset
Paper Weight:	70 lb.
EDM No.:	

© Disney/Pixar
Mattel, Inc., 333 Continental Blvd., El Segundo, CA 90245 U.S.A. Consumer Relations 1-800-524-8697 service.mattel.com Mattel U.K. Ltd., Vanwall Business Park, Maidenhead SL6 4UB. Helpline 01628500303. Mattel Australia Pty Ltd., Richmond, Victoria, 3121. Consumer Advisory Service - 1300 135 312. Mattel East Asia Ltd., Room 1106, South Tower, World Finance Centre, Harbour City, Tsimshatsui, HK, China. Diimport & Diedarkan Oleh: Mattel SEA Ptd Ltd. (993532-P) Lot 13.5, Menara Lien Hoe, Persiaran Tropicana Golf Country Resort, 47410 PJ. Tel:03-78803817, Fax:03-78803867. service.mattel.com

Assembly

1.

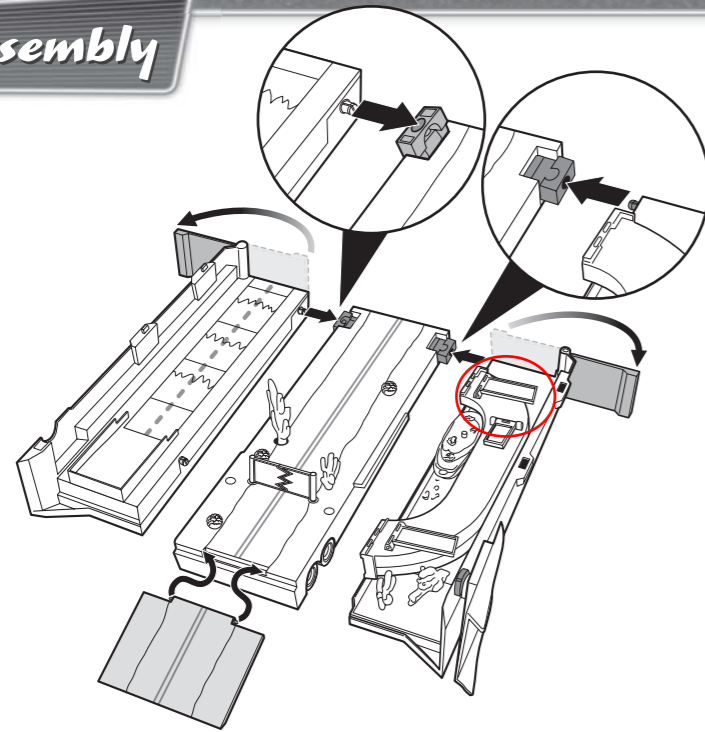

2. Pull out hitch (A). Hook trailer to the cab as shown (B).

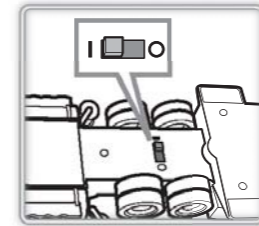

I = ON O = OFF

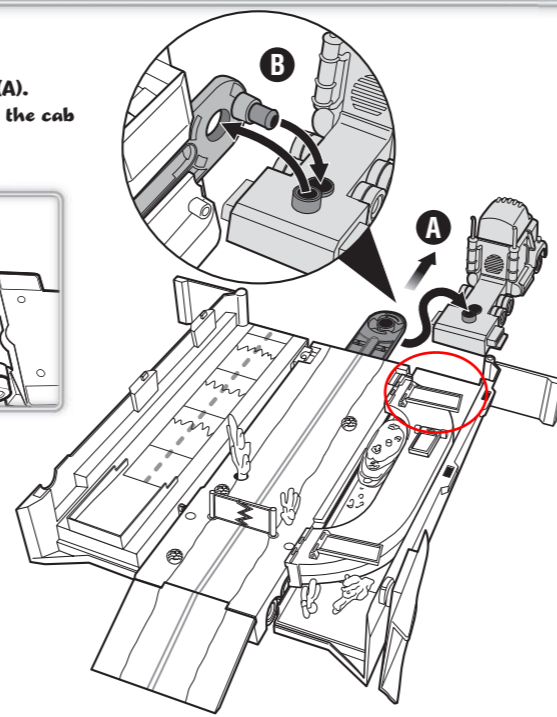

3.

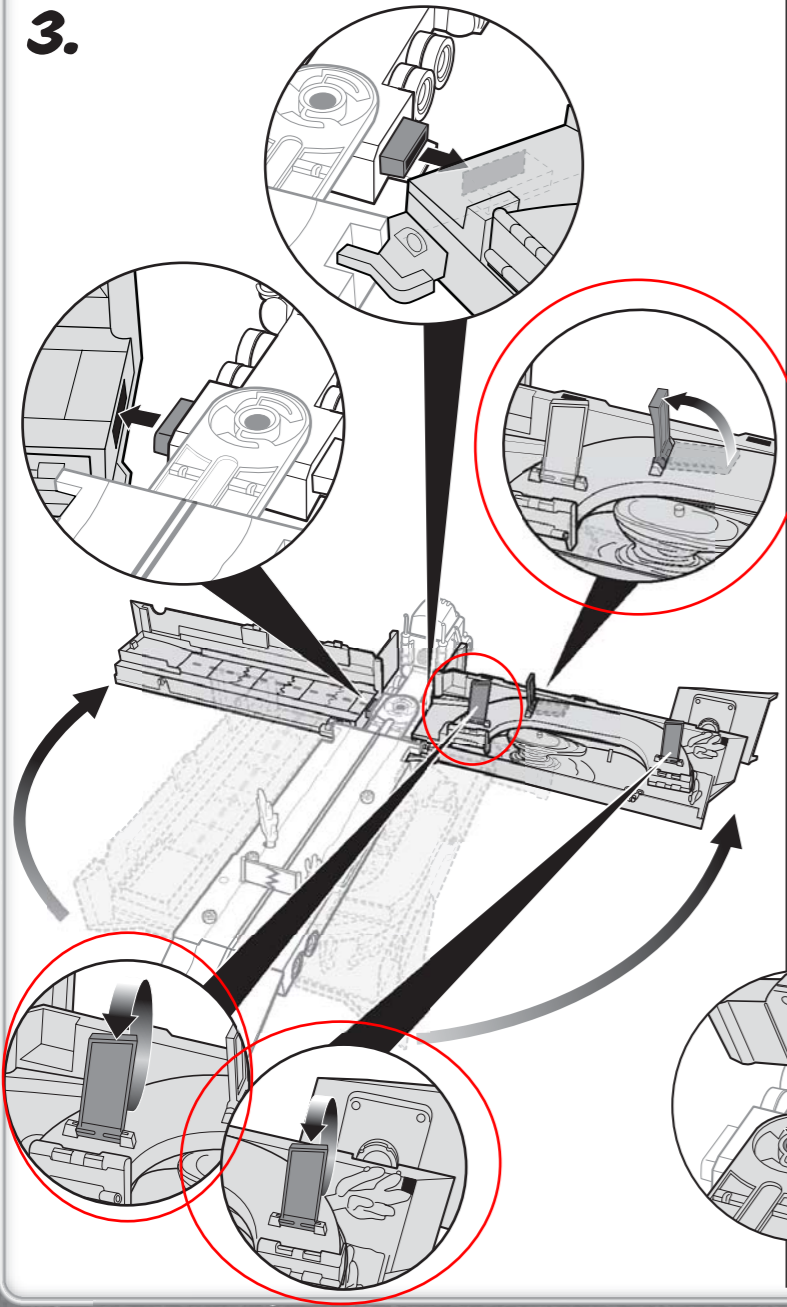

4.

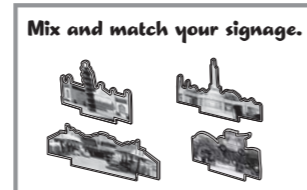

Mix and match your signage.

BACK VIEW

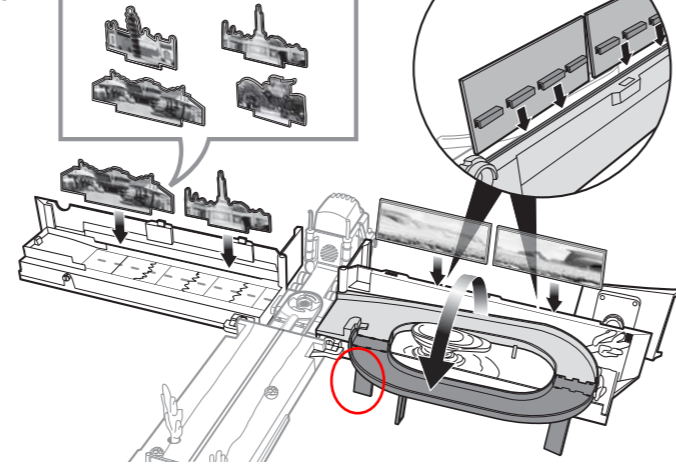

5.

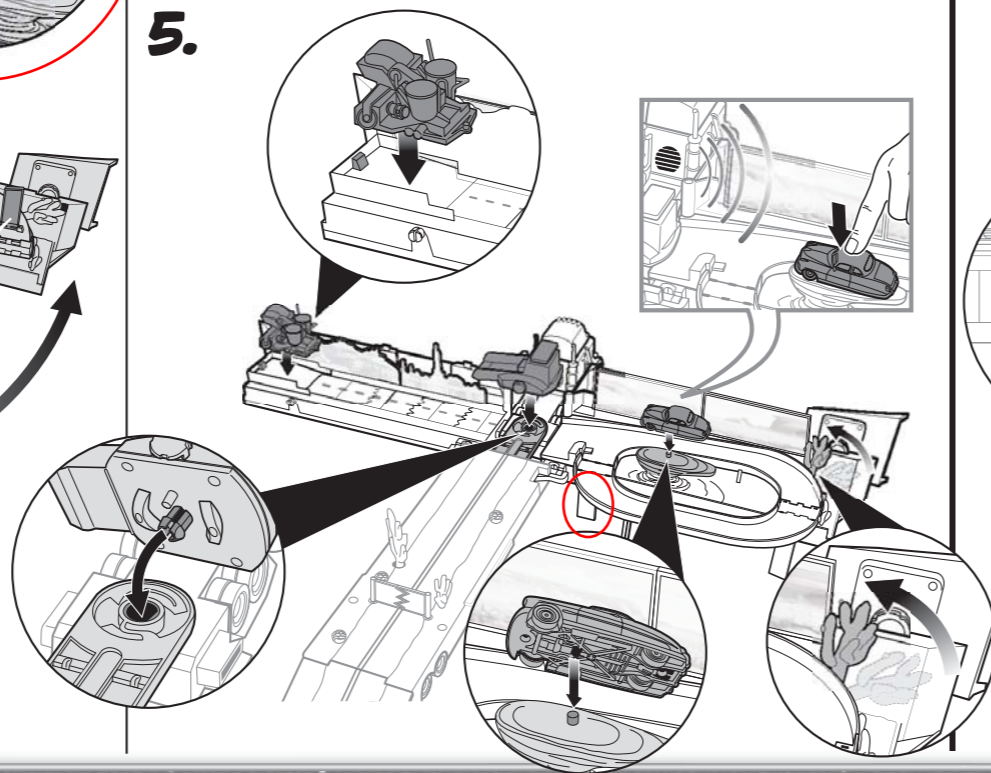

To Play 1

1. FIX THE ROAD WITH BESSIE!

Load Lightning McQueen in the launcher (A). Press the button to launch him down the road (B). Watch the road crack!

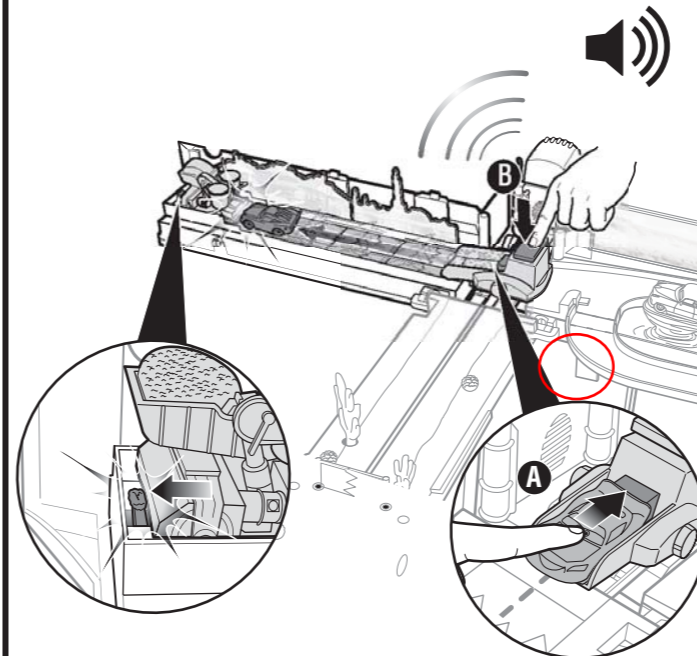

2.

Hitch Lightning McQueen up to Bessie (A). Pull Bessie and watch as Lightning McQueen fixes the road with a little help from Bessie.

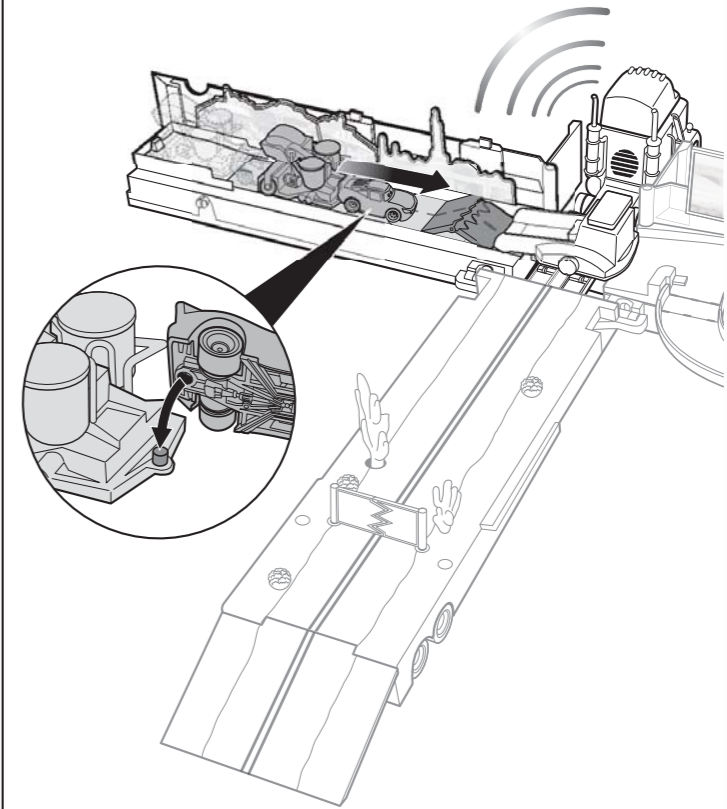

To Play 2

RACE WITH LIGHTNING MCQUEEN TO THE PISTON CUP!

1. Swivel the launcher to the middle lane (A). Load Lightning McQueen (B). Press the button (C) to launch Lightning McQueen towards the Piston Cup.

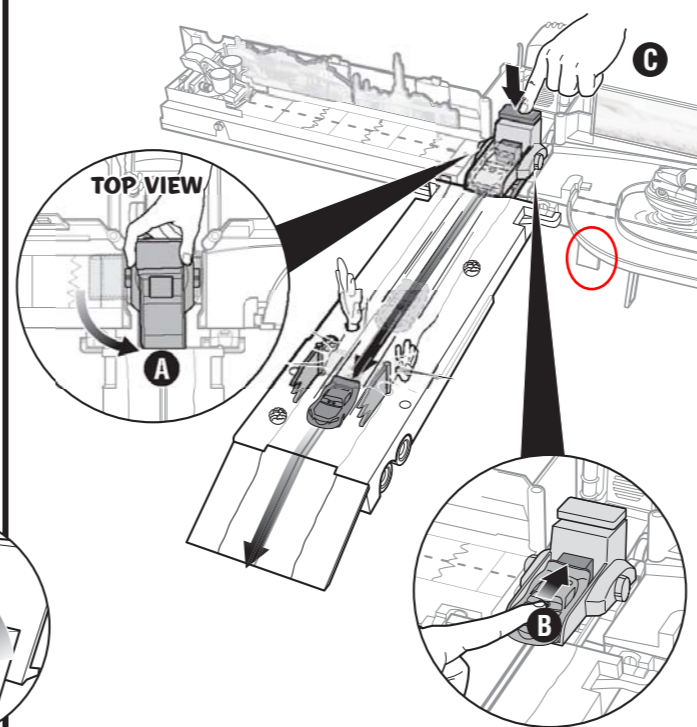

2.

Swivel the launcher (A). Load Lightning McQueen (B) and aim for the collapsing cactus. Press the button (C) and watch him go!

