

Fisher-Price®



Please keep this instruction sheet for future reference, as it contains important information.

Requires three "D" (LR20) **alkaline** batteries for mobile and two "AAA" (LR03) **alkaline** batteries for remote (batteries not included) operation.

Adult assembly is required.

Tool required for assembly:  
Phillips screwdriver (not included).

[www.fisher-price.com](http://www.fisher-price.com)

# Consumer Information

## WARNING

### Possible entanglement injury.

- Keep out of baby's reach.
  - Remove mobile portion of product from crib/cot or playpen when baby begins to push up on hands and knees.
  - This product will not attach to all crib/cot designs. Do not add additional strings or straps to attach to crib/cot or playpen.
- 
- The mobile portion of a product may be used from birth until 5 months.
  - The base portion of product may be used from birth until 36 months.
  - A crib/cot mobile is intended for visual stimulation and is not to be grasped by a child.
  - Always attach with all provided fasteners (clamp) tightly to a crib/cot or playpen according to the instructions. Check frequently.
  - Wipe this toy with a clean cloth dampened with a mild soap and water solution. Do not immerse this toy.
  - This toy has no consumer serviceable parts. Do not take this toy apart.



## CONSUMER ASSISTANCE

Call toll free: 1-800-432-5437 (US & Canada only)  
M-F 9AM to 7PM / SAT 11AM to 5PM (EST)

 [service.fisher-price.com](http://service.fisher-price.com)

Write to us at: Fisher-Price® Consumer Relations,  
636 Girard Avenue, East Aurora, New York 14052.

Hearing-impaired consumers using TTY/TDD equipment,  
please call 1-800-382-7470.

For countries outside the United States:

Canada: Mattel Canada Inc., 6155 Freemont Blvd.,  
Mississauga, Ontario L5R 3W2; [www.service.mattel.com](http://www.service.mattel.com).

Great Britain: Mattel UK Ltd, Vanwall Business Park,  
Maidenhead SL6 4UB. Helpline: 01628 500303.  
[www.service.mattel.com/uk](http://www.service.mattel.com/uk)

Australia: Mattel Australia Pty. Ltd., 658 Church Street,  
Locked Bag #870, Richmond, Victoria 3121 Australia.  
Consumer Advisory Service 1300 135 312.

New Zealand: 16-18 William Pickering Drive,  
Albany 1331, Auckland.

Asia: Mattel East Asia Ltd, Room 1106, South Tower,  
World Finance Centre, Harbour City, Tsimshatsui, HK, China.

# Parts



Base

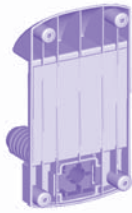

Crib/Cot Adaptor



3 Soft Stars

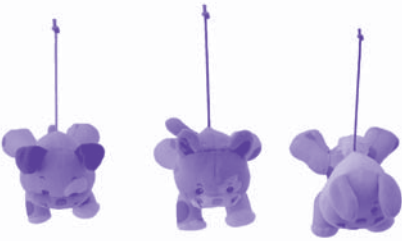

3 Soft Animals



Clamp



Arm

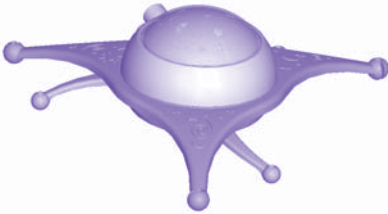

Mobile Hub



Remote

**Note:** All of the screws used to assemble this toy are located in the product. Follow these instructions carefully to fully secure the screws. Tighten and loosen all screws with a Phillips screwdriver. Do not over-tighten.

## Base Battery Installation

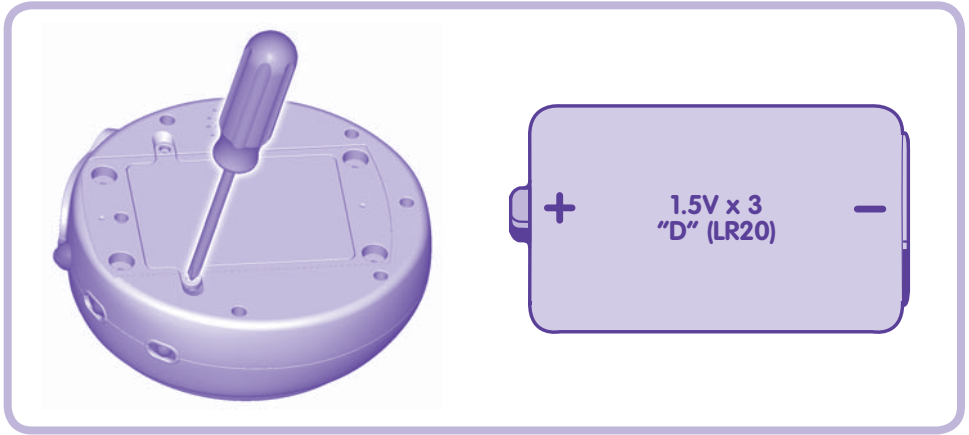

- Locate the battery compartment on the back of the base.
  - Loosen the screws in the battery compartment door and lift to remove it.  
*Hint: If the crib/cot adaptor is attached to the base, loosen the screws in the crib/cot adaptor and remove it first.*
  - Insert three "D" (LR20) **alkaline** batteries.  
*Hint: We recommend using **alkaline** batteries for longer battery life.*
  - Replace the battery compartment door and tighten the screws.
- IMPORTANT!** Under normal use conditions, the batteries in the base will require replacement more often than the batteries in the remote. When sounds or light become faint or movement of the mobile is sluggish, it's time for an adult to replace the batteries in the base.

## Remote Battery Installation

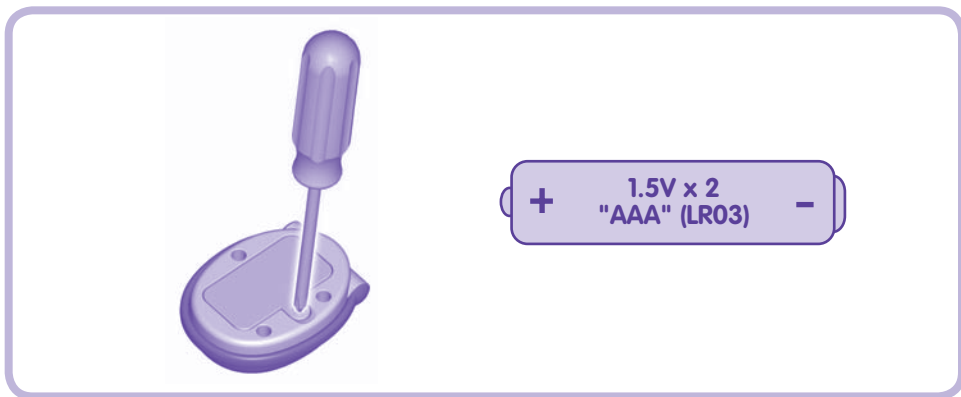

- Locate the battery compartment on the back of the remote.
- Loosen the screw in the battery compartment door and lift to remove it.
- Insert two "AAA" (LR03) **alkaline** batteries.

*Hint: We recommend using **alkaline** batteries for longer battery life.*

- Replace the battery compartment door and tighten the screw.

**IMPORTANT!** If the mobile does not respond to the remote, it does not mean that the battery power in the remote is low. Replace the batteries in the remote if the LED signal indicator on the remote is dim when the button is pressed. If the LED signal indicator does not light after installing new batteries in the remote, check the orientation of the batteries in the battery compartment to make sure they are properly installed.



- Protect the environment by not disposing of this product with household waste (2002/96/EC). Check your local authority for recycling advice and facilities (Europe only).

# Battery Safety Information

**In exceptional circumstances, batteries may leak fluids that can cause a chemical burn injury or ruin your product. To avoid battery leakage:**

- Do not mix old and new batteries or batteries of different types: alkaline, standard (carbon-zinc) or rechargeable (nickel-cadmium).
- Insert batteries as indicated inside the battery compartment.
- Remove batteries during long periods of non-use. Always remove exhausted batteries from the product. Dispose of batteries safely. Do not dispose of product in a fire. The batteries inside may explode or leak.
- Never short-circuit the battery terminals.
- Use only batteries of the same or equivalent type, as recommended.
- Do not charge non-rechargeable batteries.
- Remove rechargeable batteries from the product before charging.
- If removable, rechargeable batteries are used, they are only to be charged under adult supervision.

## FCC Statement

### United States Only

This equipment has been tested and found to comply with the limits for a Class B digital device, pursuant to Part 15 of the FCC Rules. These limits are designed to provide reasonable protection against harmful interference in a residential installation. This equipment generates, uses and can radiate radio frequency energy and, if not installed and used in accordance with the instructions, may cause harmful interference to radio communications. However, there is no guarantee that interference will not occur in a particular installation. If this equipment does cause harmful interference to radio or television reception, which can be determined by turning the equipment off and on, the user is encouraged to try to correct the interference by one or more of the following measures:

- Reorient or relocate the receiving antenna.
- Increase the separation between the equipment and receiver.
- Consult the dealer or an experienced radio/TV technician for help.

Note: Changes or modifications not expressly approved by the manufacturer responsible for compliance could void the user's authority to operate the equipment.

# Assembly

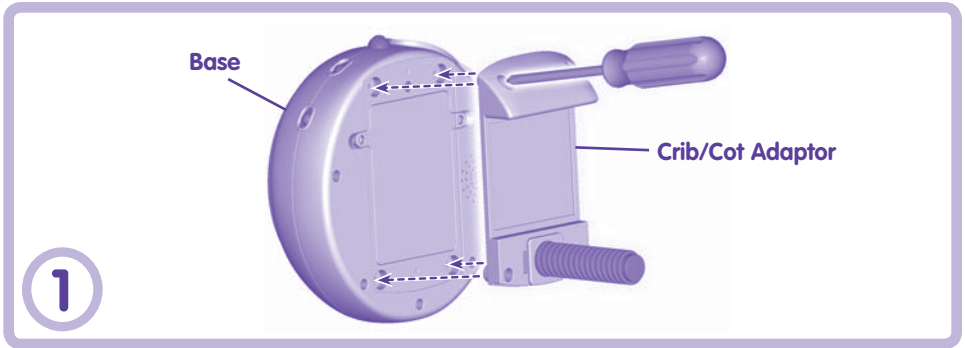

- Fit the crib/cot adaptor to the base.
- Tighten all four screws in the crib/cot adaptor.

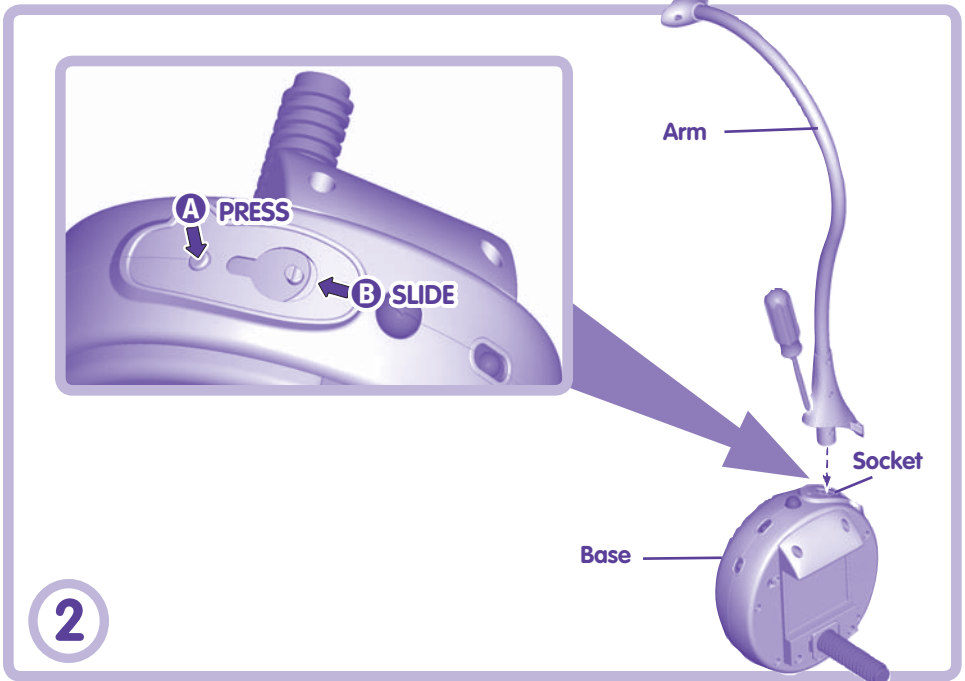

- First press the button next to the socket **A** and then slide the socket door open **B**.
- Fit the arm into the socket in the base.
- Tighten both screws in the arm.

# Assembly

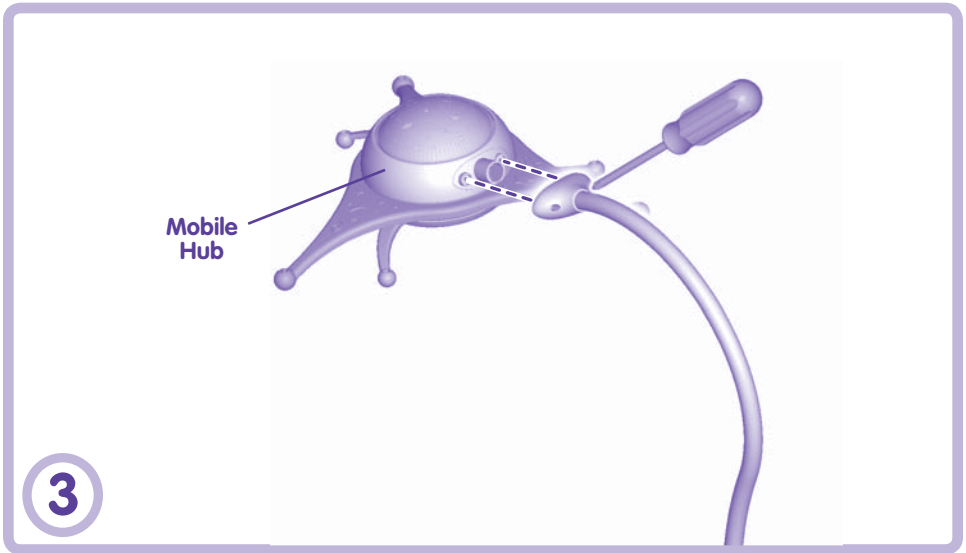

3

- Fit the mobile hub onto the end of the arm.
- Tighten both screws in the arm to secure the mobile hub.

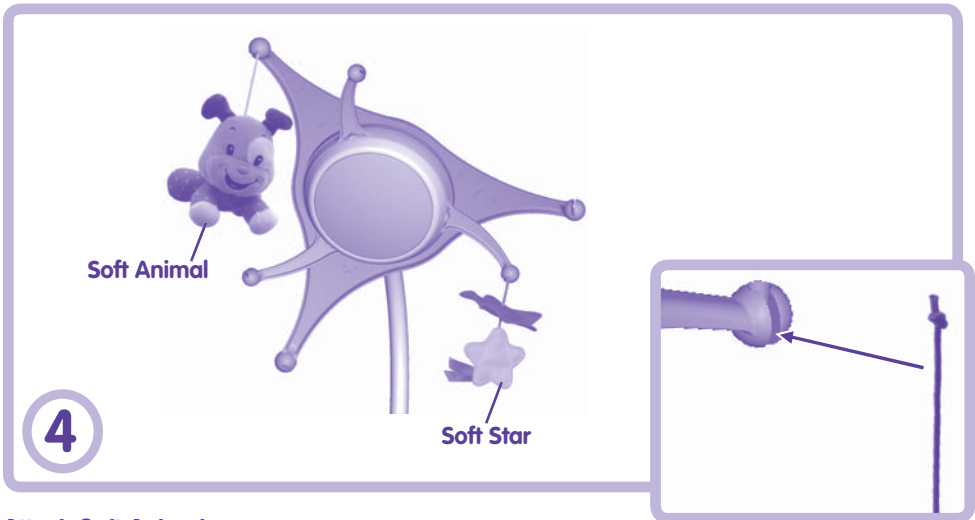

4

## Attach Soft Animals

- Fit the string on a soft animal through the slot in the end of outer spoke (larger).
- Pull down gently on the soft animal to secure the string in the outer spoke.
- Repeat this procedure to attach the remaining soft animals to the other two outer spokes.

## Attach Soft Stars

- Fit the string on a soft star through the slot in the end of inner spoke (smaller).
- Pull down gently on the soft star to secure the string in the inner spoke.
- Repeat this procedure to attach the remaining soft stars to the other two inner spokes.



# Crib/Cot Attachment

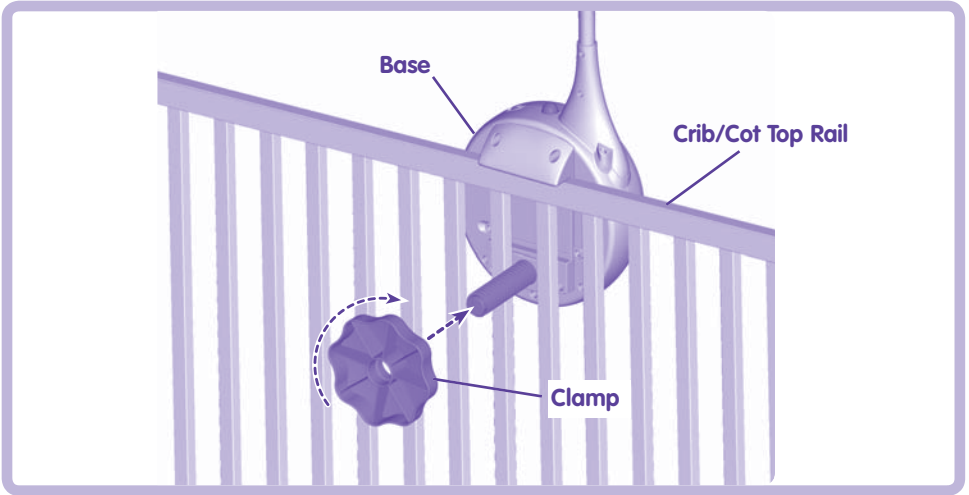

- Fit the base onto the crib/cot top rail, so that the threaded peg extends outside the crib/cot.
- Fit the clamp onto the threaded peg and turn the clamp clockwise to secure the base to the crib/cot. Do not over-tighten the clamp.

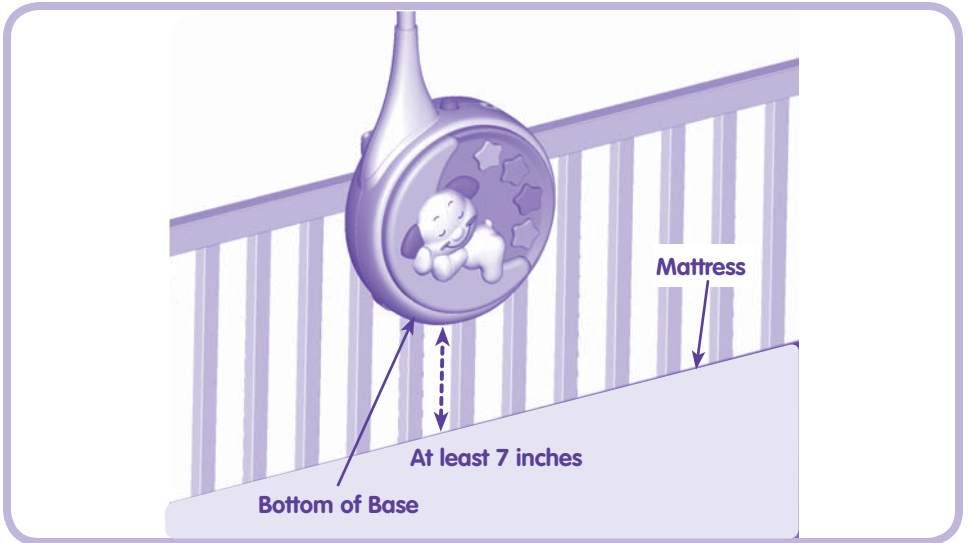

- If the distance between the base and the mattress is less than 7 inches (18 cm), lower the crib/cot mattress.

# Use

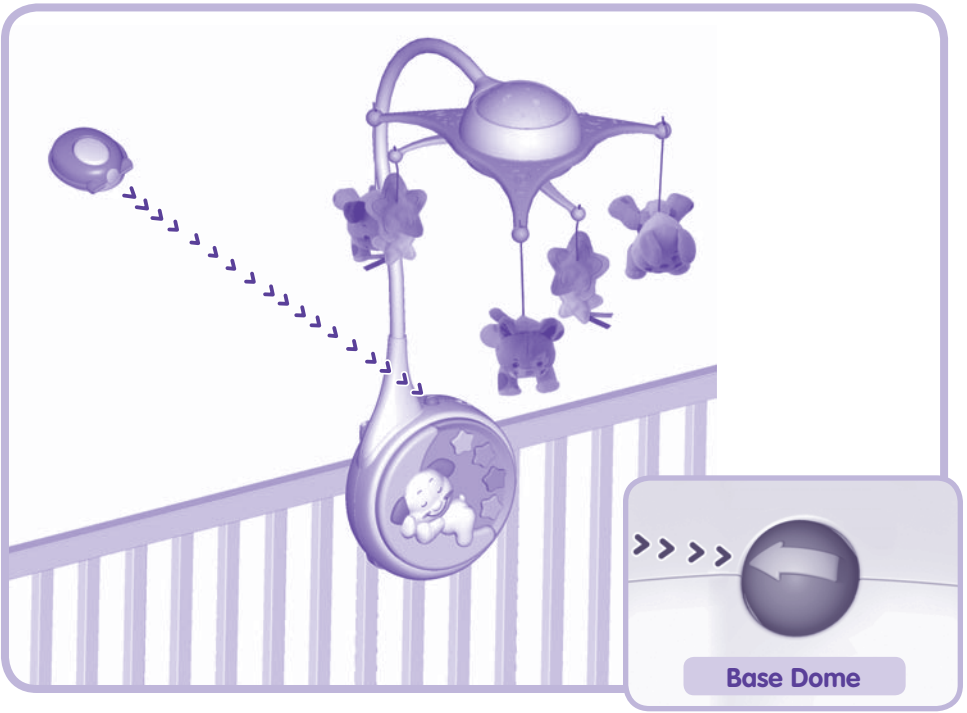

- When using the remote, make sure that the arrow on the base dome is pointing towards the transmitter window on the remote. **For best results, make sure the path between the transmitter window on the remote and the dome on the base are in a direct line and free of obstacles. Rotate the base dome so that the arrow points to the area from which you're most likely to use the remote.** For example, if you'll most often be using the remote from the doorway of the nursery, make sure that the arrow on the base dome is pointing towards the doorway and that the path between the base dome and the doorway is free from obstructions.

## IMPORTANT!

- In the unlikely event that use of the remote interferes with normal use of other remote controlled equipment, such as televisions and stereos, or use of other electric or battery powered appliances interfere with operation of the mobile, do not use both appliances at the same time.
- For best performance between the base and the remote, avoid using the remote in areas of bright light. In bright natural or artificial light, you may notice loss of range. Move the base or otherwise reduce the amount of light to improve performance.





# Classical Music, Soothing Lullabies, Lights and Motion

## Dome/Lights Control Button

Press this button  to turn the soothing night light on. Press again to turn the night light off.







**Hint:** Be sure the power/volume switch is set to an on position.

## Power/Volume Switch

Choose from four settings: off ; on with low volume ; on with medium volume ; or on with high volume .

## Mode Select Switch

Slide the switch to select one of three modes:

-    Music, motion and projected lights
-   Music and motion
-  Music only

## Music Select Buttons

Choose classical music from Bach, Mozart, Beethoven or soothing lullabies.



- Press the button on the remote to activate music, lights and motion. Press again to stop.

**Note:** The remote will remain active for about one hour. After an hour, you will need to slide the power/volume switch on the mobile off, then on again to reactivate.

## Convert to a Night Light

Remove the mobile and use as a music box with a night light!

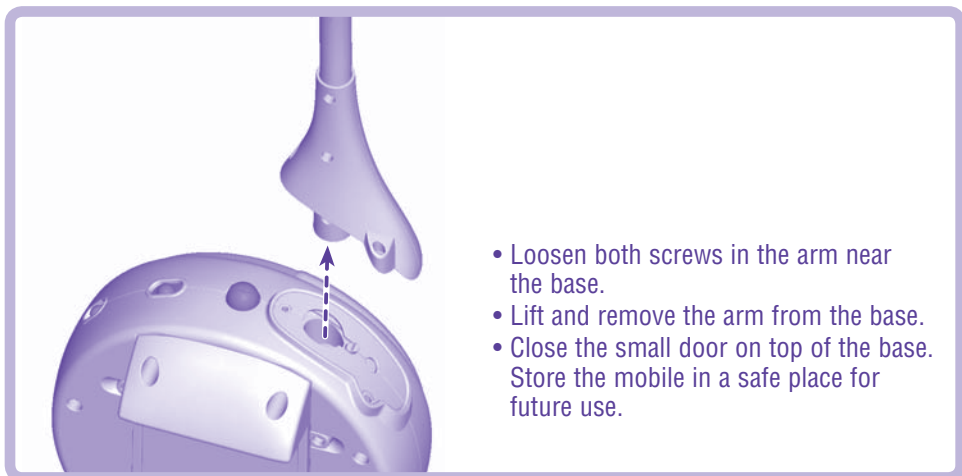

- Loosen both screws in the arm near the base.
- Lift and remove the arm from the base.
- Close the small door on top of the base. Store the mobile in a safe place for future use.