

# Fisher-Price®

Please keep this instruction sheet for future reference, as it contains important information.

Adult assembly is required to install batteries.

Tool needed for battery installation:  
Phillips screwdriver  
(not included).

Requires three "AA" batteries (included) for operation.



[www.fisher-price.com](http://www.fisher-price.com)

## Consumer Information

### **WARNING**

To prevent child from climbing out of a crib/cot, remove this product from crib/cot once child can sit up unassisted or can pull to a standing position.

- Always attach all provided fasteners (strings, straps, clamps, etc.) tightly to a crib/cot or playpen according to the instructions. Check frequently.
- Do not add additional strings or straps to attach to crib/cot or playpen.



### **CONSUMER ASSISTANCE**

Call toll free: 1-800-432-5437 (US & Canada only)  
M-F 9AM to 7PM / SAT 11AM to 5PM (EST)

 **service.fisher-price.com**

Write to us at: Fisher-Price® Consumer Relations,  
636 Girard Avenue, East Aurora, New York 14052.

Hearing-impaired consumers using TTY/TDD equipment,  
please call 1-800-382-7470.

---

For countries outside the United States:

Canada: Mattel Canada Inc., 6155 Freemont Blvd.,  
Mississauga, Ontario L5R 3W2; [www.service.mattel.com](http://www.service.mattel.com).

Great Britain: [Mattel UK Ltd, Vanwall Business Park,  
Maidenhead SL6 4UB. Helpline: 01628 500303,  
\[www.service.mattel.com/uk\]\(http://www.service.mattel.com/uk\)](http://www.service.mattel.com/uk)

Australia: Mattel Australia Pty. Ltd., 658 Church Street,  
Locked Bag #870, Richmond, Victoria 3121 Australia.  
Consumer Advisory Service 1300 135 312.

New Zealand: 16-18 William Pickering Drive,  
Albany 1331, Auckland.

Asia: Mattel East Asia Ltd, Room 1106, South Tower,  
World Finance Centre, Harbour City, Tsimshatsui, HK, China.

## Attaching to a Crib/Cot

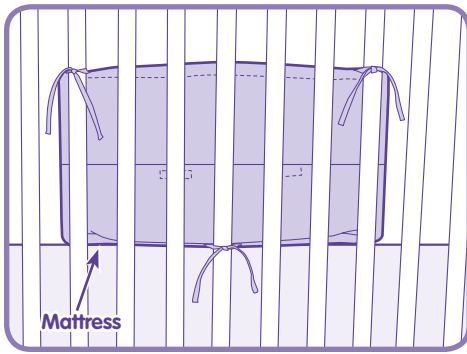

- Position this toy against the rails (on the inside of baby's crib/cot) near the mattress.

**Hint:** For newborns, place this toy along a side rail where baby can easily hear and see it. For infants, place this toy near baby's feet (within reach).

**Note:** It is better to tie the straps in a knot than a bow, since a bow may be easily untied.

- Tie each fastener to fit snugly around a crib/cot rail.

# Play Time!

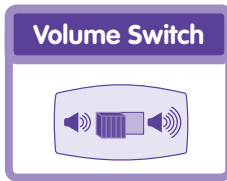
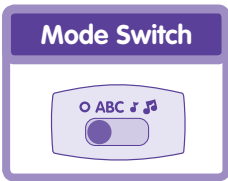

- Slide the mode switch to: **Learn ABC**, **Short Tune** 🎵, **Music** 🎵 or **Off** ○.
- When baby kicks or presses the pig, cow or chick's feet:
  - ABC** Listen to a fun sound, song or farm animal identified.
  - 🎵 Baby enjoys a short tune.
  - 🎵 Sing-along to original songs.
- Hint:** Baby enjoys an oink-oink, moo-moo or peep-peep with each kick in Short Tune or Music modes!*
- Adjust the volume to high 🔊 or low 🔊 for your child's comfort. The volume switch is located on the back of the toy. Simply open the fasteners to access the switch.
- Remove the toy from the crib/cot to extend play as baby grows!

## Battery Replacement

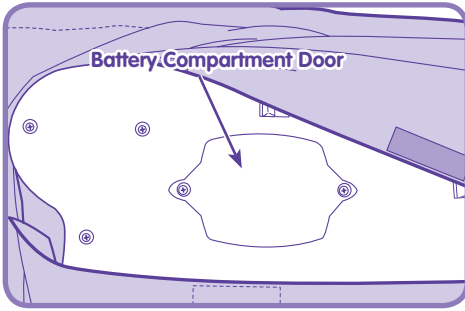

**For best performance, we recommend that you replace batteries that came with this toy with three, new "AA" (LR6) alkaline batteries.**

- Open the fasteners on the fabric cover on the back of the toy.
- Loosen the screws in the battery compartment door with a Phillips screwdriver. Remove the battery compartment door.

**Hint:** You may need to use the tip of the screwdriver to lift the battery compartment door.

- Remove the worn batteries and dispose of them properly.
- Insert three "AA" (LR6) **alkaline** batteries.

**Hint:** We recommend using **alkaline** batteries for longer battery life.

- Replace the battery compartment door and tighten the screws with a Phillips screwdriver. Do not over-tighten.
- Press to secure the fasteners on the fabric cover.
- When sounds or lights become faint or stop, it's time for an adult to change the batteries!



- Protect the environment by not disposing of this product with household waste (2002/96/EC). Check your local authority for recycling advice and facilities (Europe only).

## Battery Safety

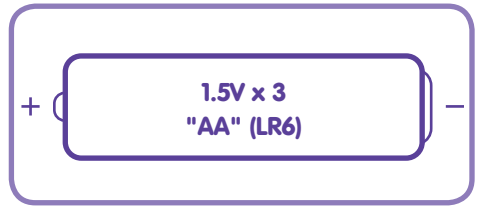

In exceptional circumstances, batteries may leak fluids that can cause a chemical burn injury or ruin your toy. To avoid battery leakage:

- Do not mix old and new batteries or batteries of different types: alkaline, standard (carbon-zinc) or rechargeable (nickel-cadmium).
- Insert batteries as indicated inside the battery compartment.
- Remove batteries during long periods of non-use. Always remove exhausted batteries from the toy. Dispose of batteries safely. Do not dispose of the product in a fire. The batteries inside may explode or leak.
- Never short-circuit the battery terminals.
- Use only batteries of the same or equivalent type, as recommended.
- Do not charge non-rechargeable batteries.
- Remove rechargeable batteries from the toy before charging.
- If removable, rechargeable batteries are used, they are only to be charged under adult supervision.

## Care

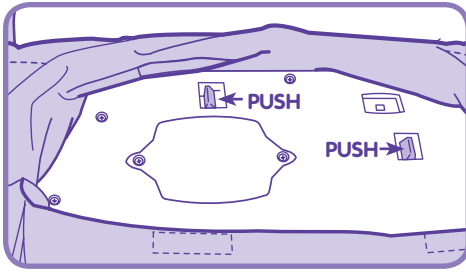

- Hand wash the fabric cover in cold water with a mild detergent. Do not use bleach. Line dry. Do not machine wash or place in a dryer.
- Surface clean the plastic toy by wiping it with a damp cloth. Do not immerse the plastic toy.
- To remove the fabric cover, open the fasteners on the back of the toy. Push both tabs, one at a time, toward the unlock position . At the same time, pull the plug(s) on the fabric cover from the front of the plastic toy. Remove the fabric cover.
- To replace the cover, first place the plastic toy into the fabric cover. Then, fit and snap the plugs (one at a time) on the fabric cover into the slots in the plastic toy. You should hear a "click". Pull gently on the fabric cover to be sure it is attached to the plastic toy.
- Press to secure the fasteners on the back of the toy.

## FCC Statement

### United States Only

This equipment has been tested and found to comply with the limits for a Class B digital device, pursuant to Part 15 of the FCC Rules. These limits are designed to provide reasonable protection against harmful interference in a residential installation.

This equipment generates, uses and can radiate radio frequency energy and, if not installed and used in accordance with the instructions, may cause harmful interference to radio communications. However, there is no guarantee that interference will not occur in a particular installation. If this equipment does cause harmful interference to radio or television reception, which can be determined by turning the equipment off and on, the user is encouraged to try to correct the interference by one or more of the following measures:

- Reorient or relocate the receiving antenna.
- Increase the separation between the equipment and receiver.
- Consult the dealer or an experienced radio/TV technician for help.

Note: Changes or modifications not expressly approved by the manufacturer responsible for compliance could void the user's authority to operate the equipment.