



Overhead Gym

**Tummy Time
Fun**



Sit & Play

Consumer Information



WARNING

Prevent Entanglement Injury

Never place gym in a crib or playpen. Never add strings, ties or other products to the gym.

- Please keep this instruction sheet for future reference, as it contains important information.
- Requires three “AA” (LR6) **alkaline** batteries for operation (not included).
- Tool required for battery installation: Phillips screwdriver (not included).

ICES-003

This Class B digital apparatus complies with Canadian ICES-003.

Operation is subject to the following two conditions: (1) this device may not cause harmful interference and (2) this device must accept any interference received, including interference that may cause undesired operation.

NMB-003

Cet appareil numérique de la classe B est conforme à la norme NMB-003 du Canada.

L'utilisation de ce dispositif est autorisée seulement aux conditions suivantes : (1) il ne doit pas produire de brouillage et (2) l'utilisateur du dispositif doit être prêt à accepter tout brouillage radioélectrique reçu, même si ce brouillage est susceptible de compromettre le fonctionnement du dispositif.

FCC Statement (United States Only)

This equipment has been tested and found to comply with the limits for a Class B digital device, pursuant to Part 15 of the FCC Rules. These limits are designed to provide reasonable protection against harmful interference in a residential installation. This equipment generates, uses and can radiate radio frequency energy and, if not installed and used in accordance with the instructions, may cause harmful interference to radio communications. However, there is no guarantee that interference will not occur in a particular installation. If this equipment does cause harmful interference to radio or television reception, which can be determined by turning the equipment off and on, the user is encouraged to try to correct the interference by one or more of the following measures:

- Reorient or relocate the receiving antenna.
- Increase the separation between the equipment and receiver.
- Consult the dealer or an experienced radio/TV technician for help.

Note: Changes or modifications not expressly approved by the manufacturer responsible for compliance could void the user's authority to operate the equipment.

This device complies with Part 15 of the FCC Rules.

Operation is subject to the following two conditions: (1) this device may not cause harmful interference and (2) this device must accept any interference received, including interference that may cause undesired operation.

Assembled Parts

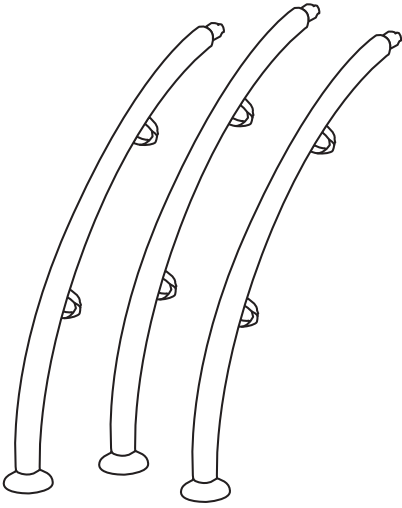

3 Tubes

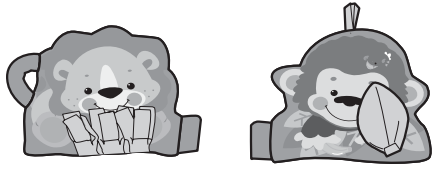

2 Animal Panels



Hub



Bear Toy

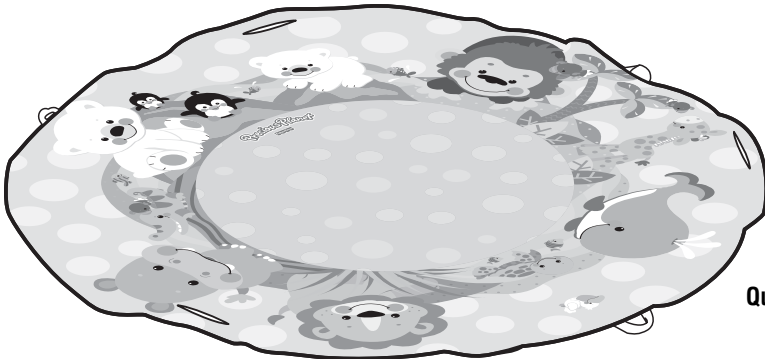

Quilt

Battery Installation

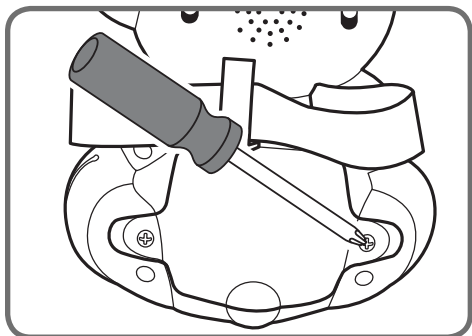

- Locate the battery compartment door on the back of the bear toy.
- Loosen the screws in the battery compartment door with a Phillips screwdriver. Remove the battery compartment door.

• Insert three “AA” (LR6) **alkaline** batteries.

Hint: We recommend using **alkaline** batteries for longer battery life.

- Replace the battery compartment door and tighten the screws with a Phillips screwdriver. Do not over-tighten.
- If this toy begins to operate erratically, you may need to reset the electronics. Slide the power/volume switch off and then back on.
- When sounds from this toy become faint or stop, it’s time for an adult to change the batteries.



- Protect the environment by not disposing of this product with household waste (2002/96/EC). Check your local authority for recycling advice and facilities (Europe only).

Battery Safety Information

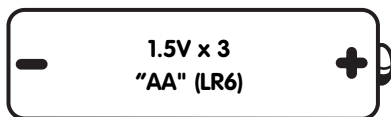

In exceptional circumstances, batteries may leak fluids that can cause a chemical burn injury or ruin your product. To avoid battery leakage:

- Do not mix old and new batteries or batteries of different types: alkaline, standard (carbon-zinc) or rechargeable (nickel-cadmium).
- Insert batteries as indicated inside the battery compartment.
- Remove batteries during long periods of non-use. Always remove exhausted batteries from the product. Dispose of batteries safely. Do not dispose of product in a fire. The batteries inside may explode or leak.
- Never short-circuit the battery terminals.
- Use only batteries of the same or equivalent type, as recommended.
- Do not charge non-rechargeable batteries.
- Remove rechargeable batteries from the product before charging.
- If removable, rechargeable batteries are used, they are only to be charged under adult supervision.

Setup

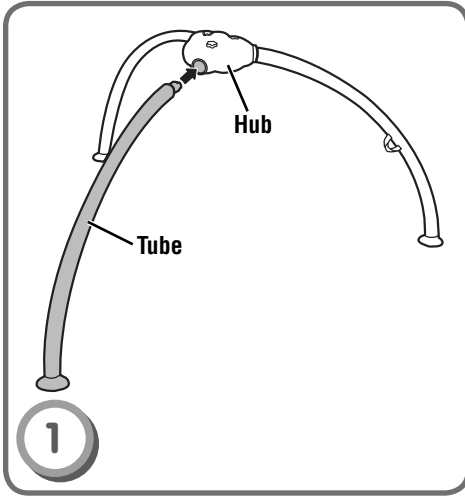

- Insert and snap the tubes into the hub.

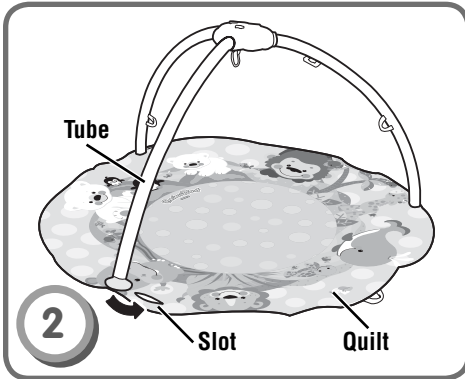

- Lay the quilt out on a flat surface with the decorated side up.
- Insert the end of each tube into the slots in the quilt.

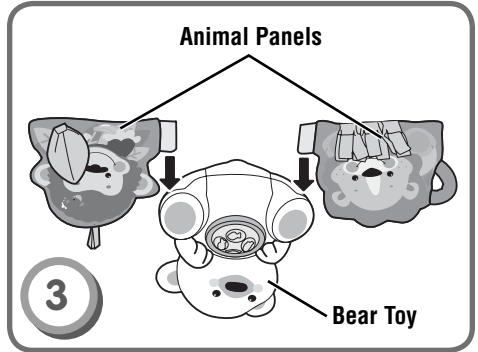

- Turn the bear toy upside down. Then, slide the tab on the animal panels into the slot on each side of the bear toy.

Hint: Each animal panel only fits one way. If it does not seem to fit, try the other panel.

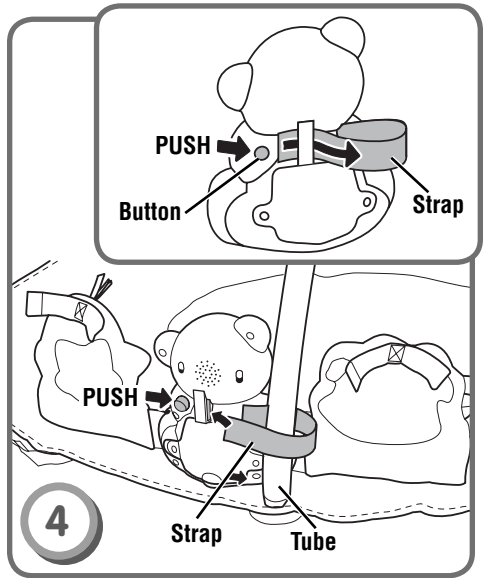

- To attach the bear toy to a tube, first push the button on the back of the bear toy and then pull the strap out of the slot.
- Wrap the strap around the tube.
- Push the button on the back of the bear toy and fit the strap back through the slot.

Musical Bear and Playtime Fun

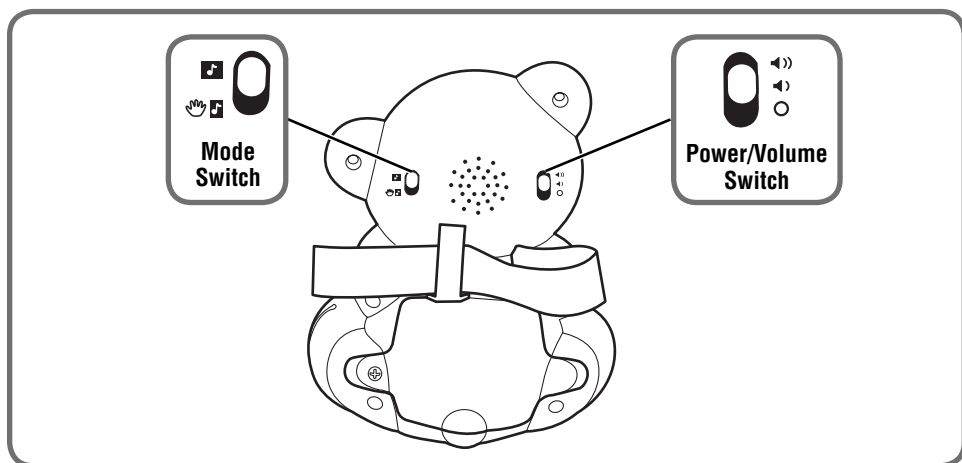

- Slide the power/volume switch on the bear toy to on with low volume ◀), or on with high volume ◀)).
- Slide the mode switch to short play or long play.
 - 🎵 **Long Play** – Sounds and music play for 20 minutes.
 - 👏🎵 **Short Play** – Tap the toy for sounds and music.



- Hang the toys from any of the loops around the gym.

Storage

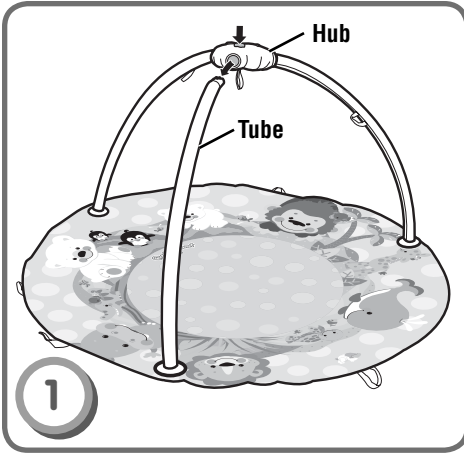

- Remove all the toys from the loops around the gym.
- Remove the lower end of each tube from the slots in the quilt.
- Push the button on top of the hub and remove each tube.

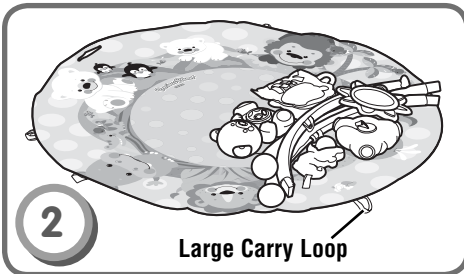

- Place the tubes, hub and toys towards the large carry loop on the quilt.

Hint: Make sure the ends of the tubes are facing the storage loop, as shown.

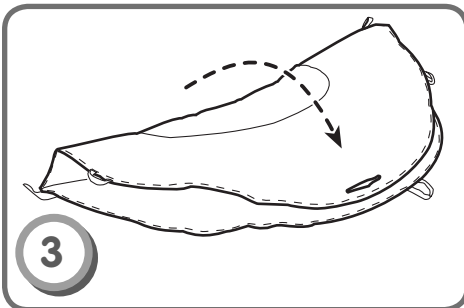

- Fold the quilt in half, as shown.

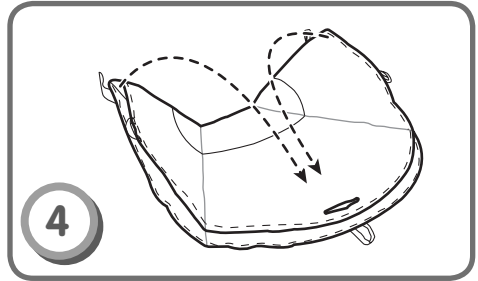

- Fold the sides of the quilt, as shown.

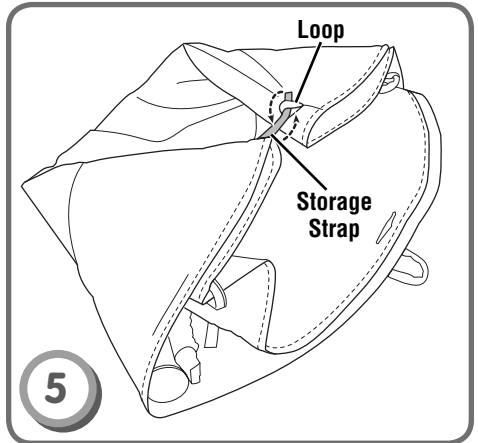

- Fit the storage strap through the loop, as shown. Fold the strap over to fasten it.

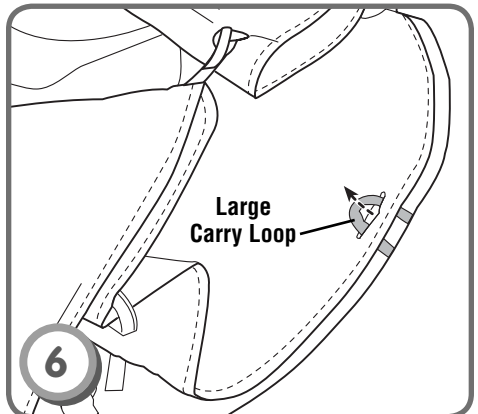

- Fit the large carry loop through the slot for easy carrying.



CONSUMER ASSISTANCE

Call toll free: 1-800-432-5437 (US & Canada only)
M-F 9AM to 7PM / SAT 11AM to 5PM (EST)



service.fisher-price.com

Write to us at: Fisher-Price® Consumer Relations,
636 Girard Avenue, East Aurora, New York 14052.

Hearing-impaired consumers using TTY/TDD equipment,
please call 1-800-382-7470.

For countries outside the United States:

Canada: Mattel Canada Inc., 6155 Freemont Blvd.,
Mississauga, Ontario L5R 3W2; www.service.mattel.com.

Great Britain: Mattel UK Ltd, Vanwall Business Park,
Maidenhead SL6 4UB, Helpline: 01628 500303,
www.service.mattel.com/uk

Australia: Mattel Australia Pty. Ltd., 658 Church Street,
Locked Bag #870, Richmond, Victoria 3121 Australia.
Consumer Advisory Service 1300 135 312.

New Zealand: 16-18 William Pickering Drive,
Albany 1331, Auckland.

Asia: Mattel East Asia Ltd, Room 1106, South Tower,
World Finance Centre, Harbour City, Tsimshatsui, HK, China.

Quilt

- Wash the quilt in cold water on the gentle cycle. Do not use bleach. Tumble dry low.

Tubes, Hub and Toys

- Wipe the surface with a clean cloth dampened with a mild soap and water solution. Do not use bleach.
- Do not immerse the bear toy.