

# Let's Play!

- 1) To color change: Dip puppy in icy cold water to reveal "mud" on puppy's face and (2) paws.

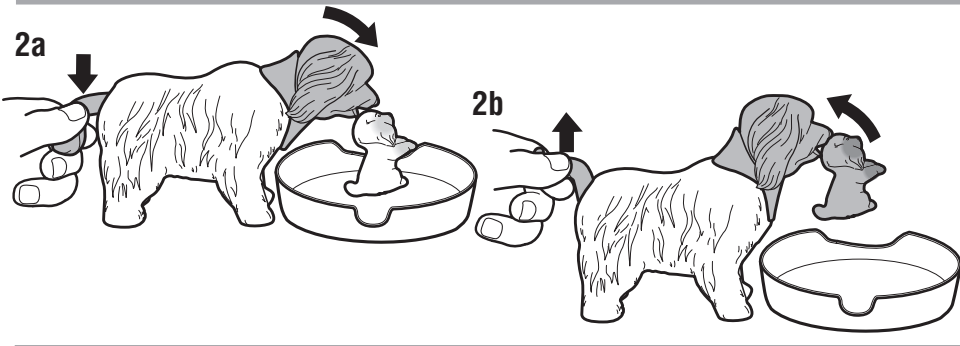

Color change by applying warm or cold water.



- 3) To release puppy, push dog's tail IN.



- 4) Fill the reservoir with warm, not hot, water. DO NOT use water that is too hot (above 43°C/110°F) to avoid burns.



- 5) Spray puppy with warm water to colour change back. Color change will last longer if you do not expose this toy to intense heat or direct sunlight for prolonged periods of time.



Dogs contain magnets. Do not use around items that are sensitive to or affected by magnetic fields.

# 3+ Barbie INSTRUCTIONS

T7036-0920



## CONTENTS

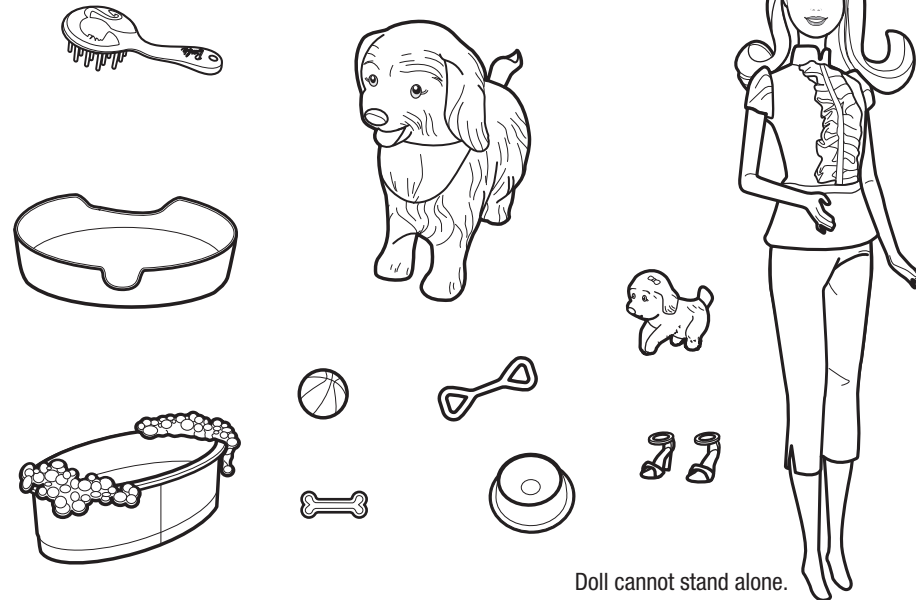

Water toys sometimes get messy. Protect play surfaces before use. Do not use on surfaces that can be damaged by water. Drain, rinse, clean, and dry all items thoroughly before storing.

**IMPORTANT:** Dog and Puppy contain magnets. Ball does not contain magnets.

**WARNING:**  
CHOKING HAZARD - Toy contains small balls and small parts. Not for children under 3 years.

Please remove everything from the package and compare to the contents shown here. If any items are missing, please contact your local Mattel office. Keep these instructions for future reference as they contain important information.

## CONSUMER INFORMATION

Need Assistance? Visit [service.mattel.com](http://service.mattel.com) or call 1-800-524-8697 (US and Canada only).

[SERVICE.MATTEL.COM](http://SERVICE.MATTEL.COM)

Mattel, Inc., 636 Girard Avenue, East Aurora, NY 14052, U.S.A. Consumer Relations 1-800-524-8697.  
 Mattel Canada Inc., Mississauga, Ontario L5R 3W2. You may call us free at 1-800-524-8697.  
 Mattel U.K. Ltd., Vanwall Business Park, Maidenhead SL6 4UB. Helpline 01628 500303.  
 Mattel Australia Pty., Ltd., Richmond, Victoria. 3121. Consumer Advisory Service - 1300 135 312 Mattel East Asia Ltd., Room 1106, South Tower, World Finance Centre, Harbour City, Tsimshatsui, HK, China.  
 Diimport & Diedarkan Oleh: Mattel SEA Ptd Ltd. (993532-P) Lot 13.5, 13th Floor, Menara Lien Hoe, Persiaran Tropicana Golf Country Resort, 47410 PJ. Tel:03-78803817, Fax:03-78803867.

© 2010 Mattel, Inc., El Segundo, CA 90245. All Rights Reserved.

## PANEL Folding Dummy

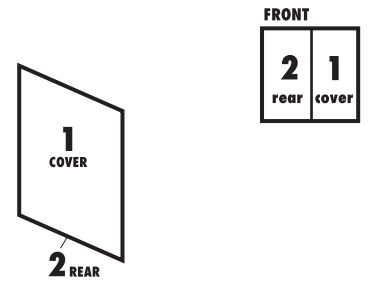

## INSTRUCTION SHEET SPECIFICATIONS

Toy: BRB CLEAN-UP PUP KM

Toy No.: T7036

Part No.: 0920

Trim Size: 11"X8.5"

Folded Size:

Type of Fold: 1 panel

# colors: One

Colors: Black

Paper Stock: White Offset

Paper Weight: 70 lb.

EDM No.:

BACK

FRONT