

BACK COLOR : 1G SIZE: W16 X H31 IN

SEE OTHER SIDE FOR STEPS 1-5

6 HANG TRACK ON WALL

Once brackets are mounted and TEMPLATE IS REMOVED FROM WALL, attach track pieces as shown.

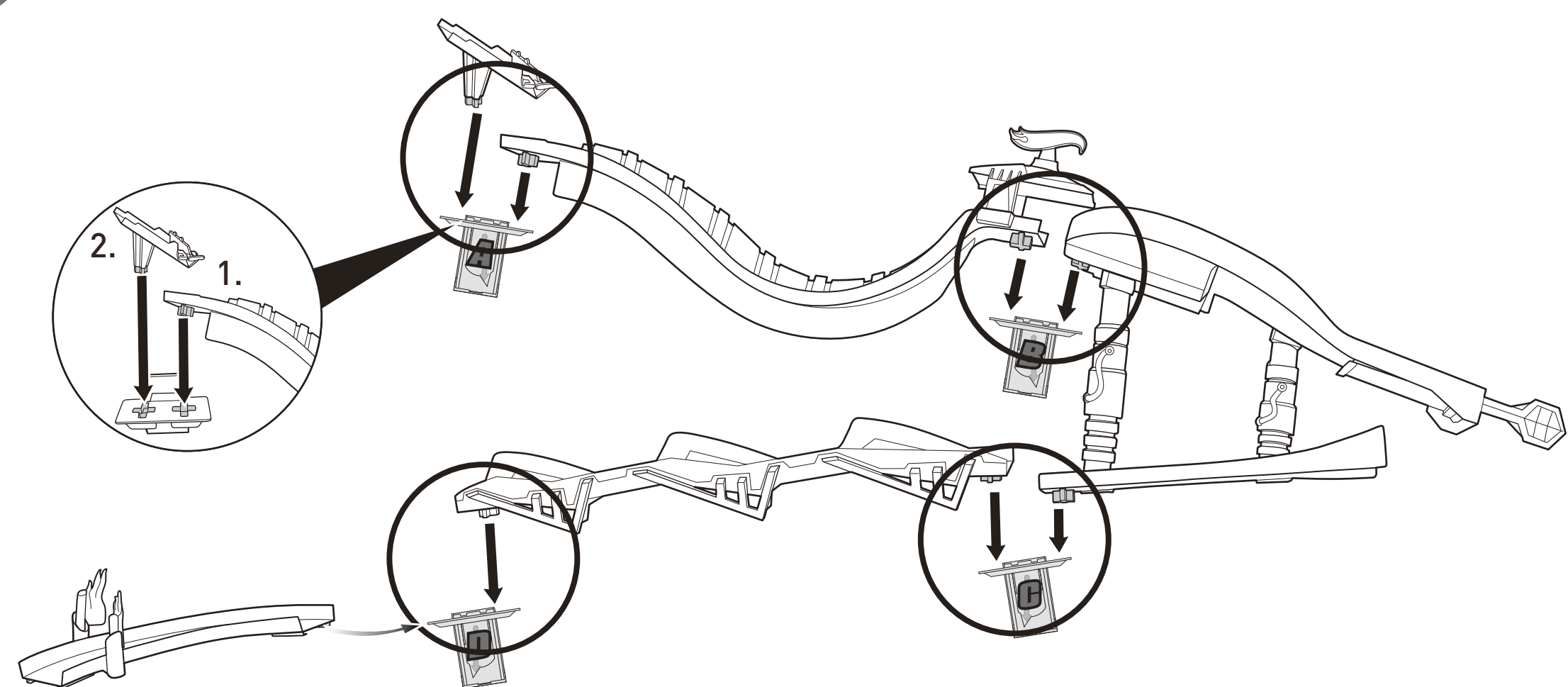

7 READY TO PLAY?

Load cars.

Open Gate to Launch!

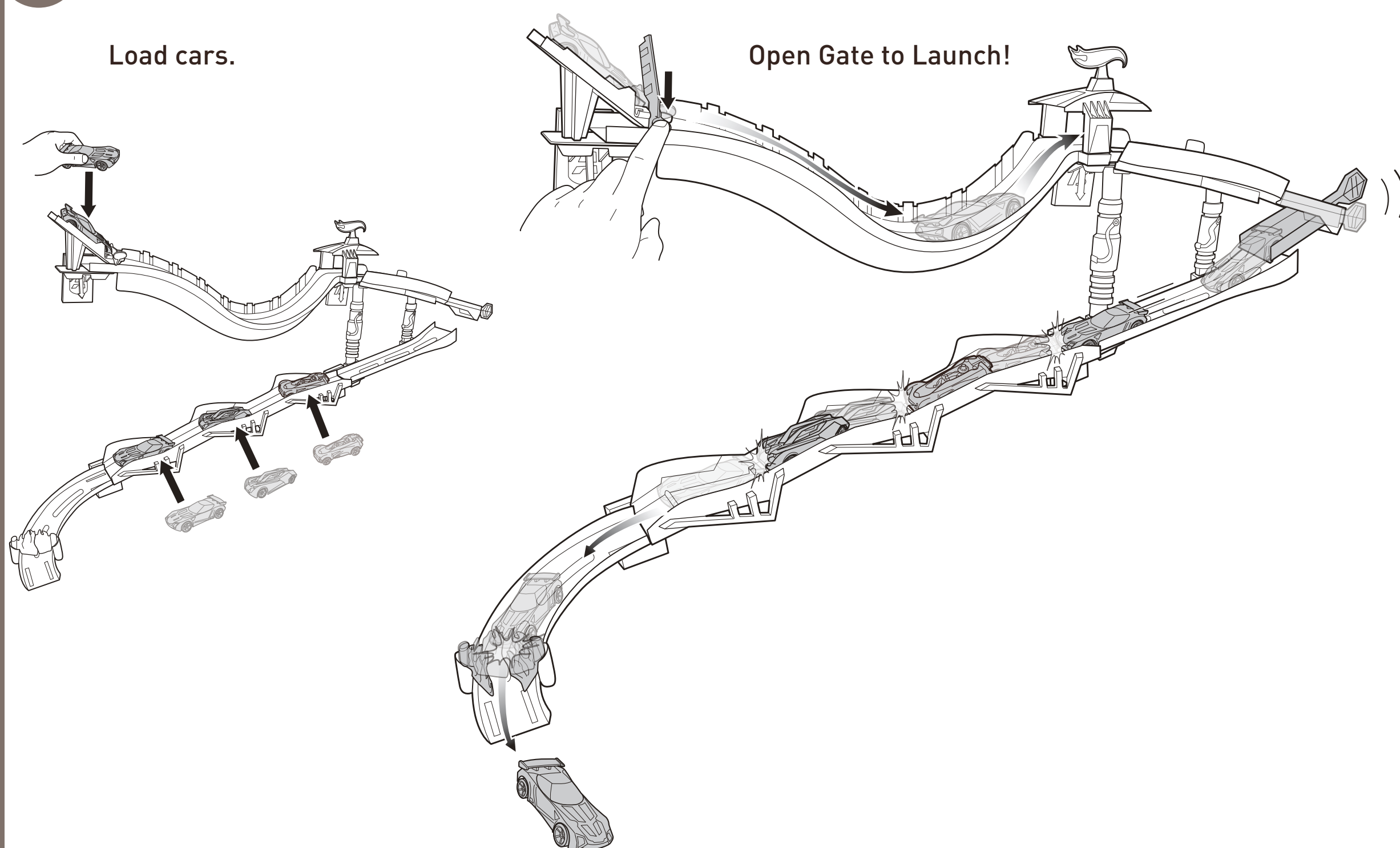

8 REATTACHING & REMOVAL

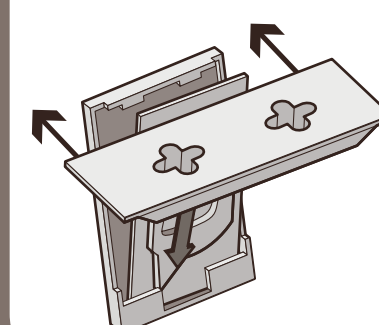

Mounting brackets are designed to break away from the set without causing surface damage. If mounting plate separates from bracket, snap bracket back into place.

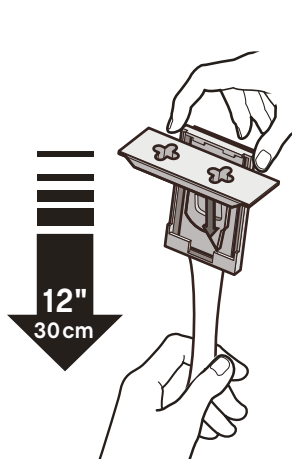

To remove brackets from the wall entirely:
1. NEVER pull strip towards you.
2. Hold bracket gently to prevent it from snapping fingers. DO NOT press against wall.
3. Grab tab on Command™ Strip and SLOWLY STRETCH STRAIGHT DOWN ALONG WALL AT LEAST 12 INCHES until bracket and strip release.
Purchase medium Command™ Refill Strips to reapply to your wall.

CONNECT

Create your own set-ups with other Wall Tracks™ sets.

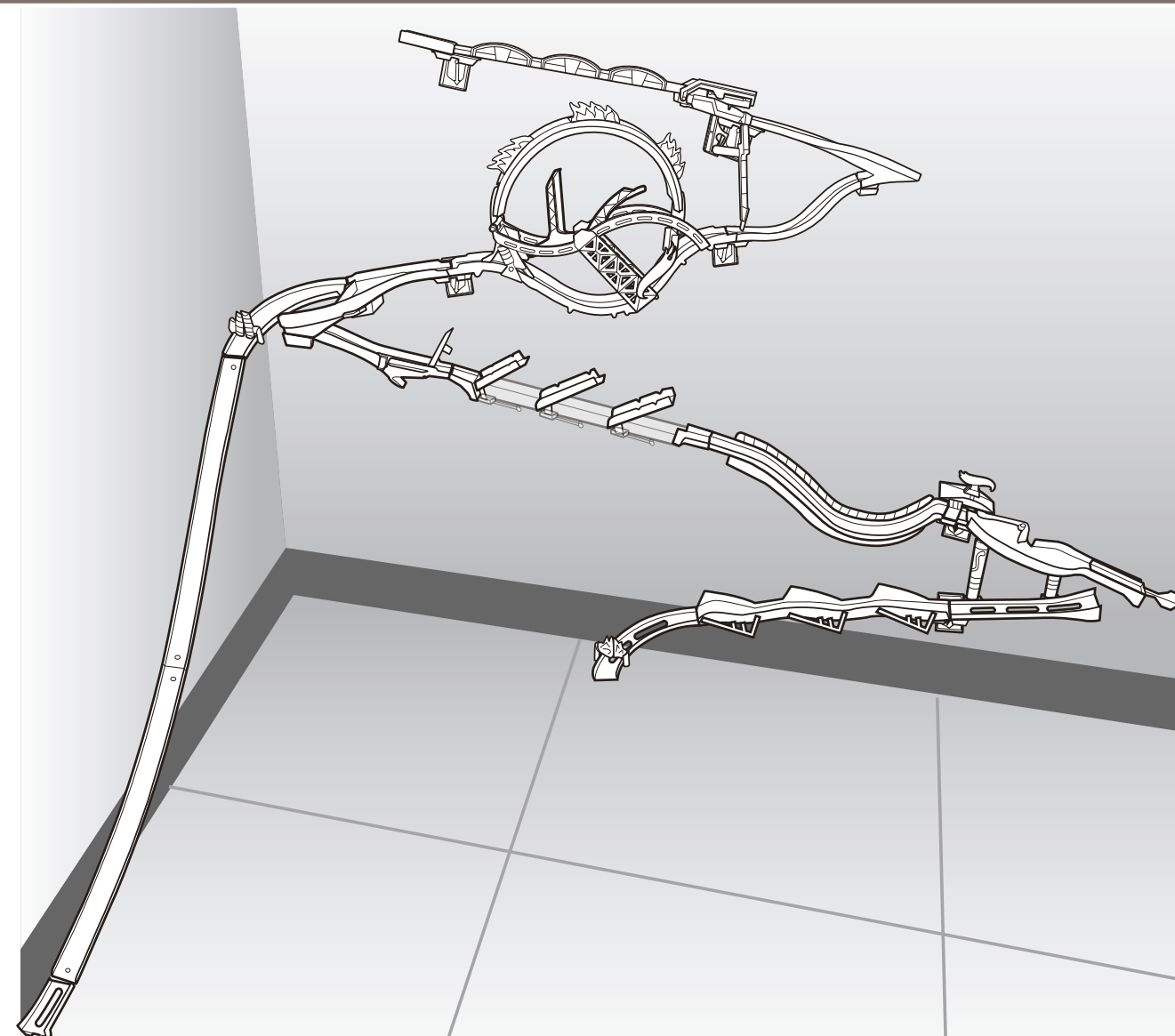

FRONT V1050 EL IS COLOR : 4C

LINE BOTTOM UP ALONG FLOOR



DRIFT RALLY SPINOUT™
HANGING TEMPLATE



Keep these instructions for future reference as they contain important information.

YOU WILL NEED:

- Low-adhesive tape such as painter's tape or masking tape
- Approximately 3 feet of open wall space
- 20 minutes

CONTENTS:

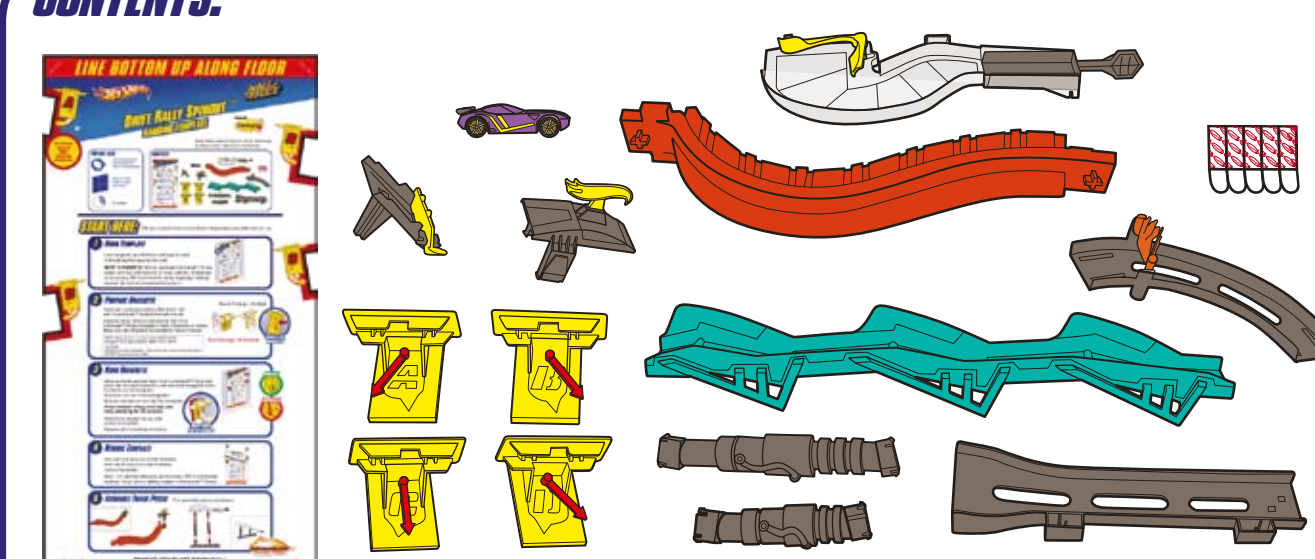

START HERE:

Please read all instructions before beginning assembly and set-up.

1 HANG TEMPLATE

Line template up with floor and tape to wall. It should lay flat against the wall.

NOTE TO PARENTS: Before applying Command™ Strips make sure the wall surface is clean and dry. If cleaning is necessary 3M recommends using isopropyl rubbing alcohol. Do not use household cleaners.



2 PREPARE BRACKETS

There are 4 yellow brackets [Marked A - D] and 5 Command™ Strips (one extra strip).

Separate strips. Remove red-printed liner from Command™ Strips and apply to back of brackets as shown. Make sure the strip tab is accessible for future removal.

NOTE: Apply strips to surfaces above 50°F (10°C). Adhesive could lose adhesion above 105°F (40°C).
CAUTION: DO NOT use with wallpaper. May not adhere well to vinyl surfaces. DO NOT hang items over beds.

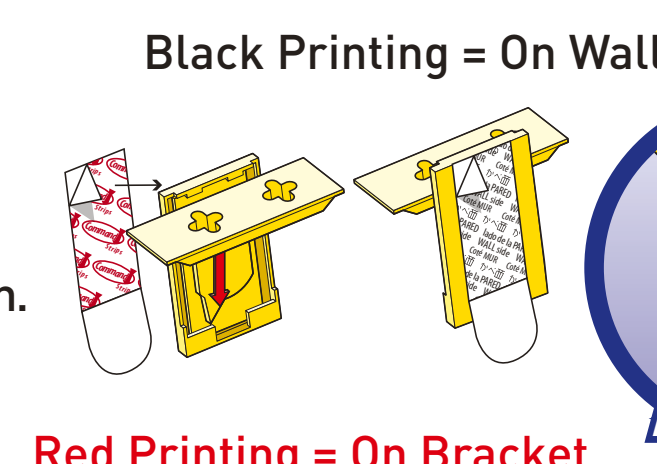

Red Printing = On Bracket

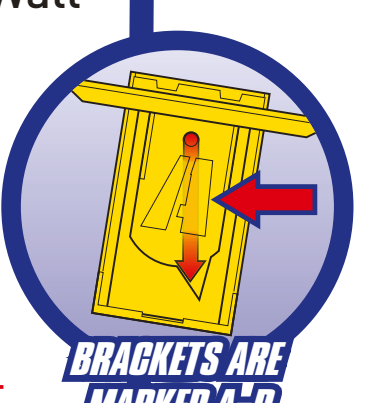

BRACKETS ARE MARKED A-D

3 HANG BRACKETS

Remove black-printed liner from Command™ Strip and place the bracket marked A onto the wall using the notch A outline on the template.

Brackets are not interchangeable. Bracket should not overlap the template.

Press bracket firmly onto wall and hold, pressing for 30 seconds.

Red arrow should line up with arrow on bracket.

Repeat with remaining brackets.

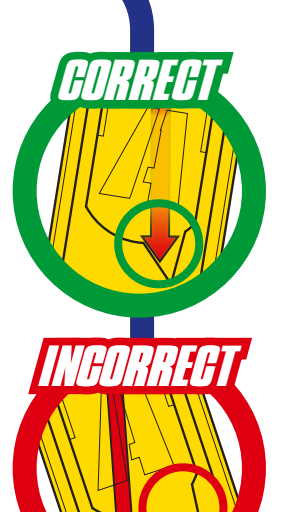
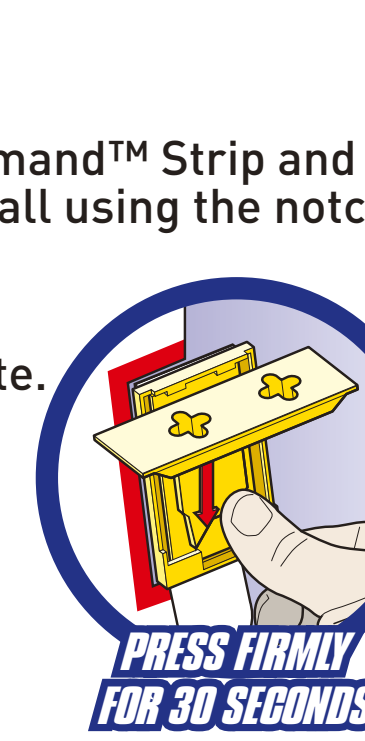

CORRECT
INCORRECT

4 REMOVE TEMPLATE

Once all brackets are firmly attached with red arrows correctly oriented, remove template.

Note: For optimal adhesion performance 3M recommends waiting 1 hour before adding weight to Command™ Strips.

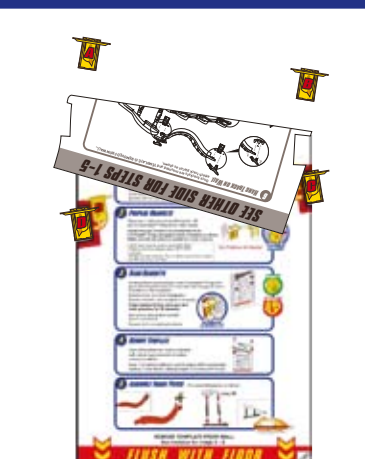

5 ASSEMBLE TRACK PIECES

Pre-assemble pieces as shown.

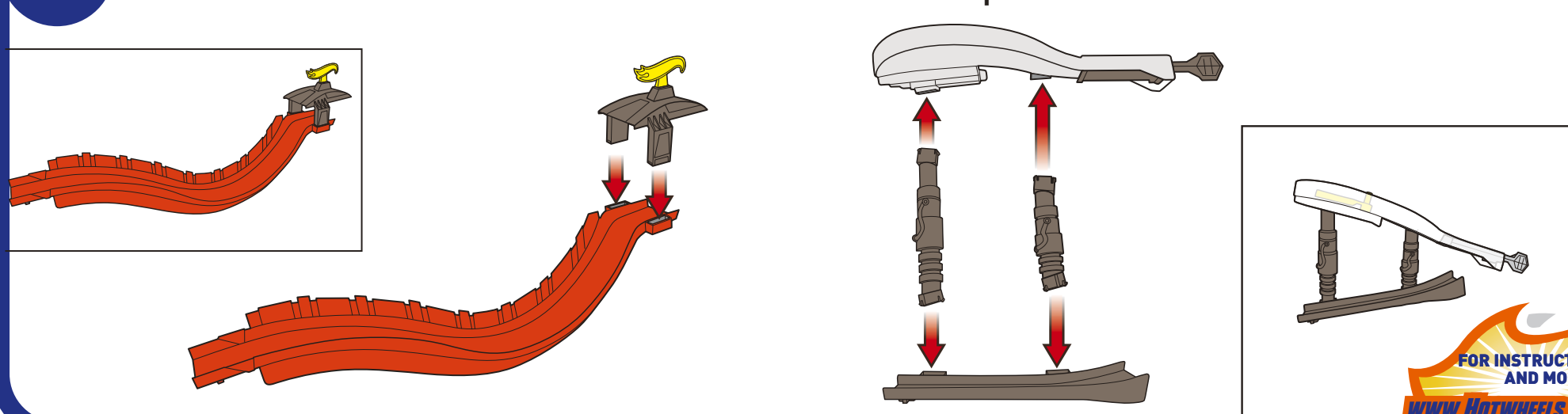

REMOVE TEMPLATE FROM WALL
See reverse for steps 6 - 8

FLUSH WITH FLOOR

SEE BACK

FOR VIDEOS AND MORE INFORMATION
ON HANGING MULTIPLE SETS, GO TO
www.HOTWHEELS.COM/WALL-TRACKS



Command™ Strips are a product of 3M. For further information visit command.com.
NOTE: Apply strips to surfaces above 50°F (10°C). Adhesive could lose adhesion above 105°F (40°C).
CAUTION: DO NOT use with wallpaper. May not adhere well to vinyl surfaces. DO NOT hang items over beds.
3M and Command are trademarks of 3M.
© 3M 2010
All Rights Reserved.



MATTEL
V1050-0120
Asst. V1049

© 2010 Mattel, Inc. All Rights Reserved.
Mattel, Inc., 4901 Great America Drive, San Gabriel, CA 91786, U.S.A. Customer Relations 1-800-824-8301.
Mattel U.K. Ltd., Villanova Business Park, Maidenhead SL4 4JH, England. Tel: 01628 500000.
Mattel Australia Pty Ltd, Broomfield, Victoria 3113. Consumer Services: 1-800-135-312.
Mattel East Asia Ltd, Room 1106, South Tower, World Finance Centre, Harbour City, Tsimshatsui, HK, China.
Singapore & Other Asia: Mattel SGA Pte Ltd 11072522-11 Lot 12-15, 12th Floor, Marina Link New, Penaraan Tropicana Golf Country Resort, 67410 PJ. Tel: 03-78803817, Fax: 03-78803867.
service.mattel.com

SEE OTHER SIDE FOR STEPS 1-5

6 HANG TRACK ON WALL

Once brackets are mounted and TEMPLATE IS REMOVED FROM WALL, attach track pieces as shown.

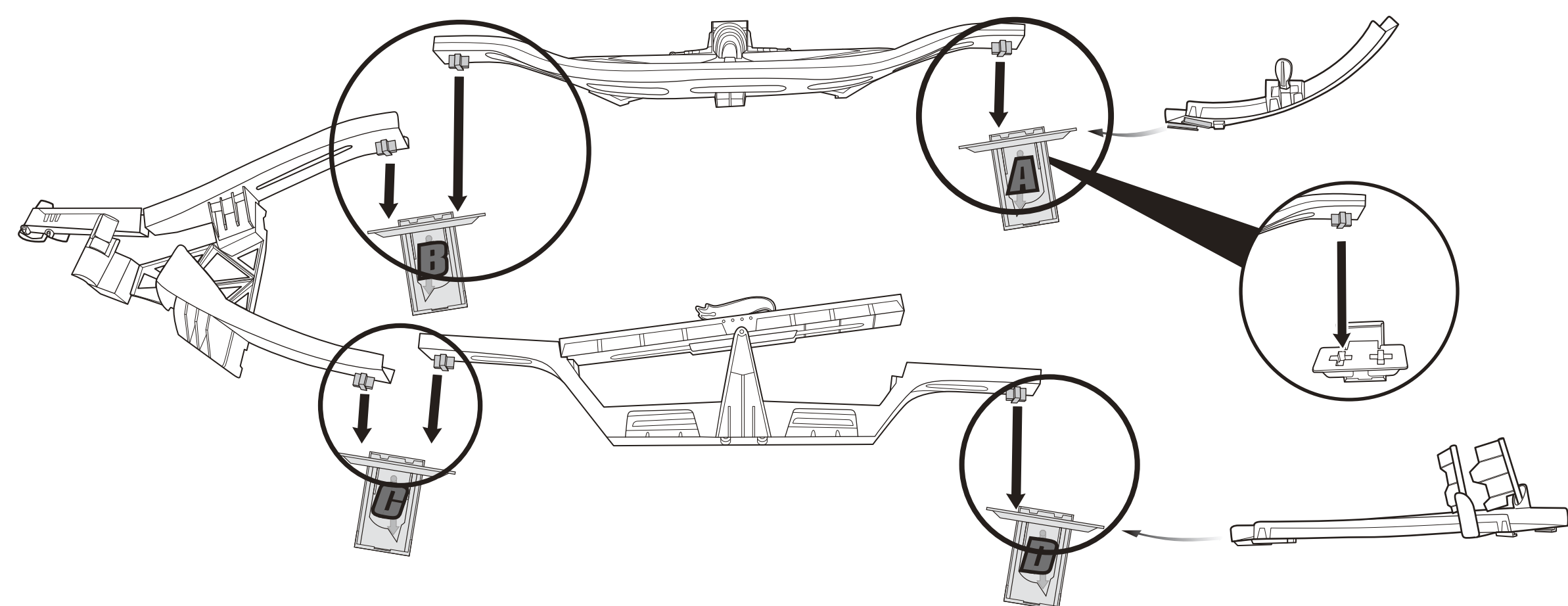

7 READY TO PLAY?

Load car.

Open Gate to Launch!

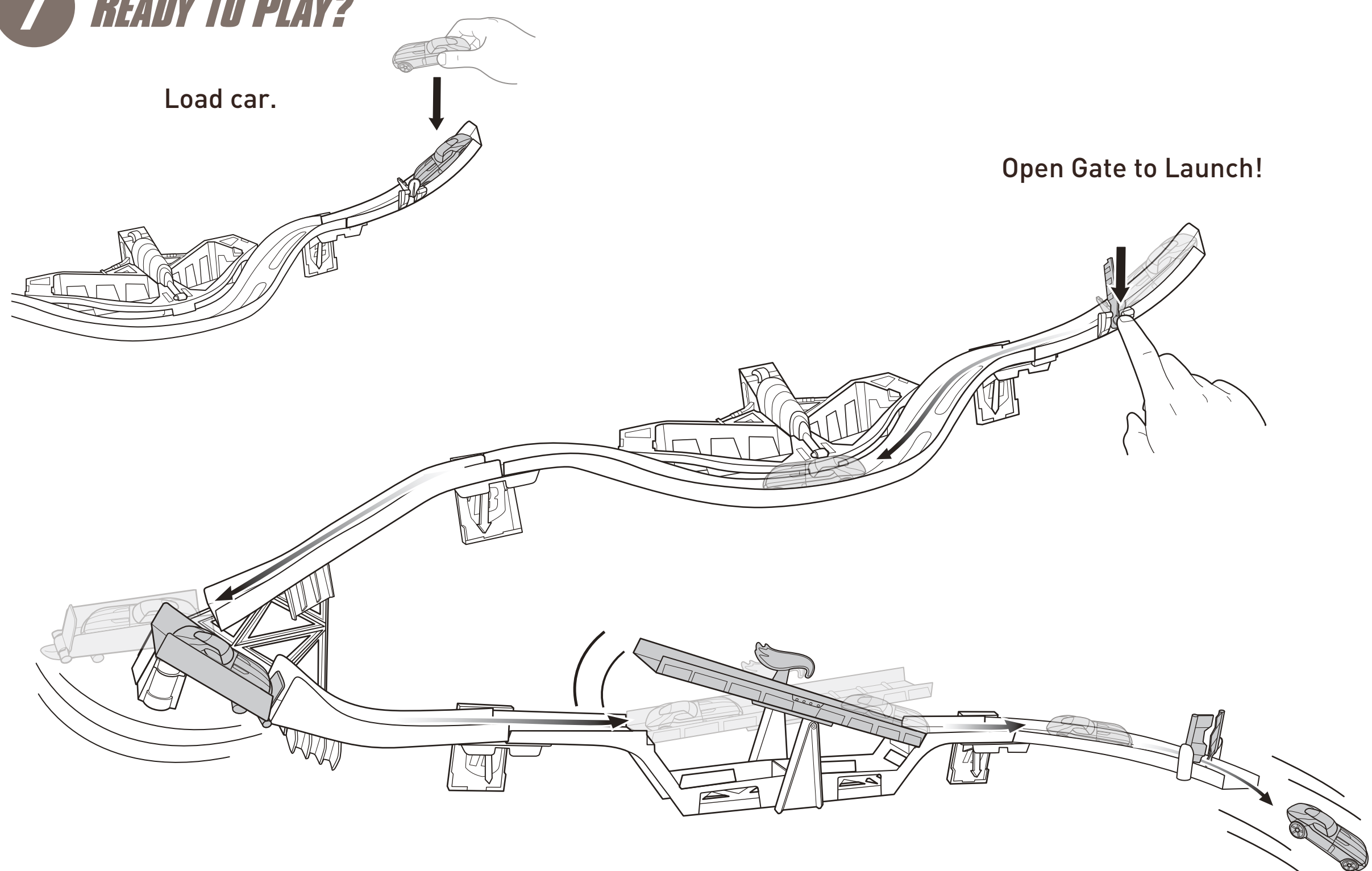

8 REATTACHING & REMOVAL

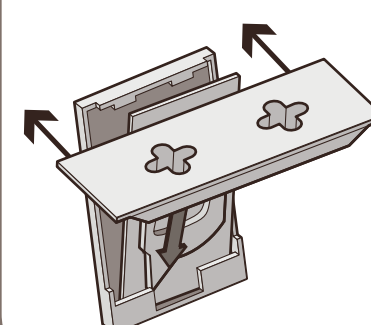

Mounting brackets are designed to break away from the set without causing surface damage. If mounting plate separates from bracket, snap bracket back into place.

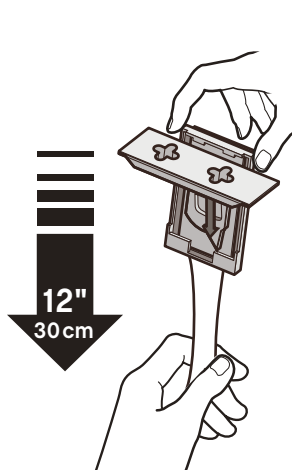

To remove brackets from the wall entirely:
1. NEVER pull strip towards you.
2. Hold bracket gently to prevent it from snapping fingers. DO NOT press against wall.
3. Grab tab on Command™ Strip and SLOWLY STRETCH STRAIGHT DOWN ALONG WALL AT LEAST 12 INCHES until bracket and strip release.
Purchase medium Command™ Refill Strips to reapply to your wall.

CONNECT

Create your own set-ups with other Wall Tracks™ sets.

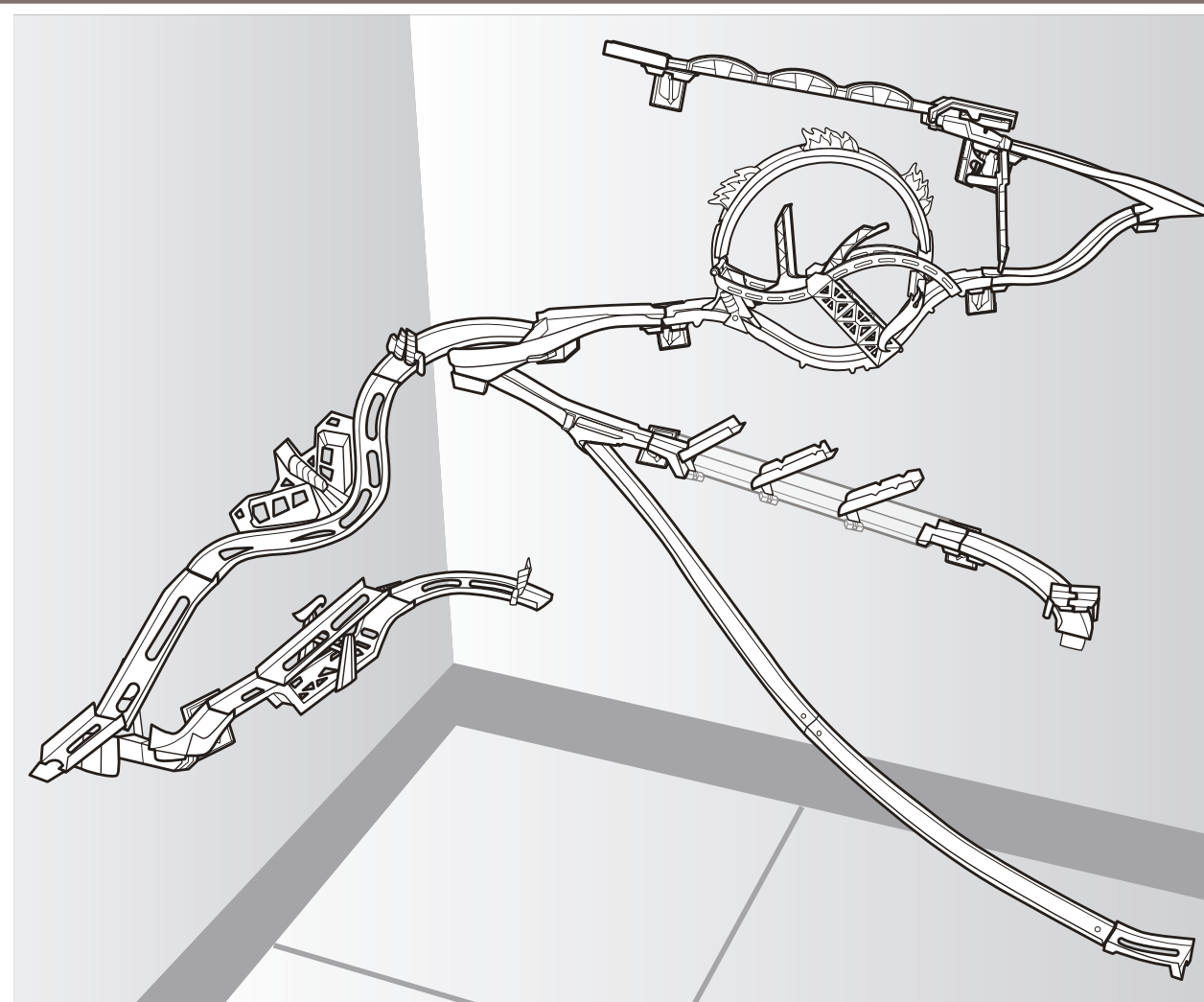

Command™ Strips are a product of 3M. For further information visit command.com
NOTE: Apply strips to surfaces above 50°F (10°C). Adhesive could lose adhesion above 105°F (40°C).
CAUTION: DO NOT use with wallpaper. May not adhere well to vinyl surfaces. DO NOT hang items over beds.
3M and command are trademarks of 3M.
© 3M 2010. All Rights Reserved.

LINE BOTTOM UP ALONG FLOOR



DAREDEVIL CURVE™



Keep these instructions for future reference as they contain important information.

YOU WILL NEED:

- Low-adhesive tape such as painter's tape or masking tape
- Approximately 3 feet of open wall space
- 20 minutes

CONTENTS:

START HERE:

Please read all instructions before beginning assembly and set-up.

1 HANG TEMPLATE

Line template up with floor and tape to wall. It should lay flat against the wall.

NOTE TO PARENTS: Before applying Command™ Strips make sure the wall surface is clean and dry. If cleaning is necessary 3M recommends using isopropyl rubbing alcohol. Do not use household cleaners.



2 PREPARE BRACKETS

There are 4 yellow brackets [Marked A - D] and 5 Command™ Strips (one extra strip).

Separate strips. Remove red-printed liner from Command™ Strips and apply to back of brackets as shown. Make sure the strip tab is accessible for future removal.

NOTE: Apply strips to surfaces above 50°F (10°C). Adhesive could lose adhesion above 105°F (40°C).
CAUTION: DO NOT use with wallpaper. May not adhere well to vinyl surfaces. DO NOT hang items over beds.

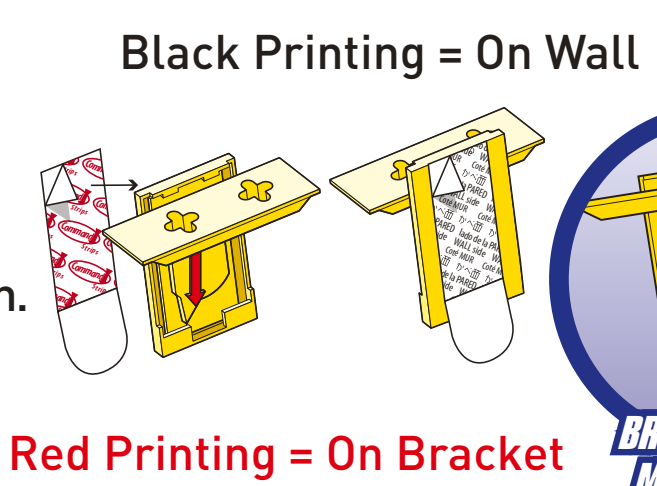

Black Printing = On Wall

Red Printing = On Bracket

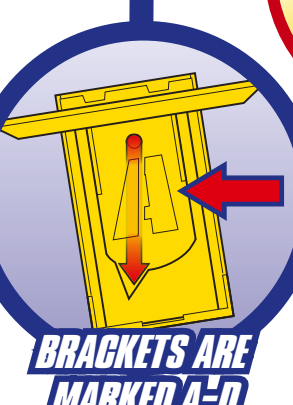

3 HANG BRACKETS

Remove black-printed liner from Command™ Strip and place the bracket marked A onto the wall using the notch A outline on the template. Brackets are not interchangeable. Bracket should not overlap the template. **Press bracket firmly onto wall and hold, pressing for 30 seconds.**

Red arrow should line up with arrow on bracket. Repeat with remaining brackets.

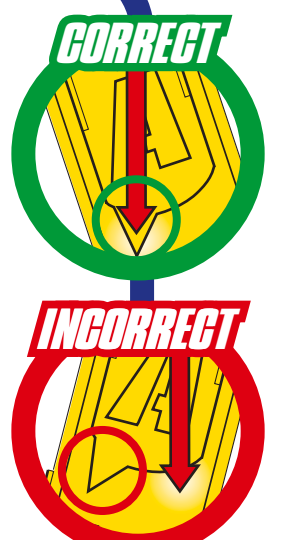
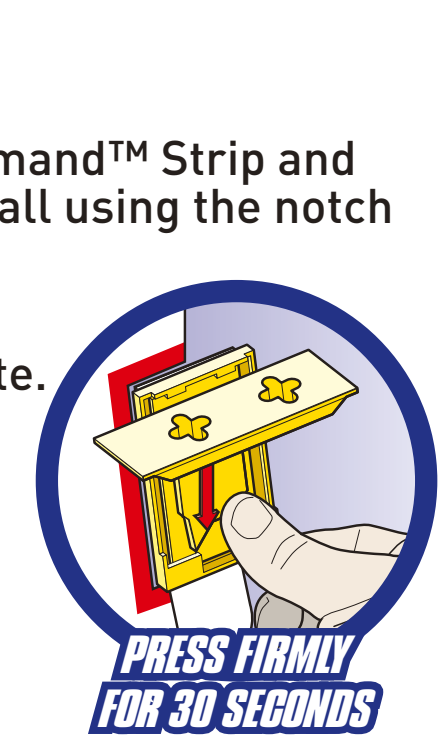

4 REMOVE TEMPLATE

Once all brackets are firmly attached with red arrows correctly oriented, remove template.

Note: For optimal adhesion performance 3M recommends waiting 1 hour before adding weight to Command™ Strips.

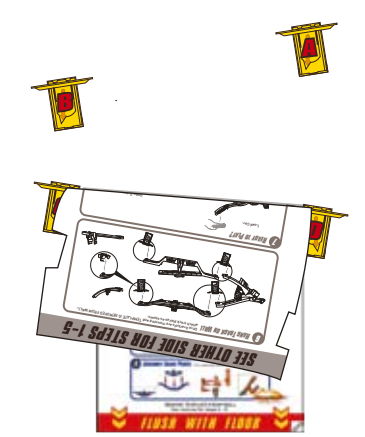

5 ASSEMBLE TRACK PIECES

Pre-assemble pieces as shown.

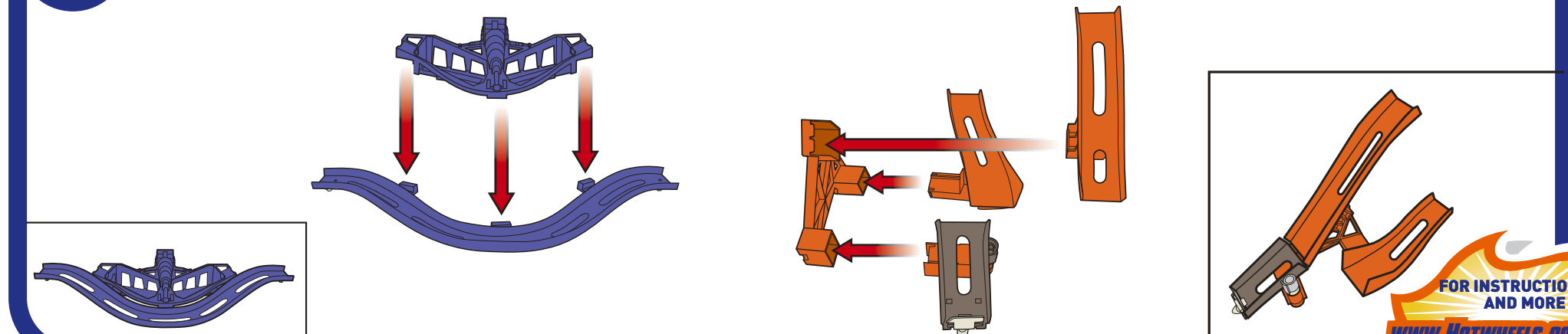

REMOVE TEMPLATE FROM WALL
See reverse for steps 6 - 8

FLUSH WITH FLOOR

SEE BACK

MATTEL

V1051 0926
Asst. V1049

FOR VIDEOS AND MORE INFORMATION
ON HANGING MULTIPLE SETS, GO TO
WWW.HOTWHEELS.COM/WALL-TRACKS



SEE OTHER SIDE FOR STEPS 1-5

6 HANG TRACK ON WALL

Once brackets are mounted and TEMPLATE IS REMOVED FROM WALL, attach track pieces as shown.

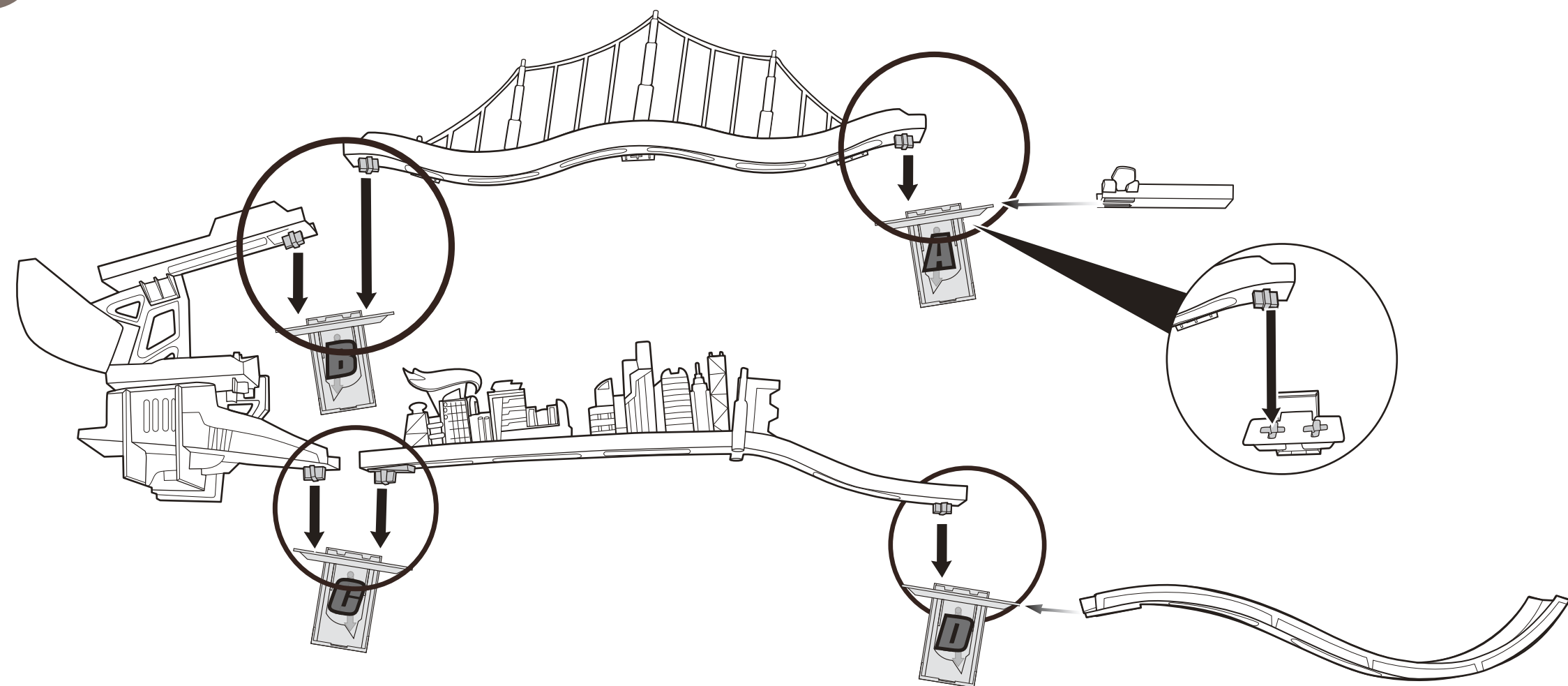

7 READY TO PLAY?

Load car.

Open Gate to Launch!

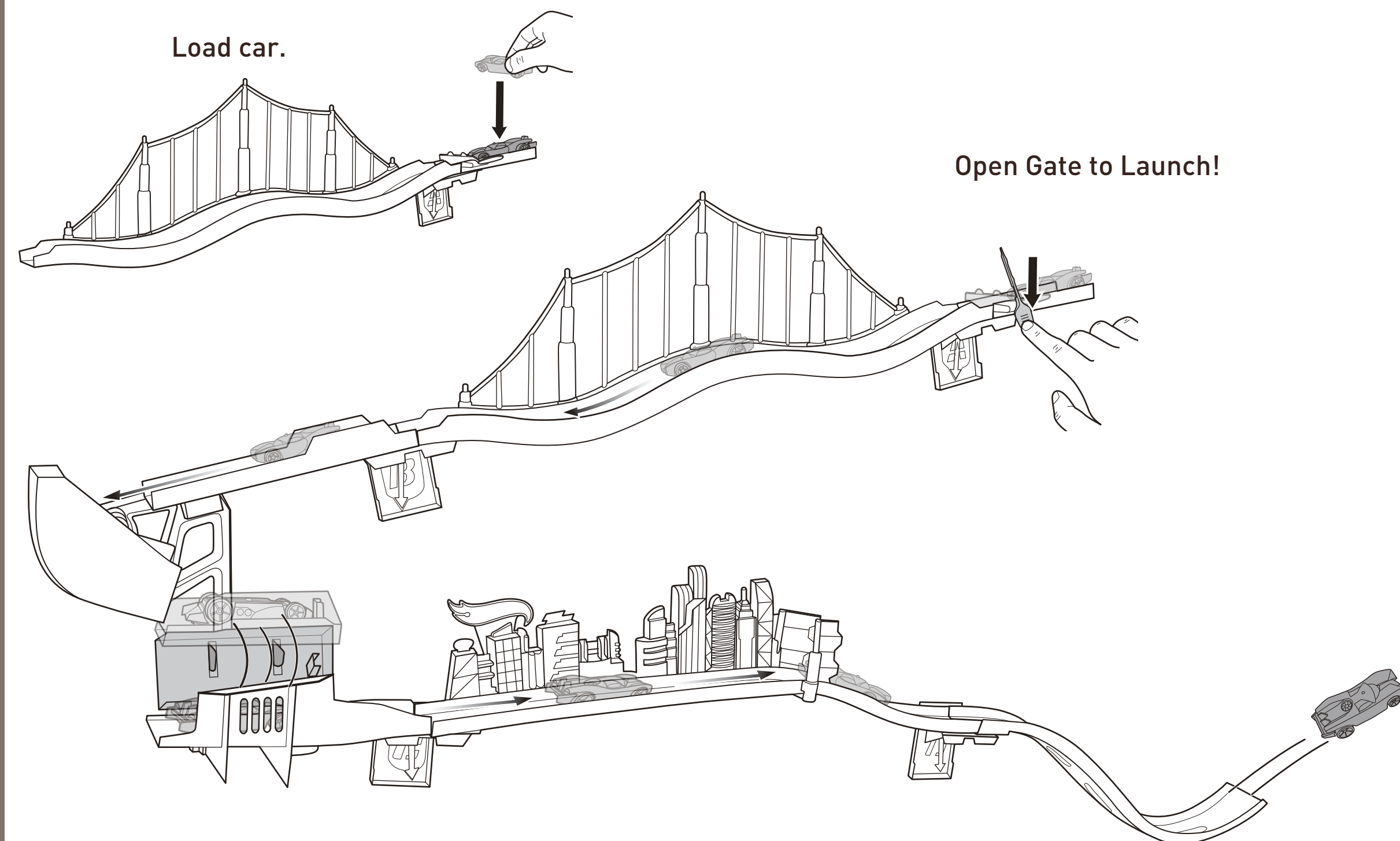

8 REATTACHING & REMOVAL

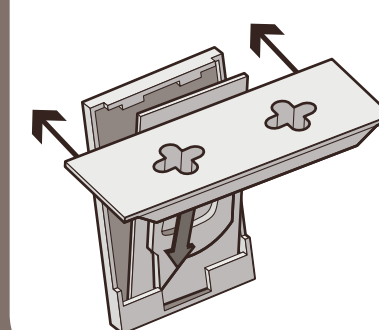

Mounting brackets are designed to break away from the set without causing surface damage. If mounting plate separates from bracket, snap bracket back into place.

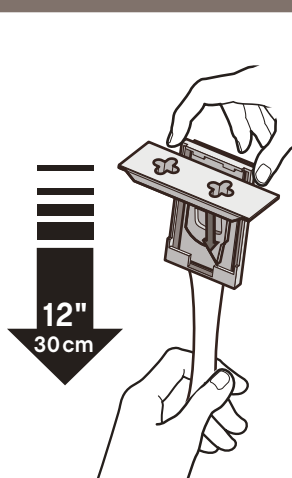

To remove brackets from the wall entirely:
1. NEVER pull strip towards you.
2. Hold bracket gently to prevent it from snapping fingers. DO NOT press against wall.
3. Grab tab on Command™ Strip and SLOWLY STRETCH STRAIGHT DOWN ALONG WALL AT LEAST 12 INCHES until bracket and strip release.
Purchase medium Command™ Refill Strips to reapply to your wall.

CONNECT

Create your own set-ups with other Wall Tracks™ sets.

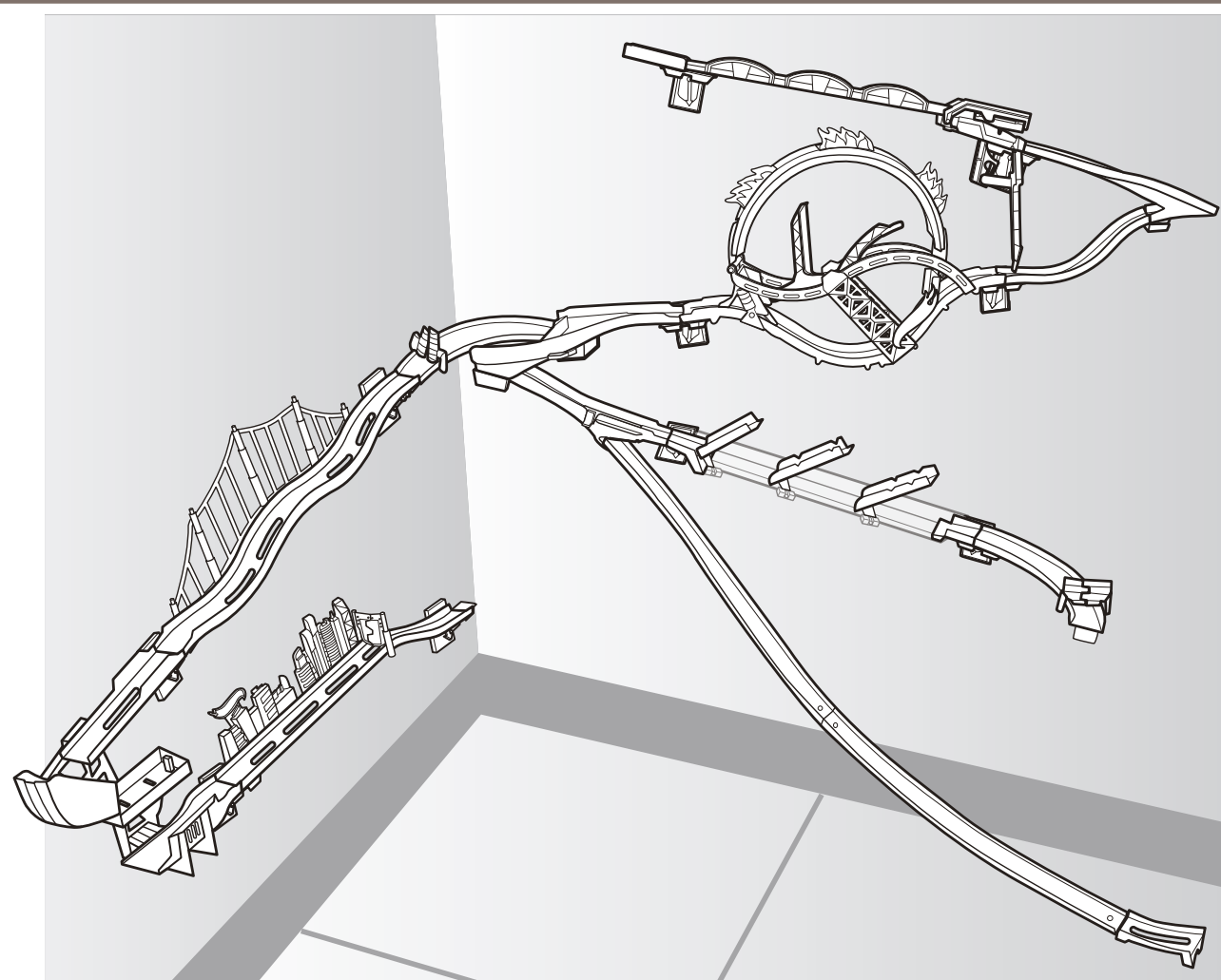

Command™ Strips are a product of 3M. For further information visit command.com
NOTE: Apply strips to surfaces above 50°F (10°C). Adhesive could lose adhesion above 105°F (40°C).
CAUTION: DO NOT use with wallpaper. May not adhere well to vinyl surfaces. DO NOT hang items over beds.
3M and Command are trademarks of 3M.
© 3M 2010. All Rights Reserved.

LINE BOTTOM UP ALONG FLOOR



DOWNHILL FLIP DROP™



Keep these instructions for future reference as they contain important information.

YOU WILL NEED:

- Low-adhesive tape such as painter's tape or masking tape
- Approximately 3 feet of open wall space
- 20 minutes

CONTENTS:

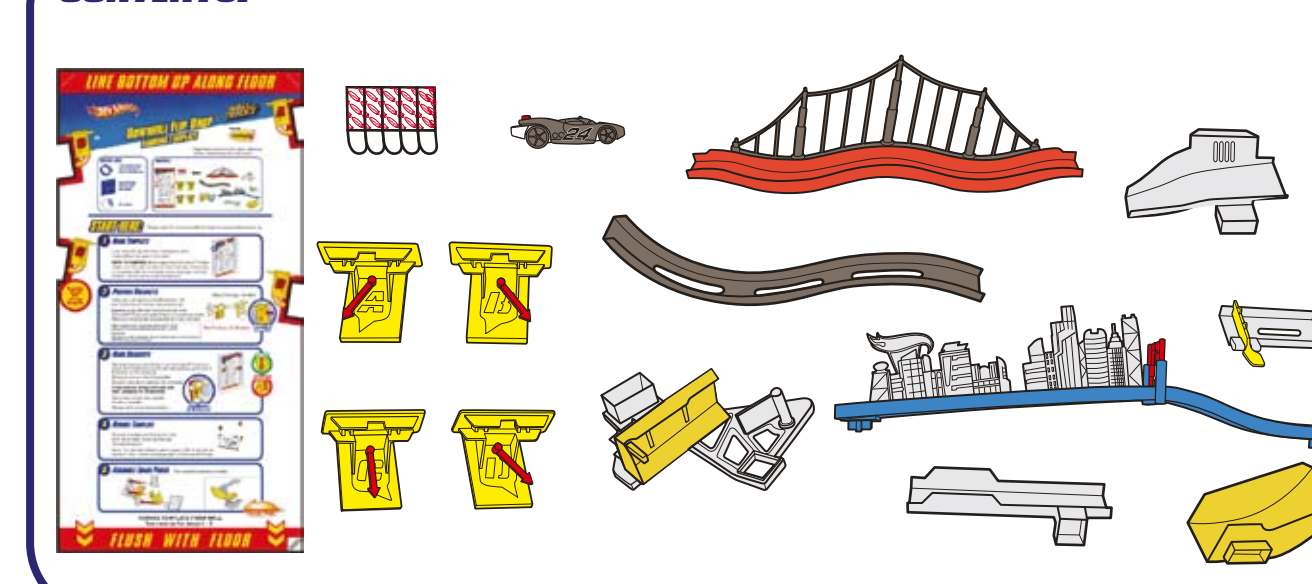

START HERE:

Please read all instructions before beginning assembly and set-up.

1 HANG TEMPLATE

Line template up with floor and tape to wall. It should lay flat against the wall.

NOTE TO PARENTS: Before applying Command™ Strips make sure the wall surface is clean and dry. If cleaning is necessary 3M recommends using isopropyl rubbing alcohol. Do not use household cleaners.



2 PREPARE BRACKETS

There are 4 yellow brackets [Marked A - D] and 5 Command™ Strips (one extra strip).

Separate strips. Remove red-printed liner from Command™ Strips and apply to back of brackets as shown. Make sure the strip tab is accessible for future removal.

NOTE: Apply strips to surfaces above 50°F (10°C). Adhesive could lose adhesion above 105°F (40°C).
CAUTION: DO NOT use with wallpaper. May not adhere well to vinyl surfaces. DO NOT hang items over beds.

Black Printing = On Wall

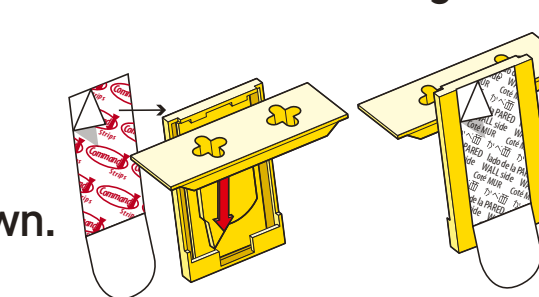

Red Printing = On Bracket



3 HANG BRACKETS

Remove black-printed liner from Command™ Strip and place the bracket marked A onto the wall using the notch A outline on the template.

Brackets are not interchangeable. Bracket should not overlap the template.

Press bracket firmly onto wall and hold, pressing for 30 seconds.

Red arrow should line up with arrow on bracket.

Repeat with remaining brackets.

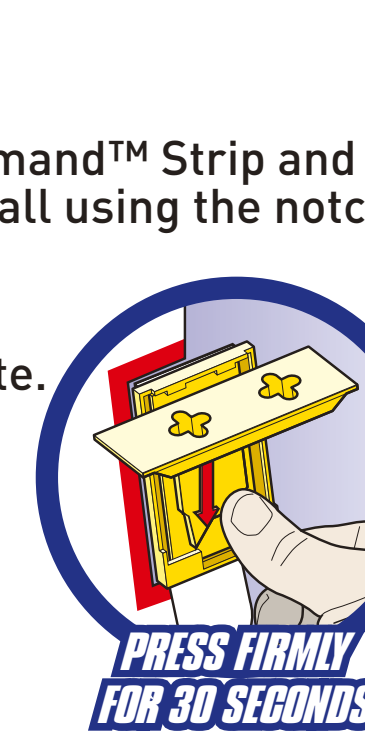

4 REMOVE TEMPLATE

Once all brackets are firmly attached with red arrows correctly oriented, remove template.

Note: For optimal adhesion performance 3M recommends waiting 1 hour before adding weight to Command™ Strips.

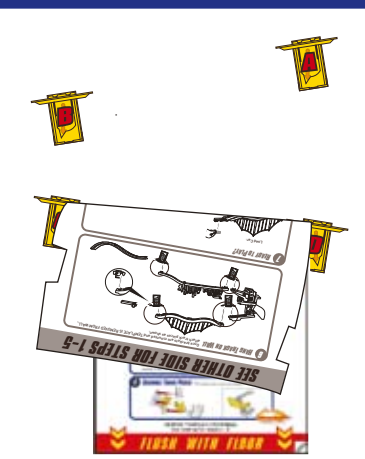

5 ASSEMBLE TRACK PIECES

Pre-assemble pieces as shown.

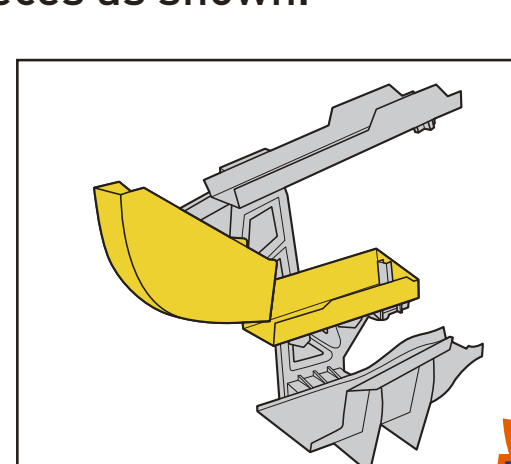
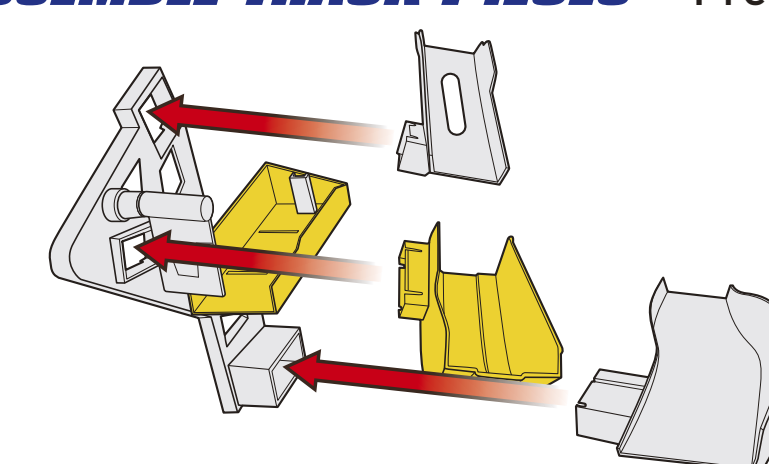

REMOVE TEMPLATE FROM WALL
See reverse for steps 6 - 8

FLUSH WITH FLOOR

SEE BACK

MATTEL

V1052-0920

Asst. V1049

FOR VIDEOS AND MORE INFORMATION
ON HANGING MULTIPLE SETS, GO TO
WWW.HOTWHEELS.COM/WALL-TRACKS

© 2010 Mattel, Inc. All Rights Reserved.
Mattel, Inc., 200 Grove Avenue, San Francisco, CA 94103. U.S.A. Consumer Relations 1-800-524-8687.
Mattel U.K. Ltd., Vauxhall Business Park, Watlington Road, Watlington, Oxford OX12 9BJ. England 01235 506300.
Mattel Australia Pty. Ltd., Business Village, 3121 Consumer Gateway Service - 1300 135 312.
Mattel East Asia Ltd., Room 1106, South Tower, World Finance Centre, Harbour City, Tsimshatsui, HK, China.
Distributors & Dealers: Mattel SEA Pte Ltd, 135-137, 13th Floor, Menara Lien Hoe, Persiaran Tropika Golf Country Resort, 47410 PJ, Tel: 03-78803817, Fax: 03-78803867.
www.mattel.com

