



Please keep this instruction sheet for future reference,
as it contains important information.

Adult assembly is required.

Tool required for assembly: Phillips screwdriver (not included).

Consumer Information

WARNING

Prevent Entanglement Injury

Crib Mobile Use

- Keep out of baby's reach.
- Remove mobile from crib or playpen when baby begins to push up on hands and knees.
- This product may not attach to all crib designs. Do not add additional strings or straps to attach to a crib or playpen.

Stroller Toy Use

- Do not attach link directly to crib or playpen.

CAUTION

- This package contains small parts in its unassembled state. Adult assembly is required.

Important Information

- Use as a mobile from birth until 5 months.
- A mobile is intended for visual stimulation and not to be grasped by a child.
- When used as a mobile, always attach with all provided fasteners (strings, straps, clamps, etc.) tightly to the crib or playpen according to the instructions. Check frequently.

Assembled Parts



Top Arm



Giraffe



Mobile Link Cover



Mobile Link



Bottom Arm

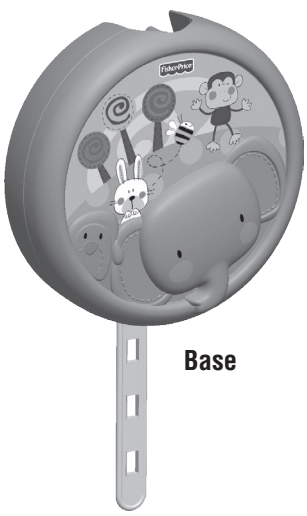

Base

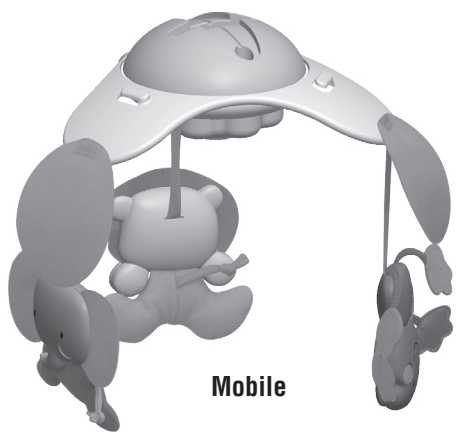

Mobile



M3,5 x 20 mm Screw – 5

Screw is shown actual size.

*Tighten all screws with a Phillips screwdriver.
Do not over-tighten the screws.*

Assembly

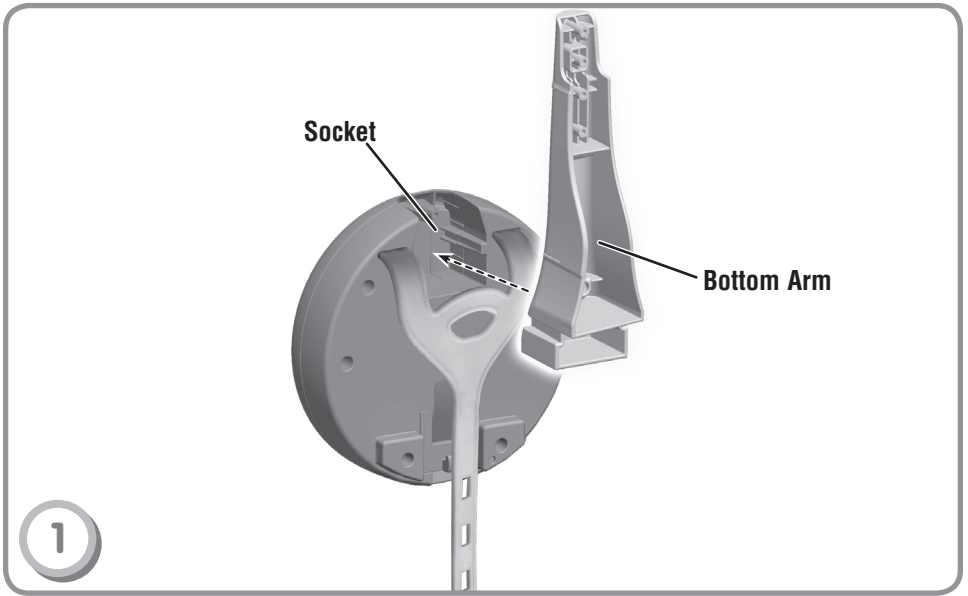

- Fit the bottom arm into the socket in the back of the base.

Hint: You may need to pull the attachment strap on the base down to fit the arm in the base.

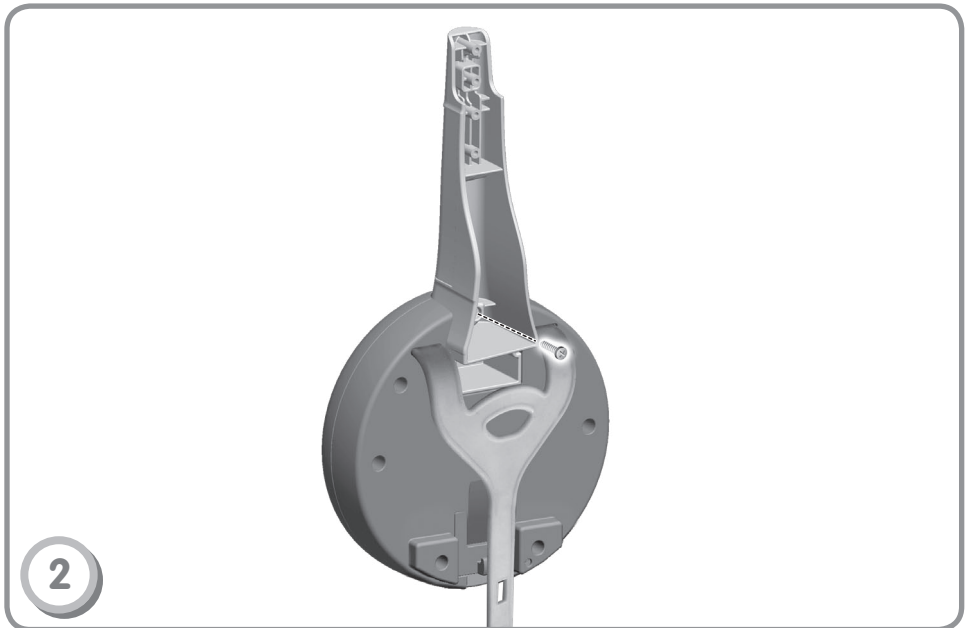

- Insert a screw into the arm and tighten.

Assembly

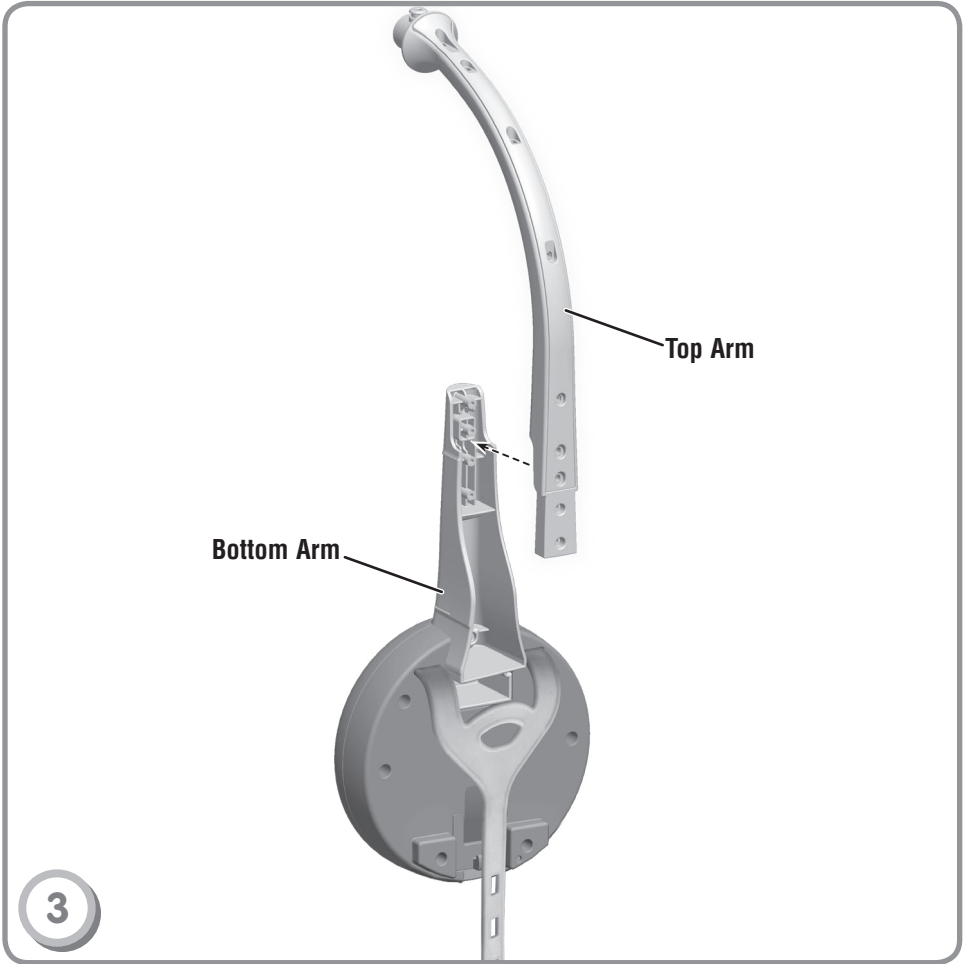

- Fit the top arm onto the bottom arm.

Assembly

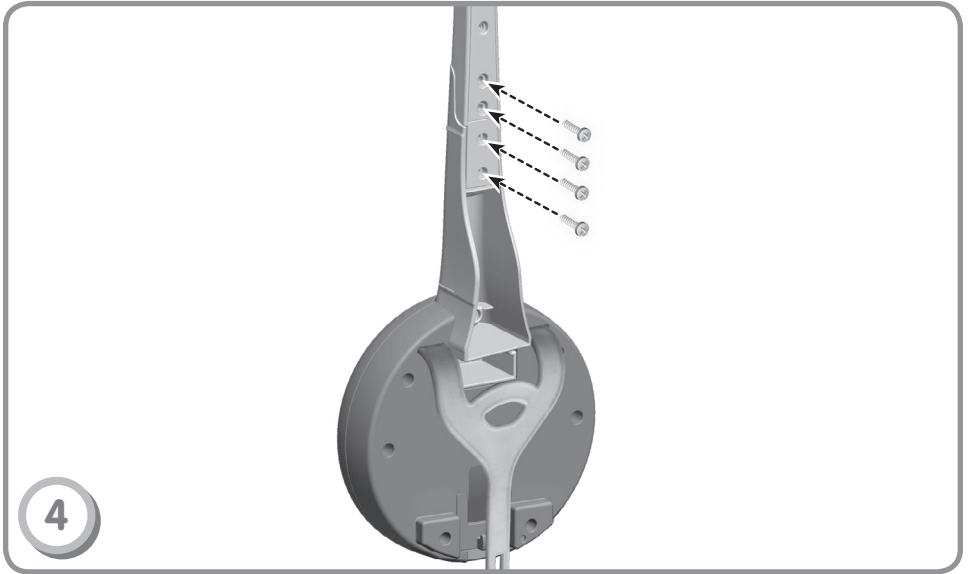

- Insert four screws into the arm assembly and tighten.

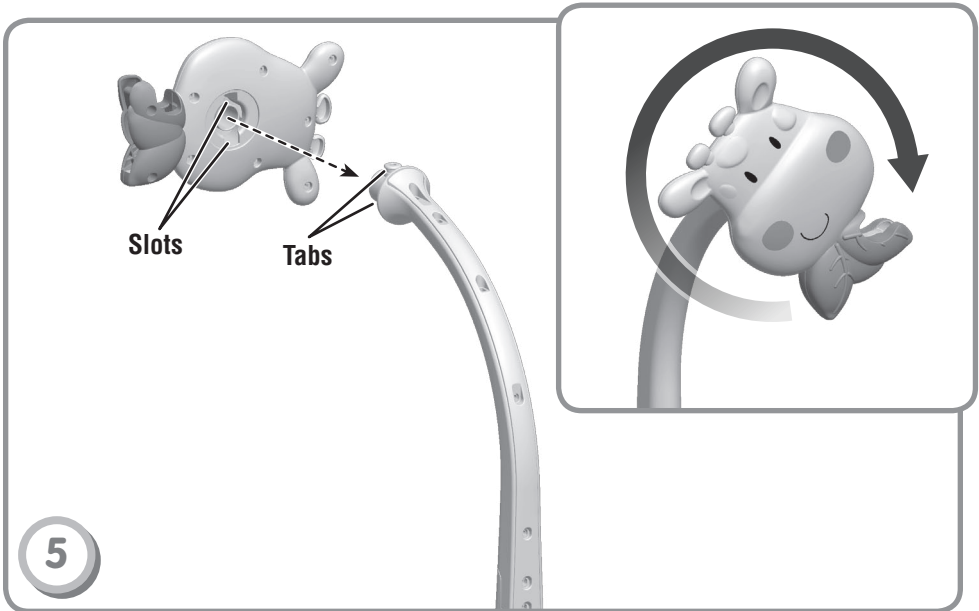

- First, align the tabs on the arm with the slots in the giraffe.
- Then, turn the giraffe to **"snap"** in place.

Assembly

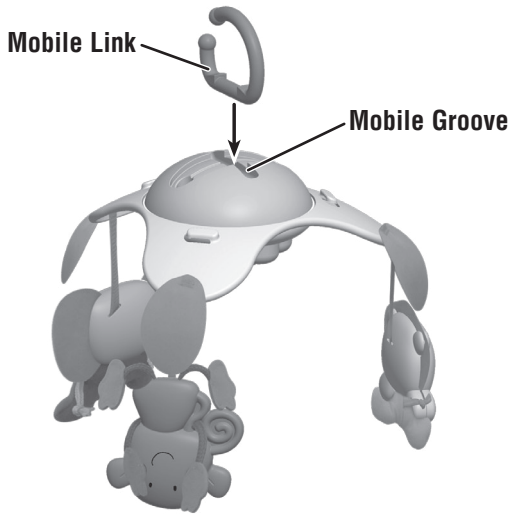

6

- Fit the flat end of the mobile link into the groove in the mobile.

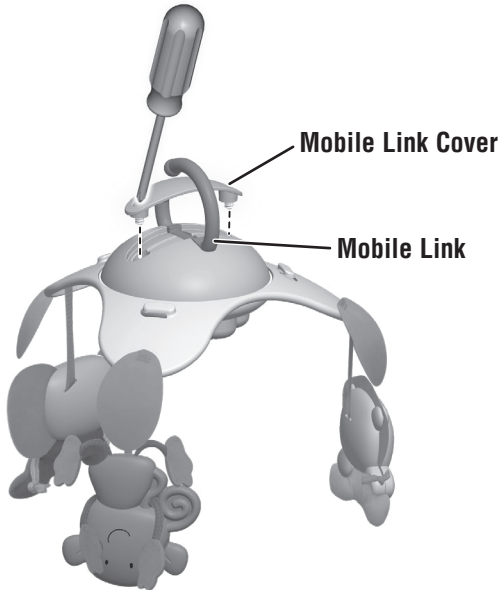

7

- Fit the mobile link cover onto the top of the mobile.
- Tighten the screws.

Note: The screws are assembled to the mobile link cover.

Assembly

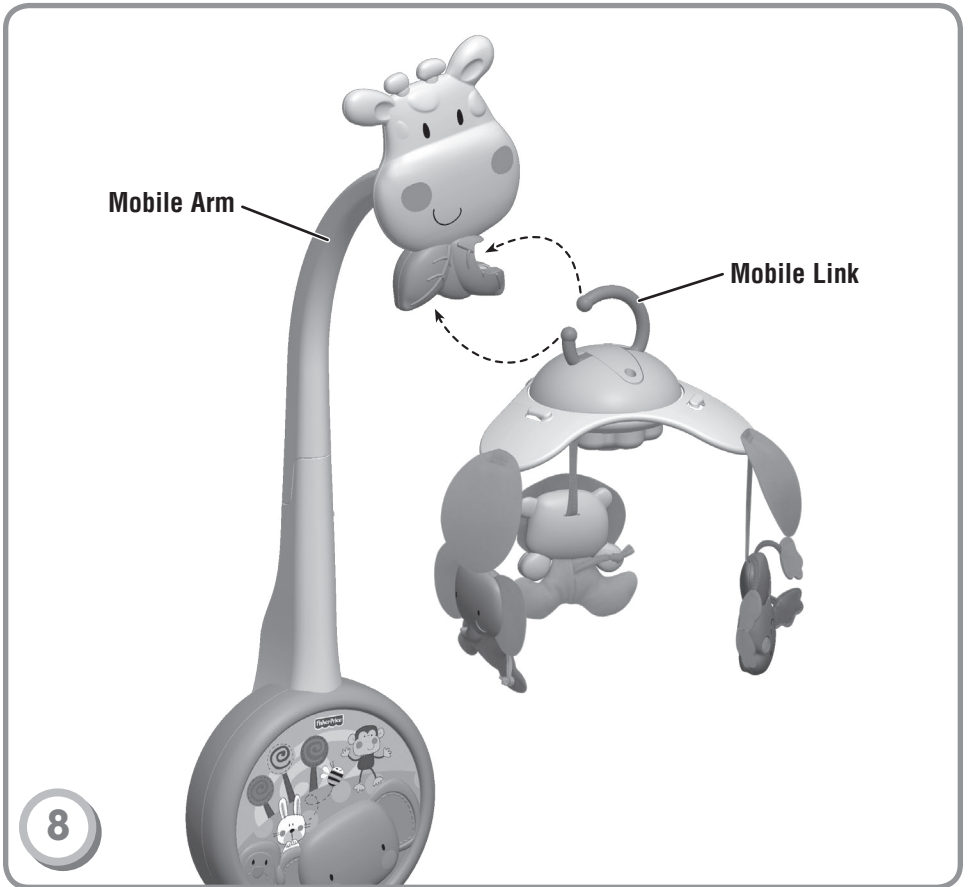

- Fit the ends of the mobile link onto the mobile arm.
- Push to “**snap**” the link in place.

Mobile Use Crib Attachment

IMPORTANT! Always attach all provided fasteners (strings, straps, clamps, etc.) tightly to a crib or playpen according to the instructions. Do not add additional strings or straps to attach to a crib. Check frequently.

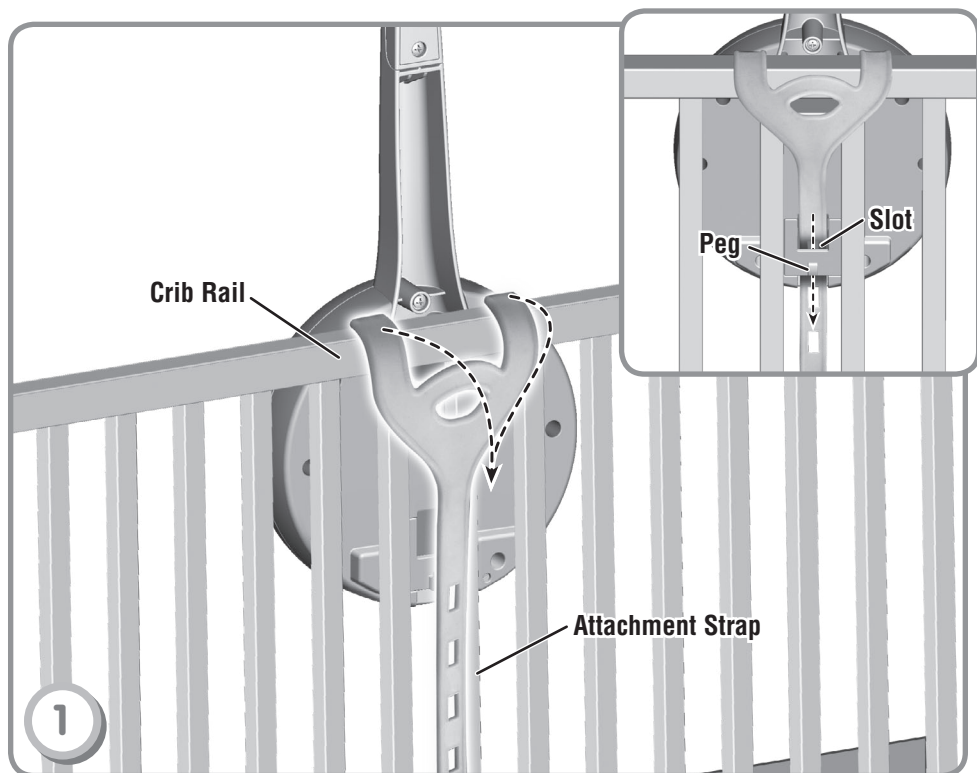

IMPORTANT! If you are attaching this toy to a crib side rail that can be lowered and raised, make sure the crib side rail is in the raised (locked) position whenever a child is in the crib.

- Position the toy inside the crib.
- Wrap the toy's attachment strap around the crib top horizontal rail.
- Slide the end of the attachment strap through the slot on the back of the toy.
- Pull the end of the attachment strap up and fasten to the slot on the peg on the back of the toy.

Note: This toy should be snug against the crib rail and spindles. Use the strap slot that provides the tightest fit.

- If you have excess strap, slide the free end of the attachment strap under the slot at the top of the attachment strap.

Mobile Use Crib Attachment

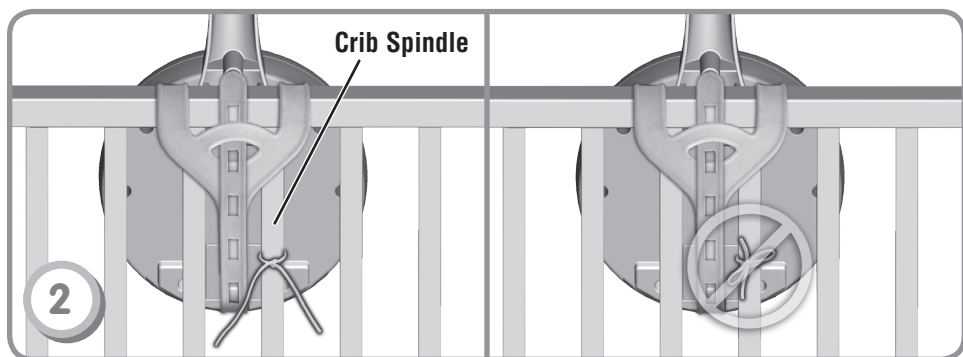

- Tie the toy's strings to a crib spindle.

Note: It is better to tie the strings in a knot than a bow, since a bow may be easily untied.

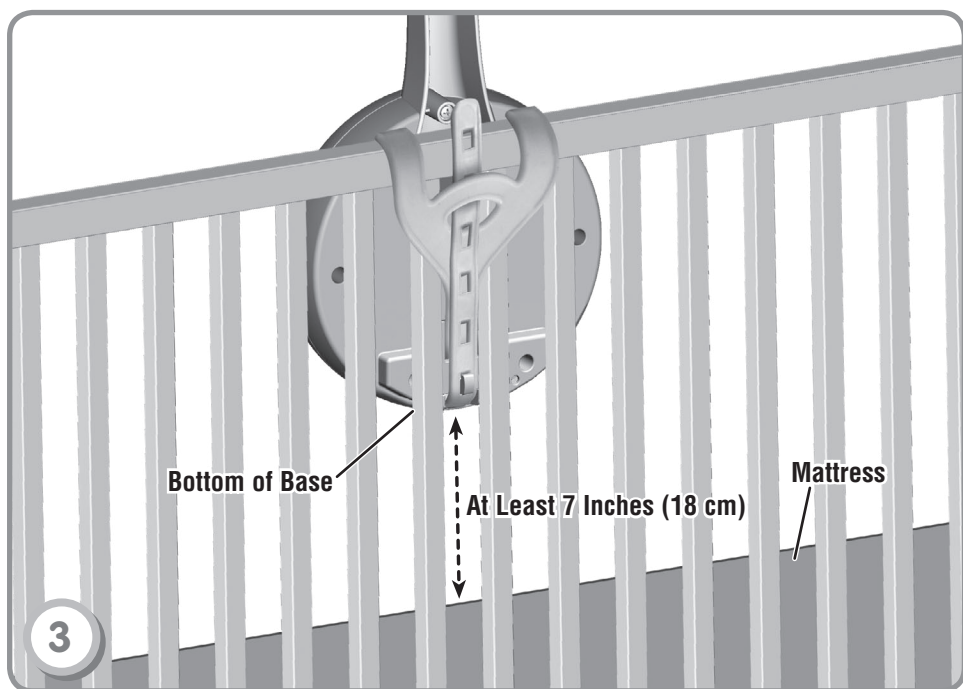

- Make sure the distance between the bottom of the product and the crib mattress is **at least 7 inches (18 cm)**.
- If the distance is less than 7 inches (18 cm): readjust the attachment straps to lift the product; or lower the crib mattress.

Musical Crib Mobile

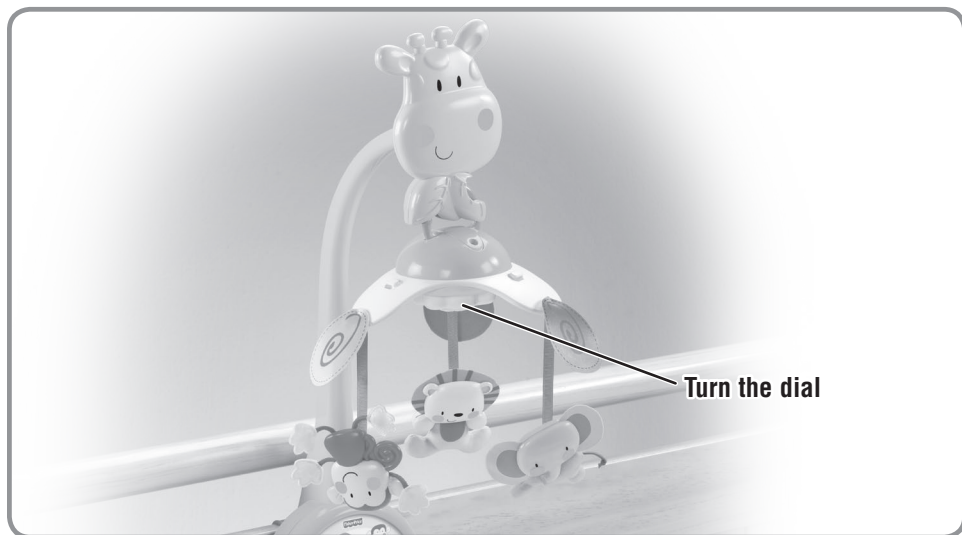

- Turn the dial on the bottom of the mobile clockwise for a musical tune.

Hint: Do not over-wind the dial.

Stroller Link Toy

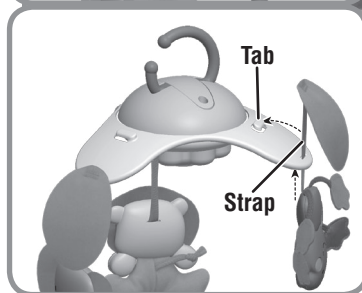
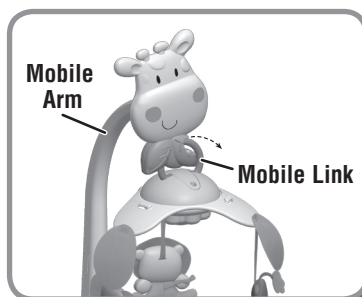

- Pull the mobile link off the mobile arm to use as a stroller toy!
- Shorten the toy straps. Pull the toy straps up and then under the tabs on top of the toy.
- Fit the open end of the mobile link onto a stroller canopy.
- Turn the dial on the bottom of the mobile clockwise for a musical tune.

Hint: Do not over-wind the dial.



CONSUMER ASSISTANCE

1-800-432-5437 (US & Canada)

1300 135 312 (Australia)



service.fisher-price.com

Fisher-Price, Inc., 636 Girard Avenue, East Aurora, NY 14052.

Hearing-impaired consumers: 1-800-382-7470.

Outside the United States:

Canada: Mattel Canada Inc., 6155 Freemont Blvd.,
Mississauga, Ontario L5R 3W2; www.service.mattel.com.

Great Britain: Mattel UK Ltd, Vanwall Business Park,
Maidenhead SL6 4UB. Helpline: 01628 500303.
www.service.mattel.com/uk

Mattel Europa, B.V., Gondel 1, 1186 MJ Amstelveen, Nederland.

Australia: Mattel Australia Pty. Ltd., 658 Church Street,
Locked Bag #870, Richmond, Victoria 3121 Australia.

New Zealand: 16-18 William Pickering Drive,
Albany 1331, Auckland.

Care

- Wipe this toy with a clean, damp cloth. Do not immerse this toy.
- This toy has no consumer serviceable parts. Do not take this toy apart.