

## BATTERY REPLACEMENT

Batteries included are for demonstration purposes only. Requires 4 AAA (LR03) alkaline batteries.

Toy uses 4 replaceable AAA (LR03) alkaline batteries. When "BATTERIES LOW" shows on screen, change batteries within 3 minutes. To replace batteries, use a Phillips head screwdriver (not included) to open battery door. Remove and set aside. Insert 4 replaceable AAA or LR03 alkaline batteries as shown. Use either AAA or LR03 alkaline batteries or equivalent. Replace battery cover and screw closed.

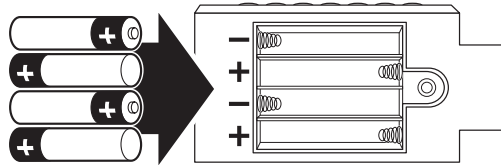

## BATTERY SAFETY INFORMATION

In exceptional circumstances batteries may leak fluids that can cause a chemical burn injury or ruin your product. To avoid battery leakage:

- Non-rechargeable batteries are not to be recharged.
- Rechargeable batteries are to be removed from the product before being charged (if designed to be removable).
- Rechargeable batteries are only to be charged under adult supervision (if designed to be removable).
- Do not mix alkaline, standard (carbon-zinc), or rechargeable (nickel-cadmium) batteries.

- Do not mix old and new batteries.
- Only batteries of the same or equivalent type as recommended are to be used.
- Batteries are to be inserted with the correct polarity.
- Exhausted batteries are to be removed from the product.
- The supply terminals are not to be short-circuited.
- Dispose of battery(ies) safely.
- Do not dispose of this product in a fire. The batteries inside may explode or leak.

This equipment has been tested and found to comply with the limits for a Class B digital device, pursuant to part 15 of the FCC rules. These limits are designed to provide reasonable protection against harmful interference in a residential installation. This equipment generates, uses and can radiate radio frequency energy and, if not installed and used in accordance with the instructions, may cause harmful interference to radio communications. However, there is no guarantee that interference will not occur in a particular installation. If this equipment does cause harmful interference to radio or television reception, which can be determined by turning the equipment off and on, the user is encouraged to try to correct the interference by consulting the dealer or an experienced radio/TV technician for help.

Mattel Inc.  
333 Continental Blvd.  
El Segundo, CA  
(310) 252-2400

NOTE: Changes or modifications not expressly approved by the manufacturer responsible for compliance could void the user's authority to operate the equipment.

This device complies with part 15 of the FCC Rules. Operation is subject to the following two conditions: (1) This device may not cause harmful interference, and (2) this device must accept any interference received, including interference that may cause undesired operation.

THIS CLASS B DIGITAL APPARATUS COMPLIES WITH CANADIAN ICES-003. Operation is subject to the following two conditions: (1) this device may not cause interference, and (2) this device must accept any interference, including interference that may cause undesired operation of the device.

CET APPAREIL NUMERIQUE DE LA CLASSE B EST CONFORME A LA NORME NMB-003 DU CANADA. L'utilisation de ce dispositif est autorisée seulement aux conditions suivantes : (1) il ne doit pas produire de brouillage et (2) il doit pouvoir tolérer tout brouillage radioélectrique reçu, même si ce brouillage est susceptible de compromettre son fonctionnement.

We want you to have fun playing with our products,  
so please give us your feedback by filling out the short On-line survey. Go to  
**[service.mattel.com/surveys](http://service.mattel.com/surveys)**

Thanks for helping us make great toys even better!

English-only site. • Site Web en anglais uniquement.

## CONSUMER INFORMATION

Need Assistance? Visit [service.mattel.com](http://service.mattel.com) or call 1-800-524-8697 (US and Canada only), M-F 9AM - 7PM & SAT 11AM - 5PM, Eastern.

**SERVICE.MATTEL.COM**

Mattel Canada Inc., Mississauga, Ontario L5R 3W2. You may call us free at 1-800-524-8697.

Mattel U.K., Ltd., Vanwall Business Park, Maidenhead SL6 4UB, Helpline 01628500303.

Mattel Australia Pty., Ltd., Richmond, Victoria 3121. Consumer Advisory Service 1300 135 312 (valid only in Australia).

Mattel East Asia Ltd, Room 1106, South Tower, World Finance Centre, Harbour City, Tsimshatsui, HK, China.

Diimport & Diedarkan Oleh: Mattel SEA Ptd Ltd (993532-P) Lot 13.5, Menara Lien Hoe, Persiaran Tropicana Golf Country Resort, 47410

# PIXEL CHIX™

## INSTRUCTIONS

6+



H8330-0920-G5  
H8331  
H8332

## CONTENTS

H8330\*

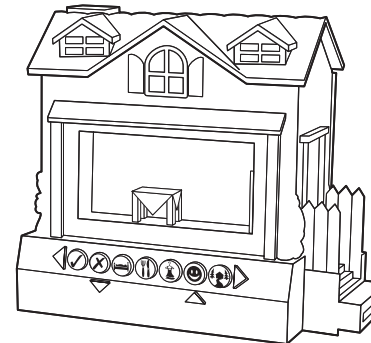

H8331\*

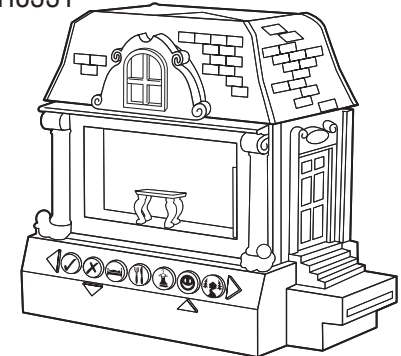

H8332\*

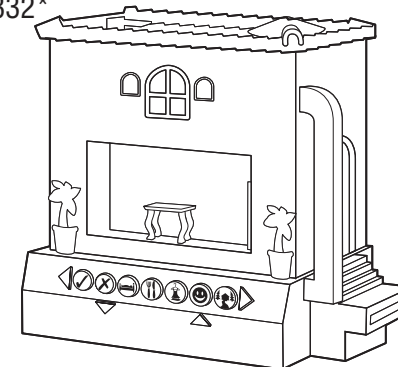

\*Each sold separately, subject to availability.

Please remove everything from the package and compare to the contents shown here.  
If any items are missing, please call 1-800-524-8697.

Keep these instructions for future reference as they contain important information.

©2005 Mattel, Inc., El Segundo, CA 90245 U.S.A. All Rights Reserved.

# A PIXILLION things we can do together!™

There are 5 levels of play with Pixel Chix.

WHEN YOU **PLAY WITH YOUR PIXEL CHIX™ GAL**, you will move up to higher levels of play. When you reach a new level of play, your Pixel Chix pal will appear in a puff of smoke, trumpet fanfare will play and she will yell, "Woo-hoo!" With each new level you get more fashions, more food, more places to go (depending on which fashion your Pixel Chix is wearing) and more games to play. The more you play with your Pixel Chix, the faster you'll get to each new level.

IF YOU **NEGLECT** YOUR PIXEL CHIX™ GAL, she may give you attitude and you will go down in levels of play. If you continue to ignore her, she will eventually leave her home and you will have to start play again at Level 1. So be sure to give her lots of attention!



## SET THE CLOCK



1. Press GO OUT button.

2. Keep pushing GO OUT button until nearest hour is chosen. A small circle moves around, inside the numbers.



3. When the small circle is next to the nearest hour, press YES to set the time.



SUN indicates day time.



MOON indicates night time.



To reset clock during play, press NO (X) and FUN (smiley face) buttons at the same time. Repeat the steps above.

## GO AHEAD AND PUSH MY BUTTONS!



YES



NO



BED TIME

Press when it is time for Pixel Chix girl to go to bed.



FASHION

Help me choose what to wear. Press FASHION button until I am wearing what you want me to wear. Press YES to accept.



FOOD

Help me choose what to eat. Press FOOD button until I am holding what you want me to eat. Press YES to accept.



FUN

Help me choose what to do. Press FUN button until I am pointing at a fun activity to do. Press YES to accept.



GO OUT

Press GO OUT button until I am pointing at what you want me to do outside. Press YES to accept.

## FUN MODE (smiley face)

Buttons YES (checkmark), NO (X), GO OUT (house with person) and FUN (smiley face) can be used as controls during certain games:



YES = left



NO = down



FUN = up



GO OUT = right

When a flashing arrow appears, push that arrow's button to control play.

Pressing BED TIME (bed), FOOD (fork and knife), or FASHION (dress) buttons interrupts play mode.

## CONNECT HOUSES

Remove cover first, then connect the houses.

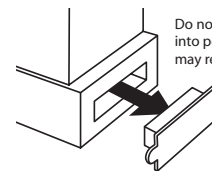

Do not put finger into ports as this may reset game.

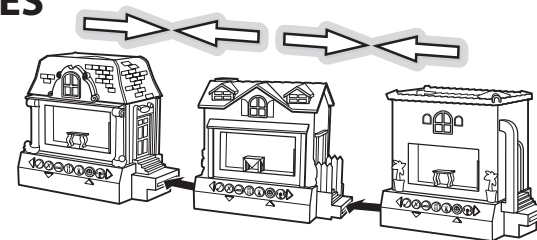

### CONNECT 2 HOUSES

Press FUN (smiley face) button on one house and a Pixel Chix™ friend from the other house comes over.



### CONNECT 3 OR MORE HOUSES

Pixel Chix™ gals wave to each other, talk on the phone, or dance.

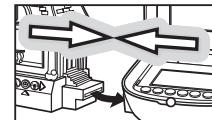

### CONNECT A HOUSE TO THE MALL

Press FUN button on the mall and the Pixel Chix™ gal goes from the house to the mall.

## TROUBLESHOOTING

### TRY ME PULL TAB

The pull tab in the Try Me slot should be automatically removed when toy is taken out of the package. If not, simply remove the pull tab before playing.

### RESET BUTTON

Reset playhouse if Pixel Chix pal leaves house, she has been neglected for a few days, or to start a fresh game. Ask an adult to insert a metal tip, such as a bent paper clip, into the hole.

When exposed to an electrostatic source, the product may malfunction and suffer memory loss. Reset the product if this occurs.

For additional information please visit [PixelChix.com](http://PixelChix.com).

BACK OF HOUSE

● RESET

TRY ME PULL TAB